

BGA 100

**STIHL**



2 - 15	Gebrauchsanleitung
15 - 28	Instruction Manual
28 - 42	Manual de instrucciones
42 - 55	Skötselföreläsning
55 - 68	Käyttöohje
68 - 81	Betjeningsvejledning
81 - 94	Bruksanvisning
94 - 107	Návod k použití
108 - 121	Használati utasítás
121 - 135	Instruções de serviço
135 - 150	Инструкция по эксплуатации
150 - 164	Instrukcja użytkowania
164 - 179	Ръководство за употреба
179 - 193	Instrucțiuni de utilizare



i. v. 

Robert Olma, Vice President, Regulatory Affairs  
& Global Governmental Relations

## 22 UKCA-Konformitätserklärung

### 22.1 Blasgerät STIHL BGA 100



ANDREAS STIHL AG & Co. KG  
Badstraße 115  
D-71336 Waiblingen  
Deutschland

erklärt in alleiniger Verantwortung, dass

- Bauart: Akku-Blasgerät
- Fabrikmarke: STIHL
- Typ: BGA 100
- Serienidentifizierung: 4866

den einschlägigen Bestimmungen der UK-Verordnungen The Restriction of the Use of Certain Hazardous Substances in Electrical and Electronic Equipment Regulations 2012, Supply of Machinery (Safety) Regulations 2008, Electromagnetic Compatibility Regulations 2016 und Noise Emission in the Environment by Equipment for use Outdoors Regulations 2001 entspricht und in Übereinstimmung mit den jeweils zum Produktionsdatum gültigen Versionen der folgenden Normen entwickelt und gefertigt worden ist: EN 55014-1, EN 55014-2, EN 60335-1 und EN 50636-2-100.

Zur Ermittlung des gemessenen und des garantierten Schalleistungspegels wurde nach UK-Verordnung Noise Emission in the Environment by Equipment for use Outdoors Regulations 2001, Schedule 8 verfahren.

- Gemessener Schalleistungspegel: 88 dB(A)
- Garantierter Schalleistungspegel: 90 dB(A)

Die Technischen Unterlagen sind bei der ANDREAS STIHL AG & Co. KG aufbewahrt.

Das Baujahr, das Herstellungsland und die Maschinenummer sind auf dem Blasgerät angegeben.

Waiblingen, 01.08.2022

ANDREAS STIHL AG & Co. KG

i. v. 

Robert Olma, Vice President, Regulatory Affairs  
& Global Governmental Relations

## 23 Anschriften

### STIHL Hauptverwaltung

ANDREAS STIHL AG & Co. KG  
Postfach 1771  
D-71307 Waiblingen

### STIHL Vertriebsgesellschaften

#### DEUTSCHLAND

STIHL Vertriebszentrale AG & Co. KG  
Robert-Bosch-Straße 13  
64807 Dieburg  
Telefon: +49 6071 3055358

#### ÖSTERREICH

STIHL Ges.m.b.H.  
Fachmarktstraße 7  
2334 Vösendorf  
Telefon: +43 1 86596370

#### SCHWEIZ

STIHL Vertriebs AG  
Isenrietstraße 4  
8617 Mönchaltorf  
Telefon:+41 44 9493030

## Contents

1	Introduction.....	16
2	Guide to Using this Manual.....	16
3	Overview.....	16
4	Safety Precautions.....	17
5	Preparing the Blower for Operation.....	20
6	Assembling the Blower.....	20
7	Adjusting Blower for User.....	21
8	Inserting and Removing Connecting Cable Plug.....	23
9	Switching the Blower On/Off.....	23
10	Checking the Blower.....	24
11	Operating the Blower.....	24
12	After Finishing Work.....	25
13	Transporting.....	25
14	Storing.....	25
15	Cleaning.....	25
16	Maintenance and Repairs.....	25
17	Troubleshooting.....	26
18	Specifications.....	27

19 Spare Parts and Accessories.....27  
 20 Disposal..... 27  
 21 EC Declaration of Conformity..... 27  
 22 UKCA Declaration of Conformity..... 28  
 23 Addresses..... 28

# 1 Introduction

Dear Customer,

Thank you for choosing STIHL. We develop and manufacture our quality products to meet our customers' requirements. The products are designed for reliability even under extreme conditions.

STIHL also stands for premium service quality. Our dealers guarantee competent advice and instruction as well as comprehensive service support.

STIHL expressly commit themselves to a sustainable and responsible handling of natural resources. This user manual is intended to help you use your STIHL product safely and in an environmentally friendly manner over a long service life.

We thank you for your confidence in us and hope you will enjoy working with your STIHL product.



Dr. Nikolas Stihl

**IMPORTANT! READ BEFORE USING AND KEEP IN A SAFE PLACE FOR REFERENCE.**

## 2 Guide to Using this Manual

### 2.1 Applicable documents

The local safety regulations apply.

- ▶ In addition to this User Manual, you should also read, understand and retain the following documents:
  - User Manual for STIHL AR battery
  - User Manual for "AP belt bag with connecting cable"
  - Safety instructions and precautions for STIHL AP battery
  - User Manual for STIHL AL 101, 301, 301-4, 500 and 501 chargers
  - Safety information for STIHL batteries and products with built-in battery:  
[www.stihl.com/safety-data-sheets](http://www.stihl.com/safety-data-sheets)

## 2.2 Symbols used with warnings in the text

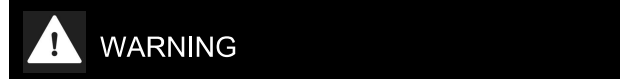

- This symbol indicates dangers that can cause serious injuries or death.
  - ▶ The measures indicated can avoid serious injuries or death.



- This symbol indicates dangers that can cause damage to property.
  - ▶ The measures indicated can avoid damage to property.

## 2.3 Symbols in Text

 This symbol refers to a chapter in this instruction manual.

# 3 Overview

## 3.1 Blower

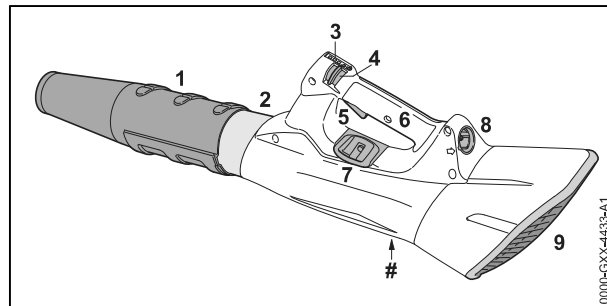

- 1 Nozzle**  
The nozzle directs and concentrates the air stream.
- 2 Blower tube**  
The blower tube directs the air stream.
- 3 LEDs**  
The LEDs indicate the selected power level.
- 4 Retaining latch**  
The retaining latch unlocks the trigger. It is also used to select the power level.
- 5 Trigger**  
The trigger switches the blower on and off.
- 6 Control handle**  
The control handle is used to operate, control and carry the blower.
- 7 Carrying ring**  
The carrying ring is used for attaching the carrying system.

**8 Socket**

The socket is used to plug in the connecting cable plug.

**9 Shield**

The shield protects the user from moving parts inside the blower.

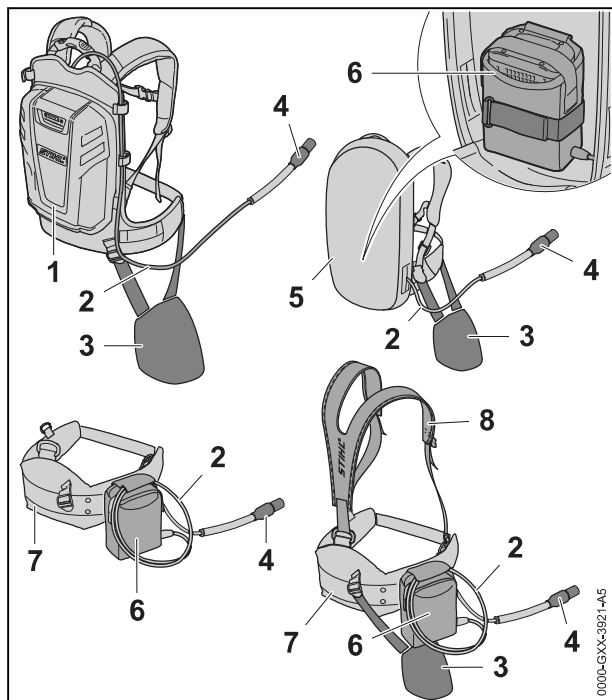
**# Rating plate with serial number****3.2 Carrying systems****1 STIHL AR battery**

The STIHL AR battery supplies power to the blower.

**2 Connecting cable**

The connecting cable connects the blower to the battery or to the AP belt bag with connecting cable.

**3 Support cushion**

The support cushion serves to secure the blower to the STIHL AR battery or the carrying system with integrated AP belt bag with connecting cable.

**4 Connecting cable plug**

The connecting cable plug connects the blower to the AP belt bag with connecting cable or a STIHL AR battery.

**5 Carrying system with integrated AP belt bag with connecting cable**

The carrying system supplies power to the blower.

**6 AP belt bag with connecting cable**

The AP belt bag with connecting cable supplies power to the blower.

**7 Shoulder strap**

The shoulder strap is used to carry the blower.

**8 The battery belt with integrated AP belt bag with connecting cable**

The battery belt supplies power to the blower.

**3.3 Symbols**

Meanings of symbols that may be on the blower:



Retaining latch unlocks the trigger in this position.



Retaining latch locks the trigger in this position.



Guaranteed sound power level according to directive 2000/14/EC in dB(A) in order to make sound emissions of products comparable.



Do not dispose of the product with your household waste.

**4 Safety Precautions****4.1 Warning Signs**

Meanings of warning signs on the blower:



Observe safety notices and take the necessary precautions.



Read, understand and save the instruction manual.



Wear safety glasses.



Confine long hair so that it cannot be sucked into the blower.



Disconnect connecting cable plug from socket during work breaks, transport, storage, maintenance and repairs.

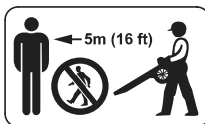

Maintain safe distance.

## 4.2 Intended Use

The STIHL BGA 100 blower is designed for blow-sweeping leaves, grass, paper and similar matter.

The blower may be used in the rain.

Power to this blower is supplied by a STIHL AP battery in combination with the “AP belt bag with connecting cable” or a STIHL AR battery.

### ⚠ WARNING

- Batteries not explicitly approved for the blower by STIHL may cause a fire or explosion. This can result in serious or fatal injuries and damage to property.
  - ▶ Use the blower with a STIHL AP battery in combination with the “AP belt bag with connecting cable” or an STIHL AR battery.
- Using the blower or the battery for purposes for which they were not designed may result in serious or fatal injuries and damage to property.
  - ▶ Use the blower as described in this instruction manual.
  - ▶ Use the battery as described in the instruction manual for the “AP belt bag with connecting cable” or the STIHL AR battery.

## 4.3 The Operator

### ⚠ WARNING

- Users who have had no instruction cannot recognize or assess the risks involved in using the blower. The user or other persons may sustain serious or fatal injuries.



- ▶ Read, understand and save the instruction manual.

- ▶ If you pass the blower on to another person: Always give them the instruction manual.
- ▶ Make sure the user meets the following requirements:
  - The user must be rested.
  - The user must be in good physical condition and mental health to operate and work with the blower. If the user’s physical, sensory or mental ability is restricted, he or she may work only under the supervision of or as instructed by a responsible person.
  - The user is able to recognize and assess the risks involved in using the blower.

- The user must be of legal age or is being trained in a trade under supervision in accordance with national rules and regulations.
  - The user has received instruction from a STIHL servicing dealer or other experienced user before working with the blower for the first time.
  - The user must not be under the influence of alcohol, medication or drugs.
- ▶ If you have any queries: Contact a STIHL servicing dealer for assistance.

## 4.4 Clothing and Equipment

### ⚠ WARNING

- Long hair can be sucked into the blower during operation. This can result in serious injuries.



- ▶ Tie up long hair so that it is above shoulder level.

- Objects can be thrown through the air at high speed during operation. This can result in personal injury.



- ▶ Wear close-fitting safety glasses. Suitable glasses that have been tested and labeled in accordance with EN 166 or national standards are available from retailers.

- ▶ Wear long trousers.
- Dust can be whipped up during operation: Whipped up dust can damage the respiratory passages and cause allergic reactions.
  - ▶ If dust is generated: Wear a dust respirator mask.
- Unsuitable clothing can snag on wood, brush or the blower. Not wearing suitable clothing may result in serious injury.
  - ▶ Wear snug-fitting clothing.
  - ▶ Do not wear a scarf or jewelry.
- Wearing unsuitable footwear may cause you to slip or stumble. This can result in personal injury.
  - ▶ Wear sturdy enclosed footwear with non-slip soles.

## 4.5 Working Area and Surroundings

### ⚠ WARNING

- Bystanders, children and animals are not aware of the dangers of the blower and objects being thrown into the air and cannot assess them. This may result in serious injury

to bystanders, children and animals and damage to property.



- ▶ Do not allow bystanders, children or animals within 5 meters of the work area.

- ▶ Maintain a clearance of 5 meters from objects.
- ▶ Do not leave the blower unattended.
- ▶ Ensure that children cannot play with the blower.
- Electrical components of the blower can produce sparks. Sparks may cause fires and explosions in highly flammable or explosive environments. Persons may be seriously or fatally injured and property may be damaged.
  - ▶ Do not work in a highly flammable or explosive environment.

#### 4.6 Safe condition

The blower is in a safe condition if the following conditions are fulfilled:

- The blower is undamaged.
- The blower is clean.
- The controls function properly and have not been modified.
- Original STIHL accessories are fitted.
- The accessories are correctly attached.

#### ⚠ WARNING

- If not in safe condition, components may no longer operate correctly and safety devices may be disabled. This may result in serious or fatal injury to people.
  - ▶ Never use a damaged blower.
  - ▶ If the blower is dirty: Clean the blower.
  - ▶ Do not modify the blower. Exception: Mounting a nozzle approved for this blower model.
  - ▶ If the controls do not function properly: Do not work with the blower.
  - ▶ Fit original STIHL accessories designed for this blower model.
  - ▶ Attach accessories as described in this User Manual or in the User Manual for the accessories.
  - ▶ Do not insert objects into the openings in the blower.
  - ▶ Replace worn or damaged labels.
  - ▶ If you have any doubts, be sure to consult a STIHL dealer.

#### 4.7 Working

#### ⚠ WARNING

- In certain situations, the user may no longer be able to concentrate on their work. This may result in the user stumbling, falling and suffering serious injury.
  - ▶ Work calmly and methodically.
  - ▶ If light and visibility are poor: Do not work with the blower.
  - ▶ Do not use the blower on your own.
  - ▶ Do not work above shoulder height.
  - ▶ Watch out for obstacles.
  - ▶ Work standing on the ground and keep your balance. If you have to work at a height: Use a mobile elevating work platform or a secure scaffolding.
  - ▶ If you start feeling fatigue: take a break.
  - ▶ Blow in direction of the wind.
- Objects can be thrown at high speed during operation. This can result in injuries to persons and animals and damage to property.
  - ▶ Do not direct air blast towards people, animals or objects.
- If the blower starts behaving differently or in an unusual way while operating, the blower may be in an unsafe condition. This may result in serious injury to people and damage to property.
  - ▶ Stop your work, detach the connecting cable plug from the socket and contact a STIHL authorized dealer.
- Vibrations may occur during blower operation.
  - ▶ Take breaks.
  - ▶ If signs of a circulatory disorder occur: Consult a doctor.
- The dust whipped up may cause the blower to be electrostatically charged. In certain conditions (e.g. dry environment) the blower may discharge suddenly and emit sparks. Sparks may cause fires and explosions in highly flammable or explosive environments. Persons may be seriously or fatally injured, and property may be damaged.
  - ▶ Do not work in a highly flammable or explosive environment.

#### 4.8 Transporting

#### ⚠ WARNING

- The blower can turn over or move while being transported. This may result in personal injuries and damage to property.
  - ▶ Push the retaining latch into position .



- ▶ Pull the connecting cable plug out of the socket.

- ▶ Secure the blower with lashing straps or a net to prevent it turning over and moving.

## 4.9 Storing

### **⚠** WARNING

- Children are not aware of and cannot assess the dangers of a blower and can be seriously injured.

- ▶ Push the retaining latch into position .



- ▶ Pull the connecting cable plug out of the socket.

- ▶ Store the blower out of the reach of children.

- Dampness can corrode the electrical contacts on the blower and metal components. The blower may be damaged.

- ▶ Push the retaining latch into position .



- ▶ Pull the connecting cable plug out of the socket.

- ▶ Store the blower in a clean and dry condition.

## 4.10 Cleaning, Maintenance and Repair

### **⚠** WARNING

- The blower may start unintentionally if the connecting cable plug remains inserted during cleaning, maintenance or repair operations. This may result in serious injury to people and damage to property.

- ▶ Move the retaining latch to the  position.



- ▶ Pull the connecting cable plug out of the socket.

- Harsh detergents, cleaning with a water jet or sharp objects can damage the blower. If the blower is not cleaned as described in this instruction manual, components may no longer function properly or safety devices may be rendered inoperative. They may cause serious injury to persons.

- ▶ Clean the blower as described in this instruction manual.

- If the blower is not serviced or repaired correctly, components may no longer function



properly or safety devices may be rendered inoperative. This may result in serious or fatal injury to people.

- ▶ Do not attempt to service or repair the blower.
- ▶ If the blower needs to be serviced or repaired: Contact your STIHL servicing dealer for assistance.

## 5 Preparing the Blower for Operation

### 5.1 Preparing the blower for operation

The following steps must be performed before commencing work:

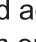
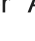
- ▶ Ensure that the following components are in a safe condition:
  - Blower,  4.6.
  - Battery as described in the STIHL AR battery's instruction manual or in the user instructions for the "AP belt bag with connecting cable".
- ▶ Check the battery as described in the STIHL AR battery's instruction manual or in the user instructions for the "AP belt bag with connecting cable".
- ▶ Fully charge the battery as described in the User Manual for STIHL AL 101, 301, 301-4, 500 and 501 chargers.
- ▶ Clean blower,  15.
- ▶ Adjust nozzle,  6.1.
- ▶ Put on and adjust the STIHL AR battery, carrying system or "AP belt bag with connecting cable",  7.
- ▶ Check the controls,  10.1.
- ▶ If it is not possible to carry out these steps: Do not use the blower and contact a STIHL authorized dealer.

## 6 Assembling the Blower

### 6.1 Mounting, Adjusting and Removing the Nozzle

The nozzle can be mounted to the blower tube in three positions to suit the height and reach of the user. The positions are marked on the blower tube.

- ▶ Switch off the blower and pull out the connecting cable plug.

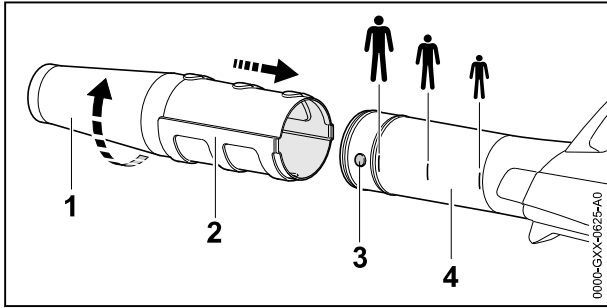

- ▶ Line up the lug (3) and the slot (2).
- ▶ Push nozzle (1) into required position on blower tube (4).
- ▶ Rotate nozzle (1) until it engages.

## 7 Adjusting Blower for User

### 7.1 Using with STIHL AR Battery

#### 7.1.1 Installing and adjusting the connecting cable

The connecting cable must be installed and adjusted to suit the user's size and the application.

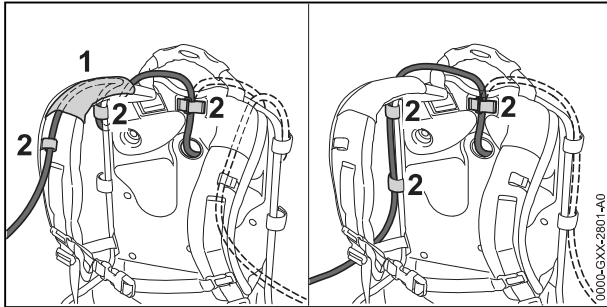

- ▶ Secure the connecting cable in position by the guide (1) on the harness and the buckles (2) or on the side of the backplate with the buckles (2).

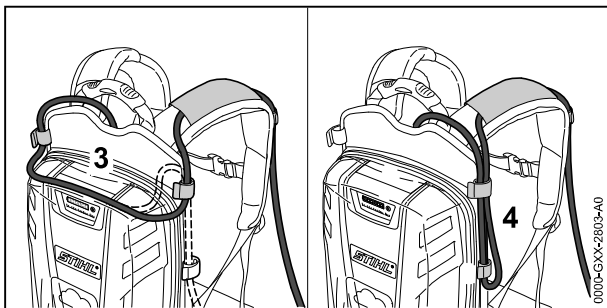

- ▶ If the connecting cable is too long: Adjust the length of the connecting cable by making a loop on the battery (3) or a loop at one side (4).
- ▶ Install the connecting cable so that it has no kinks and is as short as possible without hindering your work.

#### 7.1.2 Fitting and Adjusting the Carrying System

- ▶ Put the battery on your back.

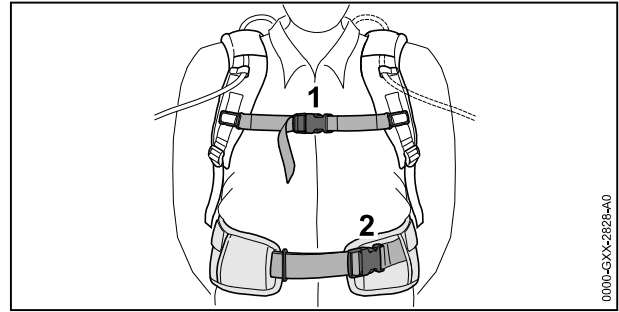

- ▶ Close buckle (2) on the waist belt.
- ▶ Close buckle (1) on the chest strap.

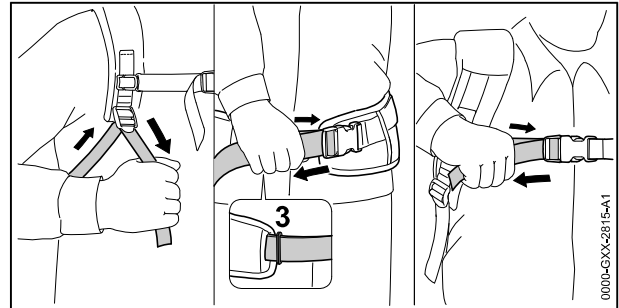

- ▶ Tighten the straps until the waist belt fits snugly on your hips and the back padding is against your back.
- ▶ Thread the end of the waist belt through the loop (3).
- ▶ Fit the hip pad as described in the instructions supplied with the hip pad.

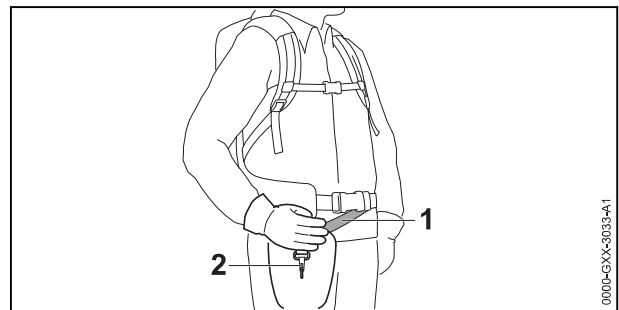

- ▶ Adjust the strap (1) so that the carabiner (2) is about a hand's width below your right hip.

### 7.2 Using with Carrying System

#### 7.2.1 Installing and adjusting the connecting cable

The connecting cable must be installed and adjusted to suit the user's size and the application.

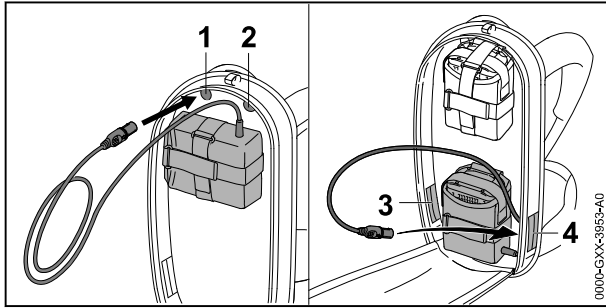

The connecting cable can be fed through the following openings:

- The upper left opening (1)
- The upper right opening (2)
- The lower left opening (3)
- The lower right opening (4)

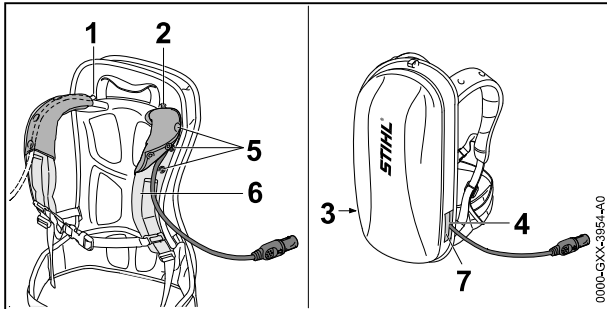

- ▶ If the connecting cable is fed through the upper left opening (1) or the upper right opening (2):
  - ▶ Open the press studs (5).
  - ▶ Feed the connecting cable over the shoulder strap (6).
  - ▶ Close the press studs (5).
- ▶ If the connecting cable is fed through the lower left opening (3) or the lower right opening (4): Seal the opening you use (3 or 4) with the hook and loop fastener (7).
- ▶ Install the connecting cable so that it has no kinks and is as short as possible without hindering your work.

### 7.2.2 Fitting and Adjusting the Carrying System

- ▶ Put the battery on your back.

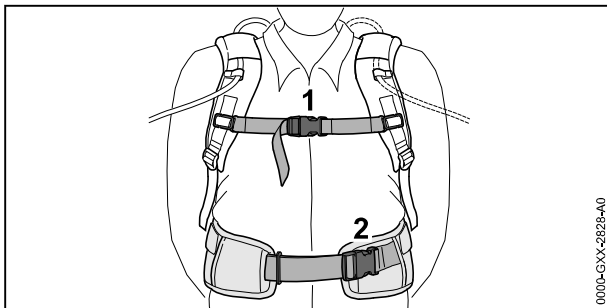

- ▶ Close buckle (2) on the waist belt.
- ▶ Close buckle (1) on the chest strap.

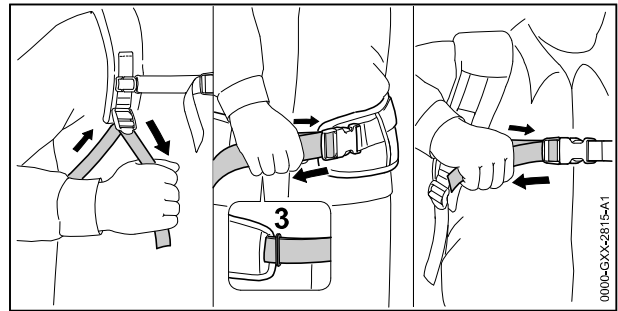

- ▶ Tighten the straps until the waist belt fits snugly on your hips and the back padding is against your back.
- ▶ Thread the end of the waist belt through the loop (3).
- ▶ Fit the hip pad as described in the instructions supplied with the hip pad.

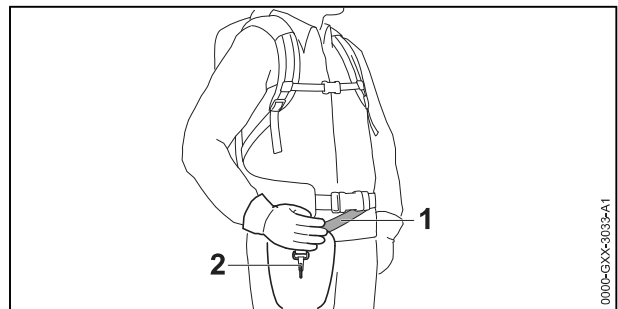

- ▶ Adjust the strap (1) so that the carabiner (2) is about a hand's width below your right hip.

## 7.3 Using with AP Belt Bag with Connecting Cable

### 7.3.1 Attaching "AP Belt Bag with Connecting Cable"

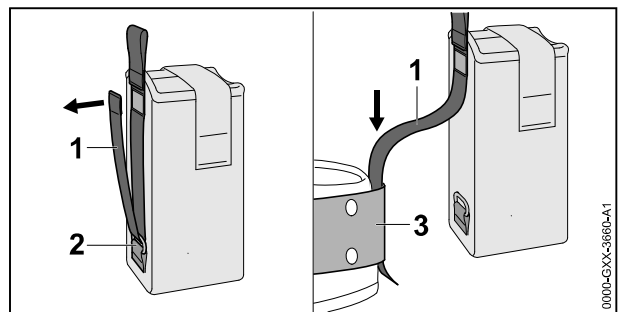

- ▶ Open the hook and loop fastener on the strap (1) and pull the strap (1) out of the ring (2).
- ▶ Thread the strap (1) through the belt (3).

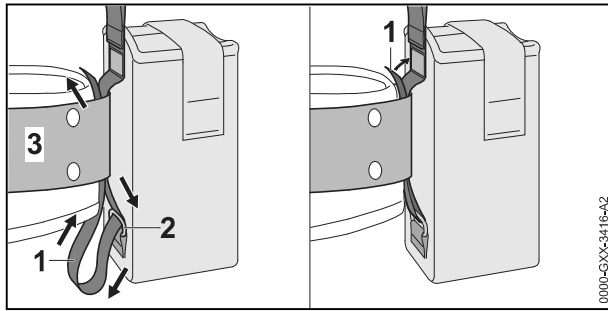

- ▶ Thread the strap (1) through the ring (2) and back through the belt (3).
- ▶ Close the hook and loop fastener (1).

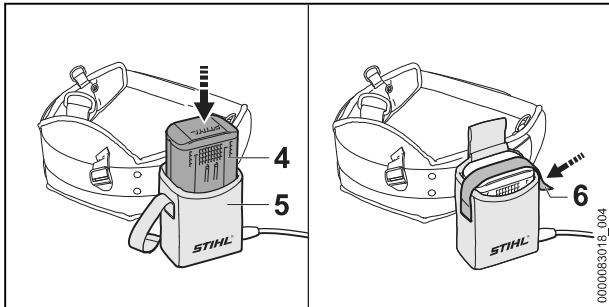

- ▶ Push the battery (4) up to the limit stop into the belt bag (5). A short beep will sound.
- ▶ Secure the battery (4) in position with the hook and loop fastener (6).

### 7.3.2 Adjusting the connecting cable

The connecting cable must be adjusted to suit the user's size and the application.

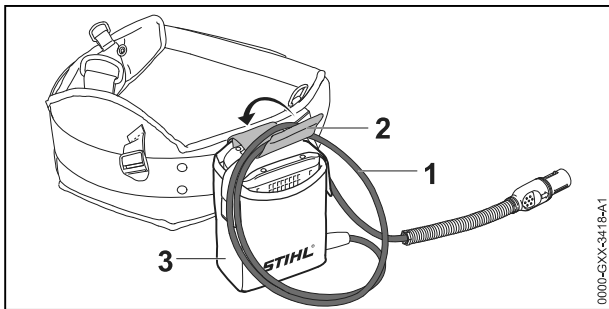

- ▶ If the connecting cable is too long: Adjust the length of the connecting cable by making a loop (1) and use the fastener (2) to attach it to the belt bag (3).
- ▶ Install the connecting cable so that it has no kinks and is as short as possible without hindering your work.

## 8 Inserting and Removing Connecting Cable Plug

### 8.1 Inserting the Connecting Cable Plug

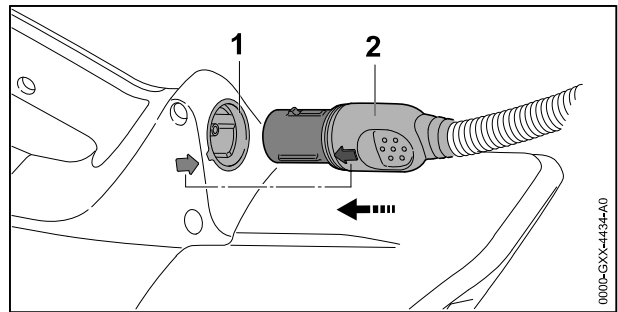

- ▶ Hold connecting cable plug (2) so that the arrow on its side lines up with the arrow on the socket (1).
- ▶ Insert the connecting cable plug (2) in the socket (1). The plug (2) engages in position.

### 8.2 Removing the Connecting Cable Plug

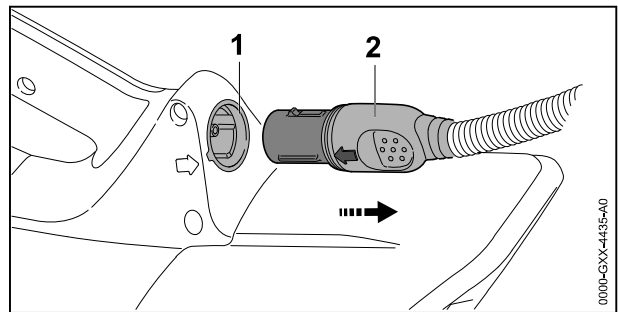



- ▶ Grip the connecting cable plug (2) with your hand.
- ▶ Pull the plug (2) out of the socket (1).

## 9 Switching the Blower On/Off

### 9.1 Switching On

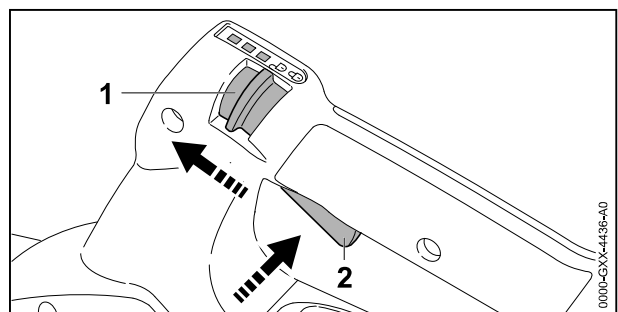
- ▶ Hold the blower with one hand on the control handle - wrap your thumb around the handle.



- ▶ Push the retaining latch (1) with your thumb to position .
- ▶ Pull the trigger (2) with your index finger and hold it there.  
The blower accelerates and air flows from the nozzle.

The air flow rate is controlled by the trigger (2).



## 9.2 Switching off the blower

- ▶ Release the trigger.  
Air stops flowing out of the nozzle.
- ▶ If air continues to flow from nozzle: Pull connecting cable plug out of the socket and contact your STIHL dealer for assistance.  
The blower is faulty.
- ▶ Move retaining latch to the  position.

# 10 Checking the Blower

## 10.1 Checking the Controls

### Trigger

- ▶ Pull the connecting cable plug out of the socket.
- ▶ Push the retaining latch into position .
- ▶ Try to pull the trigger.
- ▶ If the trigger can be pulled: Do not use the blower and contact your STIHL servicing dealer for assistance.  
The retaining latch is faulty.
- ▶ Push the retaining latch into position .
- ▶ Pull the trigger and then let it go.
- ▶ If the trigger is stiff or does not spring back to its idle position: Do not use the blower and contact your STIHL servicing dealer for assistance.  
The trigger has a malfunction.

### Switching on the blower

- ▶ Insert the connecting cable plug.
- ▶ Push the retaining latch into position .
- ▶ Pull the trigger and hold it there.  
Air flows from the nozzle.
- ▶ If 3 LEDs on the battery flash red: Pull connecting cable plug out of the socket and contact your STIHL dealer for assistance.  
There is a malfunction in the blower.
- ▶ Release the trigger.  
No air flows from the nozzle.
- ▶ If air continues to flow from nozzle: Pull connecting cable plug out of the socket and contact your STIHL dealer for assistance.  
Blower has a malfunction.

# 11 Operating the Blower

## 11.1 Holding and Controlling the Blower

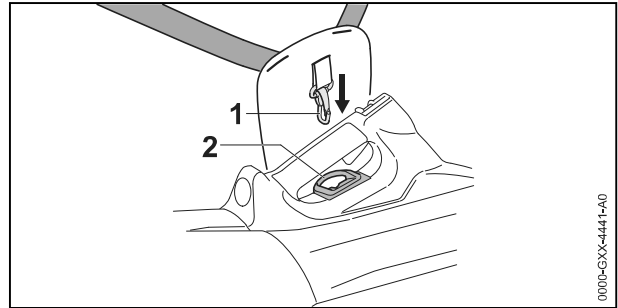

- ▶ If you use the STIHL AR battery or the carrying system with hip padding: Connect the carrying ring (2) to the carabiner (1).

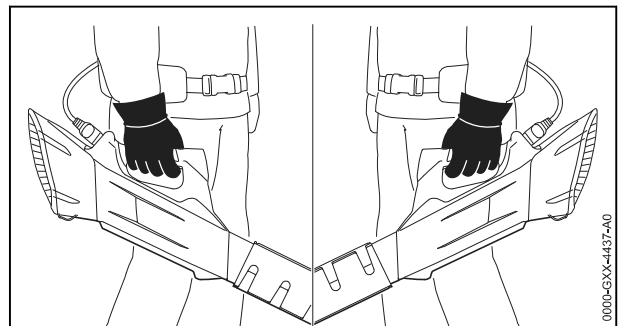



- ▶ Hold and control the blower with one hand on the control handle - wrap your thumb around the handle.

## 11.2 Setting the performance level

Depending on the application, 3 power levels can be set. The LEDs indicate the selected power level. The higher the power level, the higher the volume of air that flows from the nozzle.

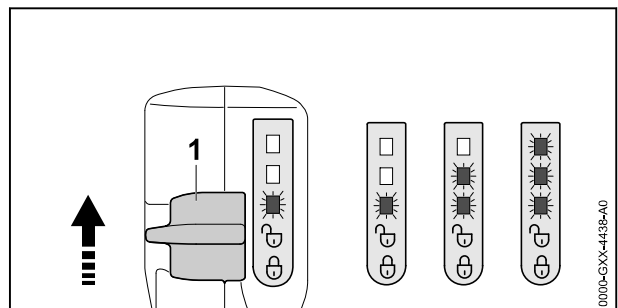
The selected power level affects the battery's runtime. The lower the power level, the longer the runtime.



- ▶ Slide the retaining latch (1) to the  position with your thumb.  
The LEDs indicate the selected power level.

- ▶ Push the retaining latch (1) forwards, hold briefly and allow it to spring back. This selects the next power level. After the third performance level, it starts again with the first performance level.
- ▶ Push the retaining latch (1) forwards and allow it to spring back as many times as necessary to select the required power level.

### 11.3 Activating the Boost Function

The boost function can be activated independent of the selected power level. The blower operates at maximum power when the boost function is activated.

The boost function affects the battery's runtime. The longer the boost function is activated, the shorter the battery runtime.

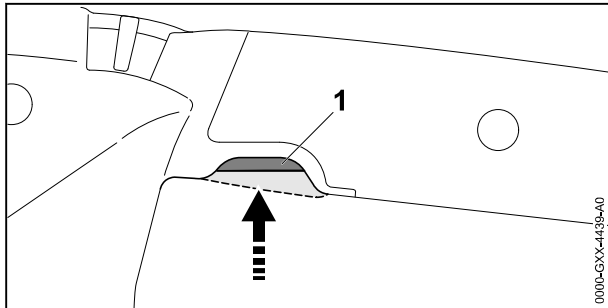

- ▶ Override the trigger's (1) end position and hold it there. The LEDs flash in sequence. The boost function is activated.

The boost function is deactivated when you release the trigger (1). The previously selected power level is restored.

### 11.4 Blow-Sweeping

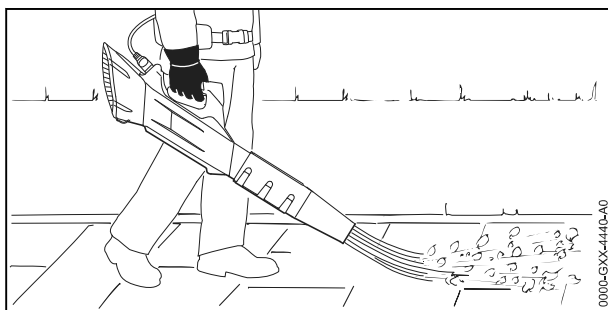

- ▶ Point the nozzle at the ground.
- ▶ Walk slowly and steadily forwards.

## 12 After Finishing Work

### 12.1 After Finishing Work

- ▶ Switch off the blower, move retaining latch to position  and pull the connecting cable plug out of the socket.

- ▶ If the blower is wet: Allow the blower to dry.
- ▶ Clean the blower.

## 13 Transporting

### 13.1 Transporting the blower

- ▶ Switch off the blower, move retaining latch to position  and pull the connecting cable plug out of the socket.

#### Carrying the blower

- ▶ Carry blower by the control handle in one hand.

#### Transporting the blower in a vehicle

- ▶ Secure the blower so that it cannot topple over and cannot move.

## 14 Storing

### 14.1 Storing the blower

- ▶ Switch off the blower, move retaining latch to position  and pull the connecting cable plug out of the socket.
- ▶ The blower should be stored so that the following conditions are met:
  - The blower cannot topple over and cannot move.
  - The blower must be out of the reach of children.
  - The blower must be clean and dry.

## 15 Cleaning

### 15.1 Cleaning the blower

- ▶ Switch off the blower, move retaining latch to position  and pull the connecting cable plug out of the socket.
- ▶ Clean blower with a damp cloth.
- ▶ Clean vents with a paintbrush.
- ▶ Clean the shield with a paintbrush or soft brush.

## 16 Maintenance and Repairs

### 16.1 Maintenance Intervals

The maintenance intervals are dependent on the environmental and operating conditions. STIHL recommends the following maintenance intervals:

#### Every 12 months

- ▶ Have the blower checked by a STIHL servicing dealer.

## 16.2 Servicing and Repairing the Blower

- ▶ If your blower has a malfunction or is damaged or requires servicing: Contact your STIHL servicing dealer.

The blower cannot be serviced or repaired by the user.

# 17 Troubleshooting

## 17.1 Troubleshooting the Blower and Battery

Error	LEDs on the battery	Cause	Remedy
The blower does not start when switched on.	1 LED flashing green.	State of charge of the battery is too low.	▶ Charge the battery as described in the User Manual for STIHL AL 101, 301, 301-4, 500 and 501 chargers.
	1 LED lights up steady red.	The battery is too warm or too cold.	▶ Pull the connecting cable plug out of the socket. ▶ Allow the battery to cool down or warm up.
	3 LEDs flash red.	There is an error in the blower.	▶ Pull connecting cable plug out of the socket and plug it in again. ▶ Switch on the blower. ▶ If 3 LEDs continue to flash red: Do not use the blower and contact your STIHL dealer for assistance.
	3 LEDs light up red.	The blower is too warm.	▶ Pull the connecting cable plug out of the socket. ▶ Allow the blower to cool down.
	4 LEDs flash red.	There is an error in the battery.	▶ Pull connecting cable plug out of the socket and plug it in again. ▶ Switch on the blower. ▶ If 4 LEDs continue to flash red: Do not use the battery and contact a STIHL authorized dealer for assistance.
		No electrical contact between the blower and the battery.	▶ Pull connecting cable plug out of the socket and plug it in again. ▶ If blower still does not start when switched on: Clean contacts of connecting cable as described in the User Manual for the STIHL AR battery or the "AP belt bag with connecting cable".
		The blower or the battery is damp.	▶ Allow blower or battery to dry.
The blower switches off while in operation.	3 LEDs light up red.	The blower is too warm.	▶ Pull the connecting cable plug out of the socket. ▶ Allow the blower to cool down.
		There is an electrical error.	▶ Pull connecting cable plug out of the socket and plug it in again. ▶ If blower continues to cut out during operation: Clean contacts of connecting cable as described in the User Manual for the STIHL AR battery or the "AP belt bag with connecting cable". ▶ Switch on the blower.
The blower operating time is too short.		The battery is not fully charged.	▶ Fully charge the battery as described in the User Manual for STIHL AL 101, 301, 301-4, 500 and 501 chargers.
		The battery service life has been exceeded.	▶ Replace the battery.

## 18 Specifications

### 18.1 STIHL BGA 100 Blower

- Approved batteries:
  - STIHL AR
  - STIHL AP together with “AP belt bag with connecting cable”
- Air speed with nozzle mounted: 63 m/s
- Weight: 2.5 kg

For battery life see [www.stihl.com/battery-life](http://www.stihl.com/battery-life).

### 18.2 Noise and Vibration Data

K-value for sound pressure level is 2 dB(A). K-value for sound power level is 2 dB(A). K-value for vibration level is 2 m/s<sup>2</sup>.

STIHL recommends that you wear hearing protection.

- Sound pressure level  $L_{pA}$  measured according to EN 50636-2-100: 80 dB(A)
- Sound power level  $L_{WA}$  measured according to EN 50636-2-100: 90 dB(A)
- Vibration level  $a_{hv}$  measured according to EN 50636-2-100, control handle: < 2.5 m/s<sup>2</sup>.

The vibration values quoted above have been measured according to a standardized test procedure and may be used to compare electric power tools. Depending on the type of usage, the vibrations that actually occur may differ from the values quoted. The vibration values quoted may be used for an initial assessment of the user's exposure to vibrations. The actual exposure to vibrations has to be estimated. This process may also take into account times during which the electric power tool is switched off and times during which it is switched on but running off load.

Information on compliance with Vibration Directive 2002/44/EC is available at [www.stihl.com/vib](http://www.stihl.com/vib).

### 18.3 REACH

REACH is an EC regulation and stands for the Registration, Evaluation, Authorisation and Restriction of Chemical substances.

For information on compliance with the REACH regulation see [www.stihl.com/reach](http://www.stihl.com/reach).

## 19 Spare Parts and Accessories

### 19.1 Spare parts and accessories

**STIHL**  These symbols indicate original STIHL spare parts and original STIHL accessories.

STIHL recommends the use of original STIHL spare parts and accessories.

Despite ongoing market observation, STIHL is unable to judge the reliability, safety and suitability of other manufacturers' spare parts and accessories; accordingly, STIHL cannot warrant for the use of those parts.

Original STIHL spare parts and original STIHL accessories are available from STIHL dealers.

## 20 Disposal

### 20.1 Disposing of Blower

Contact the local authorities or your STIHL dealer for information on disposal.

Improper disposal can be harmful to health and pollute the environment.

- ▶ Take STIHL products including packaging to a suitable collection point for recycling in accordance with local regulations.
- ▶ Do not dispose with domestic waste.

## 21 EC Declaration of Conformity

### 21.1 STIHL BGA 100 Blower

ANDREAS STIHL AG & Co. KG  
Badstraße 115  
D-71336 Waiblingen

Germany

declares under our sole responsibility that

- Type: Cordless blower
- Manufacturer's brand: STIHL
- Model: BGA 100
- Serial number: 4866

conforms to the specifications of Directives 2011/65/EU, 2006/42/EC, 2014/30/EU and 2000/14/EC and has been developed and built in compliance with the versions of the following standards valid at the production date: EN 55014-1, EN 55014-2, EN 60335-1 and EN 50636-2-100.

The measured and guaranteed equivalent sound power level has been determined in accordance with Directive 2000/14/EC, Annex V.

- Measured sound power level: 88 dB(A)
- Guaranteed sound power level: 90 dB(A)

The technical documents are stored at ANDREAS STIHL AG & Co. KG Produktzulassung.

The year of construction, the country of manufacture and the machine number are shown on the blower.

Waiblingen, 2022-08-01

ANDREAS STIHL AG & Co. KG

pp 

Robert Olma, Vice President, Regulatory Affairs & Global Governmental Relations

## 22 UKCA Declaration of Conformity

### 22.1 STIHL BGA 100 Blower



ANDREAS STIHL AG & Co. KG  
Badstraße 115  
D-71336 Waiblingen

Germany

declare under our sole responsibility that

- Category: Cordless blower
- Manufacturer's brand: STIHL
- Model: BGA 100
- Serial number: 4866

conforms to the relevant provisions of UK regulations The Restriction of the Use of Certain Hazardous Substances in Electrical and Electronic Equipment Regulations 2012, Supply of Machinery (Safety) Regulations 2008, Electromagnetic Compatibility Regulations 2016 and Noise Emission in the Environment by Equipment for use Outdoors Regulations 2001 and has been manufactured in compliance with the following standards in the versions valid on the date of production: EN 55014-1, EN 55014-2, EN 60335-1 and EN 50636-2-100.

The measured and the guaranteed sound power level have been determined in accordance with UK regulation Noise Emission in the Environ-

ment by Equipment for use Outdoors Regulations 2001, Schedule 8..

- Measured sound power level: 88 dB(A)
- Guaranteed sound power level: 90 dB(A)

The technical documents are stored at ANDREAS STIHL AG & Co. KG Produktzulassung.

The year of construction, the country of manufacture and the machine number are shown on the blower.

Waiblingen, 01.08.2022

ANDREAS STIHL AG & Co. KG

pp 

Robert Olma, Vice President, Regulatory Affairs & Global Governmental Relations

## 23 Addresses

www.stihl.com

## Índice

1	Prólogo.....	28
2	Informaciones relativas a estas instrucciones para la reparación.....	29
3	Sinopsis.....	29
4	Indicaciones relativas a la seguridad.....	30
5	Preparar el soplador para el trabajo.....	34
6	Ensamblar el soplador.....	34
7	Ajustar el soplador para el operario.....	34
8	Insertar el enchufe del cable de conexión y extraerlo.....	37
9	Conectar y desconectar el soplador.....	37
10	Comprobar el soplador.....	37
11	Trabajar con el soplador.....	38
12	Después del trabajo.....	39
13	Transporte.....	39
14	Almacenamiento.....	39
15	Limpiar.....	39
16	Mantenimiento y reparación.....	39
17	Subsanar las perturbaciones.....	40
18	Datos técnicos.....	41
19	Piezas de repuesto y accesorios.....	41
20	Gestión de residuos.....	41
21	Declaración de conformidad UE.....	41
22	Declaración de conformidad UKCA.....	42
23	Direcciones.....	42

## 1 Prólogo

Distinguidos clientes,

Traducción del manual de instrucciones original 0000007936\_016\_E

Impreso en papel blanqueado sin cloro. El papel es reciclable.

© ANDREAS STIHL AG & Co. KG 2025 0458-711-9821-C, VA2, M24.