

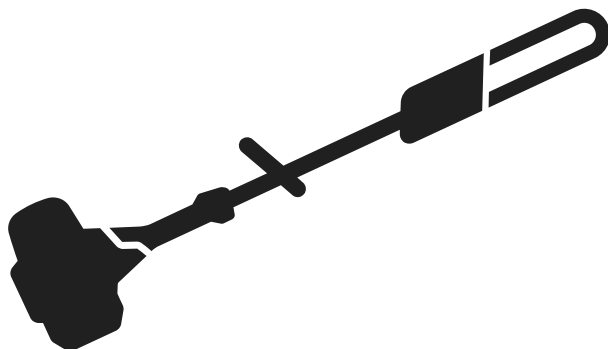

Husqvarna®



120iTK4-P



EN	Operator's manual	12-31
BG	Ръководство за експлоатация	32-54
CS	Návod k použití	55-73
DA	Brugsanvisning	74-92
DE	Bedienungsanweisung	93-114
EL	Οδηγίες χρήσης	115-137
ES	Manual de usuario	138-158
ET	Kasutusjuhend	159-177
FI	Käyttöohje	178-196
FR	Manuel d'utilisation	197-217
HR	Priručnik za korištenje	218-236
HU	Használati utasítás	237-256
IT	Manuale dell'operatore	257-277
JA	取扱説明書	278-296
KO	사용자 설명서	297-314
LT	Operatoriaus vadovas	315-333
LV	Lietošanas pamācība	334-353
MS	Panduan Pengguna	354-373
NL	Gebruiksaanwijzing	374-393
NO	Bruksanvisning	394-412
PL	Instrukcja obsługi	413-433
PT	Manual do utilizador	434-454
RO	Instrucțiuni de utilizare	455-475
RU	Руководство по эксплуатации	476-498
SK	Návod na obsluhu	499-518
SL	Navodila za uporabo	519-537
SV	Bruksanvisning	538-556
TR	Kullanım kılavuzu	557-575
UK	Посібник користувача	576-597
VI	Sách hướng dẫn sử dụng	598-615
ZH	操作手册	616-631

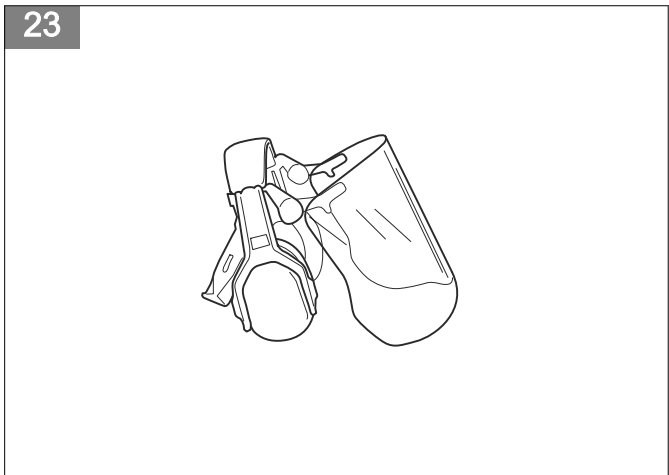
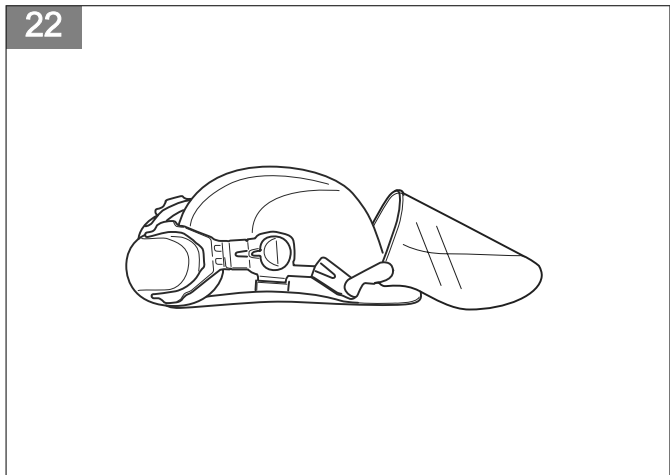
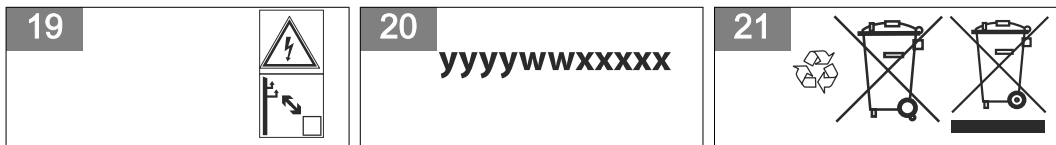
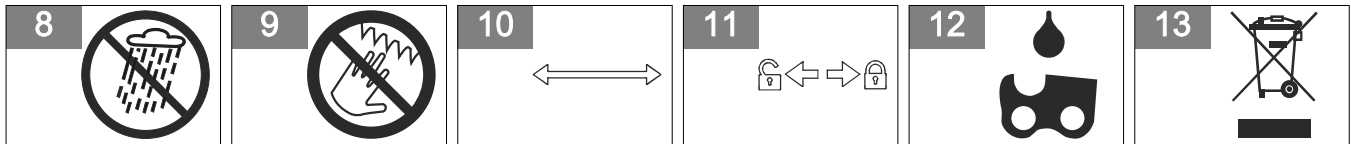
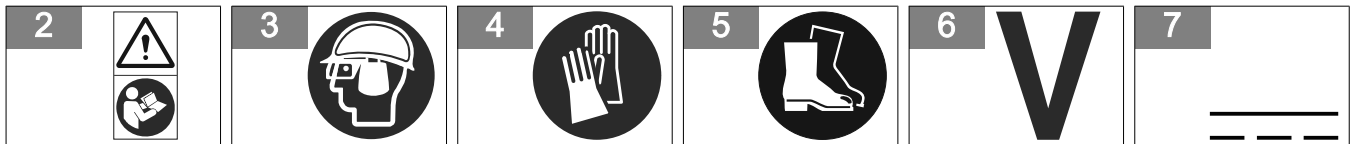
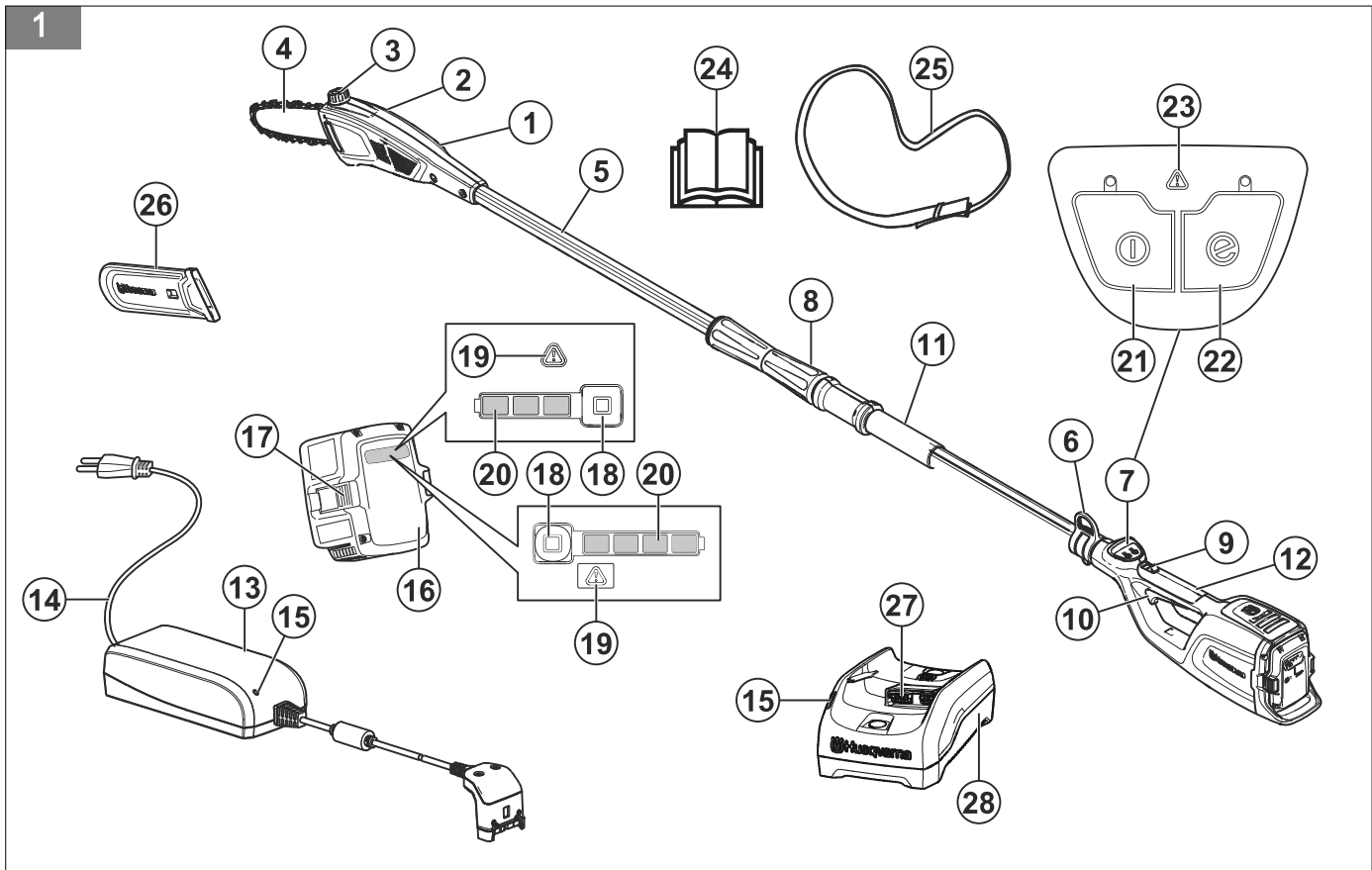

24

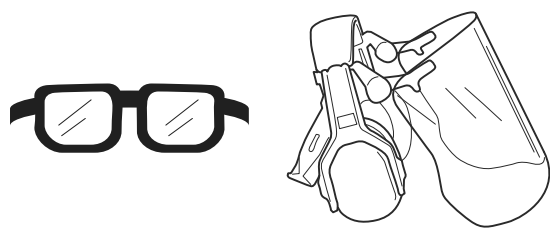

25

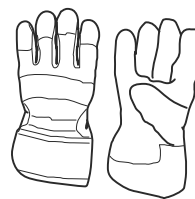

26



27



28

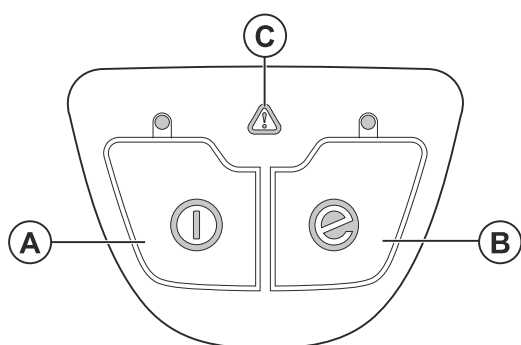

29

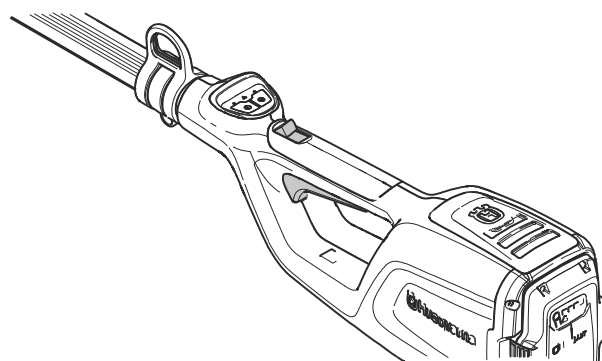

30

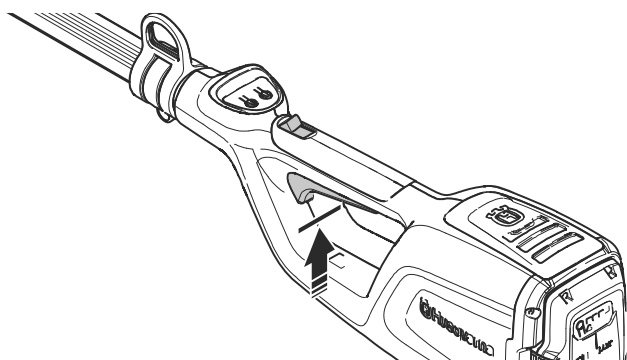

31

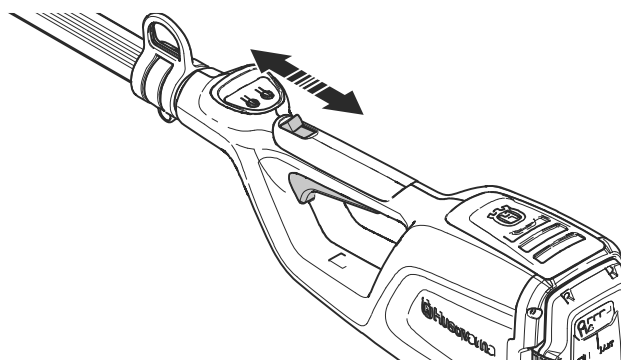

32

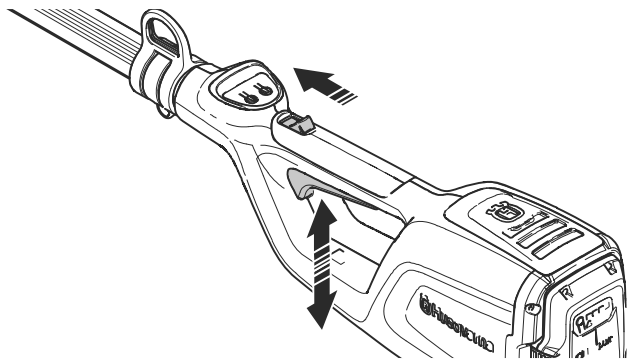

33

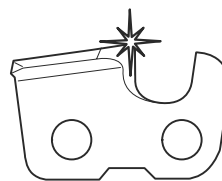

34

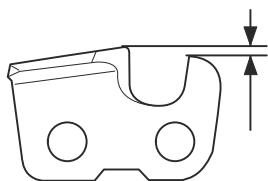

35

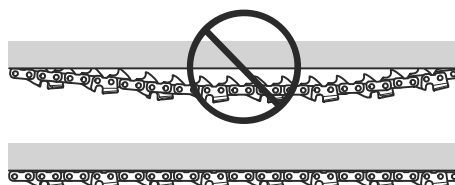

36

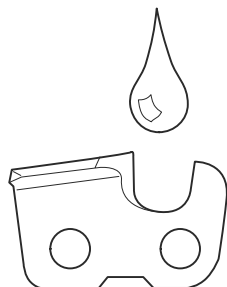

37

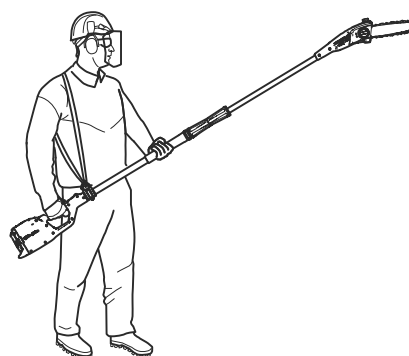

38

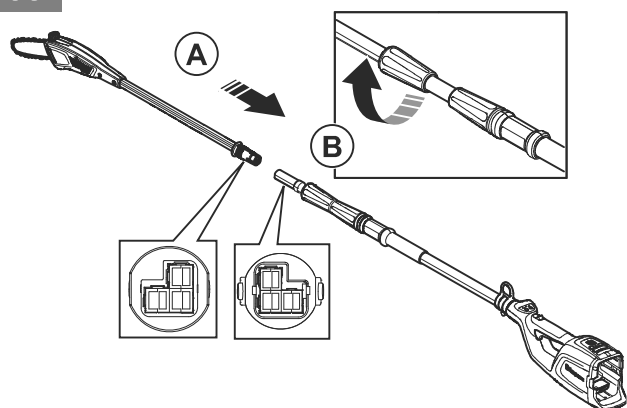

39

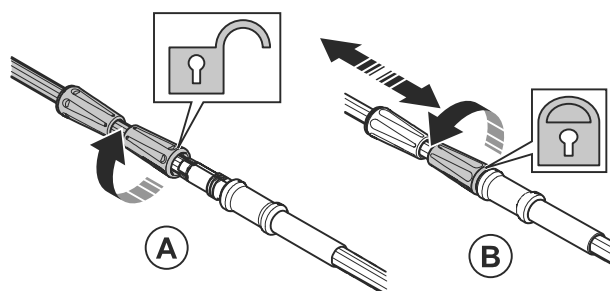

40

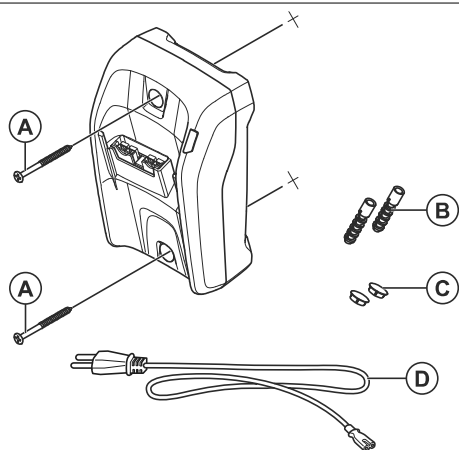

41

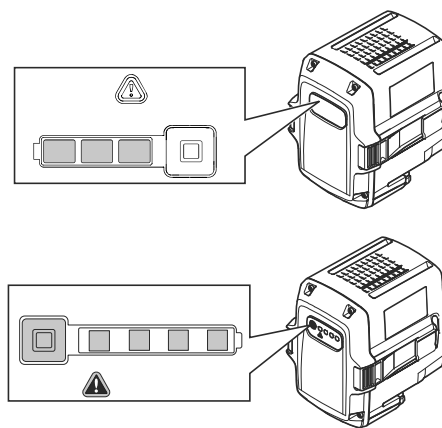

42

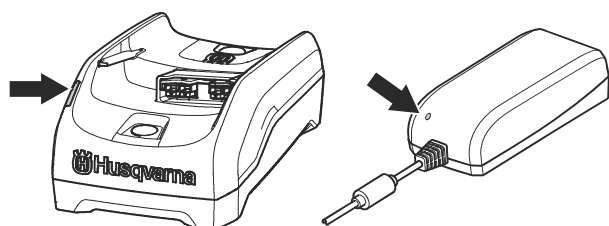

43

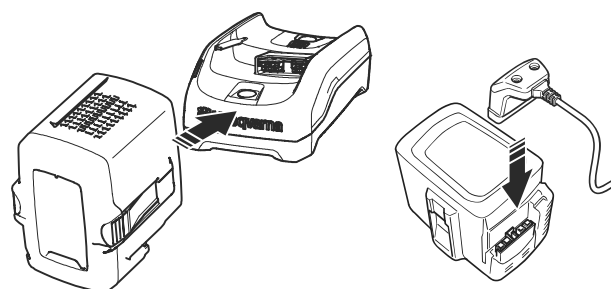

44

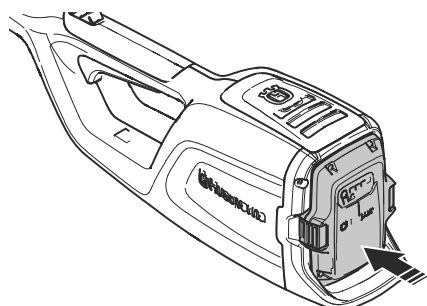

45

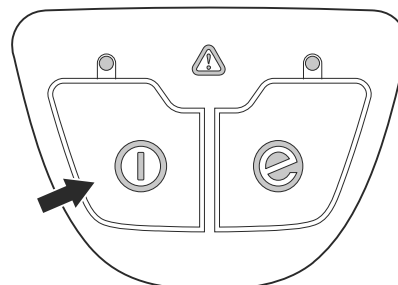

46

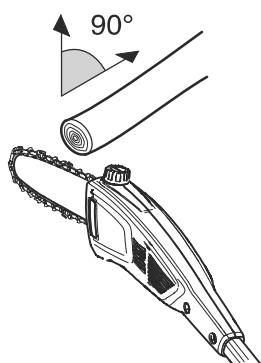

47

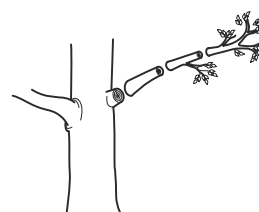

48

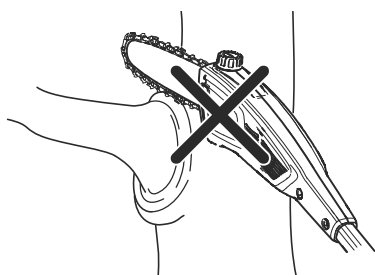

49

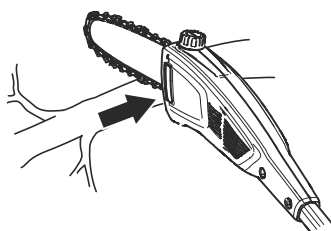

50

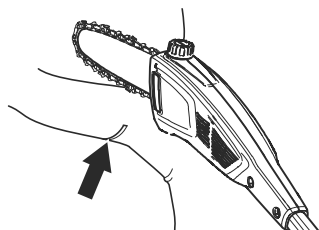

51

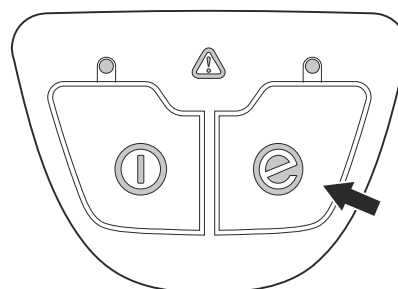

52

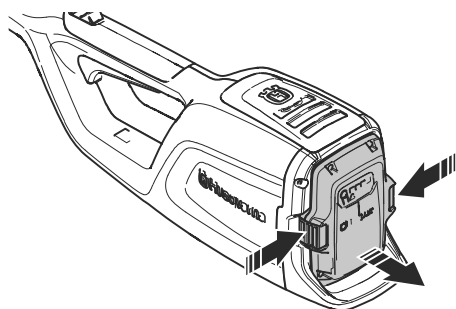

53

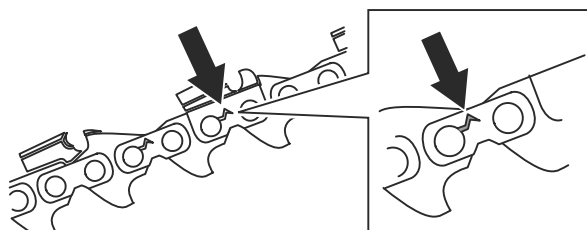

54

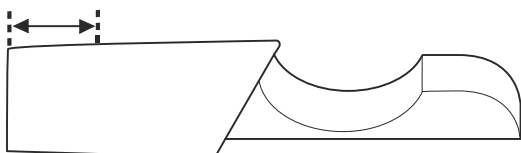

55

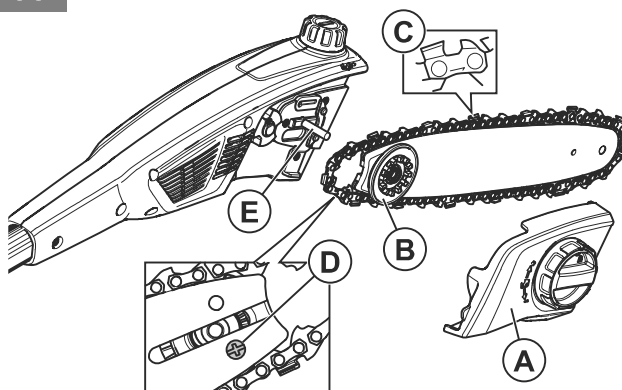

56



57

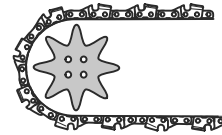

58

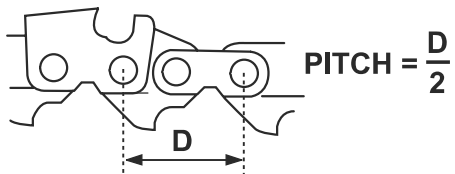

59

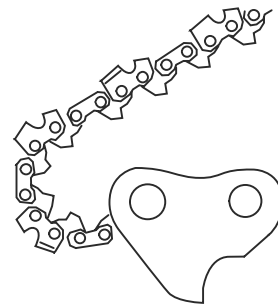

60

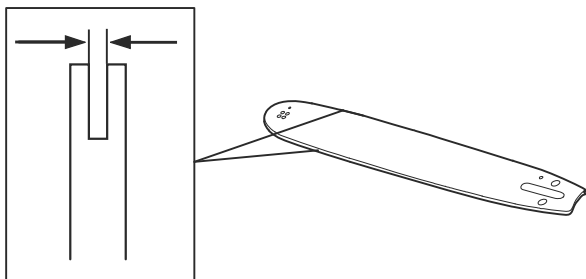

61

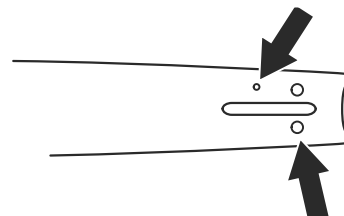

62

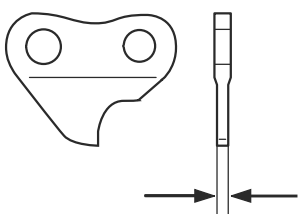

63

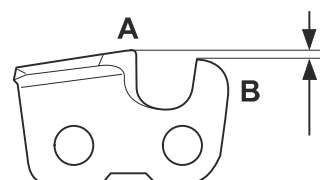

64

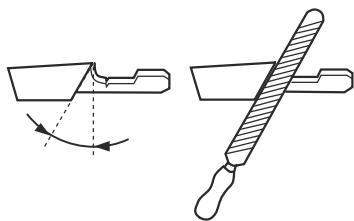

65

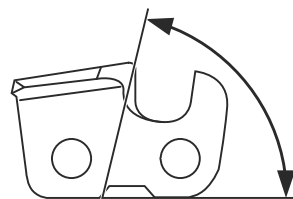

66

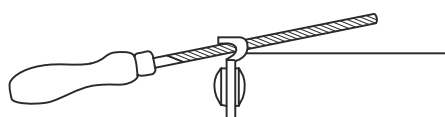

67

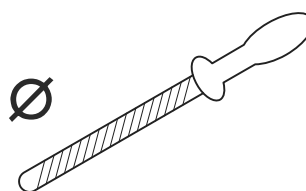

68

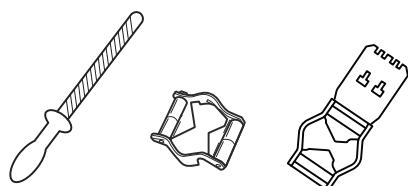

69

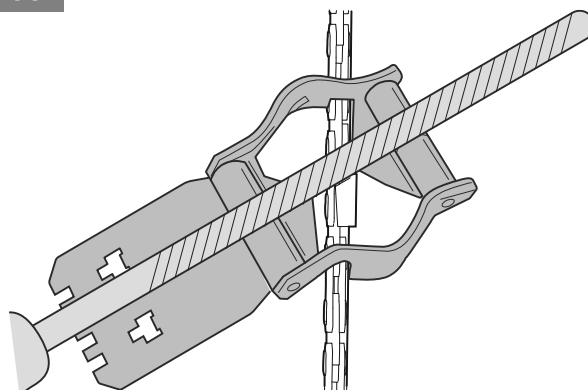

70

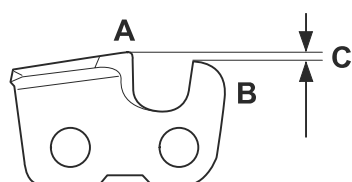

71

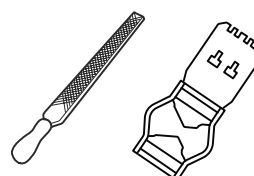

72

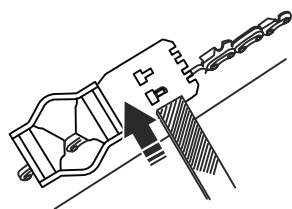

73

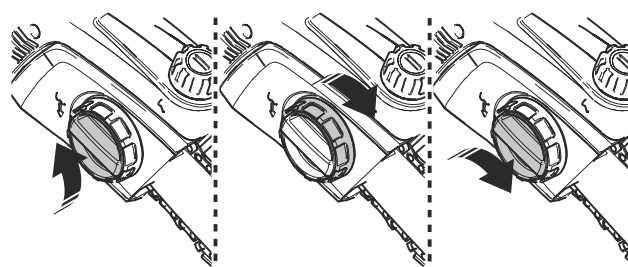

74

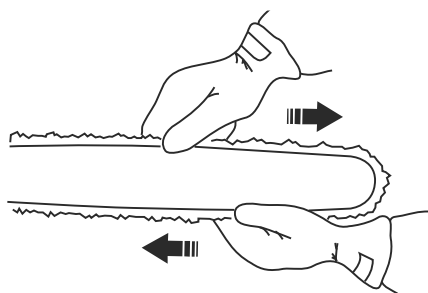

75

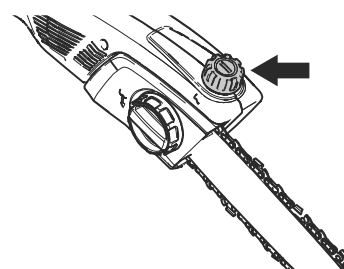

76

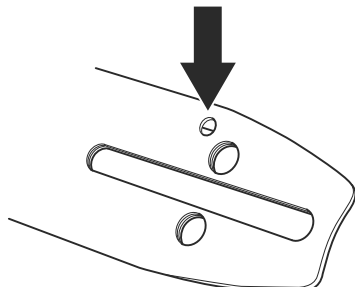

77

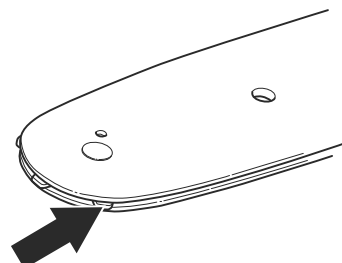

78

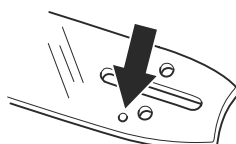

79

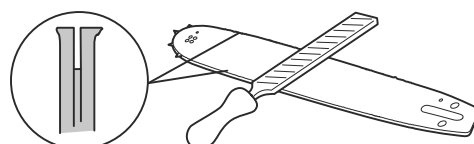

80

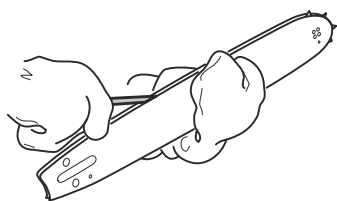

81

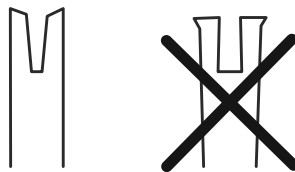

82

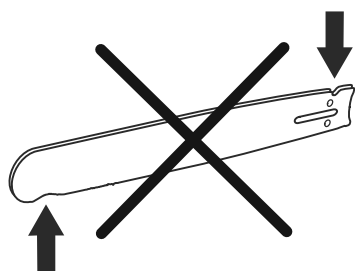

83

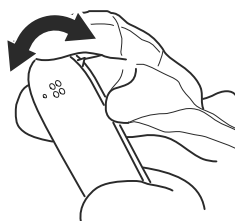

84

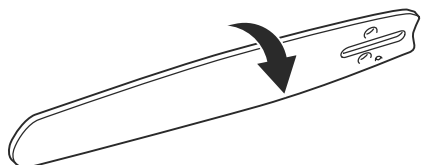

85

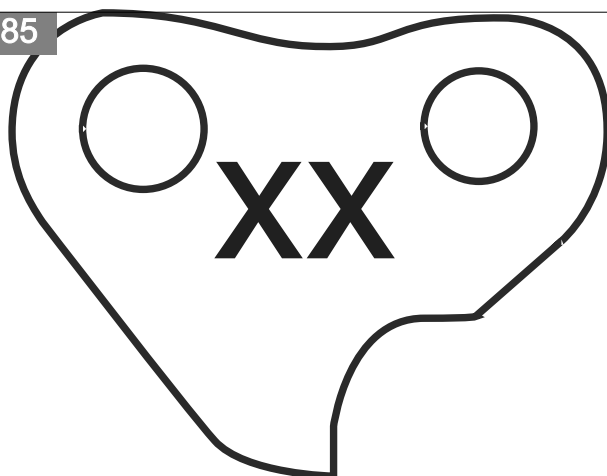

86

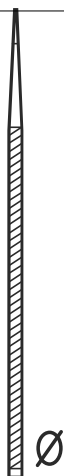

87

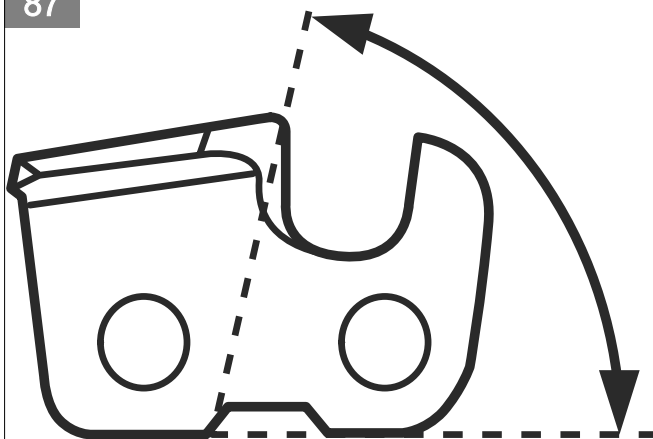

88

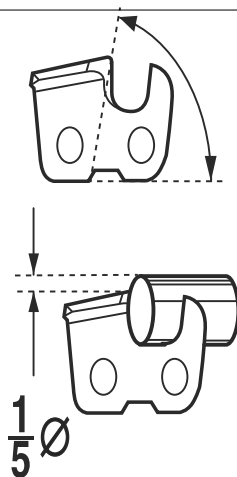

89

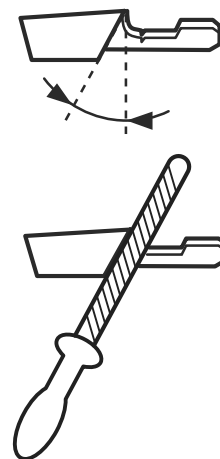

90

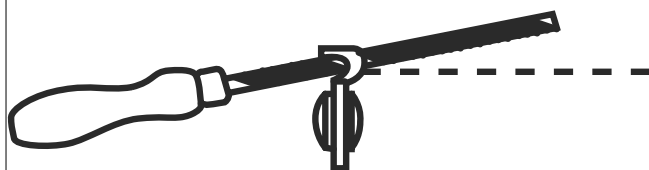

91

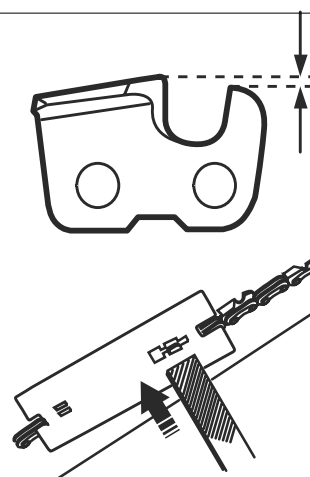

92

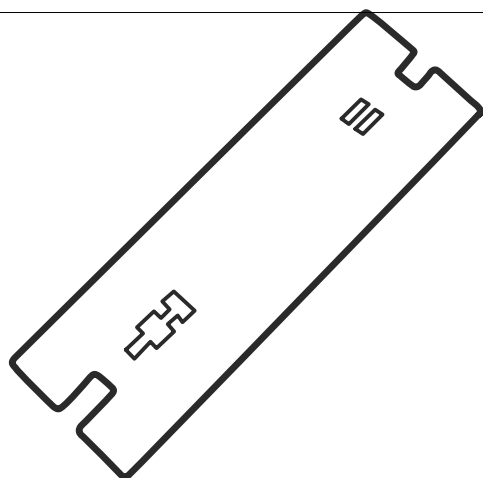

93

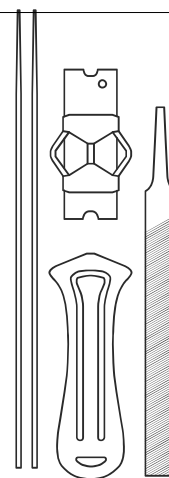

Contents

Introduction.....	12	Troubleshooting.....	26
Safety.....	13	Transportation and storage.....	27
Assembly.....	20	Technical data.....	27
Operation.....	20	Accessories.....	29
Maintenance.....	22	Declaration of Conformity.....	30

Introduction

Product description

Husqvarna 120iTK4-P is a battery telescopic pole saw.

Work is constantly in progress to increase your safety and efficiency during operation. Speak to your servicing dealer for more information.

Intended use

Use the product to cut branches and twigs. Do not use the product for other tasks.

Product overview

(Fig. 1)

1. Saw head
2. Chain tensioning knob
3. Chain oil tank
4. Guide bar
5. Shaft
6. Harness support hook
7. Keypad
8. Telescopic function
9. Power trigger lockout
10. Power trigger
11. Front handle
12. Rear handle
13. Battery charger QC80
14. Power Cord
15. Power on and warning indicator
16. Battery
17. Battery release buttons
18. Battery indicator button
19. Warning LED
20. Battery indicator LED
21. Start/Stop button
22. SavE button
23. Warning LED
24. Operator's manual
25. Harness
26. Transport guard
27. Connector
28. Battery charger 40-C80

the operator or others. It is extremely important that you read and understand the contents of the operator's manual. Please read the operator's manual carefully and make sure you understand the instructions before the product is used.

(Fig. 3) Use a protective helmet in locations where objects can fall on you. Use approved hearing protection. Use approved eye protection.

(Fig. 4) Use approved protective gloves.

(Fig. 5) Use safety footwear.

(Fig. 6) Rated voltage, V

(Fig. 7) Direct current.

(Fig. 8) Do not expose to rain.

(Fig. 9) Keep hands away from blade (only for pole hedge trimmer).

(Fig. 10) Telescopic function.

(Fig. 11) Turn left to loose the knob, turn right to tighten the knob.

(Fig. 12) Chain oil fill.

(Fig. 13) The product or package of the product is not domestic waste. Recycle it at a recycling station for electrical and electronic equipment.

Symbols on the product

(Fig. 2) **WARNING!** This product can be dangerous! Careless or incorrect use can result in serious or fatal injury to

(Fig. 14) The product complies with the applicable EC directives.

(Fig. 15) This product conforms to the applicable UK regulations.

(Fig. 19) Keep sufficient distance away from electrical power lines.

(Fig. 20) The rating plate shows serial number. **yyyy** is the production year, **ww** is the production week and **xxxxx** is the serial number.

Note: Other symbols/decals on the product refer to special certification requirements for certain markets.

Symbols on the battery and/or on the battery charger

(Fig. 21) Recycle this product at a recycling station for electrical and electronic equipment. (Applies to Europe only)

(Fig. 16) Fail-safe transformer.

(Fig. 17) Use and keep the battery charger indoors only.

(Fig. 18) Double insulation.

Product damage

We are not responsible for damages to our product if:

- the product is incorrectly repaired.
- the product is repaired with parts that are not from the manufacturer or not approved by the manufacturer.
- the product has an accessory that is not from the manufacturer or not approved by the manufacturer.
- the product is not repaired at an approved service center or by an approved authority.

Safety

Safety definitions

Warnings, cautions and notes are used to point out specially important parts of the manual.



WARNING: Used if there is a risk of injury or death for the operator or bystanders if the instructions in the manual are not obeyed.



CAUTION: Used if there is a risk of damage to the product, other materials or the adjacent area if the instructions in the manual are not obeyed.

Note: Used to give more information that is necessary in a given situation.

General safety instructions



WARNING: Read the warning instructions that follow before you use the product.

- Remove the battery to prevent the product from being started by accident.
- This product is a dangerous machine if you are not careful or if you use the product incorrectly. This product can cause serious injury or death to the operator or others.
- Do not use the product if it is changed from its initial specification. Do not change a part of the product without approval from the manufacturer. Only use parts that are approved by the manufacturer. Injury or death is a possible result of incorrect maintenance.
- Do a check of the product before use. See, *Safety devices on the product on page 17* and *Maintenance on page 22*. Do not use a product that is damaged or does not operate correctly. Do the safety checks, maintenance and service instructions described in this manual.
- Children should be supervised to ensure that they do not play with the product. Never allow children or other persons not trained in the use of the product and/or the battery to use or service it. Local laws may regulate the age of the user.
- Keep the product in a locked area to prevent access for children or persons that are not approved.
- Store the product out of reach of children.

- Under no circumstances may the design of the product be modified without the permission of the manufacturer. Always use original accessories. Non-authorized modifications and/or accessories can result in serious personal injury or the death of the operator and others.

Note: National or Local laws can regulate the use. Comply to given regulations.

General machine safety warnings



WARNING: Read all safety warnings, instructions, illustrations and specifications provided with this power tool. Failure to follow all instructions listed below may result in electric shock, fire and/or serious injury.

Note: The term "machine" in the warnings refers to your mains-operated (corded) machine or battery-operated (cordless) machine.

Work area safety

- Keep work area clean and well lit.** Cluttered or dark areas invite accidents.
- Do not operate machine in explosive atmospheres, such as in the presence of flammable liquids, gases or dust.** Machines create sparks which may ignite the dust or fumes.
- Keep children and bystanders away while operating a machine.** Distractions can cause you to lose control.

Electrical safety

- Machine plugs must match the outlet. Never modify the plug in any way. Do not use any adapter plugs with earthed (grounded) machines.** Unmodified plugs and matching outlets will reduce risk of electric shock.
- Avoid body contact with earthed or grounded surfaces, such as pipes, radiators, ranges and refrigerators.** There is an increased risk of electric shock if your body is earthed or grounded.
- Do not expose machines to rain or wet conditions.** Water entering a machine will increase the risk of electric shock.
- Do not abuse the cord. Never use the cord for carrying, pulling or unplugging the machine. Keep cord away from heat, oil, sharp edges or moving parts.** Damaged or entangled cords increase the risk of electric shock.
- When operating a machine outdoors, use an extension cord suitable for outdoor use.** Use of a cord suitable for outdoor use reduces the risk of electric shock.
- If operating a machine in a damp location is unavoidable, use a residual current device (RCD)**

protected supply. Use of a RCD reduces the risk of electric shock.

Personal safety

- Stay alert, watch what you are doing and use common sense when operating a machine. Do not use a machine while you are tired or under the influence of drugs, alcohol or medication.** A moment of inattention while operating machines may result in serious personal injury.
- Use personal protective equipment. Always wear eye protection.** Protective equipment such as dust mask, non-skid safety shoes, hard hat or hearing protection used for appropriate conditions will reduce personal injuries.
- Prevent unintentional starting. Ensure the switch is in the OFF-position before connecting to a power source and/or battery pack, picking up or carrying the machine.** Carrying machines with your finger on the switch or energising machines that have the switch on invites accidents.
- Remove any adjusting key or wrench before turning the machine on.** A wrench or a key left attached to a rotating part of the machine may result in personal injury.
- Do not overreach. Keep proper footing and balance at all times.** This enables better control of the machine in unexpected situations.
- Dress properly. Do not wear loose clothing or jewellery. Keep your hair and clothing away from moving parts.** Loose clothes, jewellery or long hair can be caught in moving parts.
- If devices are provided for the connection of dust extraction and collection facilities, ensure these are connected and properly used.** Use of dust collection can reduce dust-related hazards.
- Do not let familiarity gained from frequent use of machines allow you to become complacent and ignore machine safety principles.** A careless action can cause severe injury within a fraction of a second.
- The vibration emission during actual use of the machine can differ from the declared total value depending on the ways in which the machine is used. Operators should identify safety measures to protect themselves that are based on an estimation of exposure in the actual conditions of use (taking account of all parts of the operating cycle such as the times when the machine is switched off and when it is running idle in addition to the trigger).

Machine use and care

- Do not force the machine. Use the correct machine for your application.** The correct machine will do the job better and safer at the rate for which it was designed.
- Do not use the machine if the switch does not turn it on and off.** Any machine that cannot be controlled with the switch is dangerous and must be repaired.
- Disconnect the plug from the power source and/or remove the battery pack, if detachable, from the**

machine before making any adjustments, changing accessories, or storing machines. Such preventive safety measures reduce the risk of starting the machine accidentally.

- **Store idle machines out of the reach of children and do not allow persons unfamiliar with the machines or these instructions to operate the machines.** Machines are dangerous in the hands of untrained users.
- **Maintain machines and accessories. Check for misalignment or binding of moving parts, breakage of parts and any other condition that may affect the machines' operation. If damaged, have the machine repaired before use.** Many accidents are caused by poorly maintained machines.
- **Keep cutting tools sharp and clean.** Properly maintained cutting machines with sharp cutting edges are less likely to bind and are easier to control.
- **Use the machine, accessories and bits etc. in accordance with these instructions, taking into account the working conditions and the work to be performed.** Use of the machine for operations different from those intended could result in a hazardous situation.
- **Keep handles and grasping surfaces dry, clean and free from oil and grease.** Slippery handles and grasping surfaces do not allow for safe handling and control of the machine in unexpected situations.

Battery machine use and care

- **Recharge only with the charger specified by the manufacturer.** A charger that is suitable for one type of battery pack may create a risk of fire when used with another battery pack.
- **Use machines only with specifically designated battery packs.** Use of any other battery packs may create a risk of injury and fire.
- **When battery pack is not in use, keep it away from other metal objects, like paper clips, coins, keys, nails, screws or other small metal objects, that can make a connection from one terminal to another.** Shorting the battery terminals together may cause burns or a fire.
- **Under abusive conditions, liquid may be ejected from the battery; avoid contact. If contact accidentally occurs, flush with water. If liquid contacts eyes, additionally seek medical help.** Liquid ejected from the battery may cause irritations or burns.
- **Do not use a battery pack or machine that is damaged or modified.** Damaged or modified batteries may exhibit unpredictable behaviour resulting in fire, explosion or risk of injury.
- **Do not expose a battery pack or machine to fire or excessive temperature.** Exposure to fire or temperature above 130 °C / 265 °F may cause explosion.
- **Follow all charging instructions and do not charge the battery pack or machine outside the temperature range specified in the instructions.** Charging

improperly or at temperatures outside the specified range may damage the battery and increase the risk of fire.

Service

- **Have your machine serviced by a qualified repair person using only identical replacement parts.** This will ensure that the safety of the machine is maintained.
- **Never service damaged battery packs.** Service of battery packs should only be performed by the manufacturer or authorized service providers.

Pole-mounted pruner safety warnings:

- **Keep all parts of the body away from the saw chain or saw blade when the pole-mounted pruner is operating. Before you start the pole mounted pruner, make sure the saw chain or saw blade is not contacting anything.** A moment of inattention while operating the pole-mounted pruner may result in injury to yourself or others.
- **Always use two hands when operating the pole mounted pruner.** Hold the pole-mounted pruner with both hands to avoid loss of control.
- **To reduce the risk of electrocution, never use the pole mounted pruner near any electrical power lines.** Contact with or use near power lines may cause serious injury or electric shock resulting in death.
- **Hold the pole-mounted pruner by insulated gripping surfaces only, because the saw chain or saw blade may contact hidden wiring.** Saw chains or saw blades contacting a "live" wire may make exposed metal parts of the machine "live" and could give the operator an electric shock.
- **Wear eye and ear protection. Further protective equipment for hands and slip-resistant footwear is recommended.** Adequate protective equipment will reduce the risk of personal injury.
- **Always use head protection when operating the pole mounted pruner overhead.** Falling debris can result in serious personal injury.
- **Always keep proper footing and operate the pole-mounted pruner only when standing on the ground.** Slippery or unstable surfaces may cause a loss of balance or control of the machine.
- **Do not operate a pole-mounted pruner in a tree, on a ladder, or any unstable support.** Operation of a pole-mounted pruner in this manner may result in loss of balance, loss of control and personal injury.
- **Keep all power cords and cables away from cutting area.** Power cords or cables may be hidden in trees and can be accidentally cut by the saw chain or saw blade.
- **Do not use the pole-mounted pruner in bad weather conditions, especially when there is a risk of lightning.** This decreases the risk of being struck by lightning.
- **When cutting a limb that is under tension, be alert for spring back.** When the tension in the wood fibres

is released, the spring-loaded limb may strike the operator and/or throw the pole-mounted pruner out of control.

- **Use extreme caution when cutting brush and saplings.** The slender material may catch the saw chain or saw blade and be whipped toward you or pull you off balance.
- **When carrying the pole-mounted pruner with the machine switched off, take care not to operate any power switch and keep the saw chain or saw blade away from your body.** Proper carrying of the pole-mounted pruner will reduce the likelihood of accidental contact with the saw chain or saw blade.
- **When transporting or storing the pole-mounted pruner, always fit the guide bar or saw blade cover.** Proper handling of the pole-mounted pruner will reduce the likelihood of accidental contact with the moving saw chain or saw blade.
- **When clearing jammed material, storing or servicing the pole-mounted pruner, make sure the switch is off and all battery packs are removed.** Unexpected actuation of the machine while clearing jammed material or servicing may result in serious personal injury.
- **Cut wood only. Do not use pole-mounted pruner for purposes not intended. For example: do not use the pole-mounted pruner for cutting plastic, metal, masonry or non-wood building materials.** Use of the pole-mounted pruner for operations different than intended could result in a hazardous situation.

Causes and operator prevention of kickback

Kickback may occur when the nose or tip of the guide bar touches an object, or when the wood closes in and pinches the pole pruner in the cut. Tip contact in some cases may cause a sudden reverse reaction, kicking the guide bar up and back towards the operator. Pinching the pole pruner along the top of the guide bar may push the guide bar rapidly back towards the operator. Either of these reactions may cause you to lose control of the pole pruner which could result in serious personal injury. Do not rely exclusively upon the safety devices built into your pole pruner. As a pole pruner user, you should take several steps to keep your cutting jobs free from accident or injury. Kickback is the result of pole pruner misuse and/or incorrect operating procedures or conditions and can be avoided by taking proper precautions as given below:

- **Maintain a firm grip, with thumbs and fingers encircling the pole pruner handles, with both hands on the pole pruner and position your body and arm to allow you to resist kickback forces.** Kickback forces can be controlled by the operator, if proper precautions are taken. Do not let go of the pole pruner.
- **Do not overreach and do not cut above shoulder height.** This helps prevent unintended tip contact and enables better control of the pole pruner in unexpected situations.

- **Only use replacement guide bars and pole pruners specified by the manufacturer.** Incorrect replacement guide bars and pole pruners may cause chain breakage and/or kickback.
- **Follow the manufacturer's sharpening and maintenance instructions for the pole pruner.** Decreasing the depth gauge height can lead to increased kickback.

General pole pruner safety warnings

Follow all instructions when clearing jammed material, storing or servicing the pole pruner. Make sure the switch is off and the battery pack is removed.

Unexpected actuation of the pole pruner while clearing jammed material or servicing may result in serious personal injury.

Personal protective equipment



WARNING: Read the warning instructions that follow before you use the product.

- Always use approved personal protective equipment when you use the product. Personal protective equipment cannot fully prevent injury but it decreases the degree of injury if an accident does occur. Let your dealer help you select the right equipment.
- Use a helmet if it is possible that objects can fall on you.

(Fig. 22)

- Use approved hearing protection.

(Fig. 23)

- Use approved eye protection. If you use a visor, you must also use approved protective goggles. Approved protective goggles must agree with the ANSI Z87.1 standard in the USA or EN 166 in EU countries.

(Fig. 24)

- Use gloves when it is necessary, for example when you attach, examine or clean the cutting equipment.

(Fig. 25)

- Use protective boots, or shoes, with non-slip soles.

(Fig. 26)

- Use pants with saw protection.
- Use clothing made of a strong fabric. Always use heavy, long pants and long sleeves. Do not use loose clothing that can catch on twigs and branches. Do not wear jewelry, short pants, open shoes or go with bare feet. Put your hair up safely above your shoulders.
- Keep first aid equipment close at hand.

(Fig. 27)

Safety devices on the product



WARNING: Read the warning instructions that follow before you use the product.

In this section the product's safety features, its purpose and how checks and maintenance should be carried out to ensure that it operates correctly. See instructions under the heading *Product overview on page 12* to find where these parts are located on your product.

The life span of the product can be reduced and the risk of accidents can increase if product maintenance is not carried out correctly and if service and/or repairs are not carried out professionally. If you need further information please contact your nearest servicing dealer.



WARNING: Never use a product with damaged safety components. The product's safety equipment must be inspected and maintained as described in this section. If your product fails any of these checks, contact your service agent to get it repaired.



CAUTION: All servicing and repair work on the machine requires special training. This is especially true of the machine's safety equipment. If your machine fails any of the checks described below you must contact your service agent. When you buy any of our products we guarantee the availability of professional repairs and service. If the retailer who sells your machine is not a servicing dealer, ask him for the address of your nearest service agent.

To do a check of the keypad

1. Push and hold the start/stop button (A). (Fig. 28)
 - a) The product is on when the LED is on.
 - b) The product is off when the LED is off.
2. Refer to *To start the SavE function on page 21* for the function of the SavE button (B).
3. Refer to *Troubleshooting on page 26* if the warning indicator (C) is on or flashes.

To do a check of the power trigger lockout

The power trigger lockout prevents accidental operation. When you release the handle, the power trigger and the power trigger lockout move back to their initial position.

(Fig. 29)

1. Make sure that the power trigger is locked when the lockout is in its initial position. (Fig. 30)
2. Pull and release the lockout and make sure that it moves back to its initial position. (Fig. 31)

3. Make sure that the power trigger and the lockout move freely and that the return spring operates correctly. (Fig. 32)
4. Start the product, see *To start the product on page 21*.
5. Apply full speed.
6. Release the power trigger and make sure that the cutting attachment stops fully.

Safety instructions for the cutting equipment



WARNING: Read the warning instructions that follow before you use the product.

- Only use approved guide bar/saw chain combinations and filing equipment. Refer to *Maintenance on page 22* for instructions.
- Use protective gloves when you use or do maintenance on the saw chain. A saw chain that does not move can also cause injuries.
- Keep the cutting teeth correctly sharpened. Obey the instructions and use the recommended file gauge. A saw chain that is damaged or incorrectly sharpened increases the risk of accidents.

(Fig. 33)

- Keep the correct depth gauge setting. Obey the instructions and use the recommended depth gauge setting. Too large depth gauge setting increases the risk of kickback.

(Fig. 34)

- Make sure that the saw chain has the correct tension. If the saw chain is not tight against the guide bar, the saw chain can derail. An incorrect saw chain tension increases wear on the guide bar, saw chain and chain drive sprocket. Refer to *Accessories on page 29*.

(Fig. 35)

- Do maintenance on the cutting equipment regularly and keep it correctly lubricated. If the saw chain is not correctly lubricated, the risk of wear on the guide bar, saw chain and chain drive sprocket increases.

(Fig. 36)

Safety instructions for operation



WARNING: Read and obey the warning instructions that follow before you use the product.

- Ensure that no people or animals come closer than 15 m (50 ft.) while you work. When several operators are working in the same area the safety distance should be at least 15 m. Otherwise there is a risk of serious personal injury. Stop the product immediately if anyone approaches. Never swing the

product around without first checking behind you to make sure that no one is within the safety zone.

- Never use the product in bad weather, for instance in dense fog, in heavy rain, strong winds, intense cold, etc. Extremely hot weather may cause overheating of the product. Working in bad weather is tiring and often brings added risks, such as icy ground, unpredictable felling direction, etc.
- Do not allow children to use or be in the vicinity of the product. Since the product is easy to start, children may be able to start it if they are not kept under full surveillance. This can mean a risk of serious personal injury. Disconnect the battery when the product is not under close supervision.
- Ensure that people, animals or other things can not affect your control of the product or that they do not come in contact with the cutting attachment or loose objects that are thrown out by the cutting attachment.
- Listen out for warning signals or shouts when you wear hearing protection. Always remove your hearing protection as soon as the product stops.
- Overexposure to vibration can lead to circulatory damage or nerve damage in persons who have poor circulation. Speak to your physician if you experience symptoms of overexposure to vibration. Such symptoms include numbness, loss of feeling, tingling, pricking, pain, loss of strength, changes in skin colour or condition. These symptoms usually show in the fingers, hands or wrists.
- Never use a cutting attachment without an approved guard. If an incorrect or faulty guard is fitted this can cause serious personal injury.
- Always stop the product, remove the battery and make sure that the cutting equipment stops completely before you start to do any work on the product. Departure from the sharpening instructions considerably increase the risk of kickback.
- If you encounter a situation where you are uncertain how to proceed you should ask an expert. Contact your dealer or your service workshop. Avoid all usage which you consider to be beyond your capability.
- Avoid all usage which you consider to be beyond your capability.
- Never use the product if you are fatigued, while under the influence of alcohol or drugs, medication or anything that could affect your vision, alertness, coordination or judgment.
- The product can be thrown violently to the side when the tip of the guide bar comes in contact with a fixed object. This is called kickback. A kickback can be violent enough to cause the product/operator to be propelled in any direction, and possibly lose control of the product. Avoid cutting with the guide bar tip.
- Do not use the product unless you are able to call for help in case of an accident.
- Keep a good balance and a firm foothold. Make sure that you can move and stand safely. Check the area around you for possible obstacles (roots, rocks,

branches, ditches, etcetera) in case you have to move suddenly. Take great care when you work on sloping ground.

- Always inspect the working area. Remove all loose objects such as stones, broken glass, nails, steel wire, string, etcetera, that could be thrown out or become wrapped around the cutting attachment.
- Take great care when cutting a tree that is in tension. A tree that is in tension may spring back to its normal position before or after being cut. If you position yourself incorrectly or make the cut in the wrong place the tree may hit you or the product and cause you to lose control. Both situations can cause serious personal injury.
- Keep a good balance and a firm foothold.
- Use the harness to support the weight of the product and make it easier to handle.
- Always hold the product with both hands. Hold the product on the right side of your body. (Fig. 37)
- Stop the product before you move to another area. Attach the transport guard before carrying or transporting the product any distance.
- Never put the product down when it is activated unless you have it in clear sight.
- If the product is operated at temperatures below -10°C the product and the battery must be stored in a heated space for at least 24 hours before starting work.
- Never stand directly under underneath a branch that is being cut. This could lead to serious or even fatal personal injury.
- Observe the applicable safety regulations for work in the vicinity of overhead power lines.
- This product is not electrically insulated. If the product touches or comes close to high-voltage power lines it could lead to death or serious bodily injury. Electricity can jump from one point to another by arcing. The higher the voltage, the greater the distance electricity can jump. Electricity can also travel through branches and other objects, especially if they are wet. Always keep a distance of at least 10 m between the product and high voltage power lines and/or objects that are touching them. If you have to work within this safe distance you should always contact the relevant power company to make sure the power is switched off before you start work.
- A faulty cutting attachment may increase the risk of accidents.

Battery safety



WARNING: Read the warning instructions that follow before you use the product.

- Only use the BLi series and 40-B series battery. For details, refer to *Technical data on page 27*. The batteries are software encrypted.

- Use the BLi series and 40-B series battery that is rechargeable as a power supply for the related Husqvarna products only. To prevent injury, do not use the battery as a power supply for other devices.
- Risk of electrical shock. Do not connect the battery terminals to keys, screws or other metal. This can cause a short circuit of the battery.
- Do not use batteries that are non-rechargeable.
- Do not put objects into the air slots of the battery.
- Keep the battery away from sunlight, heat or open flame. The battery can cause burns and/or chemical burns.
- Keep the battery away from rain and wet conditions.
- Keep the battery away from microwaves and high pressure.
- Do not try to disassemble or break the battery.
- Do not let battery acid touch your skin. Battery acid causes injuries to the skin, corrosion and burns. If you get battery acid in your eyes, do not rub but flush with water for minimum 15 minutes. If battery acid has touched your skin, you must clean the skin with a large quantity of water and soap. Get medical aid.
- Use the battery in temperatures between -10 °C (14 °F) and 40 °C (104 °F).
- Do not clean the battery or the battery charger with water. See *To clean the product, the battery and the battery charger on page 25*.
- Do not use a damaged battery.
- Keep batteries in storage away from metal objects such as nails, screws or jewelry.
- Keep the battery away from children.

Battery charger safety



WARNING: Read the warning instructions that follow before you use the product.

- Risk of electrical shock or short circuit if the safety instructions are not obeyed.
- Do not use other battery chargers than the one supplied for your product. The recommended charger is QC80 / 40-C80 when you charge the BLi series and 40-B series battery.
- Do not try to disassemble the battery charger.
- Do not use a damaged battery charger.
- Do not lift the battery charger by the power cord. To disconnect the battery charger from a mains socket, pull out the plug. Do not pull the power cord.
- Keep all cables and extension leads away from water, oil and sharp edges. Make sure that the cable

is not caught between objects, for example, doors, fences or equivalent.

- Do not use the battery charger near flammable materials or materials that can cause corrosion. Make sure that the battery charger is not covered. Pull out the plug to the battery charger if there is smoke or fire.
- Only charge the battery indoors in a location with good airflow and away from sunlight. Do not charge the battery outdoors. Do not charge the battery in wet conditions.
- Only use the battery charger where the temperature is between 5 °C (41 °F) and 40 °C (104 °F). Use the charger in an environment which has a good airflow, dry and free from dust.
- Do not put objects into the cooling slots of the battery charger.
- Do not connect the battery charger terminals to metal objects as this can short circuit the battery charger.
- Use approved mains sockets that are not damaged. Make sure that the cord of the battery charger is not damaged. If extension cables are used, make sure that the extension cables are not damaged.

Safety instructions for maintenance



WARNING: Read the warning instructions that follow before you do maintenance on the product.

- Remove the battery before you do maintenance, other checks or assemble the product.
- The operator must only do the maintenance and servicing shown in this operator's manual. Turn to your servicing dealer for maintenance and servicing of a larger extension.
- Do not clean the battery or the battery charger with water. Strong detergent can cause damage to the plastic.
- If you do not do maintenance, it decreases the life cycle of the product and increases the risk of accidents.
- Special training is necessary for all servicing and repair work, especially for the safety devices on the product. If not all checks in this operator's manual are approved after you have done maintenance, turn to your servicing dealer. We guarantee that there are professional repairs and servicing available for your product.
- Only use original spare parts.

Assembly

Introduction



WARNING: Read and understand the safety chapter before you assemble the product.

To assemble the shaft

1. Make sure that the electrical plugs are aligned. (Fig. 38)
2. Connect the ends of the shaft (A) fully.
3. Tighten the screw handle on the saw head side of the shaft (B).

To adjust the length of the shaft

1. Loosen the screw handle at the battery housing side of the shaft (A). (Fig. 39)
2. Adjust the shaft to an applicable length.
3. Tighten the screw handle (B).

To adjust the harness

Always use the harness when you operate the product. The harness gives maximum control during operation of

the product. The harness decreases the risk of tiredness in your arms and back.

1. Put on the harness.
2. Attach the product to the harness support hook.
3. Adjust the length of the harness until the support hook is roughly level with your right hip. (Fig. 37)

To install the battery charger 40-C80 on the wall



CAUTION: Do not use an electric screwdriver to install the battery charger to the wall. An electric screwdriver can cause damage to the battery charger.

1. Install the battery charger on the wall with the 2 screws (A). Use wall plugs (B) if it is necessary. (Fig. 40)
2. Install the 2 screw hole plugs (C).
3. Connect the power cord (D) to the battery charger and a mains socket.

Operation

To do a function check before you use the product

1. Examine the air intake for dirt and damage. Remove grass and leaves from the product with a brush.
2. Make sure that the product operates correctly.
3. Tighten all nuts and screws.
4. Make sure that the saw head is attached correctly.
5. Examine the saw head for damages, for example, cracks. Replace the saw head if it is damaged.
6. Make sure that the covers are not damaged and that the covers are attached correctly.

Battery



WARNING: Read and understand the safety chapter before you use the battery.

Read and understand the operator's manual for the battery and the battery charger.

Keep the battery and the battery charger in the correct ambient temperatures.

	Ambient temperature
Operation of the product	-5 °C-40 °C / 23 °F-104 °F
Charging of the battery	5 °C-40 °C / 41 °F-104 °F

Battery status

The display shows the state of charge and if there are problems with the battery.

(Fig. 41)

LED indicator	Battery status (state of charge)	
	BLi10	40-B70
4 LED lights are on	N/A	The battery is 76% - 100% charged.

LED indicator	Battery status (state of charge)	
	BLi10	40-B70
3 LED lights are on	The battery is 76% - 100% charged.	The battery is 51% - 75% charged.
2 LED lights are on	The battery is 51% - 75% charged.	The battery is 26% - 50% charged.
1 LED light is on	The battery is 26% - 50% charged.	The battery is 6% - 25% charged.
1 LED light flashes	The battery is 0% - 25% charged.	The battery is 0% - 5% charged.

To charge the battery

Charge the battery if it is the first time that you use it. A new battery is only 30% charged.



CAUTION: Connect the battery charger to a power outlet with the voltage and frequency that is specified on the rating plate.

The battery does not charge if the battery temperature is more than 50 °C/122 °F.

1. Connect the power cord to the battery charger.
2. Connect the battery charger to a grounded power outlet. The charging LED flashes one time. (Fig. 42)
3. Connect the battery to the battery charger. The charging LED comes on. Charge the battery for maximum 24 hours. (Fig. 43)
4. Push the battery indicator button, if all the LED indicators come on, the battery is fully charged.
5. Pull the power plug to disconnect the battery charger from the power outlet. Do not pull the power cord.
6. Remove the battery from the battery charger.

To connect the battery to the product



WARNING: Only use Husqvarna original batteries in the product.

1. Make sure that the battery is fully charged.
2. Put the battery into the battery holder of the product. The battery must move into the holder easily, if not, it is not installed correctly. (Fig. 44)
3. Push the lower part of the battery and push it in fully into the battery holder. The battery locks into position when you hear a click.
4. Make sure that the latches lock in position correctly.

To start the product

1. Push and hold the start/stop button until the green LED comes on. (Fig. 45)
2. Pull the power trigger lockout rearward and hold the power trigger.

To cut branches



WARNING: Observe great care when working close to overhead power lines. Falling branches can result in short circuiting.

- Whenever possible, position yourself so that you can make the cut at right angles to the branch. (Fig. 46)
- Cut large branches in sections so that you have better control over where they fall. You should also pay attention to the fact that falling branches can bounce in the direction of the user after hitting ground. (Fig. 47)
- Never cut through the swelling at the root of the branch as this will slow down healing and increase the risk of fungal attack. (Fig. 48)
- Use the stop at the base of the cutting head to provide support during cutting. This will help prevent the cutting attachment from bouncing on the branch. (Fig. 49)
- Make an initial cut on the underside of the branch before cutting through the branch. This will prevent tearing of the bark, which could lead to slow healing and cause permanent damage to the tree. The cut should not be deeper than 1/3 of the branch thickness to prevent jamming. Keep the chain running while you withdraw the cutting attachment from the branch to prevent it jamming. (Fig. 50)
- Make sure you have a firm footing and that you can work without being hampered by branches, stones and trees.



WARNING: Never activate the power trigger without having the cutting attachment in full view.

To start the SavE function

The product has a SavE function. The SavE function gives the longest operation time from the battery.

1. Push the SavE button. The LED comes on to show that the function is on. (Fig. 51)
2. Push the SavE button again to stop the SavE function.

To stop the product

- 1. Release the power trigger.
- 2. Push the stop button and then the green LED light goes off.

- 3. Remove the battery from the product. Push the 2 release buttons and pull out the battery. (Fig. 52)

Maintenance

Introduction



WARNING: Read and understand the safety chapter before you do maintenance work on the product.



WARNING: Remove the battery before you do maintenance on the product.

Maintenance schedule



WARNING: Remove the battery before you do maintenance.

The following is a list of the maintenance steps that you must do on the product. Refer to the tasks in the maintenance chapter for more information.

Maintenance	Daily	Weekly	Monthly
Clean the external parts of the product with a dry cloth. Do not use water.	X		
Make sure that the start and stop button works correctly and are not damaged.	X		
Make sure that the power trigger and the power trigger lockout function correctly from a safety point of view.	X		
Make sure that all controls work and are not damaged.	X		
Keep the handles dry and clean. Makes sure that that there is no oil and grease on the handles.	X		
Make sure that the saw chain cover is not damaged. Replace the saw chain cover if it is damaged.	X		
Make sure that the screws and nuts are tight.	X		
Clean the oil tank cap	X		
Make sure that the battery release buttons on the battery works and locks the battery in the product.	X		
Examine that the battery charger is not damaged and function correctly.	X		
Make sure that the battery is not damaged.	X		
Make sure that the battery is charged.	X		
Make sure that the battery charger is not damaged.	X		
Examine all cables, couplings and connections. Make sure that there is no damage or dirt.		X	

Maintenance	Daily	Weekly	Monthly
Clean the saw chain cover.		X	
Do a check of the connections between the battery and the product. Do a check of the connection between the battery and the battery charger.			X
Make sure that the saw head is not damaged. Replace the saw head if it is damaged.	An approved Husqvarna dealer must do all servicing on the saw head.		
Examine the wear of the chain drive sprocket.	Replace the chain drive sprocket after approximately 100 hours of operation or more frequently if it is necessary.		

To examine the cutting equipment

1. Make sure that there are no cracks in rivets and links and that no rivets are loose. Replace if it is necessary. (Fig. 53)
2. Make sure that the saw chain is easy to bend. Replace the saw chain if it is rigid.
3. Compare the saw chain with a new saw chain to examine if the rivets and links are worn.
4. Replace the saw chain when the longest part of the cutting tooth is less than 4 mm/0.16 in. Also replace the saw chain if there are cracks on the cutters. (Fig. 54)

To replace the guide bar

1. Turn the locking knob counterclockwise and remove the protective cover (A). (Fig. 55)
2. Remove the guide bar with the saw chain attached.
3. Remove the saw chain from the guide bar.
4. Remove the bolt (D) and remove the gear. Keep the gear near.
5. Install the gear with the bolt (D) into the new guide bar.
6. Put the saw chain in the groove of the guide bar.
7. Install the guide bar and gear (B) onto the guide bar pin (E).
8. Install the saw chain around the drive sprocket. Make sure that the cutting teeth point in the direction away from the drive sprocket (C).
9. Install the protective cover (A) and turn the locking knob clockwise.
10. Tighten the saw chain. Refer to *To adjust the tension of the saw chain on page 24* for instructions.

To replace the saw chain

1. Turn the locking knob counterclockwise and remove the protective cover (A). (Fig. 55)
2. Remove the guide bar with the saw chain attached.
3. Remove the saw chain from the guide bar.
4. Put a new saw chain in the groove of the guide bar.

5. Install the guide bar and gear (B) onto the guide bar pin (E).
6. Install the saw chain around the drive sprocket. Make sure that the cutting teeth point in the direction away from the drive sprocket (C).
7. Install the protective cover (A) and turn the locking knob clockwise.
8. Tighten the saw chain. Refer to *To adjust the tension of the saw chain on page 24* for instructions.

To sharpen the saw chain

Information about the guide bar and saw chain



WARNING: Use protective gloves when you use or do maintenance on the saw chain. A saw chain that does not move can also cause injuries.

Replace a worn or damaged guide bar or saw chain with the guide bar and saw chain combination recommended by Husqvarna. This is necessary to keep the safety functions of the product. Refer to *Accessories on page 29*, for a list of replacement bar and chain combinations that we recommend.

- Guide bar length, in/cm. Information about the guide bar length can usually be found on the rear end of the guide bar.

(Fig. 56)

- Number of teeth on bar tip sprocket (T).

(Fig. 57)

- Chain pitch, in. The distance between the drive links of the saw chain must align with the distance of the teeth on the bar tip sprocket and drive sprocket.

(Fig. 58)

- Number of drive links. The number of drive links is decided by the type of guide bar.

(Fig. 59)

- Bar groove width, in/mm. The groove width in guide bar must be the same as the chain drive links width.

(Fig. 60)

- Chain oil hole and hole for chain tensioner. The guide bar must align with product.

(Fig. 61)

- Drive link width, mm/in.

(Fig. 62)

General information about how to sharpen the cutters

Do not use a blunt saw chain. If the saw chain is blunt, you must apply more pressure to push the guide bar through the wood. If the saw chain is very blunt, there will be no wood chips but sawdust.

A sharp saw chain eats through the wood and the wood chips becomes long and thick.

The cutting tooth (A) and the depth gauge (B) together makes the cutting part of the saw chain, the cutter. The difference in height between the two gives the cutting depth (depth gauge setting).

(Fig. 63)

When you sharpen the cutter, think about the following:

- Filing angle.

(Fig. 64)

- Cutting angle.

(Fig. 65)

- File position.

(Fig. 66)

- Round file diameter.

(Fig. 67)

It is not easy to sharpen a saw chain correctly without the correct equipment. Use a Husqvarna recommended file gauge. This will help you to keep maximum cutting performance and the kickback risk at a minimum.



WARNING: The force of the kickback increases a lot if you do not follow the sharpening instructions.

Note: Refer to *To sharpen the cutters on page 24* for information about sharpening of the saw chain.

To sharpen the cutters

1. Use a round file and a file gauge to sharpen the cutting teeth. (Fig. 68)

Note: Refer to *Accessories on page 29* for information about which file and gauge that Husqvarna recommends for your saw chain.

2. Apply the file gauge correctly on to the cutter. Refer to the instruction supplied with the file gauge.

3. Move the file from the inner side of the cutting teeth and out. Decrease the pressure on the pull stroke. (Fig. 69)
4. Remove material from one side of all the cutting teeth.
5. Turn the product around and remove material on the other side.
6. Make sure that all cutting teeth are the same length.

General information about how to adjust the depth gauge setting

The depth gauge setting (C) decreases when you sharpen the cutting tooth (A). To keep maximum cutting performance you must remove filing material from the depth gauge (B) to receive the recommended depth gauge setting. See *Technical data on page 27* for instructions about how to receive the correct depth gauge setting for your saw chain.

(Fig. 70)



WARNING: The risk of kickback increases if the depth gauge setting is too large!

To adjust the depth gauge setting

Before you adjust the depth gauge setting or sharpen the cutters, refer to *General information about how to sharpen the cutters on page 24*, for instructions. We recommend you to adjust the depth gauge setting after each third operation that you sharpen the cutting teeth.

We recommend that you use our depth gauge tool to receive the correct depth gauge setting and bevel for the depth gauge.

(Fig. 71)

1. Use a flat file and a depth gauge tool to adjust the depth gauge setting. Only use a Husqvarna recommended depth gauge tool to get the correct depth gauge setting and bevel for the depth gauge.
2. Put the depth gauge tool on the saw chain.

Note: See the package of the depth gauge tool for more information about how to use the tool.

3. Use the flat file to remove the part of the depth gauge that extends through the depth gauge tool. (Fig. 72)

To adjust the tension of the saw chain



WARNING: A saw chain with an incorrect tension can come loose from the guide bar and cause serious injury or death.

A saw chain becomes longer when you use it. It is important to adjust the tension of the saw chain regularly to make sure that it is correct. Do a check of the tension

of the saw chain before you operate the product. Tighten the saw chain as tightly as possible, but it must be possible to pull the saw chain around freely by hand.

Note: A new saw chain has a running-in period. Do a check of the tension more frequently during this period.

1. Turn the locking knob counterclockwise to unlock the chain tension adjuster. (Fig. 73)
2. Turn the chain tension adjuster clockwise to tighten the saw chain. Apply as much tension to the saw chain as possible. It must be tight against the guide bar.
3. Make sure that you can pull the saw chain around freely by hand and that it does not hang from the guide bar. (Fig. 74)
4. Turn the locking knob clockwise to lock the chain tension adjuster.

To lubricate cutting equipment



WARNING: Poor lubrication of cutting equipment may cause the chain to snap, which could lead to serious, even fatal injuries.



WARNING: Do not use waste oil!
Waste oil is dangerous for persons, the product and for the environment.

Saw chain oil

- Use saw chain oil of good adherence to the saw chain. The saw chain oil must keep its viscosity in all weather, for example, during hot summer or cold winter.
- Use Husqvarna chain oil for maximum saw chain life and to keep environmental damage to a minimum. If Husqvarna saw chain oil is not available, use a standard saw chain oil.
- In areas where oil for lubrication of saw chains is not available, use EP 90 transmission oil.

Do a check of the level of oil in the oil tank regularly to prevent damage to the saw chain and guide bar. (Fig. 75)

To fill with oil

Fill with saw chain oil after 1 hour of operation or when the battery is empty.

1. Open the oil tank cap on the top of the saw head.
2. Fill with Husqvarna saw chain oil.
3. Attach the oil tank cap.

To examine the saw chain lubrication

1. Start the product and let it run at 3/4 speed. Point the nose of the guide bar at a light color surface almost 20 cm (8 in) away.
2. After 1 minute of running, a line of oil shows on the light surface.
3. If you cannot see the line of oil after 1 minute, clean the oil channel in the guide bar. Clean the groove in the edge of the guide bar.
4. Start the product and let it run at 3/4 speed. Point the nose of the bar at a light color surface almost 20 cm (8 in) away.
5. After 1 minute of running, a line of oil shows on the light surface.
6. If you cannot see the line of oil after 1 minute, speak to your approved dealer.

To do a check if lubrication does not work

1. Check that the oil channel in the bar is not obstructed. Clean if necessary. (Fig. 76)
2. Check that the oil channel in the gear housing is clean. Clean if necessary.
3. Check that the bar tip sprocket turns freely. If the chain lubrication system is still not working after carrying out the above checks you should contact your service workshop. (Fig. 77)

To do a check of the guide bar

1. Make sure that the oil channel is not blocked. Clean if it is necessary. (Fig. 78)
2. Examine if there are burrs on the edges of the guide bar. Remove the burrs using a file. (Fig. 79)
3. Clean the groove in the guide bar. (Fig. 80)
4. Examine the groove in the guide bar for wear. Replace the guide bar if it is necessary. (Fig. 81)
5. Examine if the guide bar tip is rough or very worn. (Fig. 82)
6. Make sure that the bar tip sprocket turns freely and that the lubricating hole in the bar tip sprocket is not blocked. Clean and lubricate if it is necessary. (Fig. 83)
7. Turn the guide bar daily to extend its life cycle. (Fig. 84)

To clean the product, the battery and the battery charger

1. Clean the product with a dry cloth after use.
2. Clean the battery and battery charger with a dry cloth. Keep the battery guide tracks clean.
3. Make sure that the terminals on the battery and the battery charger are clean before use.
4. Clean around the oil tank cap with a brush.

5. Clean the inner surface of the protective cover with a brush.

2. Examine the battery charger for damages, for example cracks.

3. Make sure that the connection cord of the battery charger is not damaged and that there are no cracks in it.

To examine the battery and the battery charger

1. Examine the battery for damages, for example cracks.

Troubleshooting

Keypad

Problem	Possible faults	Possible solution
Green activate LED flashing	Low battery voltage.	Charge the battery.
The warning indicator flashes.	Overload.	The cutting attachment is blocked. stop the product. Remove the battery. Clean the cutting attachment from unwanted materials. Loosen the chain.
	Temperature deviation.	Let the product become cool.
	The power trigger and the start button are pushed at the same time.	Release the power trigger and push the start button.
The product does not start.	Dirt in the battery connectors.	Clean the battery connectors with compressed air or a soft brush.
The warning indicator is on.	It is necessary to do servicing on the product.	Speak to your servicing dealer.

Battery

Problem	Possible faults	Possible solution
Green LED flashes.	Low battery voltage.	Charge the battery.
Error LED flashes.	The battery is empty.	Charge the battery.
	Temperature deviation.	Use the battery in temperatures between -10°C (14°F) and 40°C (104°F).
	Overvoltage.	Remove the battery from the battery charger.
Error LED comes on.	Cell difference is too much (1V).	Speak to your servicing dealer.

Battery charger

Condition	Possible faults	Possible procedure
The charging LED is red.	Permanent battery charger error.	Speak to your dealer.

Condition	Possible faults	Possible procedure
The charging LED flashes green.	Temperature deviation, the battery is too cold or too hot to use or charge.	Let the battery cool down or warm it up. When the battery has the correct temperature, it can be used or charged again. Use the battery charger in ambient temperatures between 5 °C (41 °F) and 40 °C (104 °F).
The charging LED flashes red.	Faulty battery	Speak to your dealer.

Transportation and storage

Transportation and storage

- The supplied Li-ion batteries obey the Dangerous Goods Legislation requirements.
- Obey the special requirement on package and labels for commercial transportation, including by third parties and forwarding agents.
- Speak to a person with special training in dangerous material before you send the product. Obey all applicable national regulations.
- Use tape on open contacts when you put the battery in a package. Put the battery in the package tightly to prevent movement.
- Remove the battery for storage or transportation.
- Put the battery and the battery charger in a space that is dry and free from moisture and frost.
- Do not keep the battery in an area where static electricity can occur. Do not keep the battery in a metal box.
- Put the battery in storage where the temperature is between 5°C/41°F and 25°C/77°F and away from open sunlight.
- Put the battery charger in storage where the temperature is between 5 °C/41 °F and 45°C/113°F and away from open sunlight.
- Use the battery charger only when the surrounding temperature is between 5°C/41°F and 40°C/104°F.
- Charge the battery 30% to 50% before you put it in storage for long periods.

- Put the battery charger in storage in a space that is closed and dry.
- Keep the battery away from the battery charger during storage. Do not let children and other not approved persons to touch the equipment. Keep the equipment in a space that you can lock.
- Clean the product and do a full servicing before you put the product in storage for a long time.
- Use the transportation guard on the product to prevent injuries or damage on the product during transportation and storage.
- Attach the product safely during transportation.

Disposal of the battery, battery charger and product

The symbol below means that the product is not domestic waste. Recycle it at a recycling station for electrical and electronic equipment. This helps to prevent damage to the environment and to persons.

Speak to local authorities, domestic waste service or your dealer for more information.

(Fig. 21)

Note: The symbol shows on the product or package of the product.

Technical data

Technical data

	120iTK4-P
Motor	
Type	PMDC 36V
Chain speed, m/sec	10

	120iTK4-P
Features	
Low energy mode	savE
Oil tank	
Capacity, l/cm ³	0.07/70
Weight	
Without battery, cutting device, cutting device cover, harness and with empty tank, kg/lb	3.6/7.9
Noise emissions ¹	
Sound power level, measured dB(A)	93.79
Sound levels ²	
Equivalent sound pressure level at the operator's ear, dB(A)	80.6
Vibration levels ³	
Vibration levels at handles, measured according to ISO 22867, m/s²	
Collapsed, front handle/rear handle	0.793/0.676
Extended, front handle/rear handle	1.475/0.773

Approved batteries

Battery	BLi10	40-B70
Type	Lithium-ion	Lithium-ion
Battery capacity, Ah	Refer to battery rating decal	Refer to battery rating decal
Nominal voltage, V	36	36
Weight, kg	0.7	0.8

Approved battery chargers

Battery charger	QC 80	40-C80
Input voltage, V	100-240	100-240
Frequency, Hz	50-60	50-60

¹ Noise emissions in the environment measured as sound power (L_{WA}) in conformity with EC directive 2000/14/EC. The difference between guaranteed and measured sound power is that guaranteed sound power also includes dispersion in the measurement result and the variations between different products of the same model refer to Directive 2000/14/EC.

² Equivalent sound pressure level, according to ISO 22868, is calculated as the time-weighted energy total for different sound pressure levels under various working conditions. Typical statistical dispersion for equivalent sound pressure level is a standard deviation of 3 dB (A).

³ Reported data for equivalent vibration level has a typical statistical dispersion (standard deviation) of 1.5 m/s².

Battery charger	QC 80	40-C80
Power, W	80	72

Accessories

Guidebar and saw chain combinations

The following combinations are CE approved.

Guide bar			Saw chain	
Length, inch	Pitch, inch	Gauge, mm	Type	Length, number of drive links
10	1/4"	1.3	Husqvarna H00	58

Saw chain filing and file gauge

If you do not know which saw chain you have on your product, speak to your servicing dealer.

Use the recommended file gauge to get the correct filing angles. We recommend you to always use the recommended file gauge to restore the sharpness of the saw chain.

(Fig. 85)	(Fig. 86)	(Fig. 87)(Fig. 88)	(Fig. 89)	(Fig. 90)	(Fig. 91)	(Fig. 92)	(Fig. 93)
	mm/in				mm/in		
00	4.0 / 5/32	85°	30°	0°	0.65/0.025	5056981-03	5796536-01

Declaration of Conformity

EU Declaration of Conformity

We, Husqvarna AB, SE-561 82 Huskvarna, Sweden,
tel: +46-36-146500, declare under our sole responsibility
that the product:

Description	Battery telescopic pole saw
Brand	Husqvarna
Type / Model	120iTK4-P
Identification	Serial number dating 2024 and onwards

complies fully with the following EU directives and
regulations:

Regulation	Description
2006/42/EC	"relating to machinery"
2014/30/EU	"relating to electromagnetic compatibility"
2011/65/EU	"restriction of use of certain hazardous substances"

The following standards have been applied:

EN 62841-1:2015+A11:2022, EN ISO 11680-1:2021,
EN ISO 12100:2010, EN IEC 55014-1:2021, EN IEC
55014-2:2021, EN IEC 63000:2018

TÜV Rheinland LGA Products GmbH, Tillystrasse 2,
D-90431 Nuernberg, Germany, 0197, has carried out
voluntary EC type examination in accordance with
machinery directive's (2006/42/EC) article 12, point 3b.

The certificate for EC type examination has the number:
BM 50615423

Huskvarna 2024-01-19

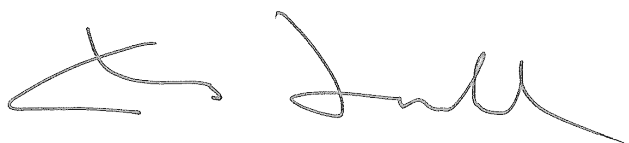

Claes Losdal, R&D Manager, Husqvarna AB

Responsible for technical documentation



UK Declaration of Conformity

We, **Husqvarna AB**, SE-561 82 Huskvarna, Sweden, tel:
+46-36-146500, declare on our sole responsibility that
the product:

Description	Battery telescopic pole saw
Brand	Husqvarna
Type / Model	120iTK4-P
Identification	Serial number dating 2024 and onwards

complies fully with the following UK regulations:

Description
The Supply of Machinery (Safety) Regulations 2008
Electromagnetic Compatibility Regulations 2016
The Restriction of the use of Certain Hazardous Substances in Electrical and Electronic Equipment Regulations 2012

and that the following standards and/or technical
specifications are applied:

EN 62841-1:2015+A11:2022, EN ISO 11680-1:2021,
EN ISO 12100:2010, EN IEC 55014-1:2021, EN IEC
55014-2:2021, EN IEC 63000:2018

TÜV Rheinland LGA Products GmbH, Tillystrasse 2,
D-90431 Nuernberg, Germany, 0197, has carried out
voluntary EC type examination in accordance with
machinery directive's (2006/42/EC) article 12, point 3b.
The certificate for EC type examination has the number:
BM 50615423

Huskvarna 2024-01-19

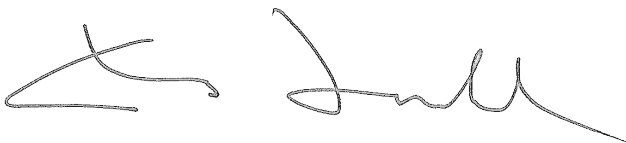

Claes Losdal, R&D Manager, Husqvarna AB

Responsible for technical documentation



UK Importer:
Husqvarna UK Ltd
Preston Road, Co. Durham
DL5 6UP