



# Husqvarna®

## BA101

EN	Operator's manual	2-15
BG	Ръководство за експлоатация	16-29
CS	Návod k použití	30-42
DA	Brugsanvisning	43-54
DE	Bedienungsanweisung	55-68
EL	Οδηγίες χρήσης	69-83
ES	Manual de usuario	84-96
ET	Kasutusjuhend	97-108
FI	Käyttöohje	109-121
FR	Manuel d'utilisation	122-135
HU	Használati utasítás	136-148
LT	Operatoriaus vadovas	149-160
LV	Lietošanas pamācība	161-173
NL	Gebruiksaanwijzing	174-186
NO	Bruksanvisning	187-198
PL	Instrukcja obsługi	199-212
PT	Manual do utilizador	213-226
RO	Instrucțiuni de utilizare	227-239
RU	Руководство по эксплуатации	240-254
SK	Návod na obsluhu	255-267
SL	Navodila za uporabo	268-279
SV	Bruksanvisning	280-291
TR	Kullanım kılavuzu	292-303
ZH	操作手册	304-313
EN-US	Operator's manual	314-321
FR-CA	Manuel d'utilisation	322-329
ES-MX	Manual de usuario	330-337
IT-US	Manuale dell'operatore	338-345

EAC

---

## Contents

---

Introduction.....	2	Transportation, storage and disposal.....	10
Safety.....	3	Technical data.....	10
Operation.....	9	Declaration of Conformity.....	12
Maintenance.....	9		

---

## Introduction

---

### Product description

We have a policy of continuous product development and therefore reserve the right to modify the design and appearance of the products without prior notice.

**Note:** This manual cover both gasoline operated and battery operated power units.

### Intended use



**WARNING:** This attachment may only be

used together with the intended power unit. See the accessory chapter in the Operator's manual for the power unit.

The attachment is only designed for blowing lawns, pathways, asphalt roads and the like.

### Attachment overview

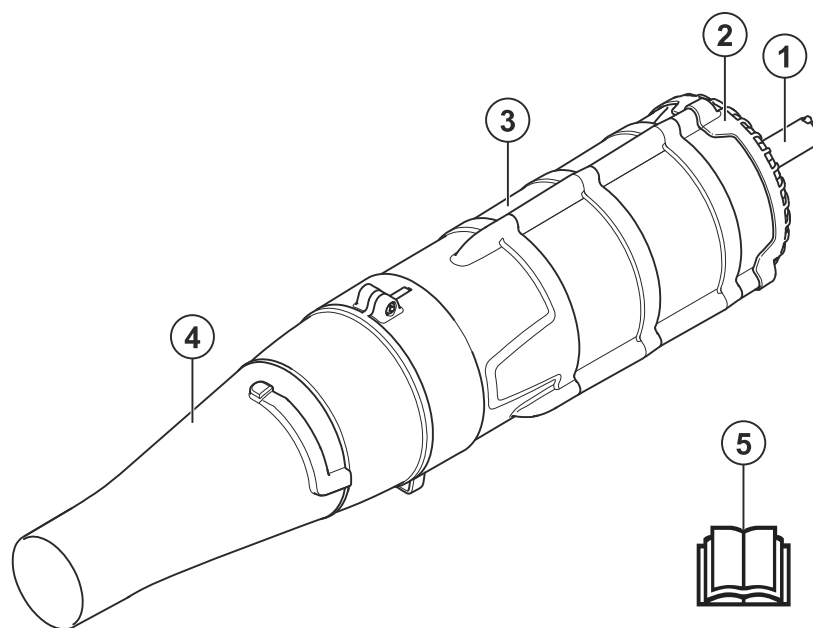

1. Shaft
2. Air intake screen
3. Fan housing
4. Air nozzle
5. Operator's manual

### Symbols on the attachment and on the power unit



Careless or incorrect use of this attachment can result in serious or fatal injury to the operator or others.



Read the operator's manual carefully and make sure you understand the instructions before you use the attachment.



This attachment is in accordance with applicable EC directives.



This product conforms to applicable UK regulations.



Use approved hearing, eye and breathing protection.



Use approved protective gloves.



Noise emission to the environment according to the European Community's Directive. The attachment's emission is

specified in the Technical data chapter and on the label.



The blower operator must ensure that no people or animals come closer than 15 meters. When several operators are working at the same site a safety distance of at least 15 meters must be in effect. The blower can forcibly throw objects that can bounce back. This can result in serious eye injuries if the recommended safety equipment is not used.



The blower can forcibly throw objects that can bounce back. This can result in serious eye injuries if the recommended safety equipment is not used.



The operator of the product must ensure, while working, that no persons or animals come closer than 15 meters.



Severing of fingers or hand by fan blade. Do not open or remove the safety guards or nets while engine is running.

**Note:** Other symbols/decals on the attachment refer to special certification requirements for certain markets.

## Safety

### Safety definitions

Warnings, cautions and notes are used to point out specially important parts of the operator's manual.



**WARNING:** Used if there is a risk of injury or death for the operator or bystanders if the instructions in the manual are not obeyed.



**CAUTION:** Used if there is a risk of damage to the product and/or the attachment, other materials or the adjacent area if the instructions in the manual are not obeyed.

**Note:** Used to give more information that is necessary in a given situation.

## General safety instructions

---



**WARNING:** Read the safety instructions that follow before you use the attachment.

---

- Please read the operator's manual carefully and make sure you understand the instructions before using the attachment.
- This Operator's manual should be read together with the Operator's manual for the power unit to get the complete user information.
- Under no circumstances may the design of the attachment be modified without the permission of the manufacturer. Do not use an attachment that appears to have been modified by others and always use original accessories. Non-authorized modifications and/or accessories can result in serious personal injury or the death of the operator or others.

## Safety instructions for operation

---



**WARNING:** Read the warning instructions that follow before you use the product.

---



**WARNING:** This product produces an electromagnetic field during operation. This field may under some circumstances interfere with active or passive medical implants. To reduce the risk of serious or fatal injury, we recommend persons with medical implants to consult their physician and the medical implant manufacturer before operating this product.

---

- Never use the product if you are tired, if you are ill, if you have consumed alcohol, or if you are taking other drugs or medication that can affect your vision, judgement or co-ordination.
- Never use a product that is faulty.
- All covers and guards must be fitted before starting. If you have a gasoline operated product, ensure that the spark plug cap and ignition lead are undamaged to avoid the risk of electric shock.
- The blower operator must ensure that no people or animals come closer than

15 meters. When several operators are working at the same site a safety distance of at least 15 meters must be in effect.

- Never allow children to use the product.
- Never allow anyone else to use the product without first ensuring that they have read and understood the contents of the operator's manual.
- Never remove the air intake screen.
- Never touch the spark plug or ignition cable while the engine is running. Touching the spark plug or plug may result in being subjected to an electrical shock.
- Always contact local authorities and make sure you are following applicable directives.
- Keep all parts of your body away from hot surfaces.
- If you encounter a situation where you are uncertain how to proceed you should ask an expert. Contact your dealer or your service workshop. Avoid all usage which you consider to be beyond your capability.
- Hold the opening of the blower as close to the ground as possible. Utilize the entire length of the blow pipe to keep the air stream close to the ground.
- Use the machine during normal working hours to avoid unnecessary disturbance. Avoid working early in the morning or late at night.
- Be aware of your surroundings. If anyone approaches your work area, release the throttle/power trigger until the person is at a safe distance. Direct the blower away from people, animals, play areas, open windows and cars etc. The force of air can cause rocks, dirt or sticks to be thrown or to ricochet which can injure people or animals, break glass or cause other damage.
- Never put hands or other objects into blower housing to avoid serious injury from the rotating impeller.
- Keep outside surface free from oil and fuel.
- Never use for spreading chemicals, fertilizer or other substances which may contain toxic materials.
- To avoid spreading fire, do not use near leaf or brush fire, fireplaces, barbecue pits, ashtrays, etc.

- Never douse or squirt the attachment with water or any other liquid.
- Always use both hands to hold the machine. Hold the machine at the side of your body.
- If you have a gasoline operated product, allow the engine to cool before refueling.
- The powerful streams of air can move objects at such a speed that they can bounce back and cause serious eye injuries.

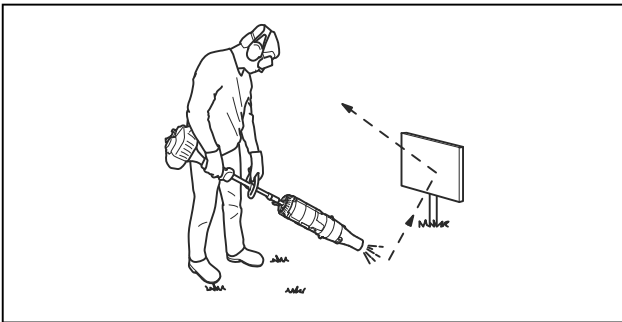

- Stop the engine/motor before assembling or dismantling accessories or other parts.
- Do not use the product in bad weather, such as dense fog, heavy rain, strong wind, intense cold, etc. Working in bad weather is tiring and can lead to dangerous conditions, e.g. slippery surfaces.
- Make sure you can move and stand safely. Check the area around you for possible obstacles (roots, rocks, branches, ditches, etc.)

in case you have to move suddenly. Take great care when working on sloping ground.



- Never put the product down with the engine/motor running unless you have it in clear sight.
- If you have a gasoline operated product, the engine exhaust fumes contain carbon monoxide, which can cause carbon monoxide poisoning. For this reason you should not start or run the product indoors, or anywhere that is poorly ventilated.
- The blower must not be used while on a ladder or scaffolding, or in high places (such as roofs). This work could result in severe injury.

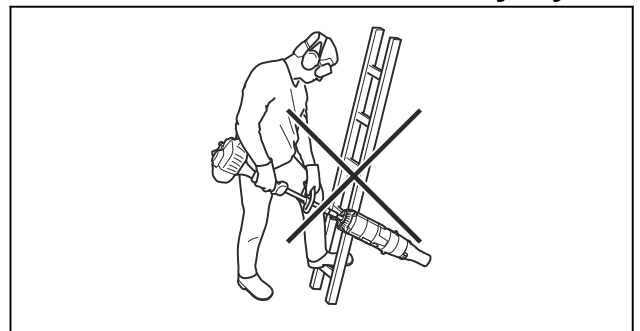

- Do not use the product unless you are able to call for help in the event of an accident.

- Never place any objects in air intake opening as this could restrict proper air flow and cause damage to the unit.
- Make sure that the product do not hit any fence, tree or other hard material. This could cause damage to the machine and lead to severe injury.
- Listen out for warning signals or shouts when you are wearing hearing protection. Always remove your hearing protection as soon as the engine/motor stops.

### Personal protective equipment



**WARNING:** Read the warning instructions that follow before you use the product.

- Always use approved personal protective equipment when you use the product. Personal protective equipment cannot fully prevent injury but it decreases the degree of injury if an accident does occur. Let your dealer help you select the right equipment.
- Use approved hearing protection that provides adequate noise reduction. Long-term exposure to noise

can result in permanent hearing impairment.

- Use approved eye protection. If you use a visor, you must also use approved protective goggles. Approved protective goggles must comply with the ANSI Z87.1 standard in the USAs or EN 166 in EU countries.

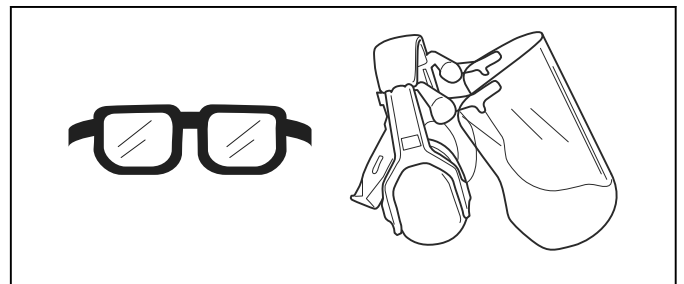

- Use breathing protection when there is a risk of dust.

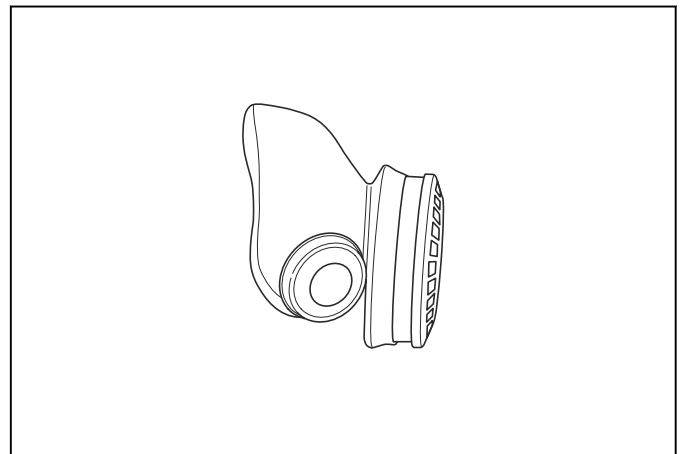

- Use gloves when necessary, for example when you attach, examine or clean the equipment.

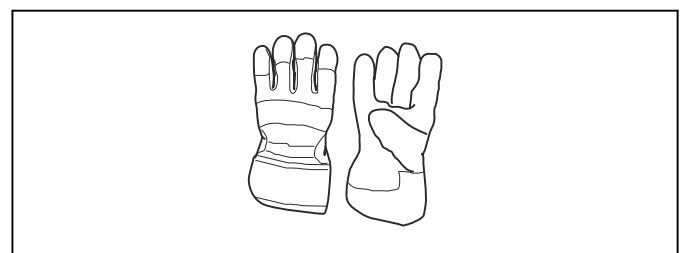

- Use sturdy non-slip boots or shoes.



- Use clothing made of a strong fabric. Always use heavy, long pants and long sleeves. Do not use loose clothing that can catch on twigs and branches. Do not wear jewelry, short pants, sandals or go with bare feet. Put your hair up safely above shoulder level.
- Keep first aid equipment close at hand.

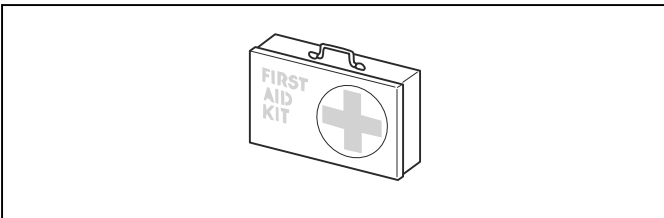

Carry out an overall inspection of the product before use. See the maintenance schedule.

Carry out the maintenance and service instructions described in this manual. Some maintenance and service measures must be carried out by trained and qualified specialists. See instructions under the Maintenance heading.

Always check for any objects that may block the air intake screen before beginning work.

In order to prevent damage due to falling of the product, assembly and dismantling should be conducted close to the ground surface.

## Safety instructions for maintenance



**WARNING:** Read the warning instructions that follow before you operate the product.



---

## Operation

---

### To use the attachment

---

**Note:** Show consideration to persons in your surroundings by avoiding using the machine at unsuitable times, such as late in the evening or early in the morning. Reduce the noise levels by limiting the number of equipment units used simultaneously. Read through and follow the simple directions so that you disturb your surroundings as little as possible.

---

1. Use a rake or a brush to release rubbish stuck to the ground.
2. Clean corners by starting in corners and moving outward. This will help prevent an accumulation of debris which could fly into your face.
3. Use the blower with the lowest possible throttle/speed. It is seldom necessary to use full throttle/speed, and many work procedures can be done at half throttle/speed. A lower throttle/speed means less noise and less dust, and it is also easier to keep control over the rubbish collected together/moved.
4. Minimise the blowing time by lightly wetting dusty areas or using spray equipment.
5. Reduce water consumption by using blowers instead of water hoses for different applications around the lawn and garden, such as lattices, screens, grills, porches, etc.
6. Be careful when working near plants. The force of the air could damage tender plants.
7. The speed of the air jet is regulated by means of the throttle/power trigger. Select the speed best suited for respective tasks.
8. Be aware of the wind direction. Work with the wind to make your work easier.
9. Using the blower to move large piles is time consuming and creates unnecessary noise.
10. Keep a good balance and a firm foothold.
11. Keep clearance between the tube and ground to avoid contact with the ground when working with the product.
12. Clean up afterwards. Make sure that you have not blown rubbish into someone's garden. Dispose of debris in trash receptacle.
13. When work is finished the product should be stored horizontally.

---

## Maintenance

---

### Introduction

Below you will find some general maintenance instructions. If you need further information please contact your service workshop.

### To perform daily maintenance on the attachment

---



**WARNING:** Always stop the engine/motor before you clean or do maintenance on the attachment. If you have a gasoline operated product, disconnect the ignition cable from the spark plug. If you have a battery operated product, remove the battery.

---



**WARNING:** Keep all parts of your body away from hot surfaces.

---

1. Clean the exterior surface of the blower.
2. Make sure that all the housing are free of cracks.
3. Make sure that the product is in perfect working order.
4. Make sure that all nuts and screws are tight.
5. Clean the labels using a damp cloth with a mild detergent.

## To check the air intake screen

1. Check that the air intake is not blocked on all sides including the underside, for example, by leaves or rubbish. A clogged air intake reduces the product's blowing capacity and increases the working temperature of the engine/motor, which can result in engine/motor failure. Stop the engine/motor and remove the object.

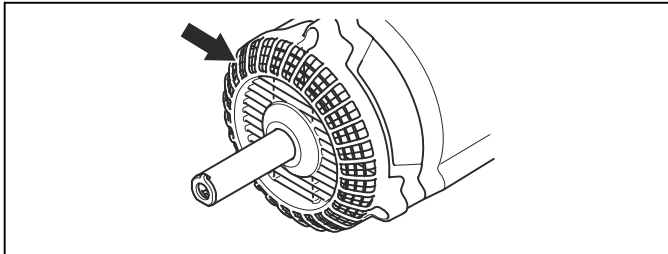

---

## Transportation, storage and disposal

---

### Transport and storage

Perform the following steps after each use:

- Allow attachment to cool before storing or transporting.
- Store in a high, cool, dry, indoor area out of reach for children.

- Clean the unit.
- Inspect attachment for any loose or damage parts. Tighten any loose screws.
- Replace any damaged, worn or broken parts.
- At the beginning of the next season, use only fresh fuel having the proper petrol to oil ratio.

### Seasonal storage

Prepare attachment for storage at end of season or if it will not be used for 30 days or more. If your blower attachment is to be stored for a period of time:

---

## Technical data

---

### Technical data for gasoline operated products

BA101	
Weight	
Weight, kg	1.9
Noise emissions	
Sound power level, measured dB (A)	109
Sound power level, guaranteed L <sub>WA</sub> dB (A)	112
Sound levels <sup>1</sup>	
Equivalent sound pressure level at the operator's ear, measured according to EN15503 dB(A)	99

---

<sup>1</sup> The equivalent sound pressure level value is calculated with a work cycle of a duration of 1/7 for idling and 6/7 for racing. Reported data for equivalent sound pressure level for the machine has a typical statistical dispersion (standard deviation) of 1 dB(A).

<b>BA101</b>	
<b>Vibration levels <sup>2</sup></b>	
Equivalent vibration levels ( $a_{hv,eq}$ ) at handles, measured according to EN 15503, $m/s^2$	
Front/rear handles:	5.6/8.3
<b>Fan performance <sup>3</sup></b>	
Max. air velocity with standard nozzle, m/s:	66
Air flow with standard nozzle, $m^3/min$	15

## Technical data for battery operated products

<b>325iLK + Blower attachment BA101</b>	
<b>Weight</b>	
Weight, kg	2.3+1.9
<b>Noise emissions <sup>4</sup></b>	
Sound power level, measured dB (A)	103
Sound power level, guaranteed $L_{WA}$ dB (A)	106
<b>Sound levels <sup>5</sup></b>	
Sound pressure level at the operator's ear, measured according to ISO 26868 dB(A)	
Equipped with approved accessory (original), dB (A)	93
<b>Vibration levels <sup>6</sup></b>	
Vibration levels at handles, measured according to EN 62841-1, $m/s^2$	
Equipped with approved accessory (original), left/right m/s	1.6/1.1
<b>Fan performance <sup>7</sup></b>	
Air flow in normal mode with standard nozzle, $m^3/min$	14
Maximum air velocity in normal mode with standard nozzle, m/s:	52

<sup>2</sup> The equivalent vibration level value is calculated with a work cycle of a duration of 1/7 for idling and 6/7 for racing. Reported data for equivalent vibration level has a typical statistical dispersion (standard deviation) of 1  $m/s^2$ .

<sup>3</sup> Together with 525LK/GC2225C engine unit.

<sup>4</sup> Noise emissions in the environment measured as sound power ( $L_{WA}$ ) in conformity with EC directive 2000/14/EC. Reported sound power level for the machine has been measured with the original cutting attachment that gives the highest level. The difference between guaranteed and measured sound power is that the guaranteed sound power also includes dispersion in the measurement result and the variations between different machines of the same model according to Directive 2000/14/EC.

<sup>5</sup> Reported data for sound pressure level for the machine has a typical statistical dispersion (standard deviation) of 3 dB (A) and has been measured with the original attachment that gives the highest level. Measured together with the 325iLK motor unit.

<sup>6</sup> Reported data for vibration level has a typical statistical dispersion (standard deviation) of 2  $m/s^2$ . For comparison of vibrations levels, battery and combustion products use vibration calculator. refer to, <https://www.husqvarna.com/uk/services-solutions/vibration-calculator/>. Measured together with the 325iLK motor unit.

<sup>7</sup> Measured together with the 325iLK motor unit.

# Declaration of Conformity

## EU Declaration of Conformity

We, **Husqvarna AB**, SE-561 82 Huskvarna, Sweden, tel: +46-36-146500, declare on our sole responsibility that the product:

<b>Description</b>	Blower attachment
<b>Brand</b>	Husqvarna
<b>Type / Model</b>	BA101
<b>Identification</b>	Serial numbers dating from 2022 and onwards

complies fully with the following EU directives and regulations:

<b>Regulation</b>	<b>Description</b>
2006/42/EC	"relating to machinery"
2000/14/EC	"relating to the noise emissions in the environment"
2011/65/EU	"on the restriction of the use of certain hazardous substances in electrical and electronic equipment"

and that the following standards and/or technical specifications are applied: EN15503:2009+A2:2015, EN ISO 12100:2021, EN IEC 63000:2018.

RISE SMP Svensk Maskinprovning AB, Box 7035, SE-750 07 Uppsala, Sweden has performed voluntary type examination on behalf of Husqvarna AB.

Certificate number: SEC/15/2416 – Husqvarna BA101.

For information relating to noise emissions, refer to *Technical data on page 10*.

Huskvarna, 2022-05-09

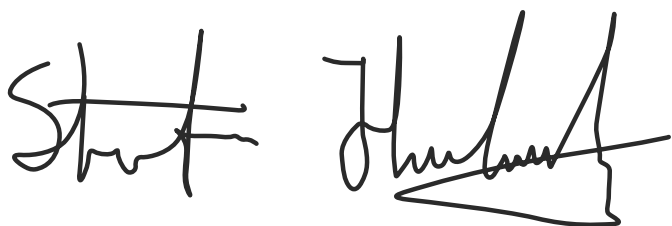

Stefan Holmberg, R&D Director, Technology Management, Husqvarna AB

Responsible for technical documentation



## UK Declaration of Conformity

We, **Husqvarna AB**, SE-561 82 Huskvarna, Sweden, tel: +46-36-146500, declare on our sole responsibility that the product:

<b>Description</b>	Blower attachment
<b>Brand</b>	Husqvarna
<b>Type / Model</b>	BA101
<b>Identification</b>	Serial numbers dating from 2022 and onwards

complies fully with the following UK directives and regulations:

<b>Description</b>
The Restriction of the Use of Certain Hazardous Substances in Electrical and Electronic Equipment Regulations 2012
The Noise Emission in the Environment by Equipment for use Outdoors Regulations 2001, schedule 9
Electromagnetic Compatibility Regulations 2016

and that the following standards and/or technical specifications are applied: EN15503:2009+A2:2015, EN ISO 12100:2021, EN IEC 63000:2018.

For information relating to noise emissions, refer to *Technical data on page 10*.

Huskvarna, 2022-05-09

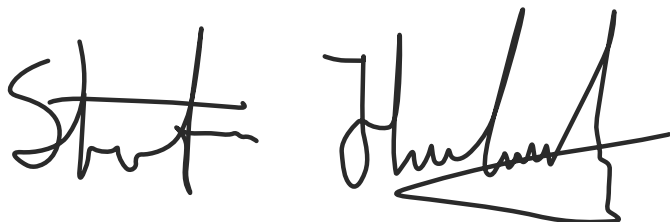

Stefan Holmberg, R&D Director, Technology Management, Husqvarna AB

Responsible for technical documentation

**UK  
CA**

UK Importer:  
Husqvarna UK Ltd  
Preston Road, Co. Durham  
DL5 6UP

## EU Declaration of Conformity

We, **Husqvarna AB**, SE-561 82 Huskvarna, Sweden, tel: +46-36-146500, declare on our sole responsibility that the product:

<b>Description</b>	Blower attachment with power unit Husqvarna 325iLK
<b>Brand</b>	Husqvarna
<b>Type / Model</b>	BA101
<b>Identification</b>	Serial numbers dating from 2022 and onwards

complies fully with the following EU directives and regulations:

<b>Regulation</b>	<b>Description</b>
2006/42/EC	"relating to machinery"
2000/14/EC	"relating to the noise emissions in the environment"
2011/65/EU	"on the restriction of the use of certain hazardous substances in electrical and electronic equipment"

and that the following standards and/or technical specifications are applied: IEC 60335-2-100, EN IEC 63000:2018.

RISE SMP Svensk Maskinprovning AB, Box 7035, SE-750 07 Uppsala, Sweden has performed voluntary type examination on behalf of Husqvarna AB. Certificate number: SEC/15/2416 – Husqvarna BA101.

RISE SMP Svensk Maskinprovning AB, Box 7035, SE-750 07 Uppsala, Sweden has also verified agreement with the appendix V of the council's directive 2000/14/EG. Certificate number: 01/012/014.

For information relating to noise emissions, refer to *Technical data on page 10*.

Huskvarna, 2022-05-09

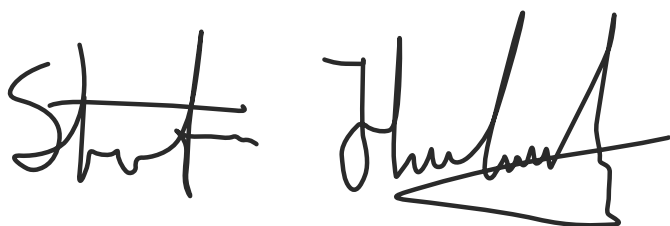

Stefan Holmberg, R&D Director, Technology Management, Husqvarna AB

Responsible for technical documentation



## UK Declaration of Conformity

We, **Husqvarna AB**, SE-561 82 Huskvarna, Sweden, tel:  
+46-36-146500, declare on our sole responsibility that  
the product:

<b>Description</b>	Blower attachment with power unit Husqvarna 325iLK
<b>Brand</b>	Husqvarna
<b>Type / Model</b>	BA101
<b>Identification</b>	Serial numbers dating from 2022 and onwards

complies fully with the following UK directives and  
regulations:

<b>Description</b>
The Restriction of the Use of Certain Hazardous Substances in Electrical and Electronic Equipment Regulations 2012
The Noise Emission in the Environment by Equipment for use Outdoors Regulations 2001, schedule 9
Electromagnetic Compatibility Regulations 2016

and that the following standards and/or technical  
specifications are applied: IEC 60335-2-100, EN IEC  
63000:2018.

For information relating to noise emissions, refer to  
*Technical data on page 10.*

Huskvarna, 2022-05-09

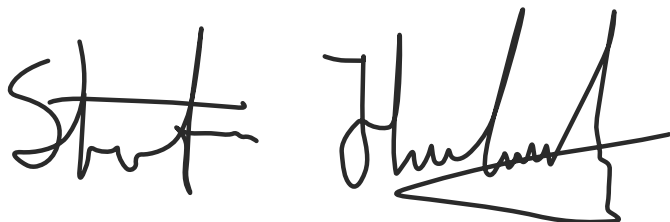

Stefan Holmberg, R&D Director, Technology  
Management, Husqvarna AB

Responsible for technical documentation

**UK  
CA**

UK Importer:  
Husqvarna UK Ltd  
Preston Road, Co. Durham  
DL5 6UP