

# **STIHL®**

## **STIHL FW 20 - TS 700, 800**

Gebrauchsanleitung  
Instruction Manual  
Notice d'emploi  
Manual de instrucciones



Uputa za uporabu  
Skötselavvisning  
Käyttöohje  
Istruzioni d'uso  
Betjeningsvejledning  
Bruksanvisning  
Návod k použití  
Használati utasítás  
Instruções de serviço  
Návod na obsluhu  
Handleiding  
Инструкция по эксплуатации  
Lietošanas instrukcija  
Інструкція з експлуатації  
οδηγίες χρήσης  
取扱説明書  
Instrukcja użytkowania  
Kasutusjuhend  
Eksploataavimo instrukcija



# Contents

Cut-off machine cart	6
Mounting	6

Original Instruction Manual

Printed on chlorine-free paper  
Printing inks contain vegetable oils, paper can be recycled.

© ANDREAS STIHL AG & Co. KG, 2012  
0458-537-9921-A\_VA3.H12.  
000000856\_002\_GB

**STIHL**®

FW 20 - TS 700, TS 800

This instruction manual is protected by copyright. All rights reserved, especially the rights to reproduce, translate and process with electronic systems.

## Cut-off machine cart

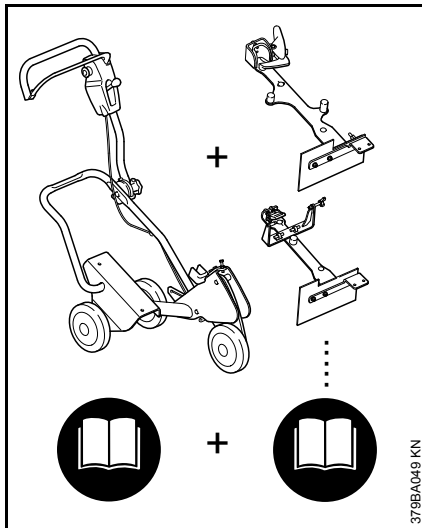

A basic machine **and** an attachment kit are combined to produce a complete cart FW 20.

The complete instruction manual for the cart FW 20 therefore consists of two instruction manuals – one for the basic machine FW 20 **and** one for the attachment kit FW-TS.

Always read **both** instruction manuals carefully before using your machine for the first time and keep them safe for future reference.

Additionally, observe the instruction manual of the cut-off machine used.

## Mounting

### Installing the mount

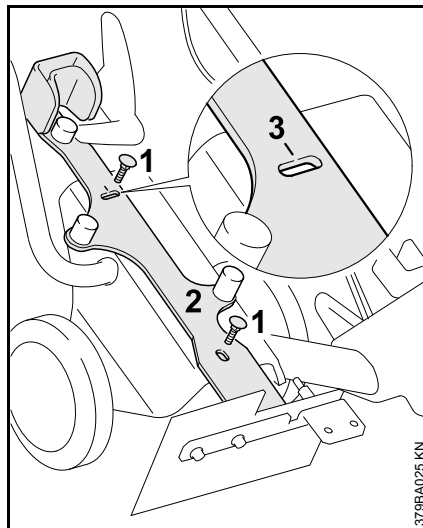

- Insert bolts (1) M8x25 from above through the oblong holes in the mount (2)
- Position the mount so that the notch (3) in the upper oblong hole is centered in relation to the bolt
- Screw on and tighten the hexagon nut with washer

### Mounting the cut-off machine

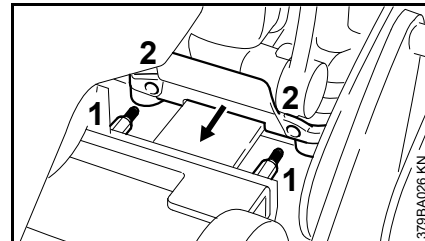

- Position the cut-off machine so that the pins (1) protrude into the holes in the support (2)

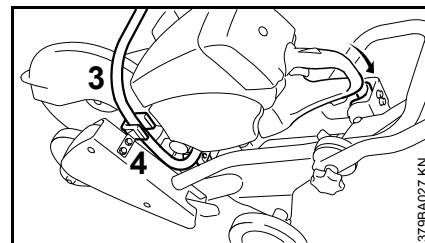

- The handlebar (3) must lie in the bracket (4)

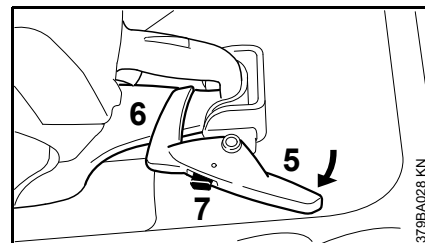

- Swivel the locking lever (5) over the hand guard (6) and engage
- The pawl (7) disengages and the handle is now fixed in place

## Mounting the throttle control

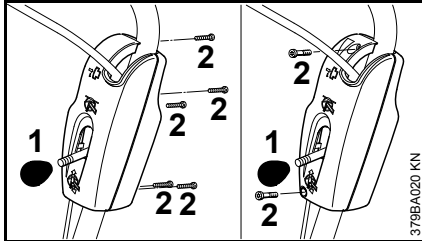

- Twist off and remove the button (1) on the lever which controls the cutting depth adjustment
- Unscrew the screws (2) and remove the moldings

## Mounting the throttle cable

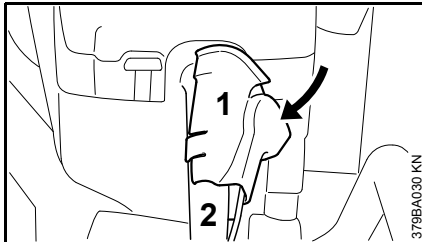

- Push the throttle cable support (1) on to the handle (2) from the side and engage in position

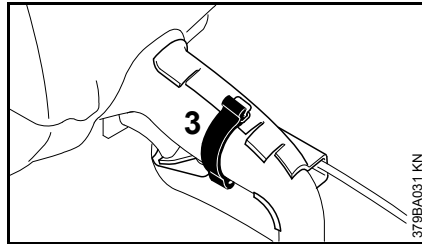

- Secure the throttle cable support with the rubber strap (3)
- Unscrew and remove the upper hexagon nut from the screw sleeve of the throttle cable

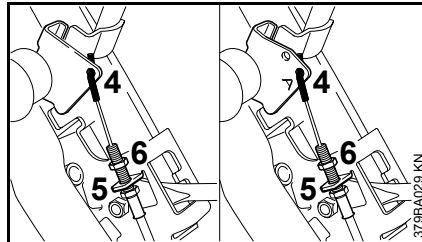

- Guide the throttle cable nipple (4) and screw sleeve through the support (5)
- Screw on hexagonal nut (6)
- Hook the throttle cable nipple into the hole (A)

## Adjusting the throttle cable

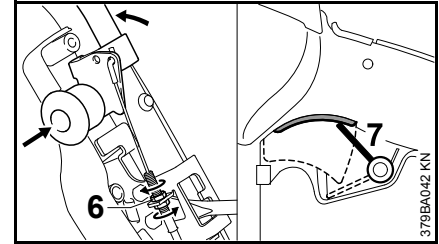

- Set the bracket bow to the full-throttle position
- Tighten the throttle cable at the lower nut until the lever (7) reaches the stop – throttle lever in full throttle position
- Tighten the hexagon nut (6)
- Release the bow – Idle position – the cut-off machine throttle lever must be in the idle position
- Screw the two moldings back together again and screw the knob back on to the lever

## Dismounting the cut-off machine

- Press down the locking pawl on the locking lever and turn the locking lever away from the hand guard
- Release the rubber strap from the throttle cable support and remove the throttle cable support from the handle
- Lift out the cut-off machine

### **Trial cut**

---

If the result of a trial cut is considerably wider than the width of the abrasive wheel segment (approximately 1.5 times the segment width), check that the abrasive wheel is correctly fitted.

### **Transport**

---

The star handle can be unscrewed and the guide tube swung forwards for compact transport (remove the water tank, if fitted).