



Husqvarna[®]

HA200, HA860

EN	Operator's manual	2-17
DE	Bedienungsanweisung	18-32
ES	Manual de usuario	33-47
FR	Manuel d'utilisation	48-62
IT	Manuale dell'operatore	63-76
NL	Gebruiksaanwijzing	77-91
PT	Manual do utilizador	92-106
SL	Navodila za uporabo	107-120

Contents

Introduction.....	2	Maintenance.....	10
Safety.....	4	Technical data.....	12
Assembly.....	8	Declaration of Conformity.....	14
Operation.....	8		

Introduction

Product description

We have a policy of continuous product development and therefore reserve the right to modify the design and appearance of the products without prior notice.

Note: This manual cover both gasoline operated and battery operated power units.

Intended use



WARNING: This attachment may only be used together with the intended product,

see the accessory chapter in the Operator's Manual of the product.

The product is only designed for cutting branches and twigs.



WARNING: Never use HA200 with a battery operated power unit.

Only use HA200 with gasoline operated power units. Use HA860 with either a gasoline operated product or a battery operated power unit.

Attachment overview for HA200 (for gasoline products only)

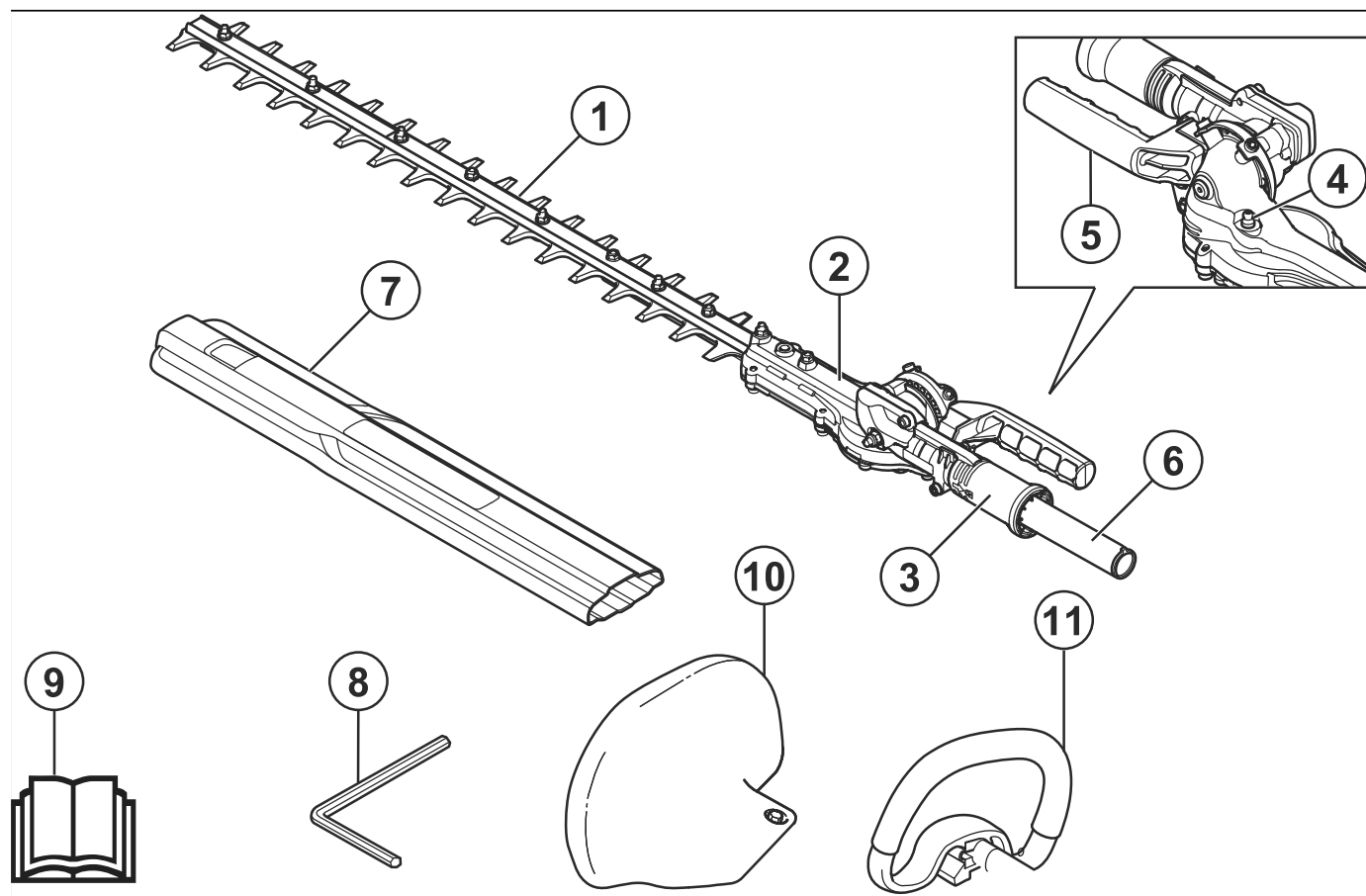

- | | |
|-------------------------------|------------------|
| 1. Blade | 4. Grease nipple |
| 2. Gearbox | 5. Handle |
| 3. Position adjustment handle | 6. Shaft |

- 7. Transport guard
- 8. Hex key
- 9. Operator's manual

- 10. Handguard
- 11. Front handle

Attachment overview for HA860

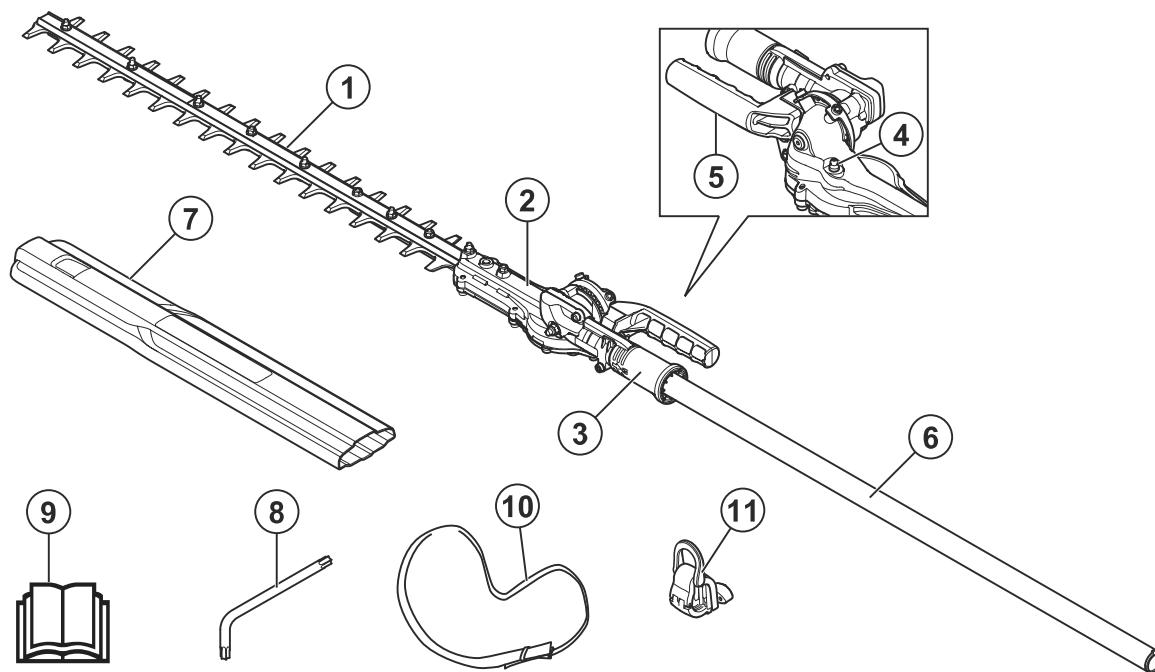

- 1. Blade
- 2. Gearbox
- 3. Position adjustment handle
- 4. Grease nipple
- 5. Handle
- 6. Shaft
- 7. Transport guard
- 8. Torx key
- 9. Operator's manual
- 10. Harness
- 11. Harness support hook



Read the operator's manual carefully and make sure you understand the instructions before you use the attachment.



Always wear approved hearing protection and protective goggles or a visor.



Symbols on the attachment and the power unit



Careless or incorrect use of this product can result in serious or fatal injury to the operator or others.



Read the operator's manual carefully and make sure you understand the instructions before you use the attachment.



This attachment is in accordance with applicable EC directives.



This product conforms to applicable UK regulations.



DANGER - Keep hands away from blade.



DANGER - Keep hands away from blade.



Always wear approved protective gloves.



Keep all parts of your body away from the hot surfaces.



Wear sturdy, non-slip boots.

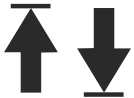

Arrows which show limits for handle positioning.

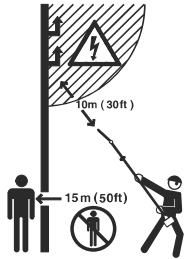

DANGER - Keep sufficient distance away from electrical power lines. This product is not electrically insulated. If the product touches or comes close to high-voltage power lines it could lead to death or serious bodily injury. Electricity can jump from one point to another by arcing. The higher the voltage, the greater the distance electricity can jump. Electricity can also travel through branches and other objects, especially if they are wet. Always keep a distance of at least 10 m between the product and high-voltage power lines and/or any objects that are touching them. If have to work within this safe distance you should always contact the relevant power company to make sure the power is switched off before you start work.

The operator of the product must ensure, while working, that no persons or animals come closer than 15 meters.



Noise emission to the environment label as per EU and UK directives and regulations, and New South Wales legislation "Protection of the Environment Operations (Noise Control) Regulation 2017". The guaranteed sound power level

of the product is specified in *Technical data on page 12* and on the label.



Cutting unit operating cycle, operation time/idle time.

Note: Other symbols/decals on the attachment refer to special certification requirements for certain markets.

Safety

Safety definitions

Warnings, cautions and notes are used to point out specially important parts of the manual.



WARNING: Used if there is a risk of injury or death for the operator or bystanders if the instructions in the manual are not obeyed.



CAUTION: Used if there is a risk of damage to the product, other materials or the adjacent area if the instructions in the manual are not obeyed.

Note: Used to give more information that is necessary in a given situation.

General power tool safety warnings



WARNING: Read all safety warnings, instructions, illustrations and specifications provided with this power tool. Failure to follow all instructions listed below may result in electric shock, fire and/or serious injury.

Save all warnings and instructions for future reference. The term "power tool" in the warnings refers to your mains-operated (corded) power tool or battery-operated (cordless) power tool.

Hedge trimmer safety warnings:

- **Keep all parts of the body away from the blade. Do not remove cut material or hold material to be cut when blades are moving. Blades continue to move after the switch is turned off. A moment of inattention**

while operating the hedge trimmer may result in serious personal injury.

- **Carry the hedge trimmer by the handle with the blade stopped and taking care not to operate any power switch.** *Proper carrying of the hedge trimmer will decrease the risk of inadvertent starting and resultant personal injury from the blades.*
- **When transporting or storing the hedge trimmer, always fit the blade cover.** *Proper handling of the hedge trimmer will decrease the risk of personal injury from the blades.*
- **When clearing jammed material or servicing the unit, make sure all power switches are off and the battery pack is removed or disconnected.** *Unexpected actuation of the hedge trimmer while clearing jammed material or servicing may result in serious personal injury.*
- **When clearing jammed material or servicing the unit, make sure all power switches are off and the lock-off is in the locked position.** *Unexpected actuation of the hedge trimmer while clearing jammed material or servicing may result in serious personal injury.*
- **Hold the hedge trimmer by insulated gripping surfaces only, because the blade may contact hidden wiring.** *Blades contacting a "live" wire may make exposed metal parts of the hedge trimmer "live" and could give the operator an electric shock.*
- **Keep all power cords and cables away from cutting area.** *Power cords or cables may be hidden in hedges or bushes and can be accidentally cut by the blade.*
- **Do not use the hedge trimmer in bad weather conditions, especially when there is a risk of lightning.** *This decreases the risk of being struck by lightning.*

Safety instructions for extended reach hedge trimmers

- **To reduce the risk of electrocution, never use the extended-reach hedge trimmer near any electrical power lines.** Contact with or use near power lines may cause serious injury or electric shock resulting in death.
- **Always use two hands when operating the extended-reach hedge trimmer.** Hold the extended-reach hedge trimmer with both hands to avoid loss of control.
- **Always use head protection when operating the extended-reach hedge trimmer overhead.** Falling debris can result in serious personal injury.

General safety instructions



WARNING: Read all safety warnings and all instructions. Failure to follow the warnings and instructions may result in electric shock, fire and/or serious injury.

- Please read the operator's manual carefully and make sure you understand the instructions before using the attachment.
- These instructions supplement the instructions that were included with the product. For other procedures, please refer to the operating instructions for the product.
- Under no circumstances may the design of the attachment be modified without the permission of the manufacturer. Do not use an attachment that appears to have been modified by others and always use original accessories. Non-authorized modifications and/or accessories can result in serious personal injury or the death of the operator or others.

Save all warnings and instructions for future reference

Safety instructions for operation

- If you encounter a situation where you are uncertain how to proceed you should ask an expert. Contact your dealer or your service workshop.
- Avoid all usage which you consider to be beyond your capability.
- **Cutting tool.** Do not touch the tool without first, switching off the engine/remove the battery.
- Never allow children to use the product.
- Ensure that no-one comes closer than 15 m while you are working.
- Never allow anyone else to use the product without first ensuring that they have understood the contents of the operator's manual.
- Never work from a ladder, stool or any other raised position that is not fully secured.

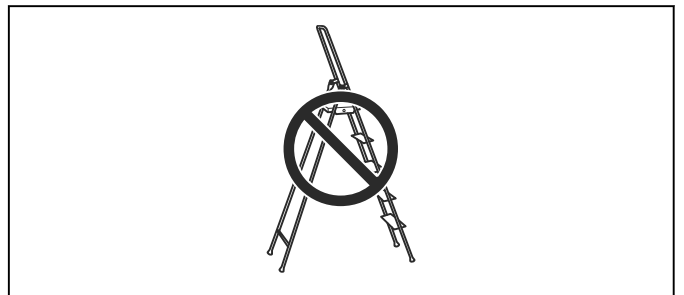

- Always ensure you have a safe and stable working position.

- Always use both hands to hold the product. Hold the product at the side of your body.

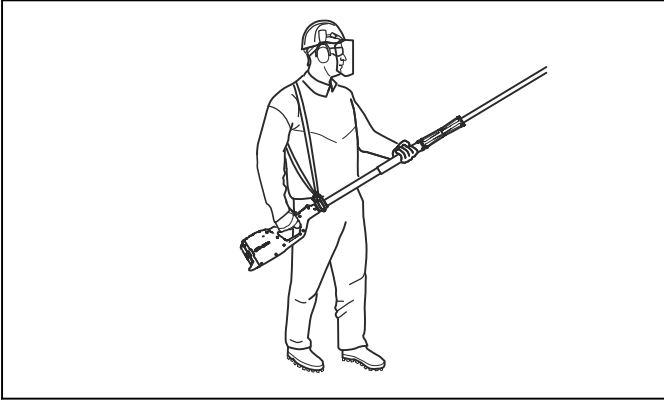

- Make sure that you connect the harness to the support hook. Only use a single harness.
- Use your right hand to control the throttle/power trigger .

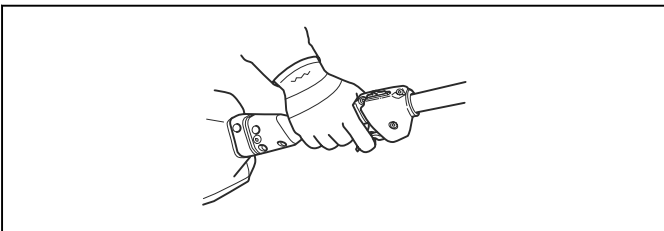

- If an emergency occurs, let go of the product and let it fall to the ground.
- Make sure that your hands and feet do not come near the cutting attachment when the engine/motor is running.
- When the engine/motor is switched off, keep your hands and feet away from the cutting attachment until it has stopped completely.
- Watch out for stumps of branches that can be thrown out during cutting.
- Always lay the product on the ground when you are not using it.
- Do not cut too close to the ground. Stones and other objects can be thrown out.
- Check the working area for foreign objects such as electricity cables, insects and animals, etc, or other objects that could damage the cutting attachment, such as metal items.
- If any foreign object is hit or if vibrations occur, stop the product immediately. If you have a gasoline operated product, disconnect the spark plug cap from the spark plug. If you have a battery operated product, remove the battery. Check that the product is not damaged. Repair any damage.
- If anything jams in the blades while you are working, stop the product immediately. If you have a gasoline operated product, switch off the engine and disconnect the spark plug cap from the spark plug. If you have a battery operated product, switch off the motor and remove the battery. Make sure the product has stopped completely before cleaning the blades.

Safety instructions for hedge trimmer attachments

- Keep all parts of the body away from the blade. Do not remove cut material or hold material to be cut when blades are moving. Blades continue to move after the switch is turned off. A moment of inattention while operating the hedge trimmer may result in serious personal injury.
- Carry the hedge trimmer by the handle with the blade stopped and taking care not to operate any power switch. Proper carrying of the hedge trimmer will decrease the risk of inadvertent starting and resultant personal injury from the blades.
- When transporting or storing the hedge trimmer, always fit the blade cover. Proper handling of the hedge trimmer will decrease the risk of personal injury from the blades.
- When clearing jammed material or servicing the unit, make sure all power switches are off and the power cord is disconnected. Unexpected actuation of the hedge trimmer while clearing jammed material or servicing may result in serious personal injury.
- Hold the hedge trimmer by insulated gripping surfaces only, because the blade may contact hidden wiring or its own cord. Blades contacting a "live" wire may make exposed metal parts of the hedge trimmer "live" and could give the operator an electric shock.
- Keep all power cords and cables away from cutting area. Power cords or cables may be hidden in hedges or bushes and can be accidentally cut by the blade.
- Do not use the hedge trimmer in bad weather conditions, especially when there is a risk of lightning. This decreases the risk of being struck by lightning.
- To reduce the risk of electrocution, never use the extended-reach hedge trimmer near any electrical power lines. Contact with or use near power lines may cause serious injury or electric shock resulting in death.
- Always use two hands when operating the extended-reach hedge trimmer. Hold the extended-reach hedge trimmer with both hands to avoid loss of control. Always use head protection when operating the extended-reach hedge trimmer overhead. Falling debris can result in serious personal injury.

Personal protective equipment



WARNING: Read the warning instructions that follow before you use the product.

- Long-term exposure to noise can result in permanent hearing impairment. Always use approved hearing protection.

- Always wear protective, non-slip boots.

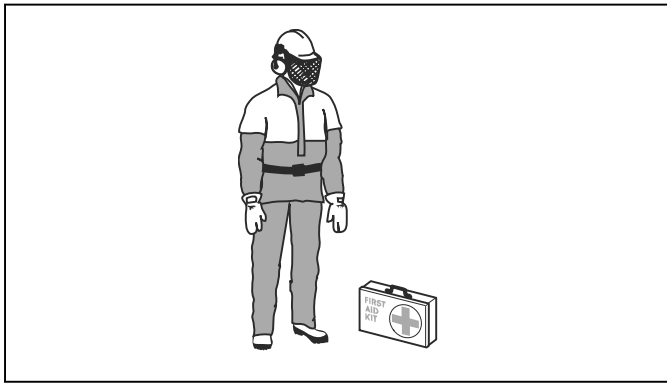

- Always wear working clothes and heavy-duty long trousers.
- Never wear loose clothing or jewellery.
- Make sure your hair does not hang below shoulder level.

Safety devices on the product



WARNING: Read the warning instructions that follow before you use the product.

In this section the product's safety features, its purpose and how checks and maintenance should be carried out to ensure that it operates correctly. See instructions under the heading *Introduction on page 2* to find where these parts are located on your product.

The life span of the product can be reduced and the risk of accidents can increase if product maintenance is not carried out correctly and if service and/or repairs are not carried out professionally. If you need further information please contact your nearest servicing dealer.



WARNING: Never use a product with damaged safety components. The product's safety equipment must be inspected and maintained as described in this section. If your product fails any of these checks, contact your service agent to get it repaired.



CAUTION: All servicing and repair work on the machine requires special training. This is especially true of the machine's safety equipment. If your machine fails any of the checks described below you must contact your service agent. When you buy any of our products we guarantee the availability of professional repairs and service. If the retailer who sells your machine is not a servicing dealer, ask him for the address of your nearest service agent.

To do a check of the hand guard (HA200, for gasoline products only)

The hand guard prevents hands from coming in contact with the moving blades, for example, if the operator loses grip on the front handle.

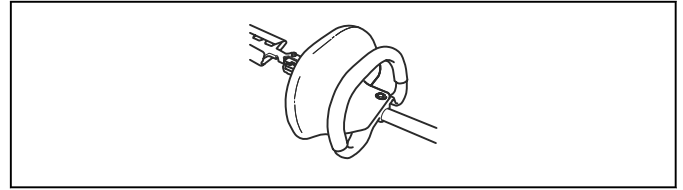

1. Check that the hand guard is fitted correctly.
2. Check that the hand guard is undamaged.

To do a check of the blades

To ensure good cutting results it is important that the contact pressure between the blades is correct.

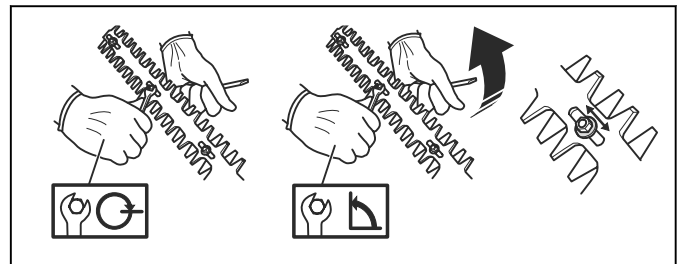

1. The contact pressure is adjusted by turning the screws on the underside of the bar clockwise as far as they will go.
2. Then turn the screws anticlockwise a 1/4 turn.
3. Lock the screws using the locking nut on the top of the bar.
4. Check that the screws are loose enough to allow the washers under the screw heads to slide sideways.
5. When the blades are correctly adjusted the play between the blades should be 0,2–0,4 mm, measured at the screws.
6. The edges of the blades are too hard to be filed. Dull blades should be sharpened using a grinder.
7. Replace the blades if they are bent or damaged.

Hot surface

The gear housing gets hot when the product has been in use. Do not touch the gear housing to avoid burning yourself.

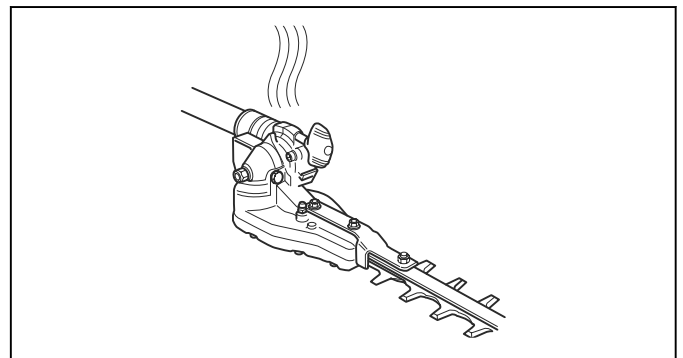

Safety instructions for maintenance

Read the warning instructions that follow before you use the product.

- Always stop the product before you work on any part of the cutting equipment. If you have a gasoline operated product, disconnect the spark plug cap from the spark plug. If you have a battery operated product, remove the battery. Check that the cutting equipment has stopped completely before you start any work on it.
- The transport guard should always be fitted to the cutting attachment when the product is not in use.
- Make sure the cutting attachment has stopped before cleaning, carrying out repairs or an inspection. If you have a gasoline operated product,

disconnect the spark plug cap from the spark plug. If you have a battery operated product, remove the battery.

- Always wear heavy-duty gloves when repairing the cutting attachment. This is extremely sharp and can easily cause cuts.

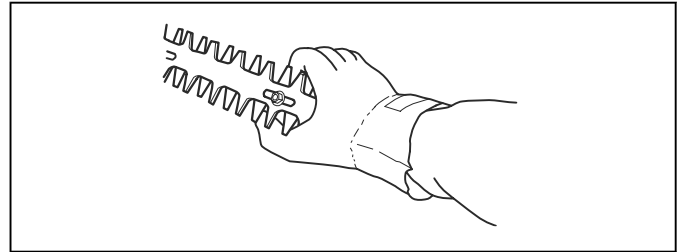

- Store the product out of reach of children.
- Use only original spare parts for repairs.

Assembly

To install the handguard (HA200) (only for gasoline operated products)

1. Install the handguard with the screw and the knob .

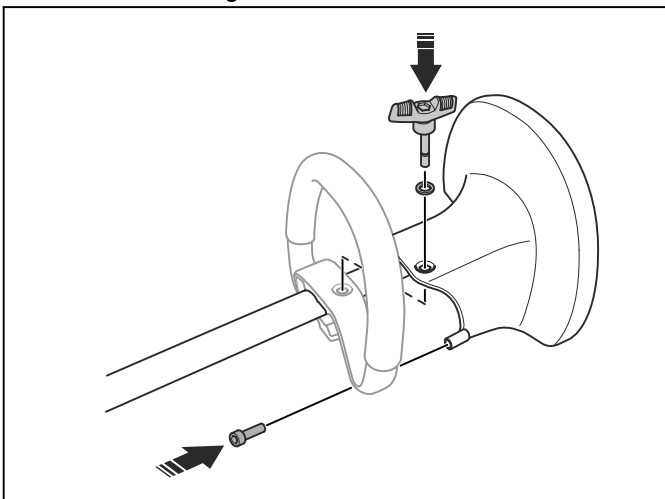

To install the harness support hook (HA860)

1. Remove the screw to release the holder of the harness support hook.

2. Put the harness support hook between the throttle handle and the loop handle.

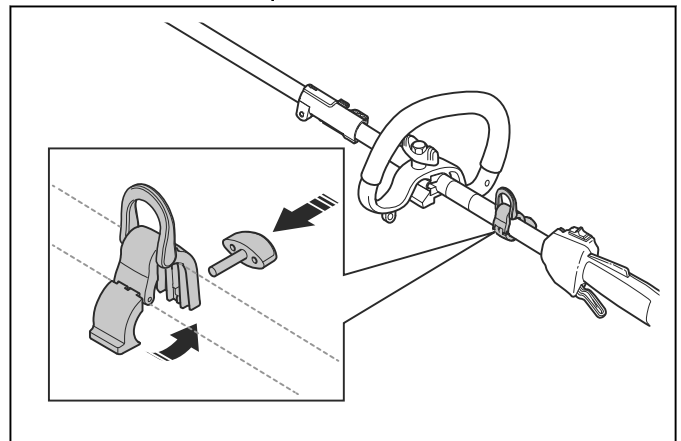

3. Install the screw to attach the harness support hook.
4. Adjust the position of the harness support hook until the product is balanced and easy to use.

Operation

To do before you operate the product

- Examine the work area and remove loose objects.
- Do a check of the cutting unit. Refer to *To do a check of the blades on page 7*.
- Make sure that the gear housing is correctly lubricated.
- Make sure that the safety devices of the product operates correctly. Do not use the product without all safety devices installed correctly.
- Make sure that all screws and nuts are tight.

- Make sure that all covers are attached correctly and not damaged before you start the product.
- Make sure that the cutting unit stops when the engine is at idle speed.

To do a check before start

1. Examine the work area. Remove any objects that could be thrown out.
2. Examine the cutting attachment. Do not use blades that are damaged.

3. Examine that the product is in perfect working order. Examine that all nuts and screws are tight.
4. Make sure the gear housing is lubricated correctly. See *To lubricate the bevel gear and gearbox on page 11* for instructions.
5. Examine that the cutting attachment stops when the throttle/power trigger is released.
6. Only use the product for the purpose it was intended for.
7. Make sure that the handle and safety features are in good working order. Never use a product that lacks a part or has been modified outside its specifications.

To operate the product

1. Start near the ground and move the product up along the hedge when you cut the sides.

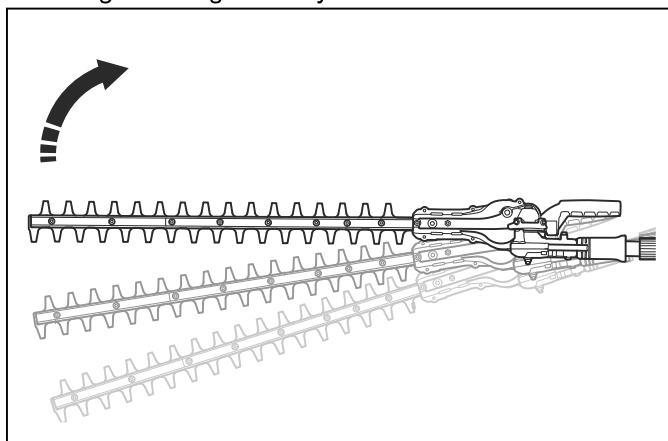

2. Adjust the speed to align with the work load.
3. Make sure that the motor does not touch the hedge.
4. Hold the product near your body for a stable work position.
5. Make sure that the end of the cutting equipment does not touch the ground.

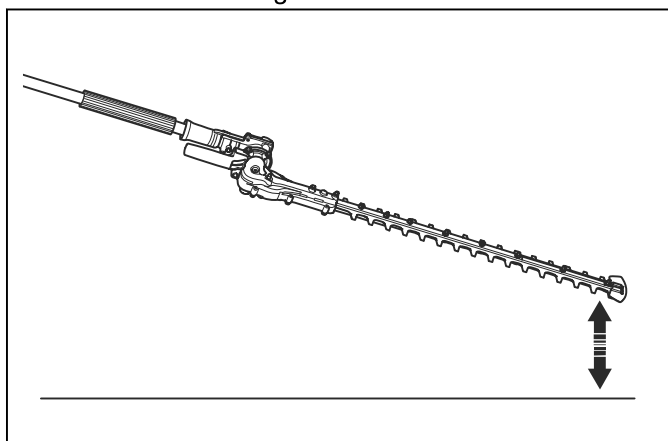

6. Be careful and work slowly until all the branches are correctly cut.

To adjust the angle of the cutting unit

The cutting unit can be adjusted in 10 different positions.



WARNING: Do not operate the cutting unit when you adjust the angle.

1. Let the engine/motor run at idle speed and make sure the cutting unit does not move.
2. Pull down the position adjustment handle.

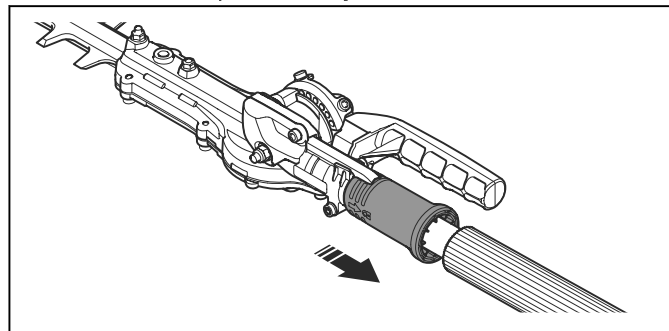

3. Tilt the cutting unit to the correct position. Use 1 of the procedures that follow.

a) Use the handle.

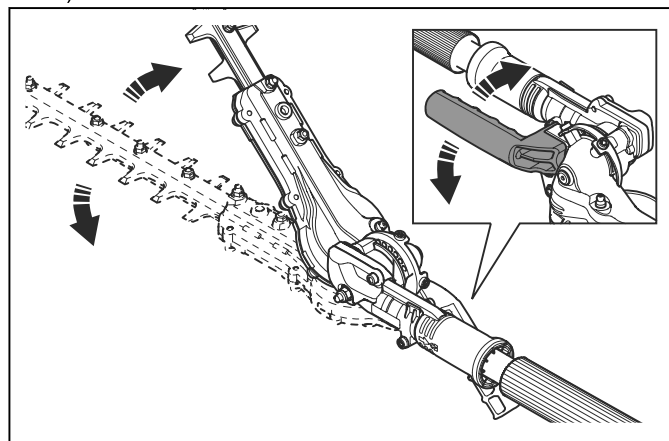

b) Push the end of the cutting unit against a stable surface.

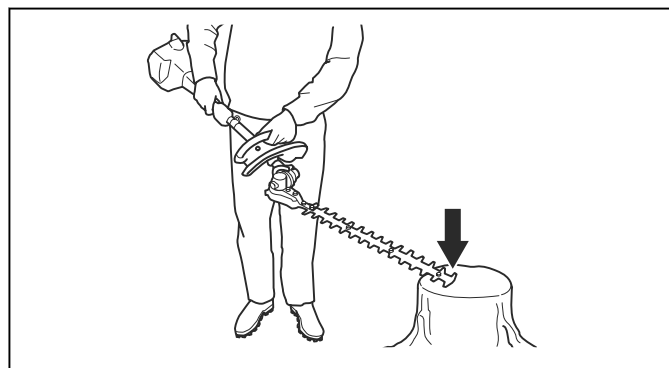

4. Release the position adjustment handle to lock the cutting unit.
5. Push the cutting unit against the hedge to make sure that it is locked.

To adjust the friction for angle adjustment



WARNING: Do not operate the cutting unit when you adjust the friction.

1. Push the stop switch to stop the product.
2. Install the transport guard on the cutting unit
3. Pull down the position adjustment handle.
4. Tilt the cutting unit to the applicable position.

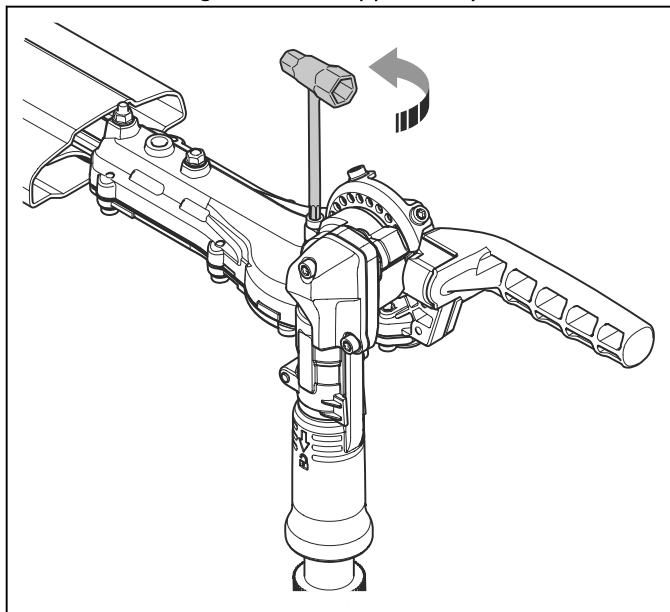

5. Adjust the screw to set the friction.
6. Set the cutting unit in different positions to try the friction.

To disassemble the product for transport



WARNING: Do not start the product when the product is in transport position.

1. Push the stop switch to stop the product.
2. Install the transport guard on the cutting attachment.
3. Turn the knob (A) to loosen the coupling.

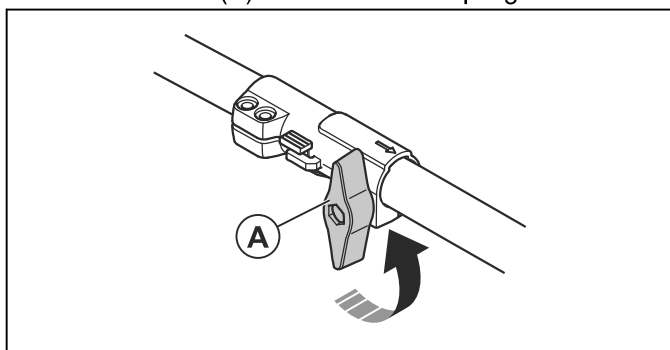

4. Push and hold the button (B).

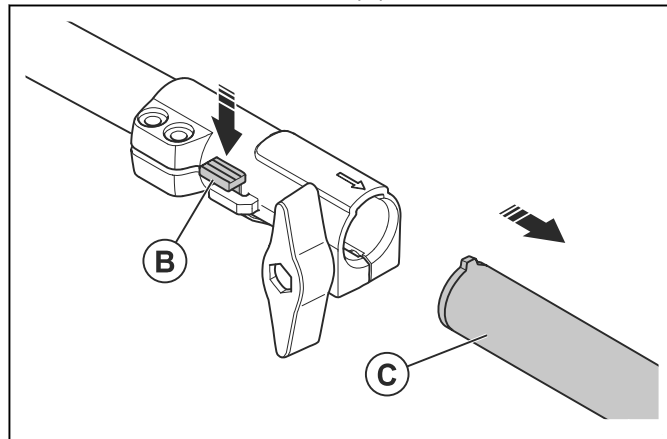

5. Pull the cutting attachment (C) straight out of the coupling.
6. Make sure that the cutting attachment and the product can not move during transportation.

To set the product in transport position



WARNING: Do not start the product when the product is in transport position.

1. Push the stop switch to stop the product.
2. Install the transport guard on the cutting unit.
3. Pull down the position adjustment handle.
4. Fold the cutting unit to make it parallel to the shaft.

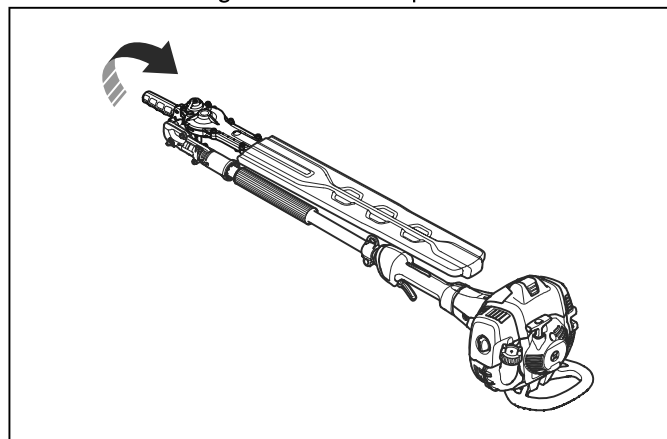

Maintenance

Introduction

Below you will find some general maintenance instructions. If you need further information please contact your service workshop.

To perform maintenance on the attachment

To do daily maintenance

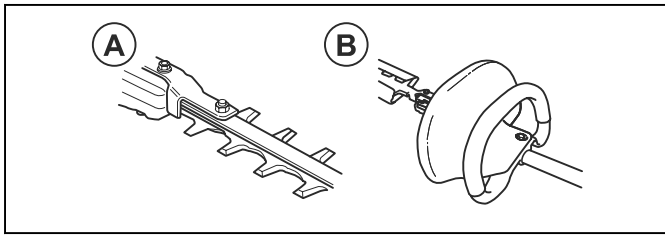

1. Examine that the blades (A) do not move when the throttle/power trigger is released or when the choke is in the start position.
2. Examine that the hand guard (B) (applicable for HA200 with gasoline powered units) is not damaged. Replace the guard if necessary.

To do general maintenance

To lubricate the bevel gear and gearbox



WARNING: To prevent burn injuries, let the product become cool before you touch the bevel gear and gearbox.

Note: New products are first filled with grease after approximately 20 hours of operation.

- Use special grease. Speak to your servicing dealer for more information.
- Add the grease through the grease nipple.

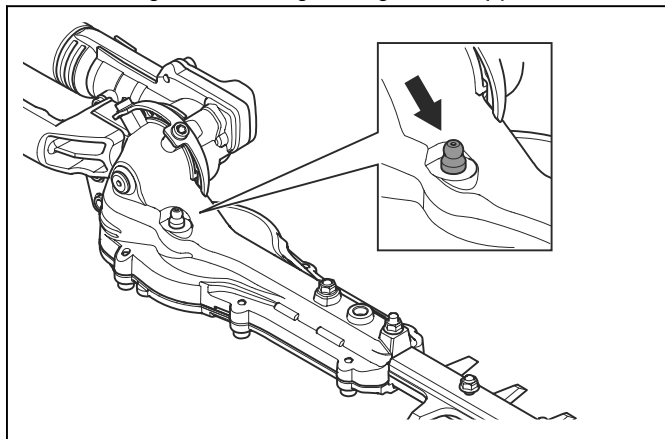

CAUTION: Do not fill the gearbox fully.

To clean and lubricate the blades

1. Clean the blades from unwanted materials before and after you use the product.
2. Lubricate the blades before long periods of storage.

Note: Speak to your servicing dealer for more information about recommended cleaning agents and lubricants.

To examine the blades

1. Remove the screw from the gearbox.

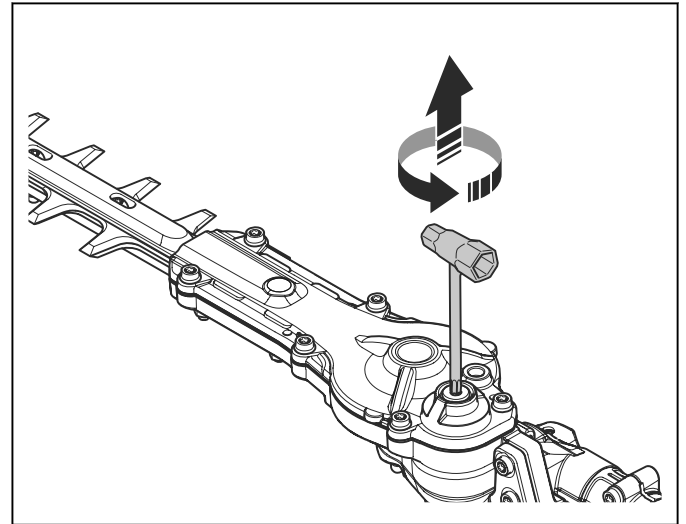

2. Put the combination wrench in the gearbox and turn clockwise and counterclockwise. Make sure that the blades move freely.

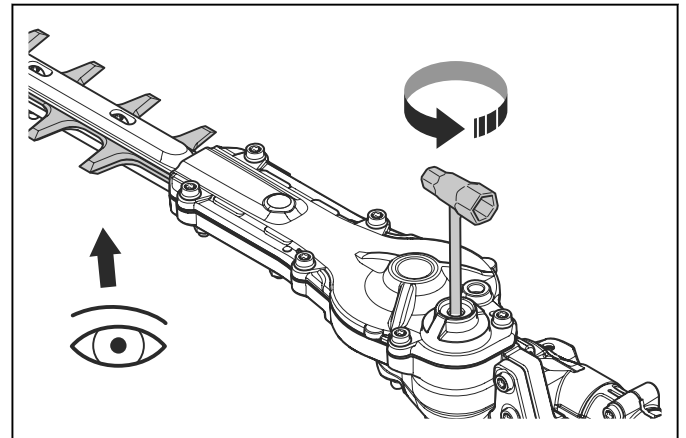

3. Examine the edges of the blades for damages and deformation.
4. Use a file to remove burrs on the blades.
5. Install in the opposite sequence.

Technical data

Technical data for gasoline operated product

	HA200	HA860
Weight		
Weight, kg	2.4	2.7
Blades		
Type	Double-sided	Double-sided
Cutting length, mm	600	600
Cutting speed, cuts/min	4400	4400
Noise emissions		
Sound power level, measured dB (A)	109	110
Sound power level, guaranteed L_{WA} dB (A)	110	110
Noise levels ¹		
Equivalent sound pressure level at the operator's ear, measured according to EN15503 dB(A)		
Equipped with approved accessory (original)	97	96
Vibration levels ²		
Equivalent vibration levels ($a_{hv,eq}$) at handles, measured according to EN ISO 22867, m/s^2		
Equipped with approved accessory (original), left/right	9.4/5.3	7.5/5.5

Technical data for battery operated product

	325iLK+HA860	525iLK+HA860
Weight		
Weight, kg	3.7+2.7	3.7+2.7
Blades		
Type	Double sided	Double sided
Cutting length, mm	600	600
Cutting speed, cuts/min	4000	4000
Noise emissions		

¹ Reported data for equivalent sound pressure level for the machine has a typical statistical dispersion (standard deviation) of 1 dB(A).

² Reported data for equivalent vibration level has a typical statistical dispersion (standard deviation) of 1 m/s^2 .

	325iLK+HA860	525iLK+HA860
Sound power level, measured dB (A)	95	95
Sound power level, guaranteed L_{WA} dB (A)	97	97
Noise levels ³		
Sound pressure level at the operator's ear, measured according to EN 62841-4-2 dB(A)		
Equipped with approved accessory (original)	84	84
Vibration levels ⁴		
Vibration levels ($a_{hv,eq}$) at handles, measured according to EN 62841-4-2, m/s^2		
Equipped with approved accessory (original), left/right	3.2/2.6	3.2/2.6

³ Reported data for equivalent sound pressure level for the machine has a typical statistical dispersion (standard deviation) of 1 dB(A).

⁴ Reported data for equivalent vibration level has a typical statistical dispersion (standard deviation) of 1 m/s^2 .

Declaration of Conformity

EU Declaration of Conformity

We, **Husqvarna AB**, SE-561 82 Huskvarna, Sweden, tel:
+46-36-146500, declare on our sole responsibility that
the product:

Description	Hedge trimmer attachments
Brand	Husqvarna
Type / Model	HA200, HA860
Identification	Serial numbers dating from 2022 and onwards

complies fully with the following EU directives and
regulations:

Directive / Regulation	Description
2006/42/EC	"relating to machinery"
2014/30/EU	"relating to electromagnetic compatibility"
2000/14/EC	"relating to the noise emissions in the environment"
2011/65/EU	"on the restriction of the use of certain hazardous substances in electrical and electronic equipment"

and that the following standards and/or technical
specifications are applied: EN ISO 12100:2010, EN ISO
14982:2009, EN IEC 63000:2018

RISE SMP Svensk Maskinprovning AB, Box 7035,
SE-750 07 Uppsala has performed voluntary type
examination on behalf of Husqvarna AB.

Certificate number: SEC/20/2548

For information relating to noise emissions, see the
*Technical data for gasoline operated product on page
12.*

Huskvarna, 2022-03-14

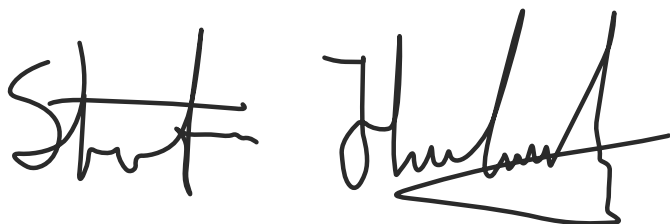

Stefan Holmberg, R&D Director, Technology
Management, Husqvarna AB

Responsible for technical documentation



UK Declaration of Conformity

We, **Husqvarna AB**, SE-561 82 Huskvarna, Sweden, tel: +46-36-146500, declare on our sole responsibility that the product:

Description	Hedge trimmer attachments
Brand	Husqvarna
Type / Model	HA200, HA860
Identification	Serial numbers dating from 2022 and onwards

complies fully with the following UK regulations:

Description
The Supply of Machinery (Safety) Regulations 2008
Electromagnetic Compatibility Regulations 2016
The Noise Emission in the Environment by Equipment for use Outdoors Regulations 2001
The Restriction of the Use of Certain Hazardous Substances in Electrical and Electronic Equipment Regulations 2012

and that the following standards and/or technical specifications are applied: EN ISO 12100:2010, EN ISO 14982:2009, EN IEC 63000:2018.

For information relating to noise emissions, see the *Technical data for gasoline operated product on page 12.*

Huskvarna, 2022-03-14

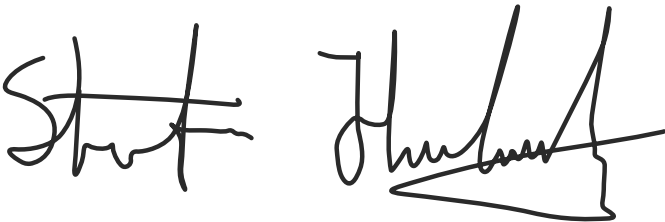

Stefan Holmberg, R&D Director, Technology Management, Husqvarna AB

Responsible for technical documentation

**UK
CA**

UK Importer:
Husqvarna UK Ltd
Preston Road, Co. Durham
DL5 6UP

EU Declaration of Conformity

We, **Husqvarna AB**, SE-561 82 Huskvarna, Sweden, tel:
+46-36-146500, declare on our sole responsibility that
the product:

Description	Battery Hedge trimmer attachments
Brand	Husqvarna
Type / Model	HA860
Identification	Serial numbers dating from 2022 and onwards

complies fully with the following EU directives and
regulations:

Directive / Regulation	Description
2006/42/EC	"relating to machinery"
2014/30/EU	"relating to electromagnetic compatibility"
2000/14/EC	"relating to the noise emissions in the environment"
2011/65/EU	"on the restriction of the use of certain hazardous substances in electrical and electronic equipment "

and that the following standards and/or technical
specifications are applied: EN ISO 12100:2010, EN IEC
63000:2018, EN 62841-4-2:2019

RISE SMP Svensk Maskinprovning AB, Box 7035,
SE-750 07 Uppsala has performed voluntary type
examination on behalf of Husqvarna AB.

Certificate number: SEC/20/2548

For information relating to noise emissions, see the
Technical data for battery operated product on page 12.

Huskvarna, 2022-03-14

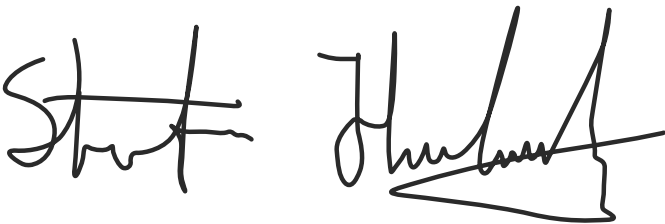

Stefan Holmberg, R&D Director, Technology
Management, Husqvarna AB

Responsible for technical documentation



UK Declaration of Conformity

We, **Husqvarna AB**, SE-561 82 Huskvarna, Sweden, tel:
+46-36-146500, declare on our sole responsibility that
the product:

Description	Battery Hedge trimmer attachments
Brand	Husqvarna
Type / Model	HA860
Identification	Serial numbers dating from 2022 and onwards

complies fully with the following UK regulations:

Description
The Supply of Machinery (Safety) Regulations 2008
Electromagnetic Compatibility Regulations 2016
The Noise Emission in the Environment by Equipment for use Outdoors Regulations 2001
The Restriction of the Use of Certain Hazardous Substances in Electrical and Electronic Equipment Regulations 2012

and that the following standards and/or technical
specifications are applied: EN ISO 12100:2010, EN IEC
63000:2018, EN 62841-4-2:2019.

For information relating to noise emissions, see the
Technical data for battery operated product on page 12.

Huskvarna, 2022-03-14

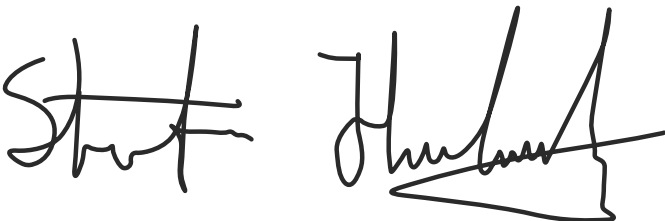

Stefan Holmberg, R&D Director, Technology
Management, Husqvarna AB

Responsible for technical documentation



UK Importer:
Husqvarna UK Ltd
Preston Road, Co. Durham
DL5 6UP