

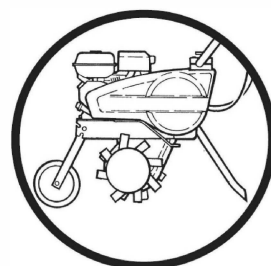

EN Operating manual
DE Benutzerhandbuch
FR Manuel d'utilisation

M3000063103-20

ES Manual de uso
IT Istruzioni per l'uso
NL Gebruikshandleiding



TF325

TF 325

EN	User manual	<i>(Translation of the original manual)</i>
	MOTOR HOE	 Read the instructions in the user manual. Become familiar with the operation and controls of the machine.
DE	Benutzerhandbuch	<i>(Übersetzung der Originalbetriebsanleitung)</i>
	MOTORHACKE	 Die Anweisungen im Benutzerhandbuch durchlesen. Sich mit den Funktionen und Bedienelementen der Maschine vertraut machen.
FR	Manuel d'utilisation	<i>(Notice originale)</i>
	MOTOBINEUSE	 Lire les instructions du manuel utilisateur. Se familiariser avec le fonctionnement et les commandes de la machine.

ES	Manual de uso	<i>(Traducción del manual original)</i>
	MOTOAZADA	 Leer las instrucciones del manual del usuario. Familiarizarse con el funcionamiento y los mandos de la máquina.
IT	Manuale di istruzioni	<i>(Traduzione delle istruzioni originali)</i>
	MOTOZAPPA	 Leggere le istruzioni contenute nel manuale per l'utente. Informarsi sul funzionamento e sui comandi della macchina.
NL	Gebruikshandleiding	<i>(Vertaling van de originele handleiding)</i>
	MOTORHAKFREES	 Lees de instructies van de gebruikershandleiding. Maak u vertrouwd met de werking en de bedieningselementen van de machine.



1.1

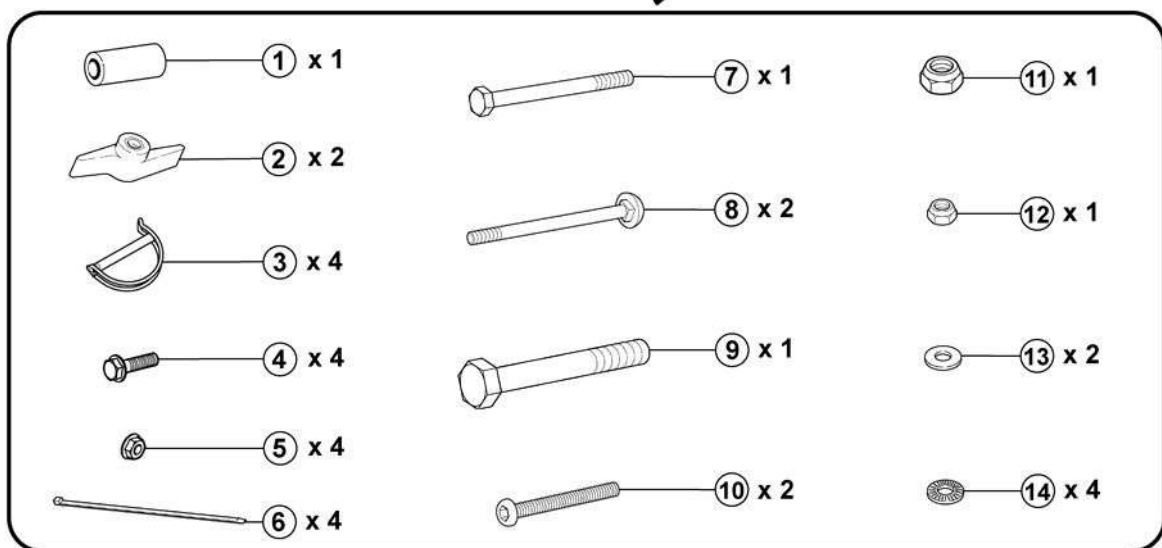
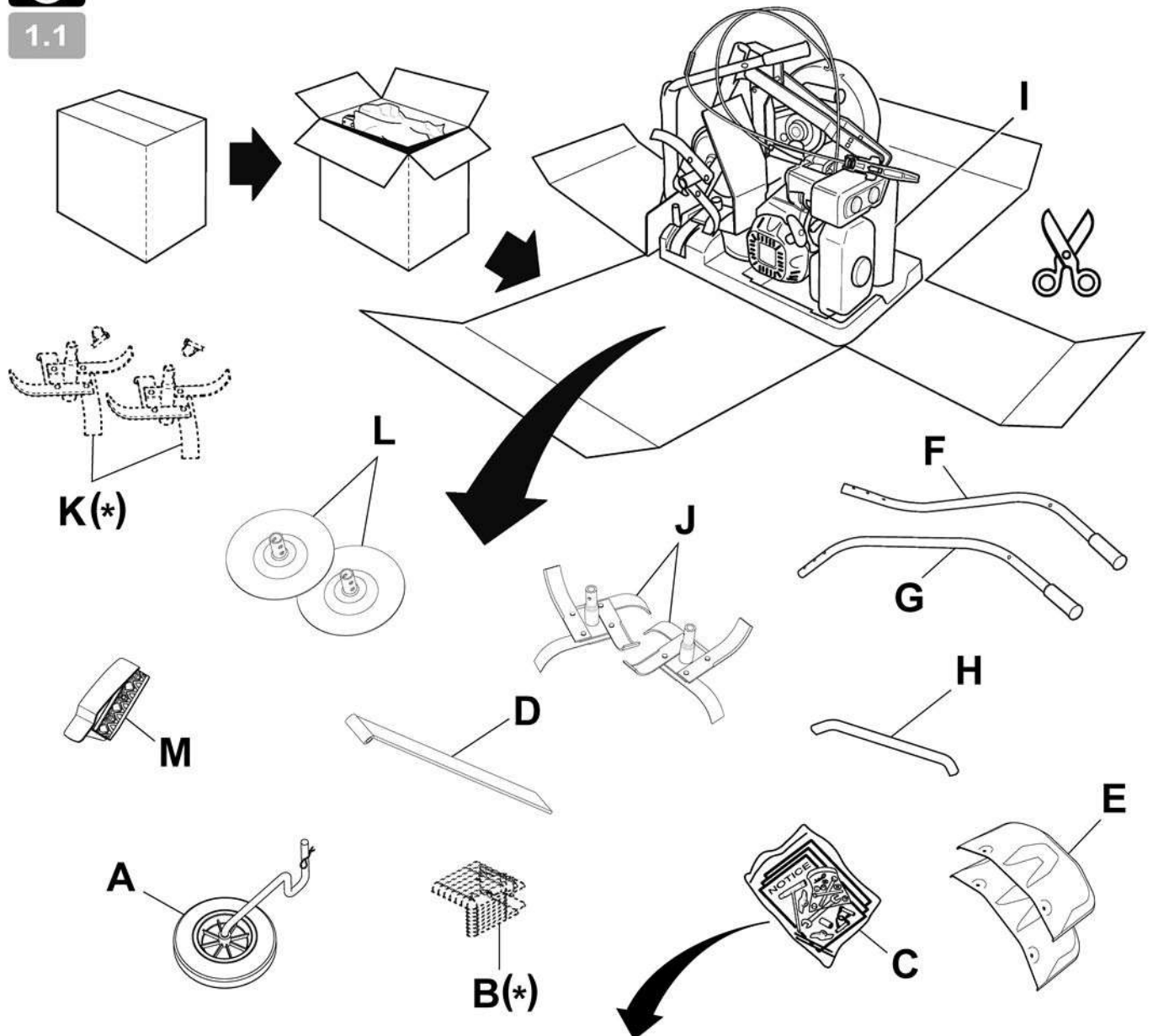

(*) : FR : (suivant version) - EN : (depending on the version) - DE : (je nach Ausführungsvariante) - BG : (според варианта)
HR : (ovisno o verziji) - DA : (Afhængigt af version) - ES : (Según versión) - ET : (järgmine versioon) - FI : (mallista riippuen)
EL : (ανάλογα με το μοντέλο) - HU : (verziótól függően) - IT : (A seconda del modello) - LV : (atkarībā no versijas)
LT : (priklausomai nuo versijos) - NL : (Naar gelang model) - NO : (Avhengig av versjon) - PL : (Zależnie od wersji)
PT : (Consoante versão) - RO : (În funcție de versiune) - TR : (versiyona göre) - SK : (v závislosti od verzie) - SL : (odvisno od verzije)
SV : (beroende på version) - CZ : (v závislosti na provedení) - UK : (в залежності від версії) - RU : (В зависимости от модификации)



1.2

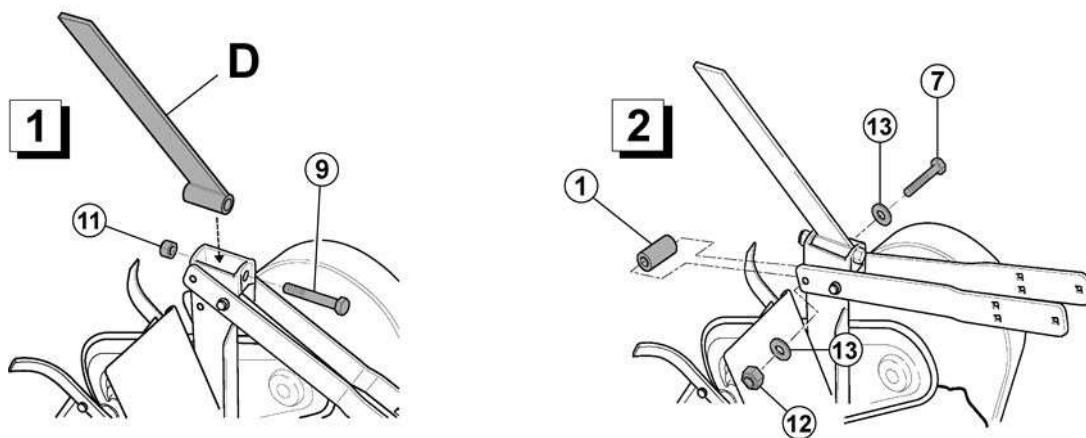

1.3

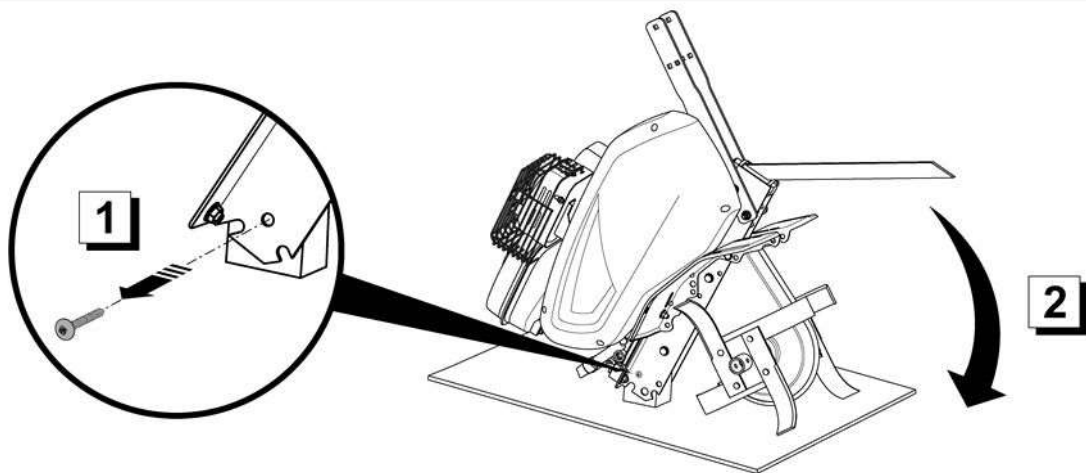

1.4

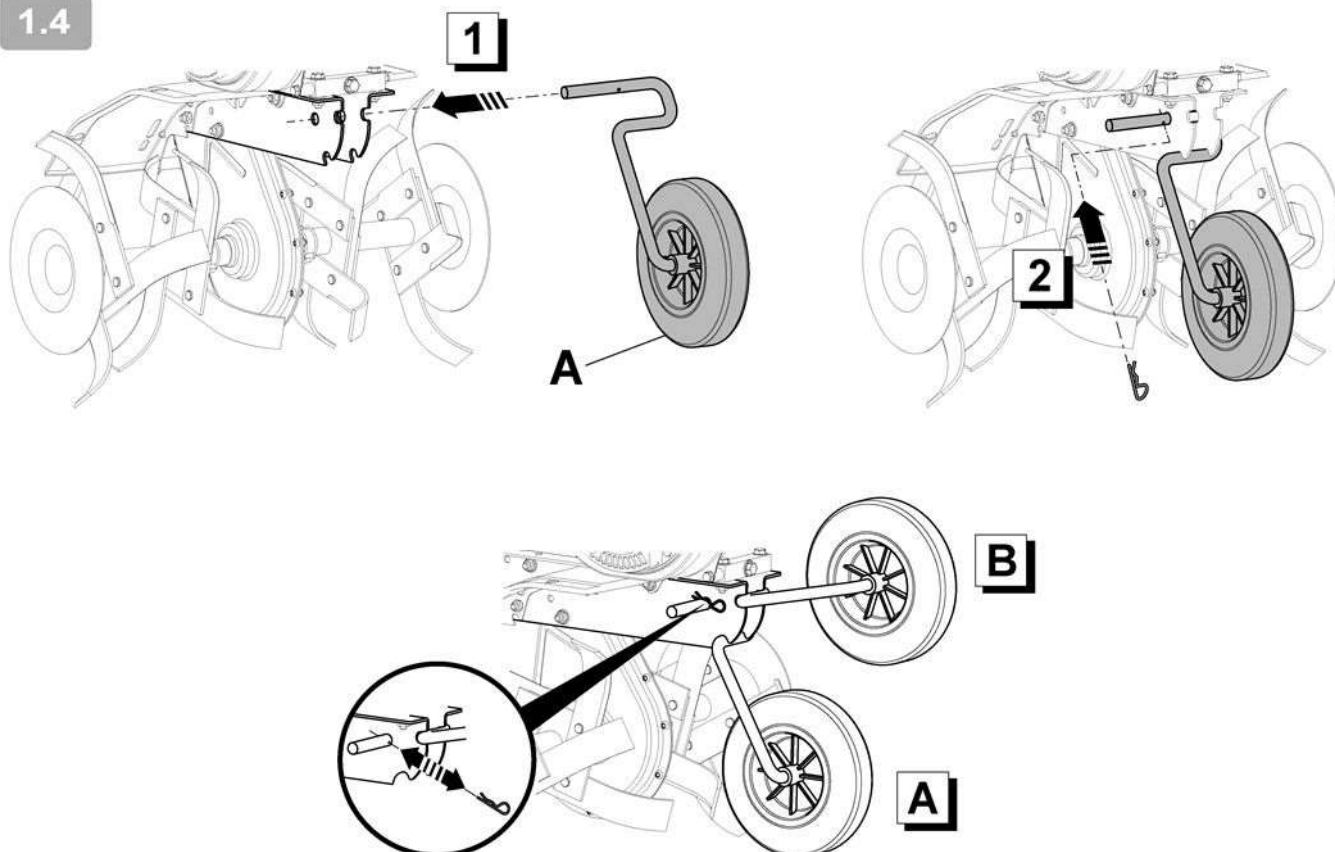

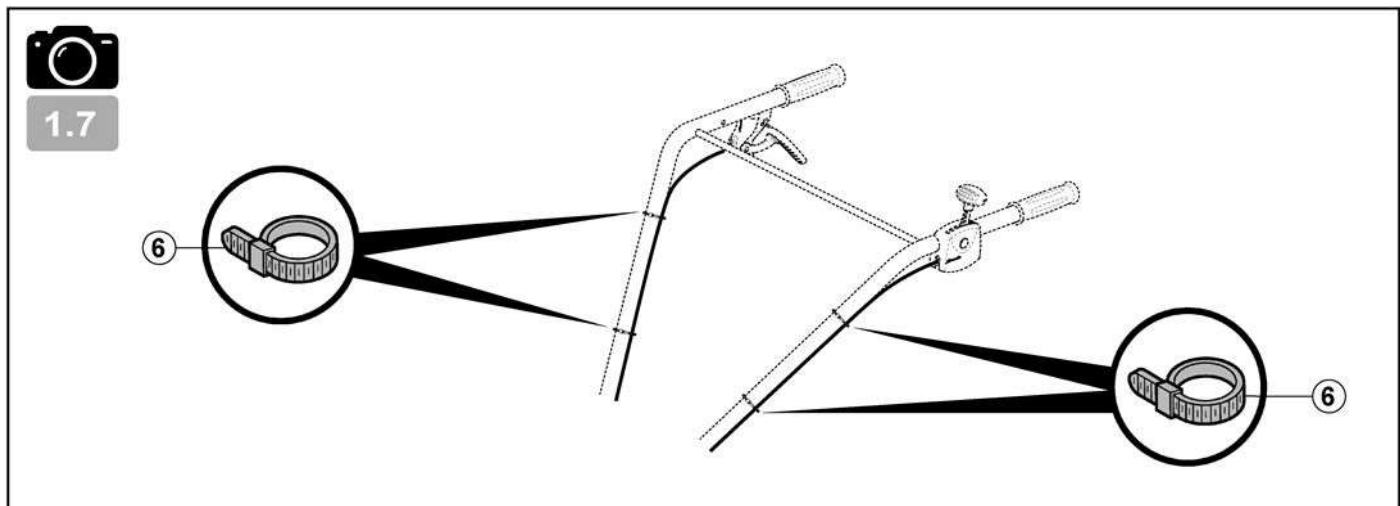
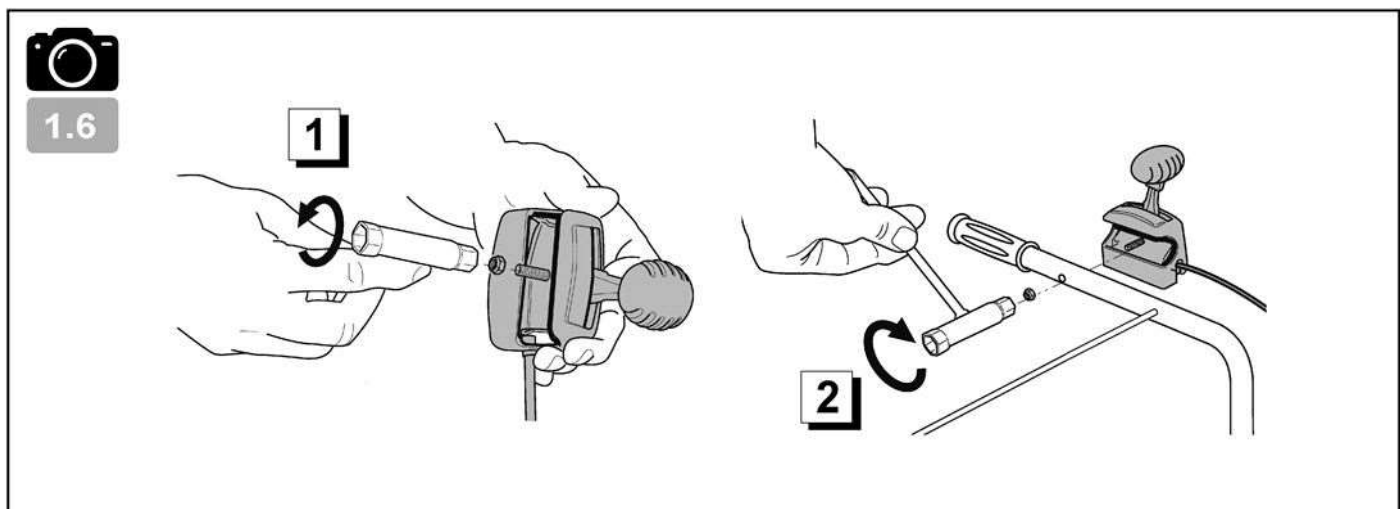
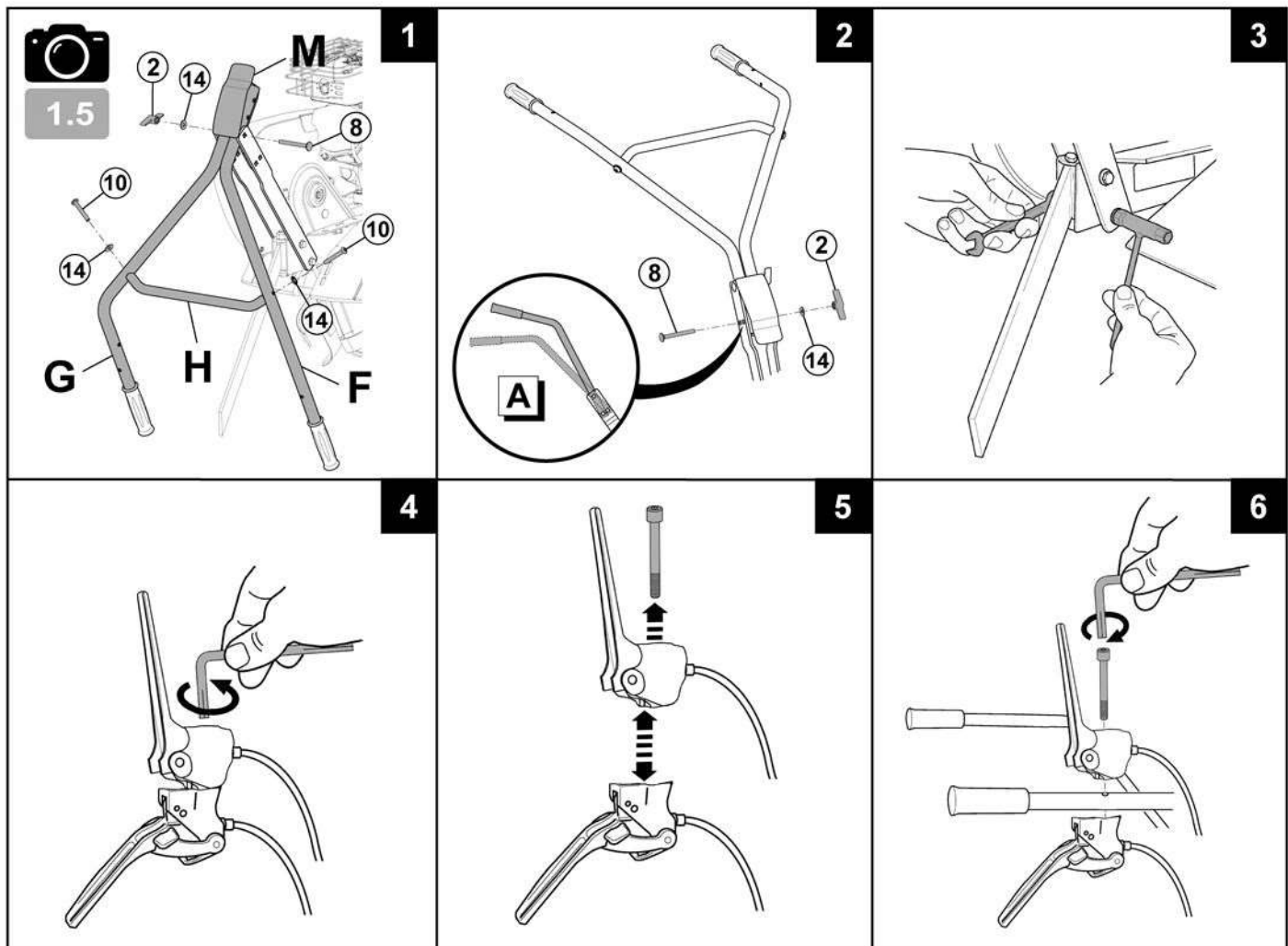



1.8

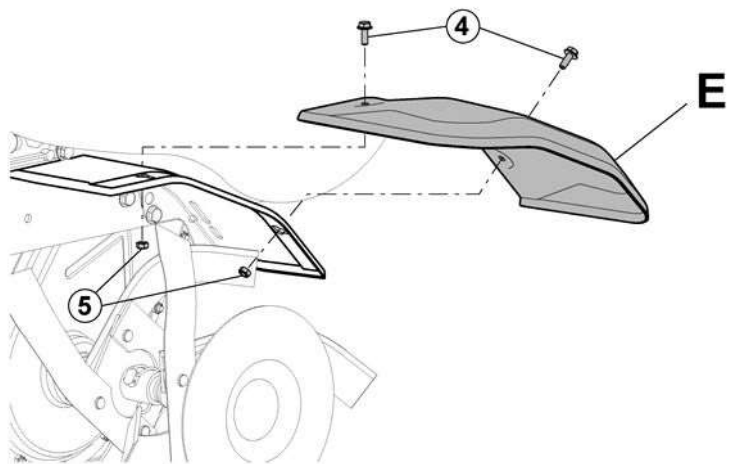

1.9

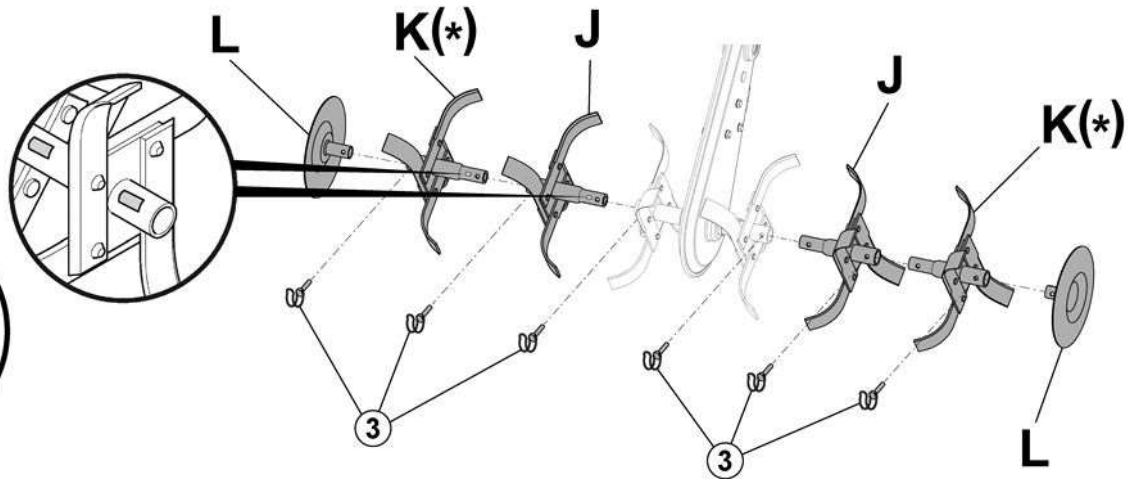

1.10

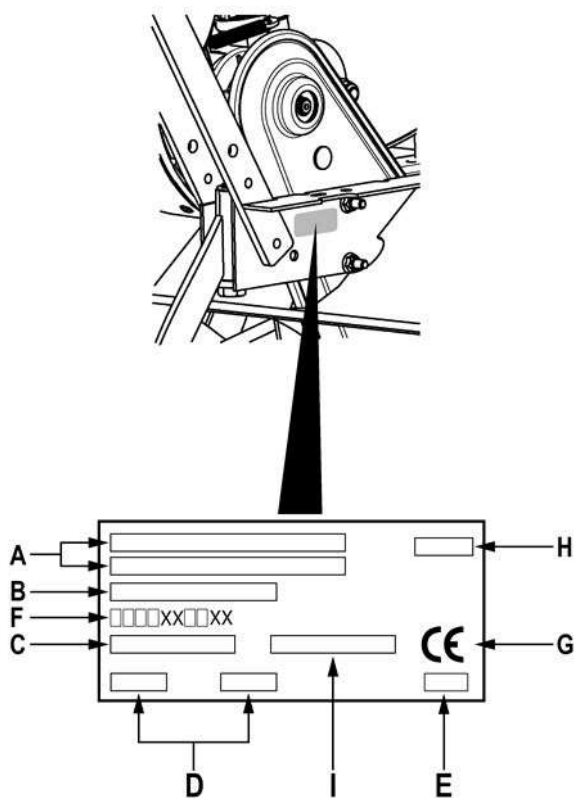

1.11

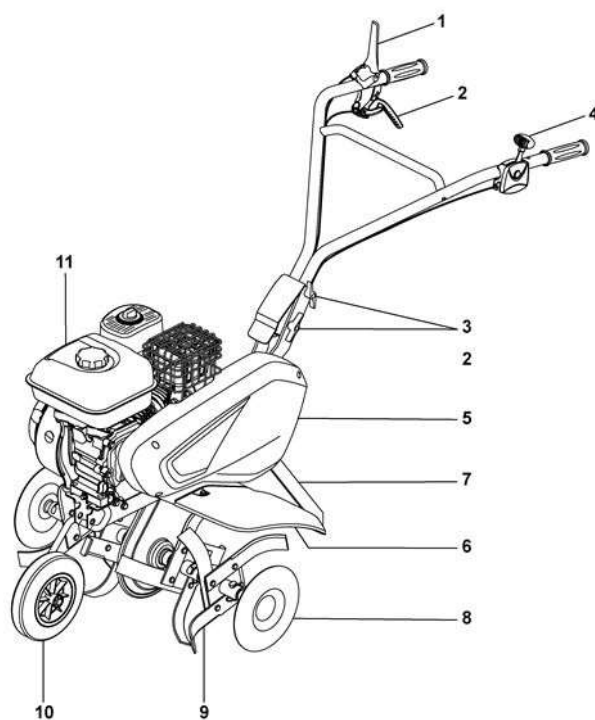

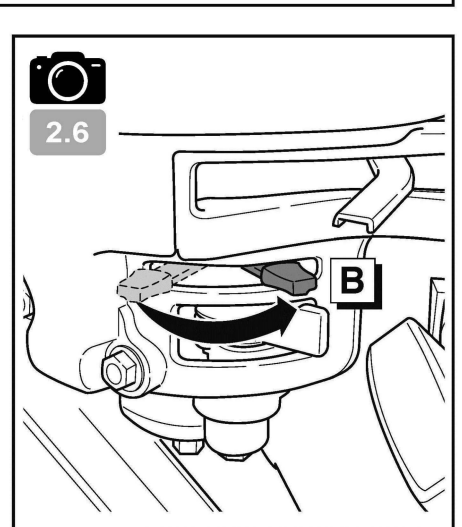
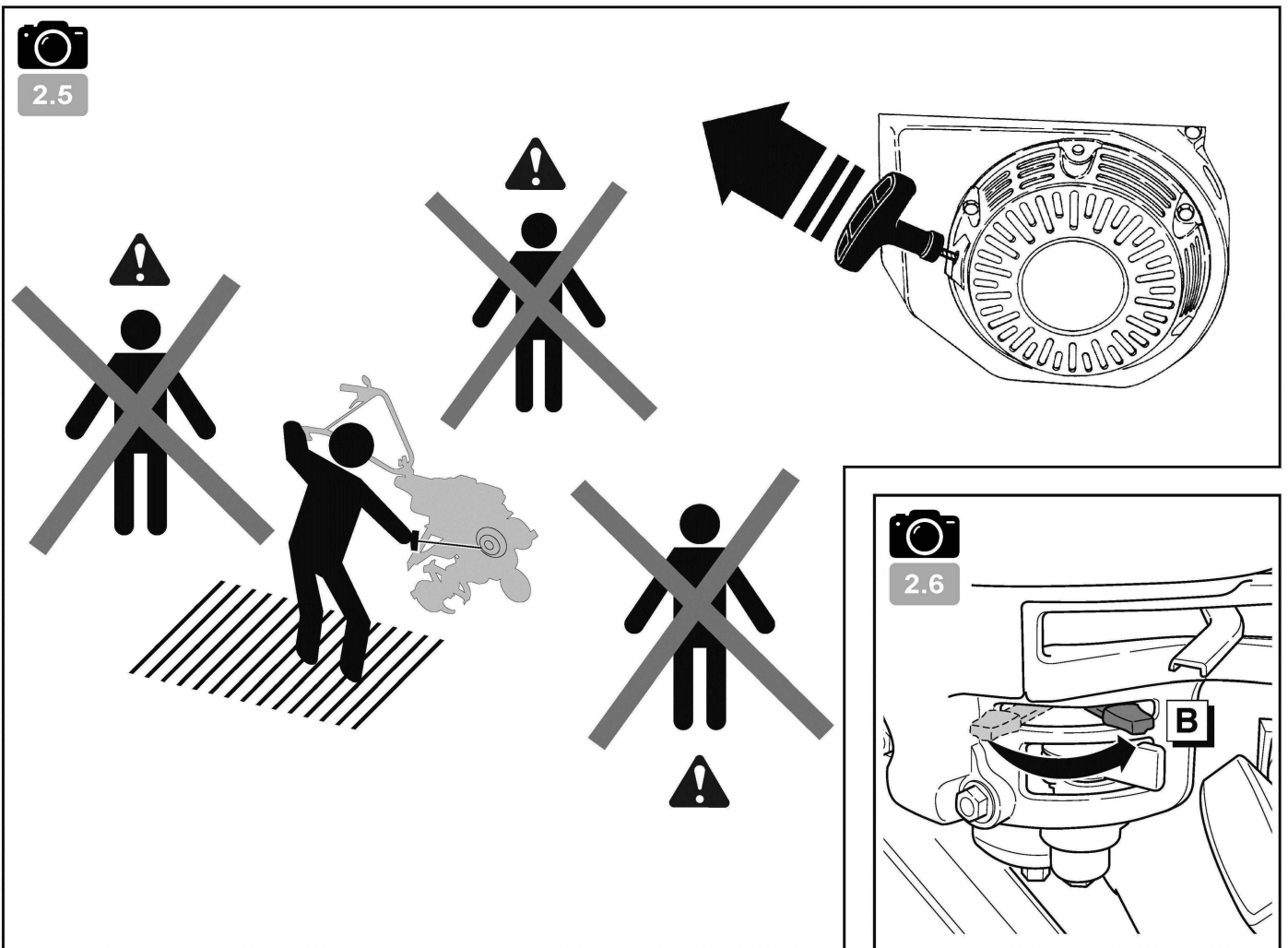
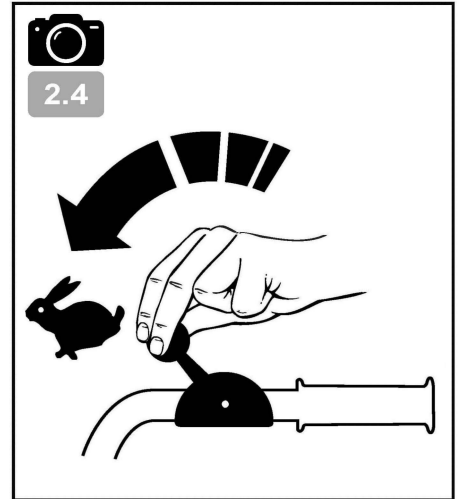
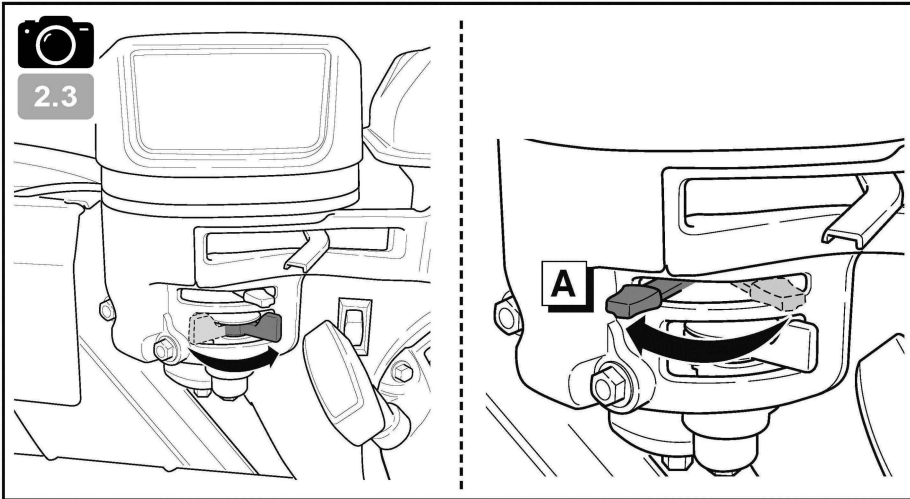
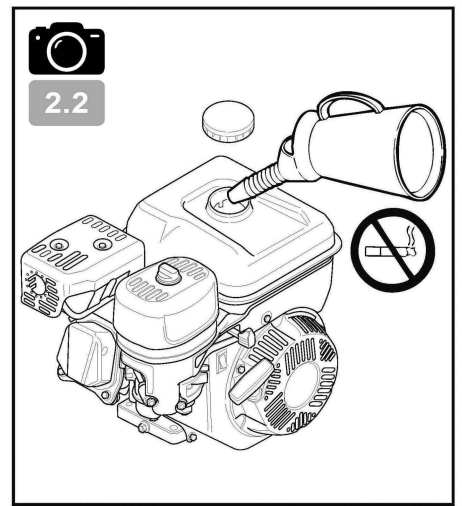
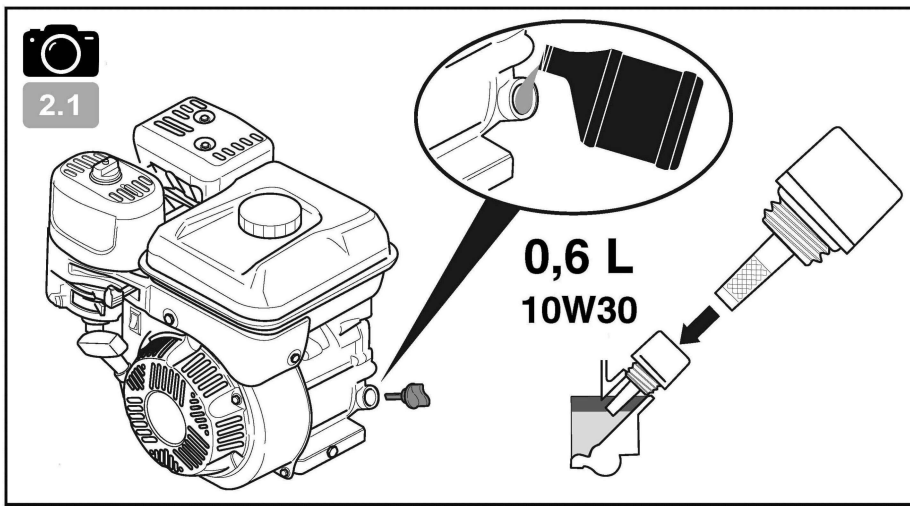



3.1

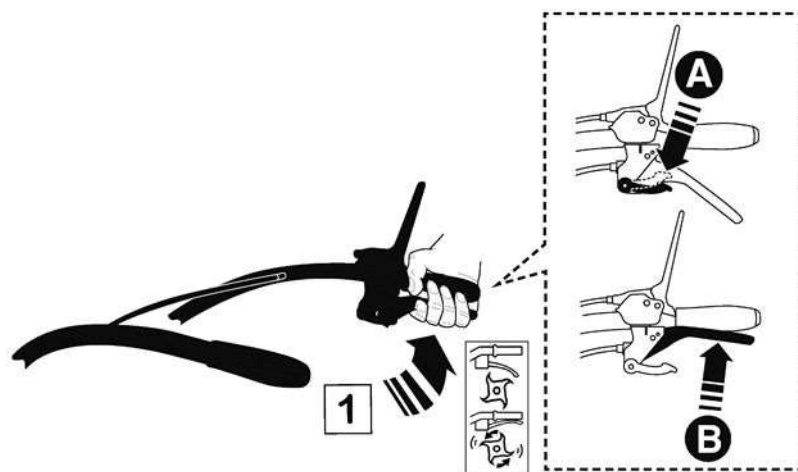
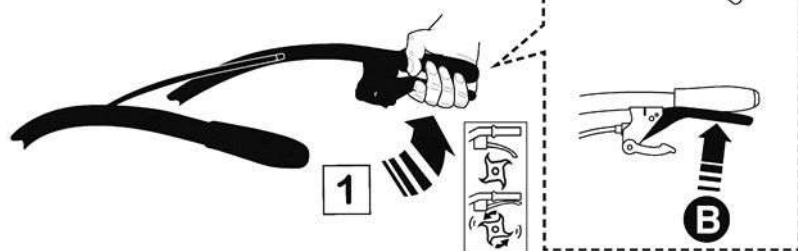

3.2

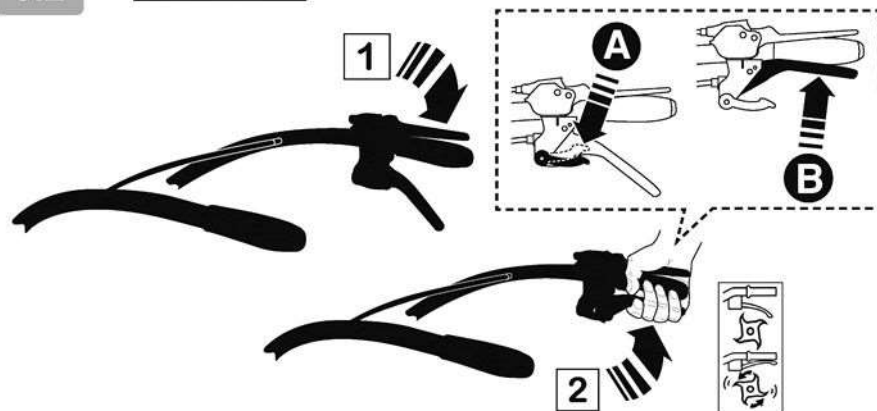

(*) : FR : (suivant version) - EN : (depending on the version) - DE : (je nach Ausführungsvariante) - BG : (според варианта)
 HR : (ovisno o verziji) - DA : (Afhængigt af version) - ES : (Según versión) - ET : (järgmine versioon) - FI : (mallista riippuen)
 EL : (ανάλογα με το μοντέλο) - HU : (verziótól függően) - IT : (A seconda del modello) - LV : (atkarībā no versijas)
 LT : (priklausomai nuo versijos) - NL : (Naar gelang model) - NO : (Avhengig av versjon) - PL : (Zależnie od wersji)
 PT : (Consoante versão) - RO : (În funcție de versiune) - TR : (versiyona göre) - SK : (v závislosti od verzie) - SL : (odvisno od verzije)
 SV : (beroende på version) - CZ : (v závislosti na provedení) - UK : (в залежності від версії) - RU : (В зависимости от модификации)

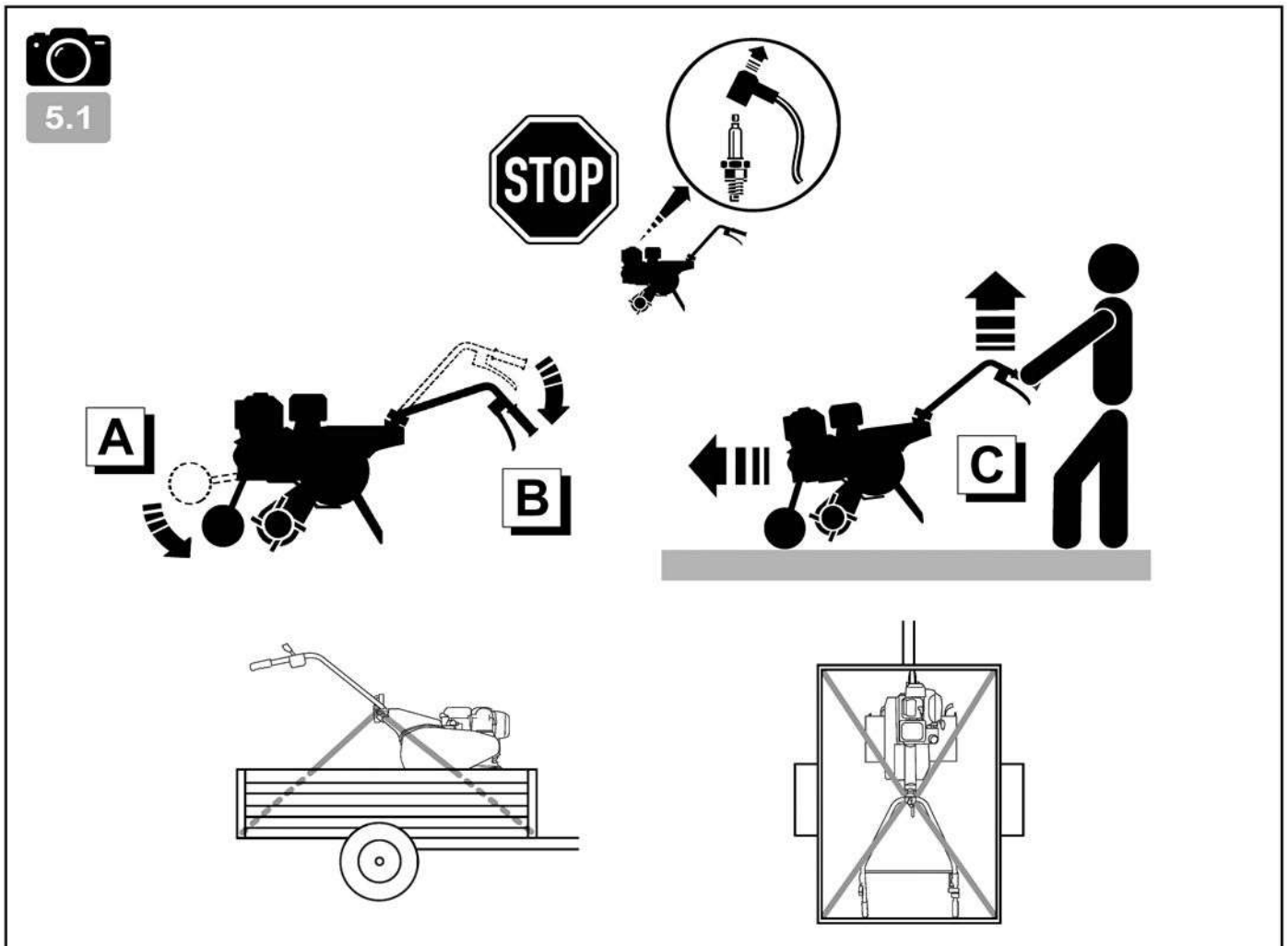
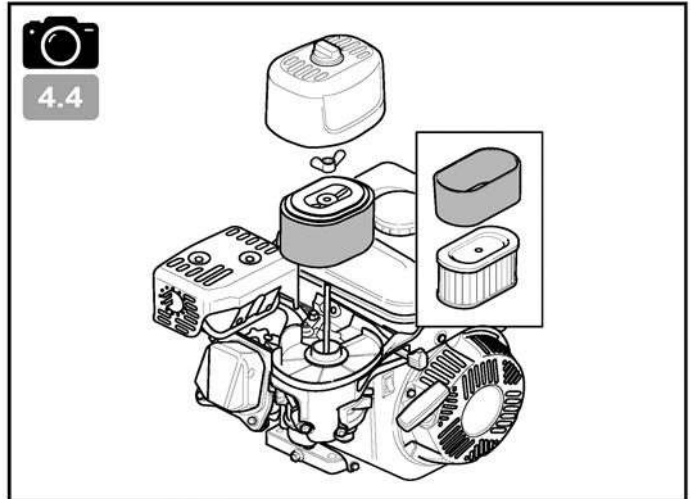
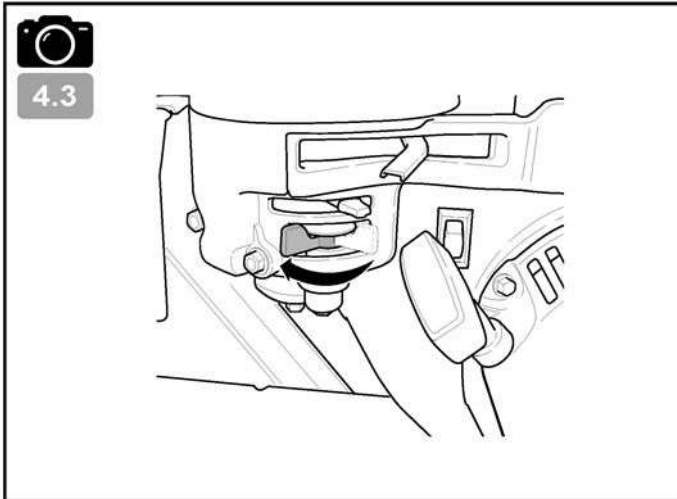
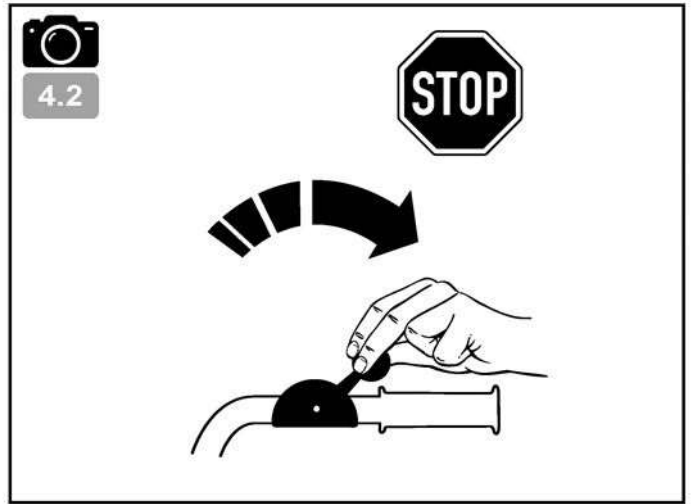
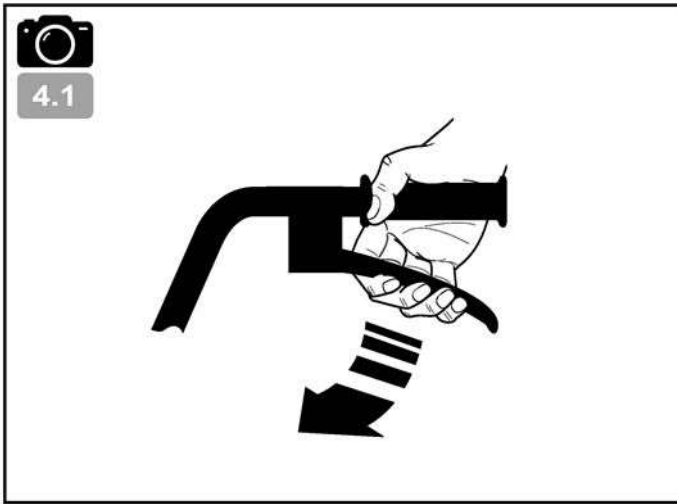

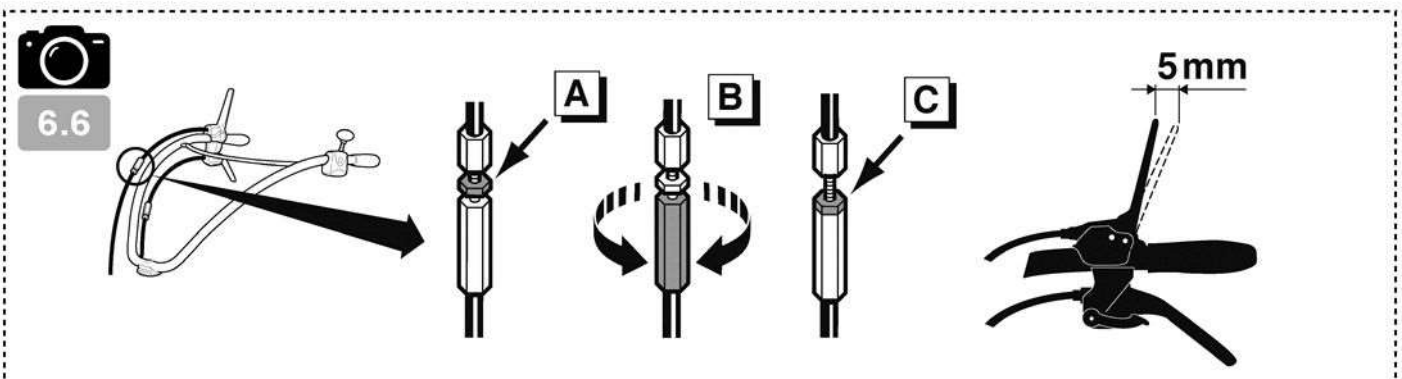
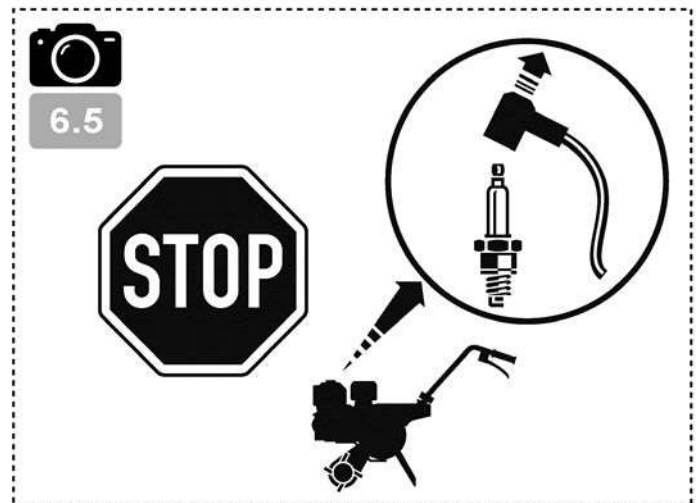
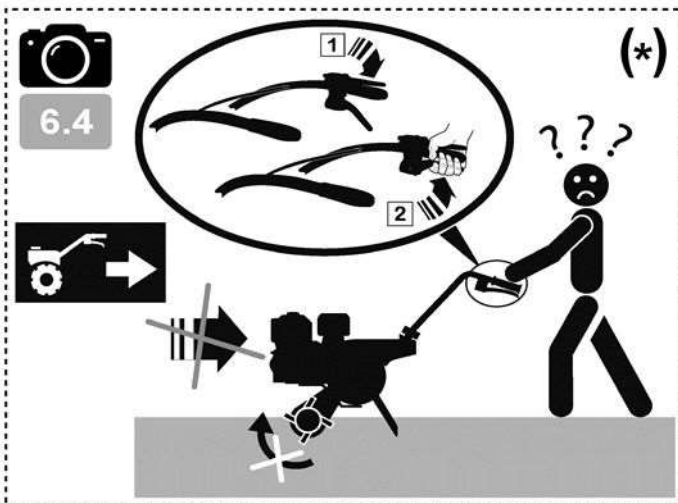
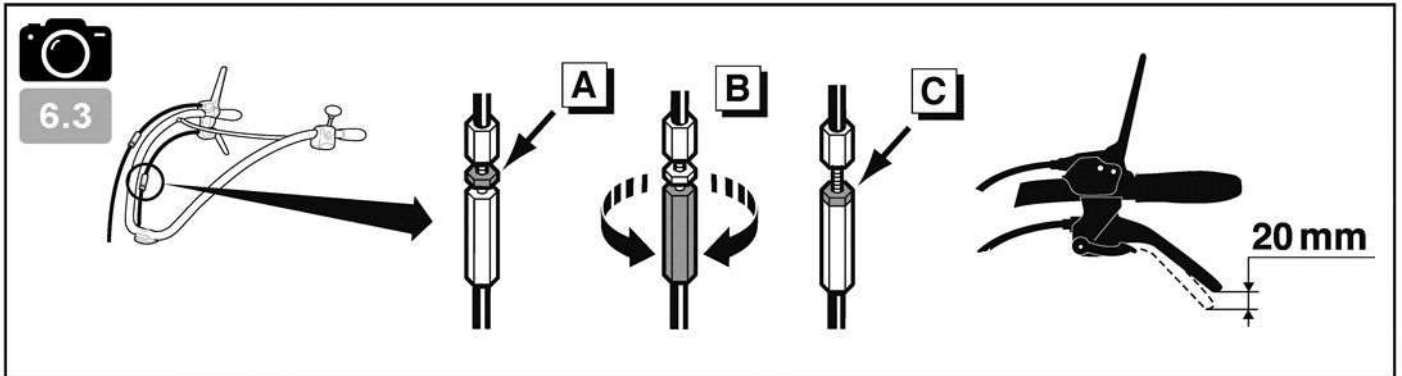
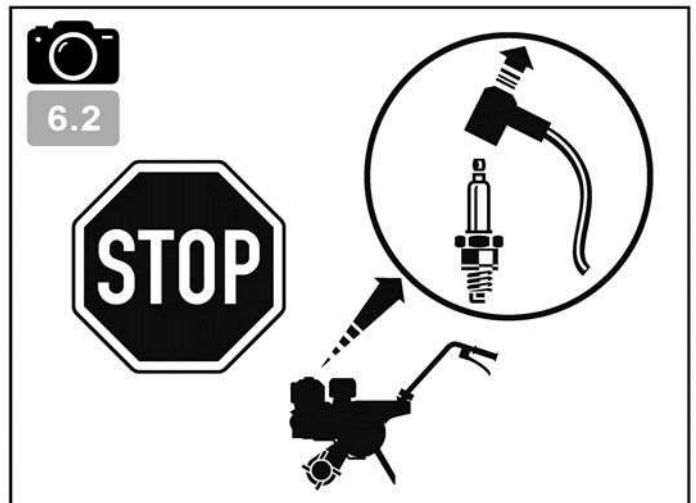
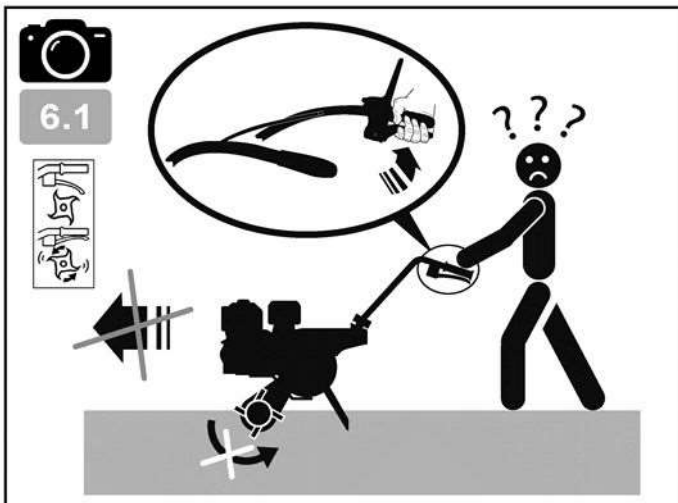

(*) : FR : (suivant version) - EN : (depending on the version) - DE : (je nach Ausführungsvariante) - BG : (според варианта)
 HR : (ovisno o verziji) - DA : (Afhængigt af version) - ES : (Según versión) - ET : (järgmine versioon) - FI : (mallista riippuen)
 EL : (ανάλογα με το μοντέλο) - HU : (verziótól függően) - IT : (A seconda del modello) - LV : (atkarībā no versijas)
 LT : (priklausomai nuo versijos) - NL : (Naar gelang model) - NO : (Avhengig av versjon) - PL : (Zależnie od wersji)
 PT : (Consoante versão) - RO : (În funcție de versiune) - TR : (versiyona göre) - SK : (v závislosti od verzie) - SL : (odvisno od verzije)
 SV : (beroende på version) - CZ : (v závislosti na provedení) - UK : (в залежності від версії) - RU : (В зависимости от модификации)

Pay close attention to indications preceded by the following statements:



CAUTION:
Indicates a high probability of serious physical injury or danger of death if the instructions are not followed

PRECAUTION: Indicates a possibility of physical injury or damage to the equipment if the instructions are not followed

NOTE: Provides useful information



This symbol warns you to be careful during certain operations

If a problem occurs, or if you have any questions about the motor hoe, please contact an approved dealer



CAUTION:
The machine is designed to provide safe and reliable service when used according to the Instructions. Please read and memorise the content of this manual before you use your machine. If you do not, you will risk injury and the equipment may be damaged

Training / Information:

- Familiarise yourself with the correct use and commands before you use the machine. Know how to shut the engine off quickly.
- The machine must always be used according to the recommendations indicated in the instruction manual.
- Do not forget that the user is responsible for any accidents or dangerous phenomena that occurs to other people or their property. It is their responsibility to assess the potential risks in the land to be worked and to take all the necessary precautions to guarantee their safety, in particular on slopes or on rough, slippery or loose ground.
- Never let children or people who are unfamiliar with these instructions use the machine. A minimum user age may be set by local regulations.
- Never work if there is anyone, in particular children or animals, within a 20-metre radius around the machine; the user must stay at the commands on the handlebars.
- Do not use the machine after taking any medicines or substances considered as potentially harmful to your reflexes and vigilance.
- Pay closer attention on hard ground as the machine will tend to be much less stable than on cultivated land.
- While working, always wear hard, non-slip shoes and long, tight trousers. Do not use the machine if you are barefoot or wearing sandals. We recommend wearing hearing protection.
- Use the machine for the purpose for which it is intended, i.e. soil turning. Any other use may be dangerous or may damage the machine.

Preparation:

- Carefully inspect the area where the machine is to be used and remove all objects which may be projected by the machine (stones, wires, glass, metal objects, etc.).
- Before use, always perform a visual inspection of the machine to make sure that the tools and deflectors are not worn or damaged. Have the worn or damaged parts replaced.
- If the machine has an engine stop button, keep the engine stop electrical cables in good condition to ensure that the engine will stop.

- Check that there are no liquid leaks (petrol, oil, etc.).
- Do not use the machine without mudguard or protective covers and make sure that all the attachment mechanisms are fully tightened.

Use:

- Never transport any people on the machine
- Start the engine carefully, following the manufacturer's instructions and keeping your feet away from the tool(s).
- Shut down the engine when the machine is unsupervised.
- Walk, never run with the machine.
- Pull the machine towards you or reverse the movement direction (if possible) with a great deal of care.
- Keep the safe distance in relation to the rotating tools, given by the handlebar length.
- Never put your hands or feet near or under rotating elements.
- In the event of:
 - Abnormal rotation,
 - Blockage,
 - Clutching problem,
 - Impact with a foreign object,
 - Damage to the engine shutdown cable (depending on the model),

shut down the engine immediately (if the engine shutdown cable is cut, activate the starter command as described in the § "starting the engine" to shut down the engine), let the machine cool down, disconnect the spark plug wire, inspect the machine and have the necessary repairs carried out by an authorised repair technician before using the machine again.

- Only work in daylight or in good quality artificial light.
- Do not use the machine on slopes over 10° (17%).
- Work cross-wise on slopes, never ascending or descending.
- On steep land, be sure of your footing and take great care when changing direction.
- Using accessories other than those recommended may make the machine dangerous and cause damage to your machine, which will not be covered by your warranty.

Maintenance / Storage / Disposal:

- Shut down the engine and disconnect the spark plug before any cleaning, verification, tool change, adjustment or maintenance operations on the machine.
- Shut down the engine, disconnect the spark plug and wear thick gloves when changing the tool(s).
- Keep all nuts and screws tight to guarantee safe usage conditions.
- To reduce the fire risks, keep the engine, the silence and the petrol storage area free of all vegetation, excess grease or any other materials likely to catch fire.
- Have the exhaust silencers replaced
- Do not repair the parts. Have the parts replaced with original parts.
- Replace the tools with complete batches to preserve the balance.
- For your safety, do not modify your machine's characteristics. Do not modify the engine speed regulation settings and do not use the engine in overspeed. Regular maintenance is essential to guarantee safety and maintain performance.
- Let the engine cool down before you store the machine inside premises.
- The device must be disposed of in accordance with the regulations in force in the country of use.

Caution – Danger: Petrol is highly flammable:

- Store the fuel in containers specially provided for the purpose. Fill up with fuel outdoors only and do not smoke during the operation.
- Never remove the cap from the petrol tank or add petrol when the engine is running or when it is hot.
- If petrol is spilled on the ground, do not try to start the engine but move the machine away from this area and avoid causing any fires until the petrol fumes have dissipated.
- Store the machine in a dry place. Never store the machine in premises where the petrol fumes may reach a flame, a spark or a high source of heat.
- Put the caps back in place correctly on the tank and the petrol feed.
- Limit the quantity of petrol in the tank to minimise splashing.
- Do not run the engine in a confined space where carbon monoxide fumes may build up.
- Carbon monoxide may be fatal. Make sure that the premises are well ventilated.

Movement / Handling / Transport:

- All actions on the machine apart from working the ground must be performed with the engine shut down and the spark plug disconnected.
- The machine must be moved (apart from working the ground) using the transport wheel as described in the § "movement".
- Handling: do not lift the machine on your own. The machine's weight is indicated on the manufacturer's plate and at the end of this manual. Use a handling method that is adapted to the machine's weight and the situation in order to guarantee safety.
- The machine must be loaded into and unloaded from a trailer using an adapted loading ramp. Stow the machine correctly for safe transport.
- The machine must be transported with the engine shut down and the spark plug disconnected using a trailer; do not use any other method of transport.

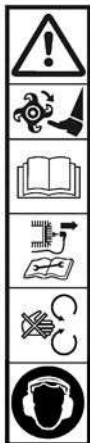

DANGER
Danger

CAUTION
Rotating cutter blades

CAUTION
Read the user manual

CAUTION
Consult the user manual and remove the spark plug before any intervention

CAUTION
Do not use without protection (moving elements)

Wear ear protectors

Gas command
(depending on engine type)

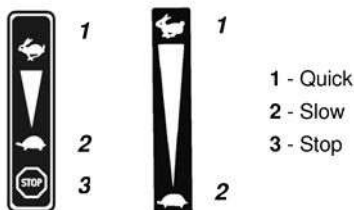

1 - Quick
2 - Slow
3 - Stop

Starter
(depending on version)



Circuit breaker
(depending on engine type)

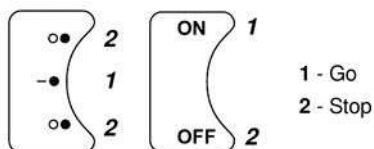

1 - Go
2 - Stop

Gear selection
(optional)



2: Forward quick speed
N: Neutral
R: Reverse
1: Forward slow speed

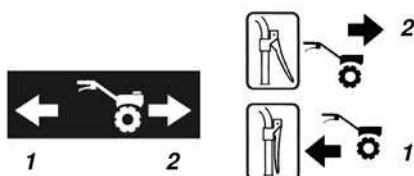

1 - Reverse
2 - Forward

Clutch handle



Clutch disengaged

Clutch engaged



Do not touch hot surfaces



The exhaust gases are dangerous
Do not use in a poorly-ventilated area



Switch the engine off before filling up



Starter



Battery charge
8 HOURS MAXIMUM



Pictograms that may or may not be present depending on the machine model

TECHNICAL INFORMATION

Machine model	TF 325		
Weight	46 kg	Engine model	CR950
Net power *	4.7 KW for an engine rate	3600 rpm	
Nominal power	4.5 KW for a nominal engine rate	3300 rpm	
Guaranteed acoustic power level	NF EN ISO 3744: février 2012		98 dB(A)
Acoustic pressure level at driving position	NF EN ISO 3744: février 2012		84,5 dB(A)
	Measurement uncertainty	1 dB(A)	
Measured acoustic power level	NF EN ISO 3744: février 2012		95,3 dB(A)
	Measurement uncertainty	1 dB(A)	
Level of vibrations on the operator's hands	NF EN 709:1997+A4:2009/AC:2012		4,7 m/s ²
	Measurement uncertainty	2 m/s ²	

* The engine power indicated in this document is a net power obtained by the test on a series engine according to standard SAE J 1349 at a given rotation speed. The power of another production engine may be different from this indicated value. The actual power of an engine installed on a machine will depend on different factors, such as the rotation speed, the temperature, humidity, atmospheric pressure, maintenance and other conditions.

EU Stage V emission compliance



WARNING: Any change to the engine voids the EU type-approval of this product

Approval no.: E5*2016/1628*2016/1628*SYA1/P*1035*0

CO₂ (g/Kw-hr): 840.50

In accordance with the provisions of Article 43 2016/1628, the manufacturer provides you with the measured CO₂ value which was determined during the EU type-approval process: this CO₂ measurement results from testing over a fixed test cycle under laboratory conditions a(n) (parent) engine representative of the engine type (engine family) and shall not imply or express any guarantee of the performance of a particular engine.

NOTE: with permanent improvement in mind, the manufacturer specifies that all of this manual is not contractually-binding and reserves the right to modify the specifications of their machines without notice



1.1

Unpacking



DANGER:
Incorrect assembly of this motor hoe may cause serious injury. Make sure that you follow all the instructions carefully



CAUTION:
Make sure that you do not cut the cables or scratch the machine's paintwork when cutting sharp edges from the body

Item	Case content
A	Transport wheel
B	Exhaust grill **
C	Instructions + nuts and bolts pouch
D	Gauge spur
E	Protection wings
F	Right steering column
G	Left steering column
H	Steering column spacer
I	Engine block
J	Mills
K	Additional cutters *
L	Plant protector disk
M	Jib cover

* Depending on version

** Depending on engine type



1.2

Mounting the stand



1.3

Remove the attachment points from the bottom of the body



1.4

Mounting the transport wheel

A = Movement position

B = Working position



1.5

Mounting the handlebar

A = Height adjustment



1.6

Mounting the gas lever



1.7

Mounting the cable tighteners



1.8

Mounting the cover plates



1.9

Mounting the additional cutters



Pay attention to the direction in which the cutters and pins are mounted



1.10

Machine identification plate

A – Manufacturer's name and address
B – Type of machine
C – Serial number
D – Nominal power
E – Weight in kilograms
F – Machine model
G – EC identification
H – Year of manufacture
I – Commercial designation



1.11



Description of the elements

1 – Reverse lever
2 – Clutch lever
3 – Handlebar adjustment handle
4 – Gas lever
5 – Belt cover
6 – Cover plates
7 – Stand
8 – Plant protector disks
9 – Rotating tools
10 – Transport wheel
11 – Engine

 ← **Oil full and level**
2.1

 ← **Petrol full**
2.2
Super or unleaded or SP95 E 10

 ← **Open the fuel tap and set the starter to position A**
2.3

 ← **Accelerator**
2.4
Set the lever to: 

 ← **Pull the launcher handle**
2.5
 Always remain inside the safety zone when the machine is starting up

 ← **Set the starter to position B**
2.6

USE

This machine is intended for:

- Preparation of the soil for planting
- Maintenance of plantations and flower beds

This machine is not intended for professional use

 ← **Forward movement**
3.1



It is essential to release the clutch before switching to reverse gear



Maintain a safety radius of 20 m around the machine



After you start the machine, do not let the engine idle: start working as soon as possible by activating the tool clutching command

There is no need to warm up the engine: letting it idle for over 2 minutes without engaging the tools may cause serious damage to the clutching system and its belt

 ← **Reverse operation (depending on version)**
3.2



It is essential to release the clutch before switching to reverse gear



Maintain a safety radius of 20 m around the machine



Reversing the machine is dangerous. Make sure that there are no obstacles behind you and slow engine speed before engaging the clutch

STOPPING



4.1

← Cutting tool shutdown

Release the clutch handle



4.2

← Engine shutdown

Set the accelerator command to: 

4.3

← Close the petrol tap

DAILY CHECKS

Check the following points before you start the engine:

- No loose or broken nuts and bolts
- No fuel or engine oil leaks
- Safety of the environment



2.1

← Clean engine oil level



2.2

← Fuel level ok



4.4

← Air filter element cleanliness and oil level
(Depending on engine type)

Do not use any flammable solvents to clean the air filter's foam element

MAINTENANCE PROGRAMME (to be carried out by an authorised workshop)

After the first 5 hours

- Change the engine oil

Every 8 hours or each day

- Clean the air filter *
- Clean the areas around the silencer and the commands
- Clean the launcher casing

Every 25 hours or once per year

- Clean the air filter *
- Clean the pre-filter *

Every 50 hours or once per year

- Change the engine oil
- Inspect the silencer and the spark guard

Every year or 300 hours

- Change the air filter
- Change the pre-filter
- Change the spark plug
- Change the fuel filter
- Clean the air cooling system *
- Check the valve play **

* Clean more often if the machine is used in a dusty atmosphere or one full of airborne debris

** Not vital unless there are performance problems (to be carried out by an authorised workshop)

Movement

5.1

 Shut down the engine

 Wait until the engine cools down (10 minutes)

A Set the wheel to movement position

B Adjust the handlebar to low position to make it easier to move the machine

C Using the handlebar, raise the cutters from the ground and move forward

- **Handling:** do not lift the machine on your own. The machine's weight is indicated on the manufacturer's plate and at the end of this manual. Use a handling method that is adapted to the machine's weight and the situation in order to guarantee safety

- The machine must be loaded into and unloaded from a trailer using an adapted loading ramp

- Stow the machine correctly for safe transport

ADJUSTING THE CLUTCH CABLE *(Depending on version)*

 When advancing jerkily or when the blades are not turning in the "Clutch engaged" position, adjust the clutch cable.

6.1

 Stop the machine and disconnect the spark plug.

6.2



6.3

A Release the cable tensioning nut on the clutch cable.

B Set the tensioning nut to provide 20mm play at the end of the lever.

C Relock the nut.
Reconnect the sparkplug.
Start the machine and try again.
If the problem persists, contact your retailer.

ADJUSTING THE REVERSING CABLE *(Depending on version)*

 In the "clutch engaged" position, in the event of an abnormal noise or when the blades do not turn, adjust the reversing cable.

6.4

 Stop the machine and disconnect the spark plug.

6.5



6.6

A Release the cable tensioning nut on the reversing lever.

B Set the tensioning nut to provide 5mm play at the end of the lever.

C Relock the nut.
Reconnect the sparkplug.
Start the machine and try again.
If the problem persists, contact your retailer.

TRANSMISSION GREASING

Period: 50 h maximum or 1/year before wintering

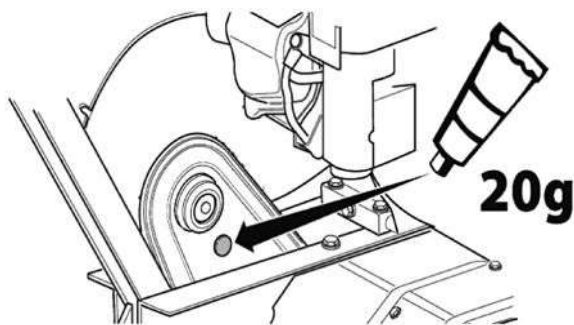

- 1- Remove the cap from the upper part of the transmission
- 2- Add 20 g of lithium grease from a tube
- 3- Put the cap back
- 4- Turn the cutters for 30 seconds