



# Husqvarna®

## CA230

### EAC

|       |                             |         |
|-------|-----------------------------|---------|
| EN    | Operator's manual           | 2-12    |
| BG    | Ръководство за експлоатация | 13-22   |
| CS    | Návod k použití             | 23-32   |
| DA    | Brugsanvisning              | 33-42   |
| DE    | Bedienungsanweisung         | 43-52   |
| EL    | Οδηγίες χρήσης              | 53-62   |
| ES    | Manual de usuario           | 63-72   |
| ET    | Kasutusjuhend               | 73-81   |
| FI    | Käyttöohje                  | 82-91   |
| FR    | Manuel d'utilisation        | 92-101  |
| HU    | Használati utasítás         | 102-111 |
| LT    | Operatoriaus vadovas        | 112-121 |
| LV    | Lietošanas pamācība         | 122-131 |
| NL    | Gebruiksaanwijzing          | 132-141 |
| NO    | Bruksanvisning              | 142-151 |
| PL    | Instrukcja obsługi          | 152-161 |
| PT    | Manual do utilizador        | 162-171 |
| RO    | Instrucțiuni de utilizare   | 172-181 |
| RU    | Руководство по эксплуатации | 182-192 |
| SK    | Návod na obsluhu            | 193-202 |
| SL    | Navodila za uporabo         | 203-212 |
| SV    | Bruksanvisning              | 213-221 |
| TR    | Kullanım kılavuzu           | 222-231 |
| ZH    | 操作手册                        | 232-240 |
| EN-US | Operator's manual           | 242-250 |
| ES-MX | Manual de usuario           | 251-259 |
| FR-CA | Manuel d'utilisation        | 260-269 |
| IT-US | Manuale dell'operatore      | 270-278 |

# Contents

|                   |   |   |    |
|-------------------|---|---|----|
| Introduction..... | 2 | Transportation, storage and disposal..... | 8  |
| Safety.....       | 3 | Technical data.....                       | 9  |
| Operation.....    | 7 | Accessories.....                          | 10 |
| Maintenance.....  | 7 | Declaration of Conformity.....            | 11 |

## Introduction

### Product description

We have a policy of continuous product development and therefore reserve the right to modify the design and appearance of the products without prior notice.

**Note:** This manual cover both gasoline operated and battery operated power units.

### Intended use



**WARNING:** This attachment may only be used together with the intended product, see the accessory chapter in the Operator's Manual of the product.

The attachment is only designed for cultivating.

### Attachment overview

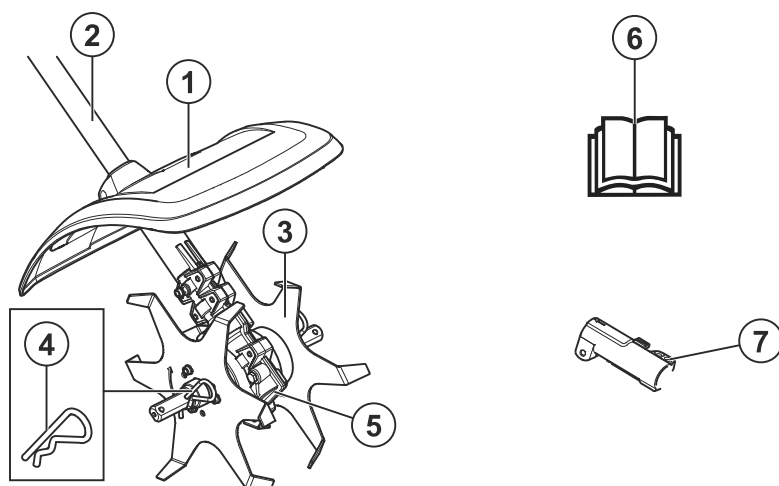

1. Blade guard
2. Shaft
3. Blades
4. Split pin
5. Gear housing
6. Operator's manual
7. Shaft coupling (Included with the product)



Read the operator's manual carefully and make sure you understand the instructions before you use the attachment.



Use approved hearing protection. Use approved eye protection. Use a breathing mask when there is a risk of dust.



This attachment is in accordance with applicable EC directives.



Careless or incorrect use of this attachment can result in serious or fatal injury to the operator or others.



This product conforms to applicable UK regulations.



Rotating parts. Keep hands and feet clear. The arrow indicates the direction of rotation.



Always wear approved protective gloves.



Wear sturdy, non-slip boots.



Watch out for thrown objects and ricochets.



The operator must ensure that no people or animals come closer than 15 meters. When several operators are working at the same site a safety distance of at least 15 meters must be in effect. The attachment can forcibly throw objects that can bounce back. This can result in serious eye injuries if the recommended safety equipment is not used.



Keep a minimum of 15 m / 50 ft distance to persons and animals during operation of the product.



Keep all parts of your body away from the hot surfaces.



Noise emission to the environment label as per EU and UK directives and regulations, and New South Wales legislation "Protection of the Environment Operations (Noise Control) Regulation 2017". The guaranteed sound power level of the product is specified in *Technical data on page 9* and on the label.

**Note:** Other symbols/decals on the attachment refer to special certification requirements for certain markets.

## Safety

### Safety definitions

Warnings, cautions and notes are used to point out specially important parts of the operator's manual.



**WARNING:** Used if there is a risk of injury or death for the operator or bystanders if the instructions in the manual are not obeyed.



**CAUTION:** Used if there is a risk of damage to the product and/or the attachment, other materials or the adjacent area if the instructions in the manual are not obeyed.

**Note:** Used to give more information that is necessary in a given situation.

### Read all instructions



**WARNING:** When using electric gardening appliances, basic safety precautions should always be followed to reduce the risk of fire, electric shock, and personal injury, including the following:

### General safety instructions



**WARNING:** Read the safety instructions that follow before you use the attachment.

- Please read the operator's manual carefully and make sure you understand the instructions before using the attachment.
- These instructions supplement the instructions that were included with the product. For other procedures, please refer to the operating instructions for the product.

- Under no circumstances may the design of the attachment be modified without the permission of the manufacturer. Do not use an attachment that appears to have been modified by others and always use original accessories. Non-authorized modifications and/or accessories can result in serious personal injury or the death of the operator or others.

## Safety instructions for operation



**WARNING:** Read the warning instructions that follow before you use the product.

- Faulty blades can increase the risk of accidents.
- At times grass and stones can become caught in the tines. Always stop the engine/motor when cleaning.
- Watch out for thrown objects. Never lean over the cutting attachment guard. Stones, rubbish, etc. can be thrown up into the eyes causing blindness or serious injury.
- The gear can get hot during use and may remain so for a while afterwards. You could get burnt if you touch it.
- Do not use the product unless you are able to call for help in the event of an accident.
- Only use the product for the purpose it was intended for.
- Never use the product if you are tired, if you have drunk alcohol, or if you are taking medication that could affect your vision, your judgement or your co-ordination.
- Never use the product in extreme weather conditions such as severe cold, very hot and/or humid climates.
- Never use a product that is faulty. Carry out the safety checks, maintenance and service instructions described in this manual. Some maintenance and service measures must be carried out by trained and qualified specialists. See instructions under the Maintenance heading.
- Never allow children to use the product.
- Never allow anyone else to use the product without first ensuring that they have read and understood the contents of the operator's manual.
- Inspect the working area. Remove all loose objects, such as stones, broken glass, nails, steel wire, string, etc. that could be thrown out or become wrapped around the cutter or cutter guard.
- Keep unauthorised persons at a distance. Children, animals, onlookers and helpers should be kept outside the safety zone of 15 m while you work. Stop the product immediately if anyone approaches.
- If you encounter a situation where you are uncertain how to proceed you should ask an expert. Contact your dealer or your service workshop.
- Avoid all usage which you consider to be beyond your capability.
- Observe your surroundings and make sure that there is no risk of people or animals coming in contact with or affect your control of the product.
- Do not use the product in bad weather, such as dense fog, heavy rain, strong wind, intense cold, etc. Working in bad weather is tiring and can lead to dangerous conditions, e.g. slippery surfaces.
- Make sure you can move and stand safely. Check the area around you for possible obstacles (roots, rocks, branches, ditches, etc.) in case you have to move suddenly. Take great care when working on sloping ground.
- Listen out for warning signals or shouts when you are wearing hearing protection. Always remove your hearing protection as soon as the engine/motor stops.
- The engine/motor must be switched off before moving.
- Never put the product down with the engine/motor running unless you have it in clear sight.
- The cutting tool must work away from the operator. Never work with the tool towards the operator as this may cause serious injury.
- Always hold the product with both hands. Hold the product on the right of your body.
- Make sure your hands and feet do not come near the cutter when the engine/motor is running.
- Always keep the tines close to the ground.



- Always release the throttle/power trigger after each working operation. Long periods at full throttle/speed without any load on the engine/motor (i.e. without the resistance that the cutting attachment exerts on the engine when you are using the product) can lead to serious engine/motor damage.
- Pay extra attention when pulling the cultivator towards you while working.
- If heavy vibration occurs, stop the product. If you have a gasoline operated product, disconnect the HT lead from the spark plug. If you have a battery operated product, remove the battery. Check that the product is not damaged. Repair any damage.
- Keep hands away from blades.

## Personal protective equipment



**WARNING:** Read the warning instructions that follow before you use the product.

- Always use approved personal protective equipment when you use the product. Personal protective equipment cannot fully prevent injury but it decreases the degree of injury if an accident does occur. Let your dealer help you select the right equipment.
- Use approved hearing protection that provides adequate noise reduction. Long-term exposure to noise can result in permanent hearing impairment.

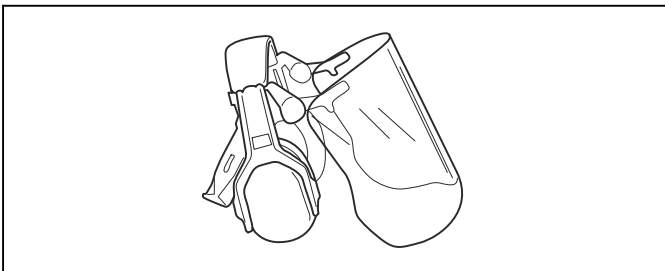

- Use approved eye protection. If you use a visor, you must also use approved protective goggles. Approved protective goggles must comply with the ANSI Z87.1 standard in the USAs or EN 166 in EU countries.

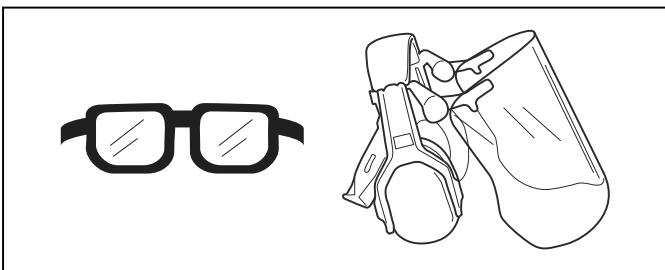

- Use gloves when necessary, for example when you attach, examine or clean the cutting equipment.

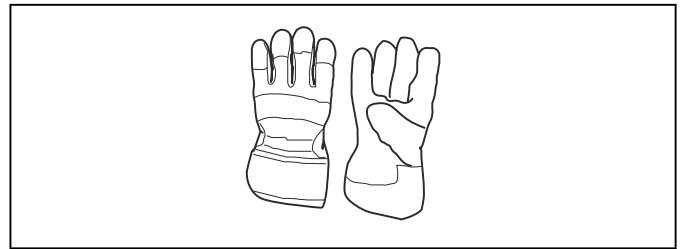

- Use protective boots with steel toes and non-slip soles.



- Use clothing made of a strong fabric. Always use heavy, long pants and long sleeves. Do not use loose clothing that can catch on twigs and branches. Do not wear jewelry, short pants, sandals or go with bare feet. Put your hair up safely above shoulder level.
- Keep first aid equipment close at hand.

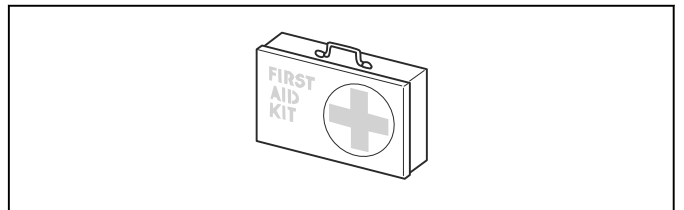

## Safety devices on the attachment



**WARNING:** Read the warning instructions that follow before you use the attachment.

This section contains the attachment's safety features, its purpose and how checks and maintenance should be carried out to ensure that it operates correctly. See instructions under the heading *Attachment overview on page 2* to find where these parts are located on your attachment.

The life span of the attachment can be reduced and the risk of accidents can increase if attachment maintenance is not carried out correctly and if service and/or repairs are not carried out professionally. If you need further information please contact your nearest servicing dealer.



**WARNING:** Never use an attachment with defective safety components. The attachment's safety equipment must be inspected and maintained as described in this section. If your attachment fails any of

these checks, contact your service agent to get it repaired.



**WARNING:** All servicing and repair work on the product requires special training. This is especially true of the product's safety equipment. If your product fails any of the checks described below you must contact your service agent. When you buy any of our products we guarantee the availability of professional repairs and service. If the retailer who sells your product is not a servicing dealer, ask him for the address of your nearest service agent.

### To do a check of the cutting equipment

The tines are designed and machined to withstand the loads resulting from cultivating.

The two basic rules:

1. Only use cutting attachments with the guards we recommend!

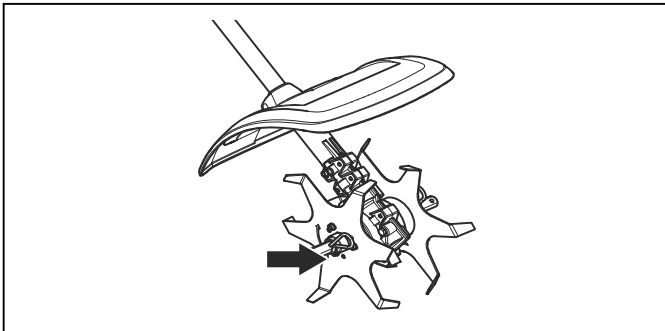

2. Check the cutting attachment for damage or cracks. A damaged cutting attachment should always be replaced.

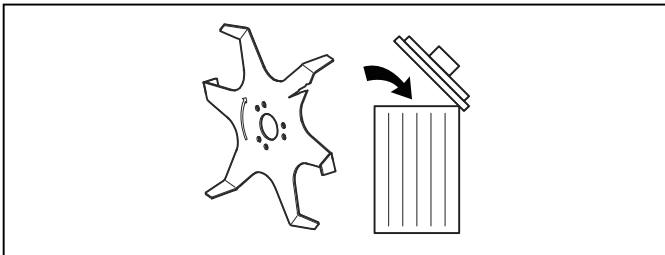

### To do a check of the cutting attachment guard

This guard is intended to prevent loose objects from being thrown towards the operator. The guard also protects the operator from accidental contact with the cutting attachment.

1. Ensure that the guard is undamaged and is not cracked.

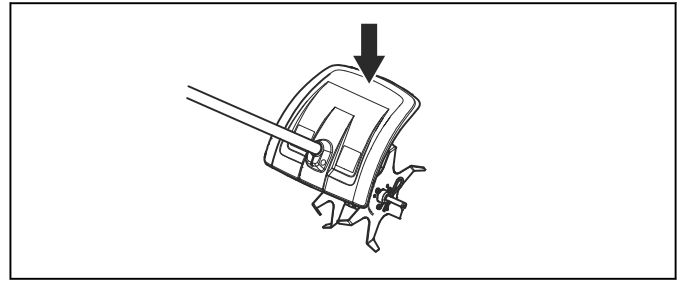

2. Replace the guard if it has been exposed to impact or is cracked.

### Safety instructions for maintenance



**WARNING:** Read the warning instructions that follow before you do maintenance.



**WARNING:** Always stop the product before you work on any part of the attachment. It can continue to move even after the throttle/power trigger is released. If you have a gasoline operated product, disconnect the HT leads from the spark plug. If you have a battery operated product, remove the battery. Ensure the attachment has stopped completely before you start to work on it.

- Cultivating should only be done in daylight or other well-lit conditions.
- Check the entire product before starting. Replace damaged parts. Check that all guards and covers are complete and fastened securely. Check all nuts and screws.
- If you have a gasoline operated product, make sure that there are no fuel leaks.
- Check that the blades are undamaged and show no signs of cracking or other damage. Replace the blades if necessary.

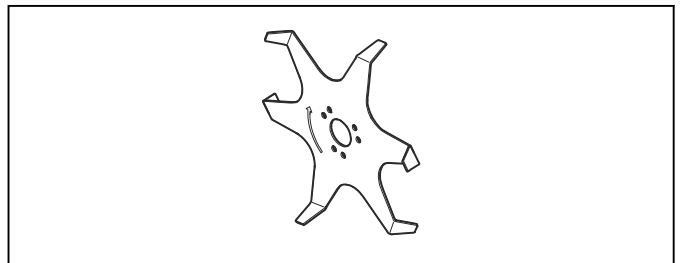

- Make sure the cutter guard is fitted and not damaged.

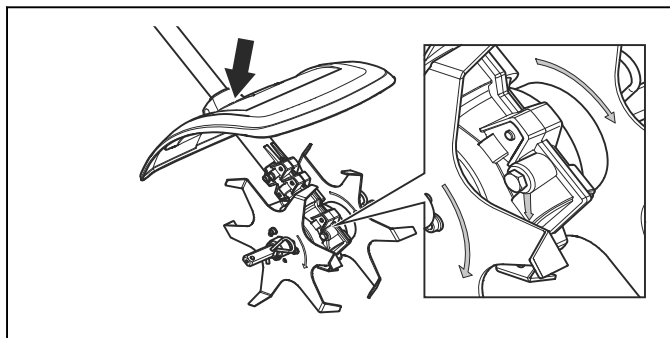

- Check that the tines and tine guard are secured correctly. Make sure the direction of rotation agrees with the cutters and on the gear. The arrows must point in the same direction.

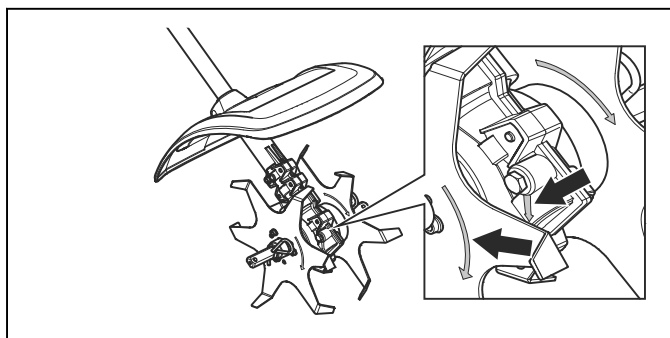

- Check that the blades do not move when the throttle/power trigger is released.
- Make sure the handle and safety features are in order. Never use a product that has any parts missing or has been modified in relation to the specification.
- Only use the product for the purpose it was intended for.
- Make sure the cutting attachment has stopped before cleaning, carrying out repairs or an inspection. If you have a gasoline operated product, disconnect the HT leads from the spark plug. If you have a battery operated product, remove the battery.
- Wear heavy-duty gloves when repairing the cultivator.
- Use only original spare parts for repairs.
- Store the product out of reach of children.

## Operation

### To start the product with a cold engine

If you have a gasoline operated product, obey these instructions to start the product with a cold engine.

1. Run the basic product warm and then shut down the product.
2. Mount the accessory as per the assembly instructions.

## Maintenance

### Introduction

Below you will find some general maintenance instructions. If you need further information please contact your service workshop.

### To replace the blades



**WARNING:** Always stop the product before you work on any part of the attachment. It can continue to move even after the throttle/power trigger is released. If you have a gasoline operated product, disconnect the HT leads from the spark plug. If you have a battery operated product, remove the battery. Ensure the attachment has stopped completely before you start to work on it.

1. Loosen the split pin.

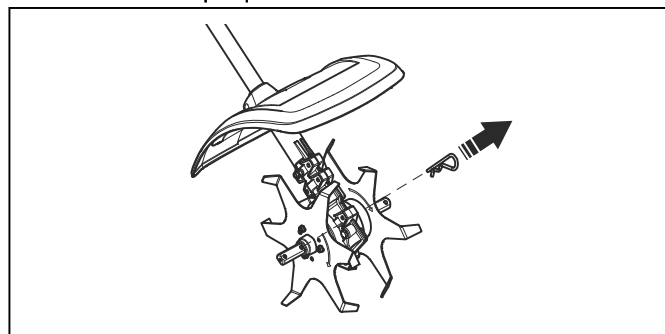

2. Remove the cutter package from the gear housing's output axle.

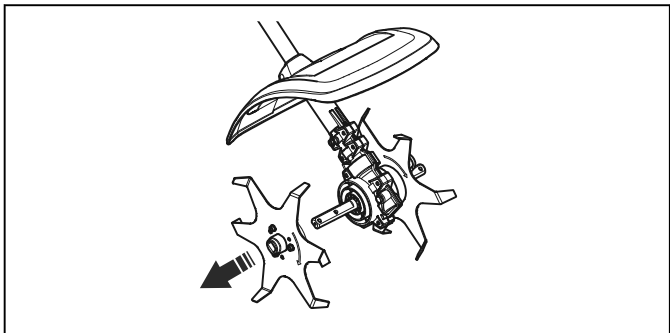

3. Mount the cutter package onto the gear housing's output shaft. Make sure the direction of rotation agrees with the cutters and on the gear. The arrows must point in the same direction.

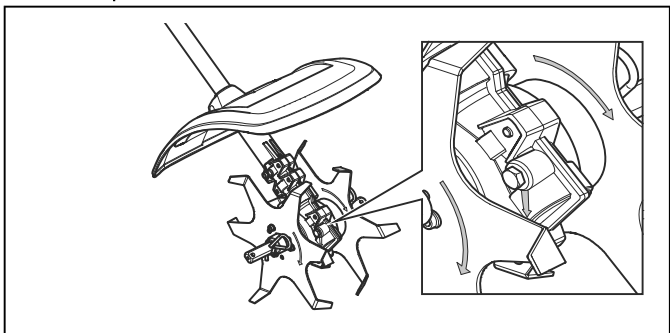

1. Check that the guard is undamaged and not cracked. Replace the guard if it has been exposed to impact or is cracked.
2. Check that the blades do not move when the throttle/power trigger is released.
3. Check that the blades are undamaged and show no signs of cracking or other damage. Replace the blades if necessary.
4. Check that nuts and screws are tight.
5. Clean the outside of the product.
6. Check that the split pins and cotter pins are undamaged and secured correctly.

## To perform daily maintenance on the product

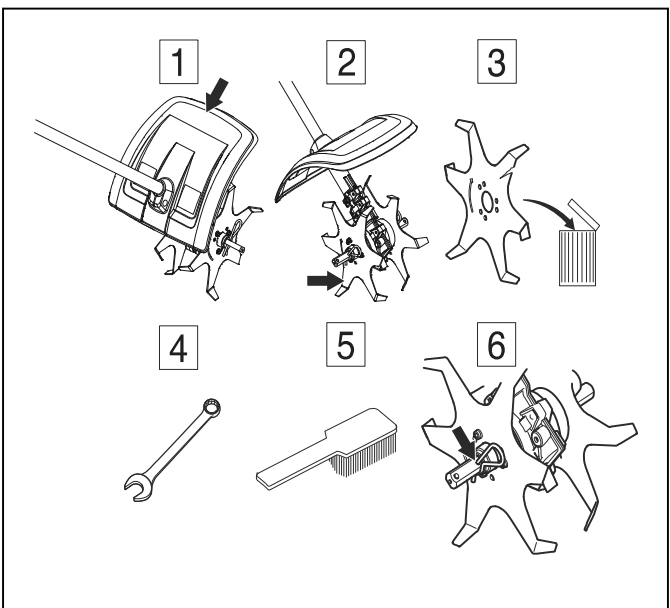

---

## Transportation, storage and disposal

---

### Transport and storage

If transporting the attachment on another vehicle always use approved securing devices and make sure that the attachment is securely held.

Ensure the attachment is cleaned and that a complete service is carried out before long-term storage.



## Technical data

### Technical data for gasoline operated products

|  |         |
|--|---------|
|  | CA230   |
| <b>Weight</b>  |         |
| Weight with 2x cutters, kg   | 2.9     |
| Weight with 4x cutters (accessory), kg   | 3.7     |
| <b>Dimensions, mm</b>  |         |
| 2x cutters   | 140     |
| 4x cutters (accessory)   | 235     |
| <b>Noise emissions <sup>1</sup></b>  |         |
| Sound power level, measured dB (A)   | 105     |
| Sound power level, guaranteed L <sub>WA</sub> dB (A)   | 109     |
| <b>Sound levels <sup>2</sup></b>   |         |
| Equivalent sound pressure level at the operator's ear, measured according to EN ISO 22868 , dB (A):    |         |
| Equipped with approved accessory (original)  | 92.4    |
| <b>Vibrations <sup>3</sup></b>   |         |
| Equivalent vibration levels (a <sub>hV,eq</sub> ) at handles, measured according to , m/s <sup>2</sup> |         |
| Equipped with approved accessory (original), left/right  | 4.2/6.1 |

### Technical data for battery operated products

|   |         |
|---|---------|
| <b>325iLK + Cultivator attachment CA230</b> |         |
| <b>Weight</b>                               |         |
| Weight with 2x cutters, kg                  | 2.3+2.9 |
| Weight with 4x cutters (accessory), kg      | 2.3+3.7 |

<sup>1</sup> Noise emissions in the environment measured as sound power (L<sub>WA</sub>) in conformity with EC directive 2000/14/EC. Reported sound power level for the machine has been measured with the original cutting attachment that gives the highest level. The difference between guaranteed and measured sound power is that the guaranteed sound power also includes dispersion in the measurement result and the variations between different machines of the same model according to Directive 2000/14/EC.

<sup>2</sup> Reported data for equivalent sound pressure level for the machine has a typical statistical dispersion (standard deviation) of 1 dB (A).

<sup>3</sup> Reported data for equivalent vibration level has a typical statistical dispersion (standard deviation) of 1 m/s<sup>2</sup>.

|  |         |
|--|---------|
| <b>325iLK + Cultivator attachment CA230</b>  |         |
| <b>Noise emissions <sup>4</sup></b>  |         |
| Sound power level, measured dB (A)   | 89      |
| Sound power level, guaranteed L <sub>WA</sub> dB (A)                                     | 90      |
| <b>Sound levels <sup>5</sup></b>   |         |
| Sound pressure level at the operator's ear, measured according to EN ISO 22868 , dB (A): |         |
| Equipped with approved accessory (original)  | 78      |
| <b>Vibrations <sup>6</sup></b>   |         |
| Vibration levels at handles, measured according to EN 62841-1, m/s <sup>2</sup>          |         |
| Equipped with approved accessory (original), left/right                                  | 1.3/2.2 |

---

## Accessories

---

### Accessories

| Approved accessories | Accessory type | Guard, art. no. |
|----------------------|----------------|-----------------|
| Cultivator Cutter    | 4 x blades     |                 |

<sup>4</sup> Noise emissions in the environment measured as sound power (L<sub>WA</sub>) in conformity with EC directive 2000/14/EC. Reported sound power level for the machine has been measured with the original cutting attachment that gives the highest level. The difference between guaranteed and measured sound power is that the guaranteed sound power also includes dispersion in the measurement result and the variations between different machines of the same model according to Directive 2000/14/EC.

<sup>5</sup> Reported data for sound pressure level for the machine has a typical statistical dispersion (standard deviation) of 3 dB (A) and has been measured with the original attachment that gives the highest level.

<sup>6</sup> Reported data for vibration level has a typical statistical dispersion (standard deviation) of 2 m/s<sup>2</sup>. For comparison of vibrations levels, battery and combustion products use vibration calculator. <https://www.husqvarna.com/uk/services-solutions/vibration-calculator/>.

# Declaration of Conformity

## EU Declaration of Conformity

We, **Husqvarna AB**, SE-561 82 Huskvarna, Sweden, tel:  
+46-36-146500, declare on our sole responsibility that  
the product:

|                       |   |
|-----------------------|---|
| <b>Description</b>    | Cultivator attachment                       |
| <b>Brand</b>          | Husqvarna                                   |
| <b>Type / Model</b>   | CA230                                       |
| <b>Identification</b> | Serial numbers dating from 2022 and onwards |

complies fully with the following EU directives and  
regulations:

| <b>Directive / Regulation</b> | <b>Description</b>  |
|-------------------------------|---|
| 2006/42/EC                    | "relating to machinery"   |
| 2000/14/EC                    | "relating to the noise emissions in the environment"  |
| 2011/65/EU                    | "on the restriction of the use of certain hazardous substances in electrical and electronic equipment " |

and that the following standards and/or technical  
specifications are applied: ISO 11449:1994, EN IEC  
63000:2018

0404, RISE SMP Svenska Maskinprovning AB, Box  
7035, SE-750 07 Uppsala, Sweden has carried out  
EC type examination in accordance with the machinery  
directive's (2006/42/EC) article 12, point 3b., annex IX.

Certificate number: SEC/14/2415

Huskvarna, 2022-03-29

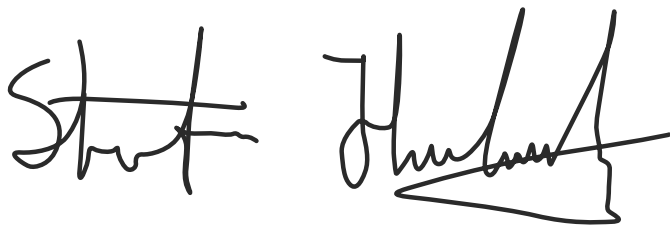

Stefan Holmberg, R&D Director, Technology  
Management, Husqvarna AB

Responsible for technical documentation



## UK Declaration of Conformity

We, **Husqvarna AB**, SE-561 82 Huskvarna, Sweden, tel:  
+46-36-146500, declare on our sole responsibility that  
the product:

|                       |   |
|-----------------------|---|
| <b>Description</b>    | Cultivator attachment                       |
| <b>Brand</b>          | Husqvarna                                   |
| <b>Type / Model</b>   | CA230                                       |
| <b>Identification</b> | Serial numbers dating from 2022 and onwards |

complies fully with the following UK regulations:

|  |
|--|
| <b>Description</b>   |
| The Supply of Machinery (Safety) Regulations 2008  |
| The Noise Emission in the Environment by Equipment for use Outdoors Regulations 2001                               |
| The Restriction of the Use of Certain Hazardous Substances in Electrical and Electronic Equipment Regulations 2012 |

and that the following standards and/or technical  
specifications are applied: ISO 11449:1994, EN IEC  
63000:2018.

Huskvarna, 2022-03-29

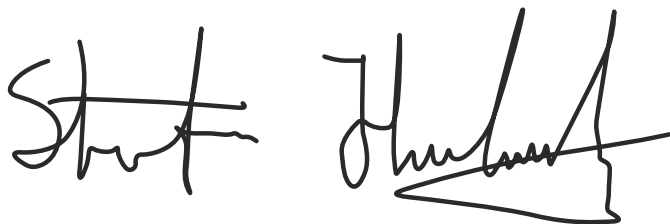

Stefan Holmberg, R&D Director, Technology  
Management, Husqvarna AB

Responsible for technical documentation

**UK  
CA**

UK Importer:  
Husqvarna UK Ltd  
Preston Road, Co. Durham  
DL5 6UP