

# Husqvarna®

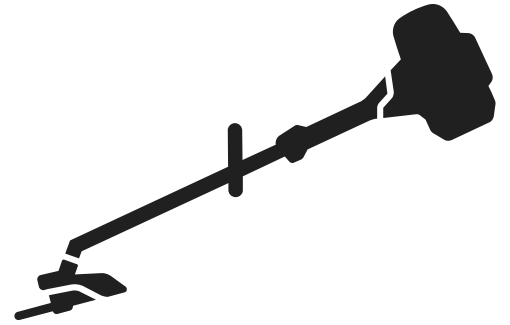

## 129C, 129L, 129LK



EN	Operator's manual	5-14
DE	Bedienungsanweisung	15-25
FR	Manuel d'utilisation	26-36
ES	Manual de usuario	37-47
IT	Manuale dell'operatore	48-58
NL	Gebruiksaanwijzing	59-69
SV	Bruksanvisning	70-79
NO	Bruksanvisning	80-89
DA	Brugsanvisning	90-99
FI	Käyttöohje	100-109
PT	Manual do utilizador	110-120
EL	Οδηγίες χρήσης	121-131
CS	Návod k použití	132-141
HR	Priručnik za korištenje	142-151
SL	Navodila za uporabo	152-161
PL	Instrukcja obsługi	162-172
SK	Návod na obsluhu	173-182
HU	Használati utasítás	183-193
RU	Руководство по эксплуатации	194-204
ET	Kasutusjuhend	205-214
LT	Operatoriaus vadovas	215-224
LV	Lietošanas pamācība	225-234
BG	Ръководство за експлоатация	235-245
RO	Instrucțiuni de utilizare	246-256
TR	Kullanım kılavuzu	257-266
UK	Посібник користувача	267-277
SR	Priručnik za rukovaoca	278-287
BS	Korisnički priručnik	288-297

1

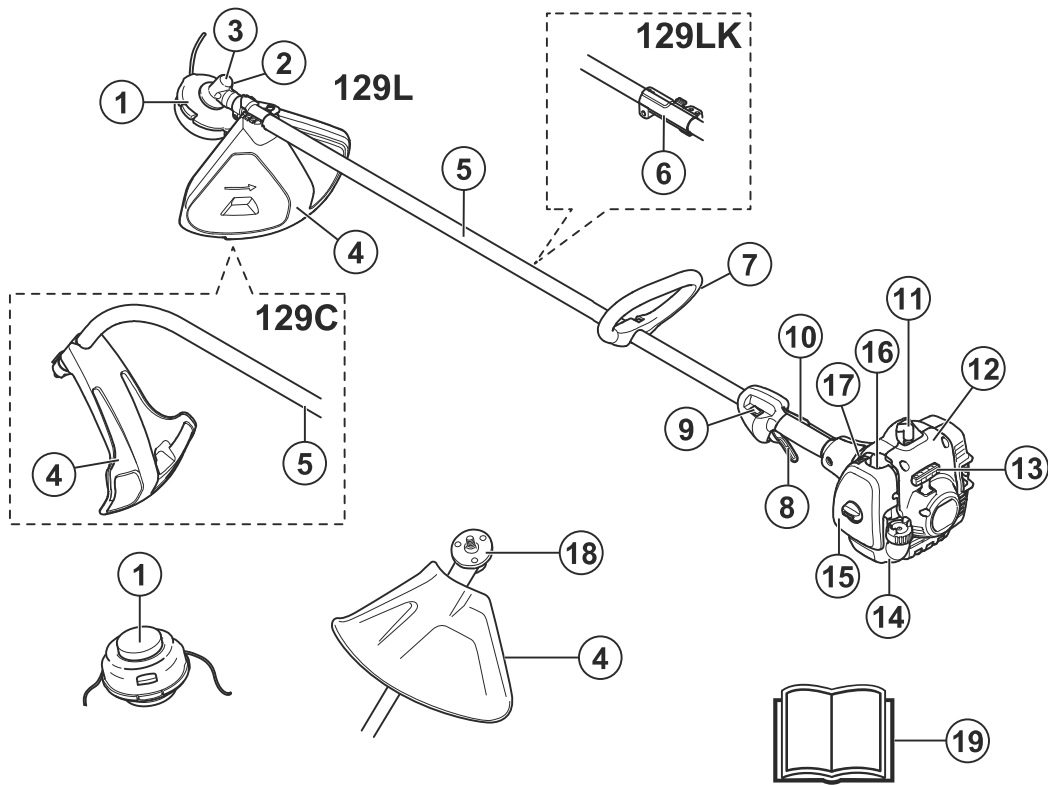

2	3	4	5	6	7
8	9	10	11	12	13
14	15	16	17	18	19

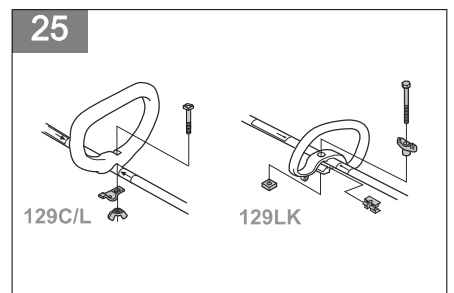
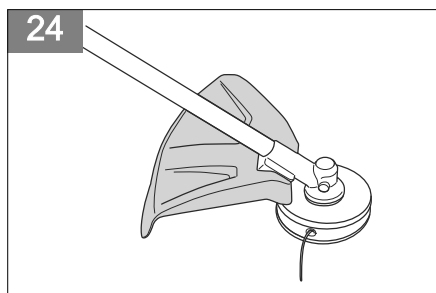
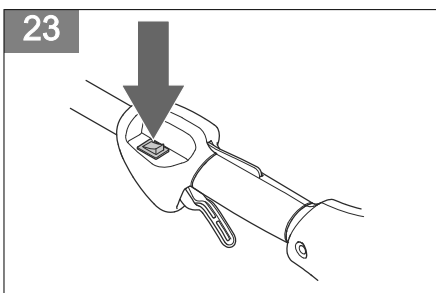
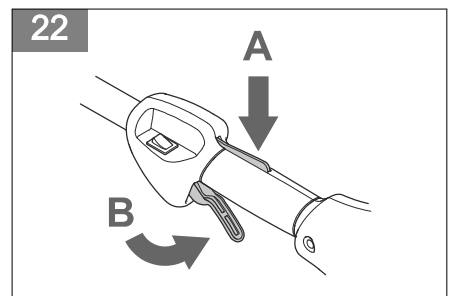

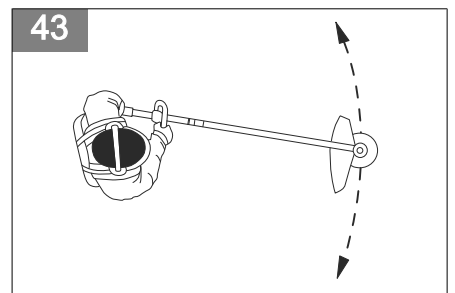
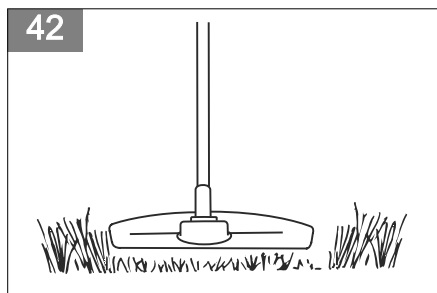
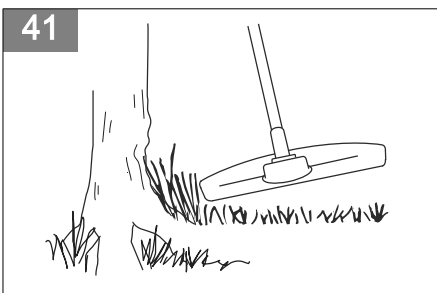
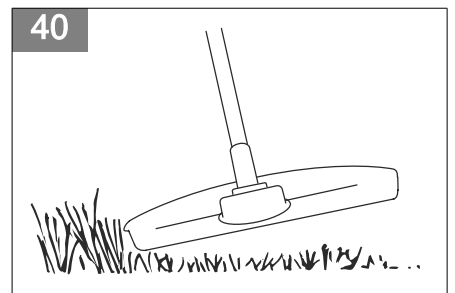
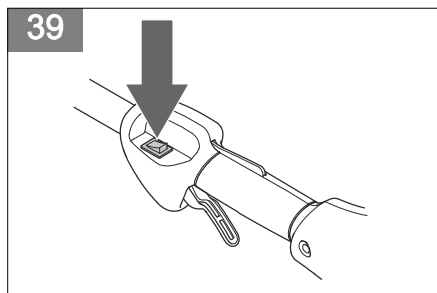
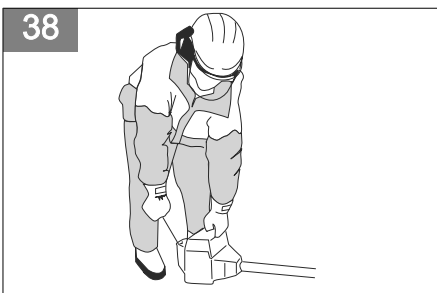
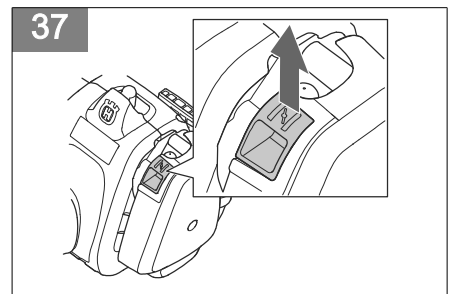
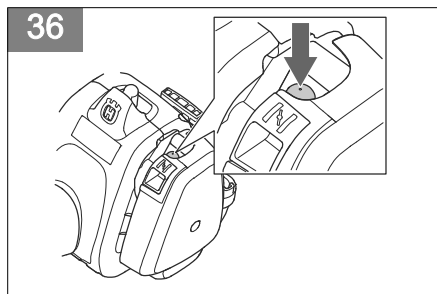
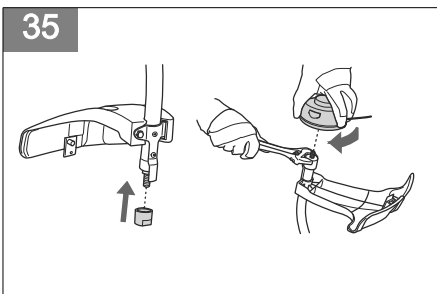
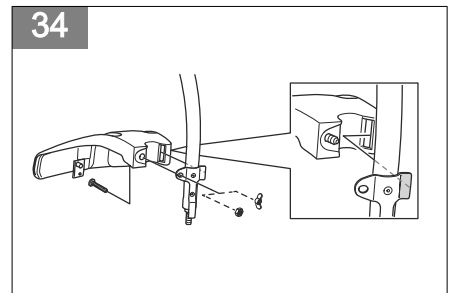
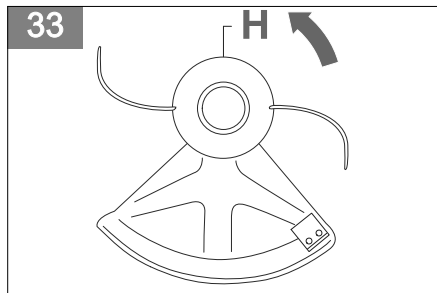
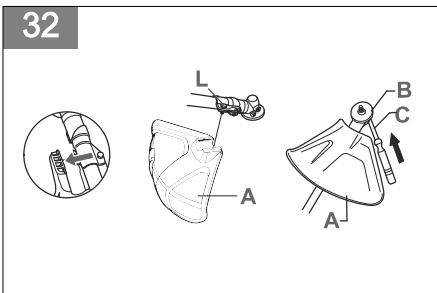
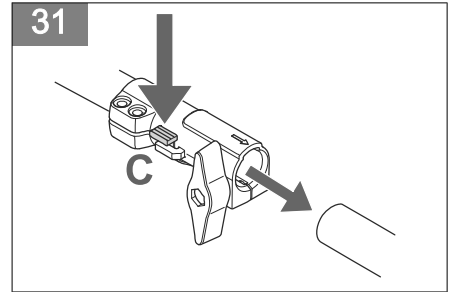
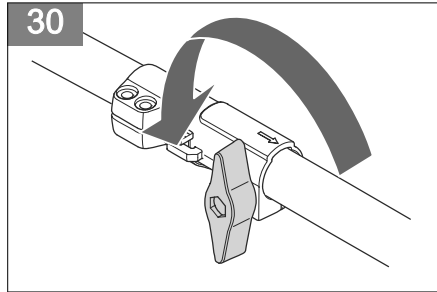
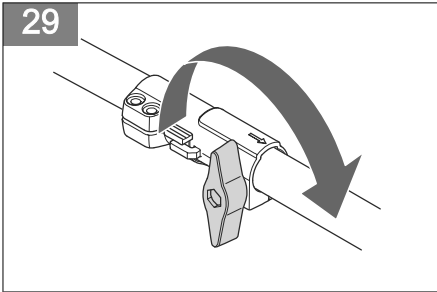
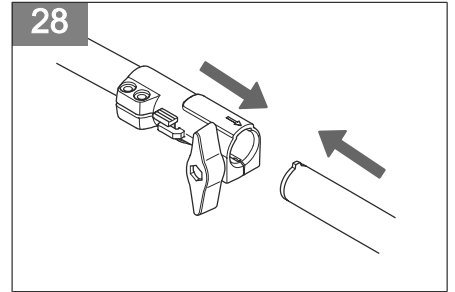
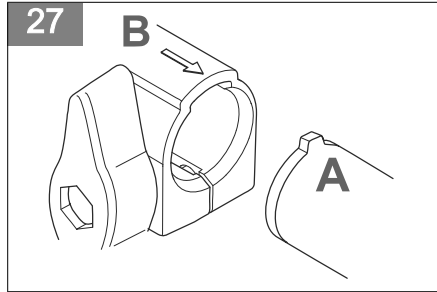
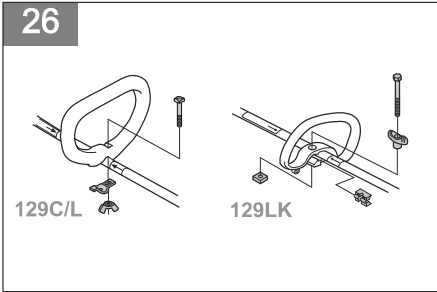

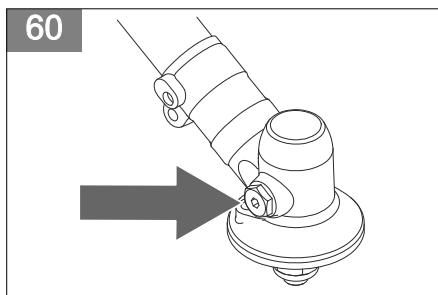
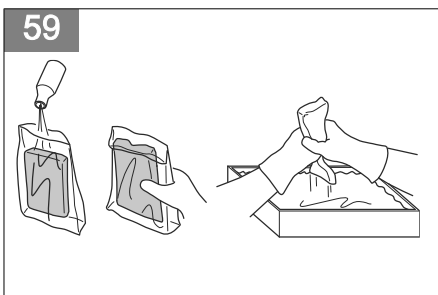
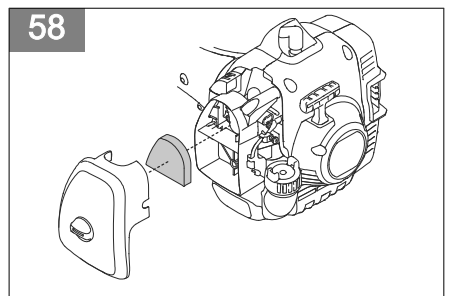
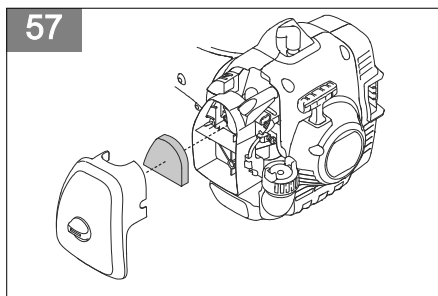
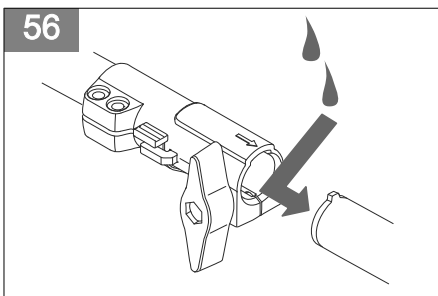
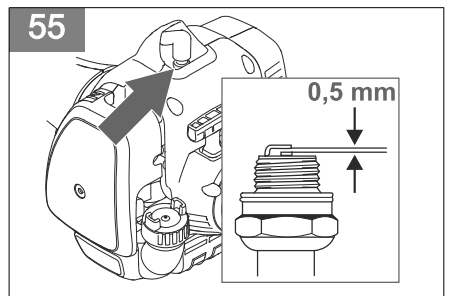
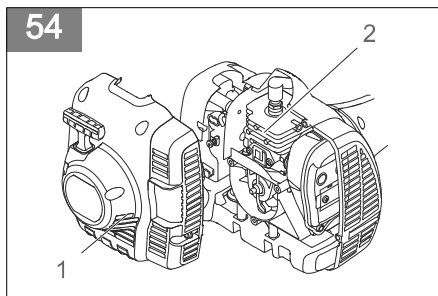
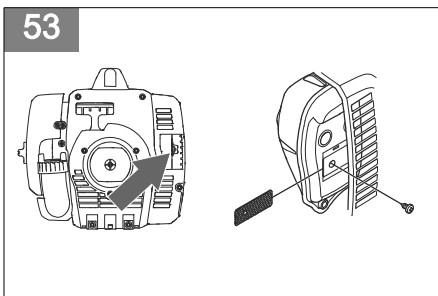
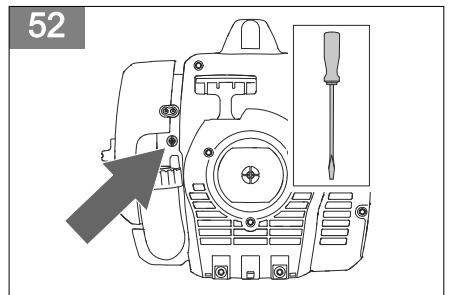
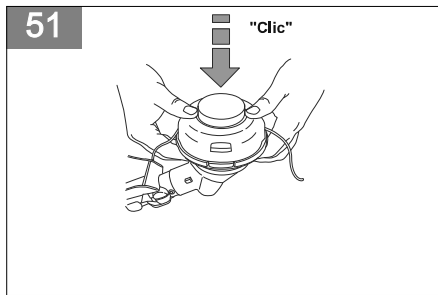
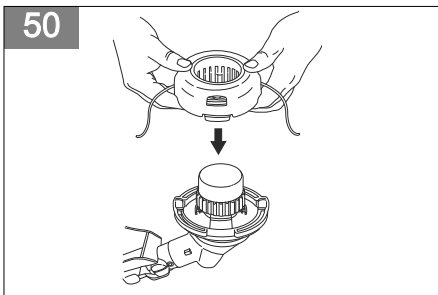
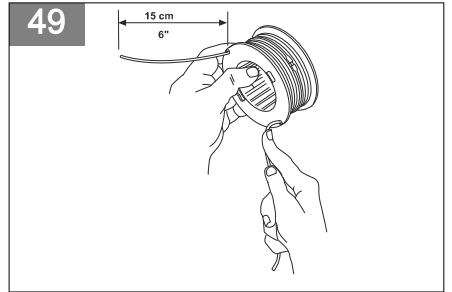
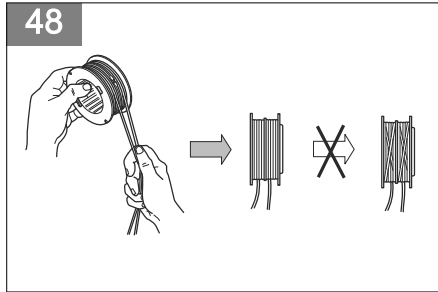
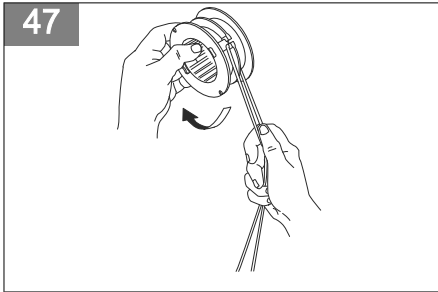
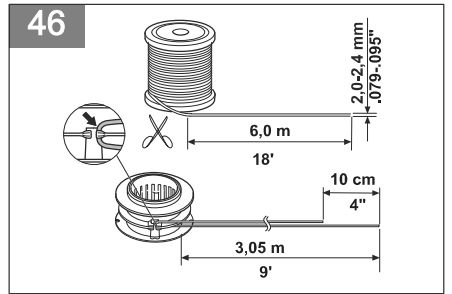
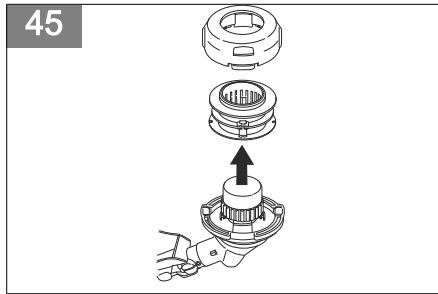
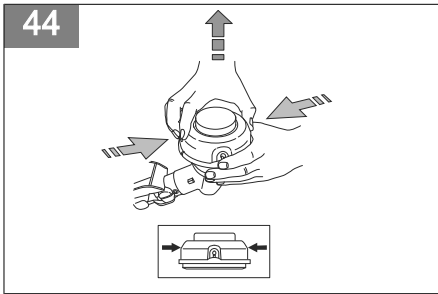

---

# Contents

---

Introduction.....	5	MAINTENANCE.....	11
Safety.....	6	TECHNICAL DATA.....	12
ASSEMBLY.....	9	ACCESSORIES.....	13
OPERATION.....	9	CONTENTS OF THE EC DECLARATION OF CONFORMITY.....	13

---

## Introduction

---

### Operator's manual

The initial language of this operator's manual is English. Operator's manuals in other languages are translations from English.

### Overview

(Fig. 1)

1. Trimmer head
2. Grease filler cap
3. Bevel gear
4. Cutting attachment guard
5. Shaft
6. Shaft coupling
7. Loop handle
8. Throttle trigger
9. Stop switch
10. Throttle trigger lockout
11. Spark plug cap, spark plug
12. Starter housing
13. Starter rope handle
14. Fuel tank
15. Air filter cover
16. Primer bulb
17. Choke control
18. Drive disc
19. Operator's manual

(Fig. 7) The product can cause objects to eject, which can cause damage to the eyes.

(Fig. 8) The product can cause objects to eject, which can cause damage to the eyes.

(Fig. 9) Max. speed of the output shaft.

(Fig. 10) Safe distance

(Fig. 11) Only use an approved trimmer line. Do not use a blade.

(Fig. 12) Do not use a cutting attachment made of metal.

(Fig. 13) Make sure that long hair is put up above your shoulders.

(Fig. 14) The arrows show the limits for the position of the handle.

(Fig. 15) Sound power level.

(Fig. 16) Noise level

(Fig. 17) The product agrees with the applicable EC directives.

(Fig. 18) The product agrees with the applicable EAC directives.

(Fig. 19) The product agrees with the applicable Ukraine directives.

### Symbols on the product

(Fig. 2) Warning

(Fig. 3) Read this manual.

(Fig. 4) Use approved head protection.

(Fig. 4) Use approved hearing protection.

(Fig. 4) Use approved eye protection.

(Fig. 5) Use approved protective gloves.

(Fig. 6) Use protective shoes/boots.

---

**Note:** Other symbols/decals on the product refer to certification requirements for other commercial areas.

---

## Product liability

As referred to in the product liability laws, we are not liable for damages that our product causes if:

- the product is incorrectly repaired.
- the product is repaired with parts that are not from the manufacturer or not approved by the manufacturer.
- the product has an accessory that is not from the manufacturer or not approved by the manufacturer.

- the product is not repaired at an approved service center or by an approved authority.

## EU V



**WARNING:** Tampering with the engine voids the EU type-approval of this product.

---

## Safety

---

### Safety definitions

The definitions below give the level of severity for each signal word.



**WARNING:** Injury to persons.



**CAUTION:** Damage to the product.

**Note:** This information makes the product easier to use.

### General safety instructions

- Use the product correctly. Injury or death is a possible result of incorrect use. Only use the product for the tasks found in this manual. Do not use the product for other tasks.
  - Obey the instructions in this manual. Obey the safety symbols and the safety instructions. If the operator does not obey the instructions and the symbols, injury, damage or death is a possible result.
  - Do not discard this manual. Use the instructions to assemble, to operate and to keep your product in good condition. Use the instructions for correct installation of attachments and accessories. Only use approved attachments and accessories.
  - Do not use a damaged product. Obey the maintenance schedule. Only do the maintenance work that you find an instruction about in this manual. An approved service center must do all other maintenance work.
  - This manual cannot include all situations that can occur when you use the product. Be careful and use your common sense. Do not operate the product or do maintenance to the product if you are not sure about of the situation. Speak to a product expert, your dealer, service agent or approved service center for information.
- Disconnect the spark plug cable before you assemble the product, put the product into storage or do maintenance.
  - Do not use the product if it is changed from its initial specification. Do not change a part of the product without approval from the manufacturer. Only use parts that are approved by the manufacturer. Injury or death is a possible result of incorrect maintenance.
  - Do not breathe in the fumes from the engine. Long term inhalation of the engine's exhaust fumes is a health risk.
  - Do not start the product indoors or near flammable material. The exhaust fumes are hot and can contain a spark which can start a fire. Not sufficient airflow can cause injury or death because of asphyxiation or carbon monoxide.
  - When you use this product the engine makes an electromagnetic field. The electromagnetic field can cause damage to medical implants. Speak to your physician and medical implant manufacturer before you operate the product.
  - Do not let a child operate the product. Do not let a person, without knowledge of the instructions operate the product.
  - Make sure that you always monitor a person, with decreased physical capacity or mental capacity, that uses the product. A responsible adult must be there at all times.
  - Lock the product in an area that children and unapproved persons cannot access.
  - The product can eject objects and cause injuries. Obey the safety instructions to decrease the risk of injury or death.
  - Do not go away from the product when the engine is on.
  - The operator of the product is responsible if an accident occurs.
  - Make sure that parts are not damaged before you use the product.
  - Make sure that you are at a minimum 15 m (50 ft) away from other persons or animals before you use the product. Make sure that a person in adjacent area knows that you will use the product.

- Refer to national or local laws. They can prevent or decrease the operation of the product in some conditions.
- Do not use the product if you are fatigued or influenced by alcohol, drugs or medicine. They can have effects on your vision, alertness, coordination or judgment.

## Safety instructions for operation

- Make sure the product is fully assembled before you use it.
- Before a start, move the product 3 m (10 ft) away from the position where you filled the fuel tank. Put the product on a flat surface. Make sure that the cutting attachment does not touch the ground or other objects.
- The product can cause objects to eject, which can cause damage to the eyes. Always use an approved eye protection when you operate the product.
- Be careful, a child can come near the product without your knowledge during operation.
- Do not operate the product if there are persons in the work area. Stop the product if a person goes into the work area.
- Make sure that you are always in control of the product.
- Do not use the product if you cannot receive aid if an accident occurs. Always make sure others know you will operate the product before you start to operate the product.
- Do not turn with the product before you make sure that no persons or animals are in the safety area.
- Remove all unwanted materials from the work area before you start. If the cutting attachment hits an object, the object can eject and cause injury or damage. Unwanted material can wind around the cutting attachment and cause damage.
- Do not use the product in bad weather (fog, rain, strong winds, risk of lightning or other weather conditions.). Dangerous conditions (such as slippery surfaces) can occur because of bad weather.
- Make sure that you can move freely and work in a stable position.

(Fig. 20)

- Make sure that you cannot fall when you use the product. Do not tilt when you operate the product.
- Always hold the product with your two hands. Hold the product on the right side of your body.

(Fig. 21)

- Operate the product with the cutting attachment below your waist.
- If the choke control is in the choke position when the engine starts, the cutting attachment starts to turn.
- Do not touch the bevel gear after the engine stops. The bevel gear is hot after the engine stops. Hot areas can cause injury.
- Stop the engine before you move the product.
- Do not put down the product with the engine on.

- Before you remove the unwanted materials from the product, stop the engine and wait until the cutting attachment stops. Let the cutting attachment stop before you or an aid remove the cut material.

## Personal protective equipment

- Always use correct personal protective equipment when you operate the product. The personal protective equipment does not erase the risk of injury. The personal protective equipment decreases the grade of injury if an accident occurs.
- Always use an approved eye protection while you operate the product.
- Do not operate the product with bare feet or with open shoes. Always use heavy-duty slip-resistant boots.
- Use heavy, long pants.
- If it is necessary, use approved protective gloves.
- Use a helmet if it is possible that objects fall on your head.
- Always use approved ear protection while you operate the product. Noise for a long period can cause noise-induced hearing loss.
- Make sure that you have a first aid kit near.

## Protective devices on the product

- Make sure that you regularly do the maintenance to the product.
  - The life of the product increases.
  - The risk of accidents decreases.

Let an approved dealer or an approved service center regularly examine the product to do adjustments or repairs.

- Do not use a product with damaged protective equipment. If the product is damaged, speak to an approved service center.

## Throttle trigger lockout

The throttle trigger lockout locks the throttle trigger. (Fig. 22)

Push the throttle trigger lockout (A) to release the throttle trigger (B). When you release the handle, the throttle trigger lockout and the throttle trigger go back to their initial positions.

1. Make sure that the throttle trigger (B) is locked at idle when you release the throttle trigger lockout (A).
2. Push the throttle trigger lockout (A) and make sure that it goes back to its initial position when you release it.
3. Push the throttle trigger (B) and make sure that it goes back to its initial position when you release it.

Start the engine, and then apply full throttle. Release the throttle trigger and examine if the cutting attachment stops. If the cutting attachment turns with the throttle in the idle position, examine the idle adjustment screw of the carburetor.

## Stop switch

Start the engine. Make sure that the engine stops when you move the stop switch to the stop position.

(Fig. 23)

## Cutting attachment guard

The cutting attachment guard prevents a loose object to eject in the direction of the operator.

(Fig. 24)

Examine the cutting attachment guard for damage and replace if it is damaged. Only use the approved guard for the cutting attachment.

## Muffler

- Do not use an engine with a damaged muffler. A damaged muffler increases the noise level and the risk of fire. Keep a fire extinguisher near.
- Examine regularly that the muffler is attached to the product.
- Do not touch the engine or the muffler when the engine is on. Do not touch the engine or the muffler for a while after the engine stops. Hot surfaces can cause injuries.
- A hot muffler can cause a fire. Be careful, if you use the product near flammable liquids or fumes.
- Do not touch the parts in the muffler, if the muffler is damaged. The parts can contain some carcinogenic chemicals.

## Cutting attachment

- Do the regular maintenance. Let an approved service center regularly examine the cutting attachment to do adjustments or repairs.
  - The performance of the cutting attachment increases.
  - The life of the cutting attachment increases.
  - The risk of accidents decreases.
- Only use an approved cutting attachment guard. For more information, see *TECHNICAL DATA on page 12*.
- Do not use a damaged cutting attachment.

## Grass trimmer head

- Make sure that you wind the grass trimmer line tightly and equally around the drum to decrease the vibration.
- Use only the approved grass trimmer heads and grass trimmer lines. See *TECHNICAL DATA on page 12*.
- Use a correct length of the grass trimmer line. A long grass trimmer line uses more engine power than a short grass trimmer line.
- Make sure that the cutter on the cutting attachment guard is not damaged.
- Soak the grass trimmer line in water for 2 days before you attach the grass trimmer line to the

product. This increases the life of the grass trimmer line.

## Fuel safety

- Do not start the product if there is fuel or engine oil on the product. Remove the unwanted fuel/oil and let the product dry. Remove unwanted fuel from the product.
- If you spill fuel on your clothing, change clothing immediately.
- Do not get fuel on your body, it can cause injury. If you get fuel on your body, use a soap and water to remove the fuel.
- Do not start the engine if you spill oil or fuel on the product or on your body.
- Do not start the product if the engine has a leak. Examine the engine for leaks regularly.
- Be careful with fuel. Fuel is flammable and the fumes are explosive and can cause injuries or death.
- Do not breathe in the fuel fumes, it can cause injury. Make sure that there is a sufficient airflow.
- Do not smoke near the fuel or the engine.
- Do not put warm objects near the fuel or the engine.
- Do not add the fuel when the engine is on.
- Make sure that the engine is cool before you refuel.
- Before you refuel, open the fuel tank cap slowly and release the pressure carefully.
- Do not add fuel to the engine in an indoor area. Not sufficient airflow can cause injury or death because of asphyxiation or carbon monoxide.
- Tighten the fuel tank cap carefully or a fire can occur.
- Move the product at a minimum of 3 m (10 ft) from the position where you filled the tank before a start.
- Do not put too much fuel in the fuel tank.
- Make sure that a leak cannot occur when you move the product or fuel container.
- Do not put the product or a fuel container where there is an open flame, spark or pilot light. Make sure that the storage area does not contain an open flame.
- Only use approved containers when you move the fuel or put the fuel into storage.
- Empty the fuel tank before long-term storage. Obey the local law on where to dispose fuel.
- Clean the product before long-term storage.
- Remove the spark plug cable before you put the product into storage to make sure that the engine does not start accidentally.

## Safety instructions for maintenance

- If you cannot adjust the idle speed to make the cutting attachment stop, speak to your service center. Do not use the product until the product is correctly adjusted or repaired.



## ASSEMBLY



**WARNING:** Read the safety chapter before you assemble the product.

### To attach the loop handle

1. Attach the loop handle to the shaft in compliance with the illustration and tighten. (Fig. 25)
2. Make sure that the loop handle attaches between the arrows on the shaft.

### To assemble the two-piece shaft

1. Turn the knob to loosen the shaft coupling. (Fig. 26)
2. Align the tab of the shaft (A) with the arrow on the shaft coupling (B). (Fig. 27)
3. Push the shaft into the shaft coupling until the shaft attaches. (Fig. 28)
4. Make sure that you tighten the knob before you use the product. (Fig. 29)

### To disassemble the two-piece shaft

1. Turn the knob to loosen the shaft coupling. (Fig. 30)
2. Push and hold the button (C). (Fig. 31) Hold the engine end and pull the shaft out of the shaft coupling.

### To assemble the cutting attachment

#### To attach the cutting attachment guard and the trimmer head (straight shaft)

1. Attach the cutting attachment guard (A) to the shaft with the bolt (L). (Fig. 32) Make sure to use the correct cutting attachment guard and the correct trimmer head.
2. Attach the drive disc (B) to the output shaft.
3. Turn the output shaft until the hole in the drive disc aligns with the hole in the gear housing.
4. Put a small screwdriver (C) in the hole to lock the shaft. (Fig. 32)
5. Turn the trimmer head (H) counterclockwise to tighten the trimmer head to the gearbox. (Left hand threads.) (Fig. 33)

#### To attach the cutting attachment guard and trimmer head (curved shaft)

1. Attach the guard. (Fig. 34) Tighten the nut.
2. Attach the dust cup on the shaft. (Fig. 35)
3. Hold the dust cup with an adjustable wrench to make sure the shaft does not turn.
4. Attach the trimmer head to the shaft. Turn the trimmer head clockwise.

## OPERATION



**WARNING:** Read and understand the safety chapter before you operate the product.

### Fuel

#### To use fuel



**CAUTION:** This product has a two-cycle engine. Use a mixture of gasoline and two-cycle engine oil. Make sure to use the correct quantity of oil in the mixture. Incorrect ratio of gasoline and oil can cause damage to the engine.

### Gasoline



**CAUTION:** Do not use gasoline with an octane number less than 90 RON (87 AKI). This can cause damage to the product.



**CAUTION:** Do not use gasoline with more than 10% ethanol concentration (E10). This can cause damage to the product.

- Always use new unleaded gasoline with a minimum octane number of 90 RON (87 AKI) and with less than 10% ethanol concentration (E10).
- Use gasoline with a higher octane number if you frequently use the product at continuously high engine speed.

### Two-cycle engine oil

- Use only high quality two-cycle engine oil. Use only an air cooled engine oil.
- Do not use other types of oil.
- Mixture ratio 50:1 (2%)

Gasoline	Oil
1 U.S. Gal.	77 ml (2,6 oz)
1 UK Gal.	95 ml (3,2 oz)
5 l	100 ml (3,4 oz)

## To make the fuel mixture

---

**Note:** Always use a clean fuel container when you mix the fuel.

---

**Note:** Do not make more than 30 days quantity of fuel mixture.

---

1. Add half of the gasoline quantity.
2. Add the full quantity of oil.
3. Shake the fuel mixture to mix the contents.
4. Add the remaining gasoline quantity.
5. Shake the fuel mixture to mix the contents.
6. Fill the fuel tank.

## To add fuel

- Always use a fuel container with an antispill valve.
- If there is some fuel on the container, remove the unwanted fuel and let the container dry.
- Make sure that the area near the fuel tank cap is clean.
- Shake the fuel container before you add the fuel mixture to the fuel tank.

## To start and stop

### Before you start the engine

- Examine the product for missing, damaged, loose or worn parts.
- Examine the nuts, screws and bolts.
- Examine the air filter.
- Examine the throttle trigger lockout and the throttle control for correct operation.
- Examine the stop switch for correct operation.
- Examine the product for fuel leaks.
- Examine the saw chain sharpness and tension.

### To start a cold engine

1. Push the primer bulb 10 times. (Fig. 36)
2. Pull the choke control up. (Fig. 37)
3. Hold the body of the product on the ground with your left hand. (Fig. 38) Do not step on the product. Pull the starter rope handle slowly until you feel some resistance. Then pull the starter rope handle with force.

**Note:** Do not pull the throttle trigger while you start the engine.

---

4. Continue to pull the starter rope handle until the engine starts or tries to start (max. 3 pulls). If the engine starts or tries to start, push the choke control down. Continue to pull until the engine starts. Wait 60 seconds after a start before you pull the throttle trigger.



**CAUTION:** Do not pull the starter rope until it stops. Do not let go of the starter rope when it is fully extended. Release the starter rope slowly. Failure to obey these instructions can cause damage to the engine.

---

## To start a warm engine

1. Push the primer bulb 10 times.
2. Pull the starter rope until the engine starts.

## To stop

- Push the stop switch to stop the engine. (Fig. 39)
- 

**Note:** The stop switch automatically goes back to its initial position.

---

## To operate the grass trimmer

---



**CAUTION:** Make sure that you slow the engine to idle speed after each operation. A long period at full throttle without a load on the engine can cause damage to the engine.

---

**Note:** Clean the cover of the trimmer head when you attach a new trimmer line to prevent vibrations. Examine other parts of the trimmer head and clean if it is necessary.

---

## To trim the grass

1. Hold the trimmer head immediately above the ground at an angle. (Fig. 40) Do not push the grass trimmer line into the grass.
2. Decrease the length of the grass trimmer line by 10-12 cm (4-4.75 in) and decrease engine speed to decrease the risk of damage to plants.
3. Use 80 % throttle when you cut grass near objects. (Fig. 41)

## To cut the grass

1. Make sure that the grass trimmer line is parallel to the ground when you cut. (Fig. 42)
2. Do not push the trimmer head to the ground. The ground and the product can be damaged.
3. Do not let the trimmer head touch the ground continuously, it can cause damage to the trimmer head.
4. Use full throttle when you move the product from side to side to cut grass. (Fig. 43) Make sure that the grass trimmer line is parallel to the ground.

## To replace the trimmer line

(Fig. 44)  
(Fig. 45)

(Fig. 46)

(Fig. 47)

(Fig. 48)

(Fig. 49)

(Fig. 50)

(Fig. 51)

---

## MAINTENANCE

---



**WARNING:** Read and understand the safety chapter before you clean, repair or do maintenance on the product.

### Maintenance schedule

Make sure that you obey the maintenance schedule. The intervals are calculated from daily use of the product. The intervals are different if you do not use the product each day. Only do the maintenance work that is found in this manual. Speak to an approved service center about other maintenance work not found in this manual.

#### Weekly maintenance

- Clean the external surfaces.
- Examine the idle speed.
- Examine the bevel gear grease (straight shaft).

#### Monthly maintenance

- Examine the starter rope handle and the starter rope.

#### Yearly maintenance

- Examine the spark plug.
- Apply grease to the end of the drive shaft (two-piece shaft).
- Clean the external surfaces of the carburetor and its adjacent areas.
- Clean the cooling system.
- Examine the spark arrester screen.
- Examine the fuel filter.
- Examine the fuel hose for damage.
- Examine all cables and connections.

#### 50 hours maintenance

- Have an approved service center repair or replace the muffler.

### To adjust the idle speed

- Make sure that the air filter is clean and the air filter cover is attached before you adjust the idle speed.
- Adjust the idle speed with the idle adjustment screw T which is identified with "T" mark.
- The idle speed is correct when the engine operates smoothly in all positions. The idle speed must be below the speed when the cutting attachment starts to turn.

1. Turn the idle adjustment screw clockwise until the cutting attachment starts to turn. (Fig. 52)

2. Turn the idle adjustment screw counterclockwise until the cutting attachment stops.

### To do maintenance on the spark arrester screen

Use a wire brush to clean the spark arrester screen. (Fig. 53)

### To clean the cooling system

Clean the parts of the cooling system with a brush. (Fig. 54)

### To examine the spark plug



**CAUTION:** Use the recommended spark plug. Make sure that the replacement is the same as the manufacturer supplied part. An incorrect spark plug can cause damage to the product.

1. Examine the spark plug when:
  - a) the engine is low on power.
  - b) the engine is not easy to start.
  - c) the engine does not operate correctly at idle speed.
2. If, the engine is not easy to start or operate, examine the spark plug for unwanted materials. To decrease the risk of unwanted material on the spark plug electrodes:
  - a) make sure that the idle speed is correctly adjusted.
  - b) make sure that the fuel mixture is correct.
  - c) make sure that the air filter is clean.
3. Clean the spark plug if it is dirty. Examine that the electrode gap is correct. (Fig. 55)
4. Replace the spark plug when it is necessary.

### To apply grease to the two-piece shaft

- Apply grease to the end of the drive shaft after each 30 hours of operation. (Fig. 56)

### To do the maintenance to the air filter

#### To clean the air filter

1. Remove the air filter cover and remove the air filter. (Fig. 57)
2. Clean the air filter with warm soap water. Make sure that the air filter is dry before you install it.

- Replace the air filter if it is too dirty to fully clean it. Always replace a damaged air filter.
- If your product has a foam air filter, apply air filter oil. Only apply air filter oil to a foam filter. Do not apply oil to a felt filter.

### To apply air filter oil to the air filter



**CAUTION:** Always use special air filter oil on foam air filters. Do not use other types of oil.



**WARNING:** Do not get oil on your body.

- Remove the air filter cover and remove the air filter. (Fig. 58)

- Put the air filter in a plastic bag.
- Put the air filter oil in the plastic bag. (Fig. 59)
- Push the plastic bag to make sure the oil supplies equally across the air filter.
- Push on the air filter, while in the bag, to remove the air filter oil that is not necessary. Remove the air filter from the bag.
- Install the air filter.

### To add grease to the bevel gear

Make sure that the bevel gear is filled 3/4 full with bevel gear grease.

(Fig. 60)

## TECHNICAL DATA

	unit	129C (A05328CCHV)	129L (A05328CSHV)	129LK (A05328CSHV)
<b>Engine Specifications</b>				
Cylinder displacement	cm <sup>3</sup>	27,6	27,6	27,6
Electrode gap	mm	0,5	0,5	0,5
Fuel tank volume	cm <sup>3</sup>	343	343	343
Idling speed	min <sup>-1</sup>	2800 - 3200	2800 - 3200	2800 - 3200
Maximum power speed	min <sup>-1</sup>	8000	8000	8000
Power output	kW	0,85	0,85	0,85
Spark plug		Husqvarna HQT-4	Husqvarna HQT-4	Husqvarna HQT-4
Maximum output shaft rotation	min <sup>-1</sup>	8500	7200	7200
<b>Noise and Vibration Data</b>				
Equivalent vibration level (ahv, eq) left handle - see note 1	m/s <sup>2</sup>	3,64	9,9	9,9
Equivalent vibration level (ahv, eq) right handle - see note 1	m/s <sup>2</sup>	3,59	8,9	8,9
Sound power level, guaranteed (L <sub>WA</sub> ) - see note 2	dB(A)	114	114	114
Sound power level, measured - see note 2	dB(A)	106	105	106
Sound pressure level at operator's ear - see note 3	dB(A)	93	95	95
<b>Product Dimensions</b>				
Weight (excluding cutting equipment)	kg	4,61	5,21	5,98

**Note 1:** Reported data for equivalent vibration level has a typical statistical dispersion (standard deviation) of 1 m/s<sup>2</sup>.

**Note 2:** Noise emissions in the environment measured as sound power ( $L_{WA}$ ) in conformity with EC directive 2000/14/ EC. Reported sound power level for the machine has been measured with the original cutting attachment that gives the highest level. The difference between guaranteed and measured sound power is that the guaranteed sound power also includes dispersion in the measurement result and the variations between different machines of the same model according to Directive 2000/14/EC.

**Note 3:** Reported data for equivalent sound pressure level for the machine has a typical statistical dispersion (standard deviation) of 1 dB (A).

## ACCESSORIES

129C		
Approved accessories	Type	Cutting attachment guard
Thread shaft (3/8 R)		
Trimmer head	T25 (Ø 2.0 - 2.4 mm)	580 44 66-10
129L, 129LK		
Approved accessories	Type	Cutting attachment guard
Threaded shaft (M10L)		
Trimmer head	T25 (Ø 2.0 - 2.4 mm)	580 44 66-06

Optional accessories	Type	Use with
Sweeper attachment with shaft	SR600	129LK
Hedge trimmer attachment with shaft	HA860	129LK
Edger attachment with shaft	ECA850, ESA860	129LK
Saw attachment with shaft	PA1100	129LK
Cultivator attachment with shaft	CA230	129LK
Grass trimmer attachment with shaft	TA850	129LK
Saw attachment with shaft	PAX1100	129LK
Saw attachment with shaft	PAX730	129LK

## CONTENTS OF THE EC DECLARATION OF CONFORMITY

We, Husqvarna AB, SE 561 82 Huskvarna, SWEDEN, declare under our sole responsibility that the represented product:

Description	Gasoline Grass Trimmer / Brushcutter
Brand	Husqvarna

<b>Description</b>	<b>Gasoline Grass Trimmer / Brushcutter</b>
Platform / Type / Model	Platform A05328CCHV, representing model 129C  Platform A05328CSHV, representing models 129L and 129LK
Batch	Serial number dating 2013 and onwards

complies fully with the following EU directives and regulations:

<b>Directive/Regulation</b>	<b>Description</b>
2006/42/EC	“relating to machinery”
2014/30/EU	“relating to electromagnetic compatibility”
2000/14/EC	“relating to outdoor noise”

Harmonized standards and/or technical specifications applied are as follows: EN ISO 12100, EN ISO 11806-1, CISPR 12, ISO 14982

In accordance with directive 2000/14/EC, Annex V, the declared sound values are stated in the technical data section of this manual and in the signed EC Declaration of Conformity.

TÜV Rheinland N.A. has carried out a voluntary examination on behalf of Husqvarna AB, providing a Certificate of conformity to EC Council directive 2006/42/EC for machinery.

The certificate, as provided on the signed EC Declaration of Conformity, is applicable to all manufacturing locations and Countries of Origin, as stated on the product.

The supplied gasoline grass trimmer / brushcutter conforms to the example that underwent examination.