

# REA 60.0 PLUS

# ***STIHL***



2 - 25	Gebrauchsanleitung
25 - 47	Instruction Manual
47 - 72	Notice d'emploi
72 - 95	Istruzioni d'uso
95 - 118	Handleiding



STIHL Vertriebszentrale AG & Co. KG  
Robert-Bosch-Straße 13  
64807 Dieburg  
Telefon: +49 6071 3055358

## ÖSTERREICH

STIHL Ges.m.b.H.  
Fachmarktstraße 7  
2334 Vösendorf  
Telefon: +43 1 86596370

## SCHWEIZ

STIHL Vertriebs AG  
Isenrietstraße 4  
8617 Mönchaltorf  
Telefon: +41 44 9493030

## Contents

1	Introduction.....	25
2	Guide to Using this Manual.....	25
3	Overview.....	26
4	Safety Precautions.....	27
5	Preparing the pressure washer for operation.....	34
6	Charging the Battery, LEDs.....	34
7	Assembling the pressure washer.....	35
8	Connecting to a water source.....	36
9	Removing and Fitting the Battery.....	38
10	Switching the pressure washer on and off.....	38
11	Checking the high-pressure washer and battery.....	38
12	Operating the pressure washer.....	39
13	After Finishing Work.....	40
14	Transporting.....	41
15	Storing.....	41
16	Cleaning.....	42
17	Maintenance.....	43
18	Repairing.....	43
19	Troubleshooting.....	43
20	Specifications.....	45
21	Spare Parts and Accessories.....	46
22	Disposal.....	46
23	EC Declaration of Conformity.....	46
24	UKCA Declaration of Conformity.....	46
25	Addresses.....	47

## 1 Introduction

Dear Customer,

Thank you for choosing STIHL. We develop and manufacture our quality products to meet our customers' requirements. The products are

designed for reliability even under extreme conditions.

STIHL also stands for premium service quality. Our dealers guarantee competent advice and instruction as well as comprehensive service support.

STIHL expressly commit themselves to a sustainable and responsible handling of natural resources. This user manual is intended to help you use your STIHL product safely and in an environmentally friendly manner over a long service life.

We thank you for your confidence in us and hope you will enjoy working with your STIHL product.

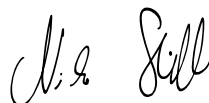

Dr. Nikolas Stihl

**IMPORTANT! READ BEFORE USING AND KEEP IN A SAFE PLACE FOR REFERENCE.**

## 2 Guide to Using this Manual

### 2.1 Applicable documents

The local safety regulations apply.

- In addition to this User Manual, you should also read, understand and retain the following documents:
  - Safety notes and precautions for the STIHL AK battery
  - User Manual for STIHL AL 101, 301, 501 chargers
  - Safety information for STIHL batteries and products with built-in battery:  
[www.stihl.com/safety-data-sheets](http://www.stihl.com/safety-data-sheets)
  - User Manual and packaging of the accessory used
  - User Manual and packaging of the cleaning agent used

### 2.2 Warning Notices in Text



**DANGER**

- This notice refers to risks which result in serious or fatal injury.
  - Serious or fatal injuries can be avoided by taking the precautions mentioned.

**WARNING**

- This notice refers to risks which **can** result in serious or fatal injury.
  - ▶ Serious or fatal injuries can be avoided by taking the precautions mentioned.

**NOTICE**

- This notice refers to risks which can result in damage to property.
  - ▶ Damage to property can be avoided by taking the precautions mentioned.

## 2.3 Symbols in Text



This symbol refers to a chapter in this instruction manual.

# 3 Overview

## 3.1 High-pressure washer and battery

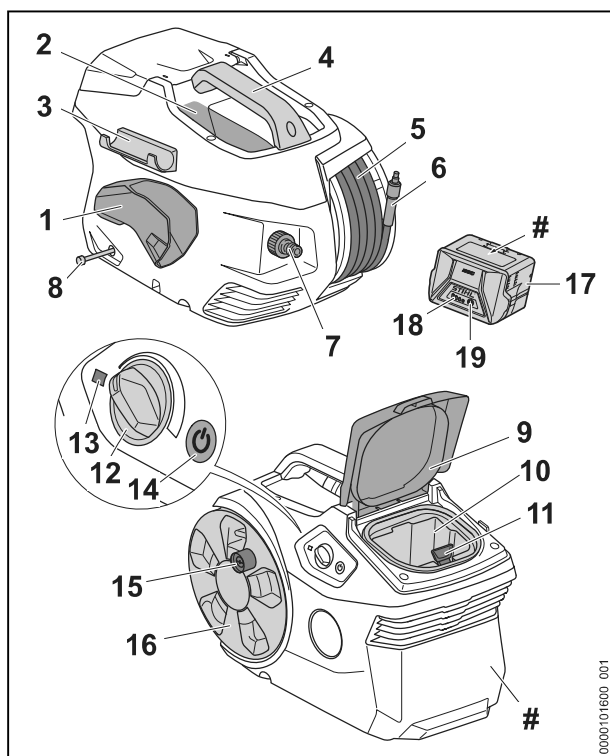

- 1 Holder**  
The holder is used to store the spray gun.
- 2 Compartment**  
The compartment is used to store the supplied nozzle.
- 3 Holder**  
The holder is used to store the spray lance.

- 4 Handle**  
The handle is used to carry the high-pressure washer.
- 5 High-pressure hose**  
The high-pressure hose transports the water from the high-pressure pump to the spray gun.
- 6 Connector**  
The connector connects the high-pressure hose with the spray gun.
- 7 Connector**  
The connector is used to connect the water hose.
- 8 Detergent hose**  
The detergent hose is used to suction the detergent.
- 9 Flap**  
The flap covers the battery compartment.
- 10 Battery compartment**  
The battery compartment holds the battery.
- 11 Locking lever**  
The locking lever holds the battery in the battery compartment.
- 12 Rotary control**  
The rotary control is used to set the operating pressure and the quantity of water.
- 13 LED**  
The LED indicates the status of the high-pressure washer.
- 14 Pushbutton**  
The pushbutton is used to switch the high-pressure washer on and off.
- 15 Crank handle**  
The crank handle is used to turn the hose reel.
- 16 Hose reel**  
The hose reel is used to coil the high-pressure hose.
- 17 Battery**  
The battery supplies power to the high-pressure washer.
- 18 LEDs**  
The LEDs indicate the state of charge of the battery and any faults.
- 19 Button**  
The pushbutton activates the LEDs on the battery.
- # Rating plate with machine number**

### 3.2 Spray attachment

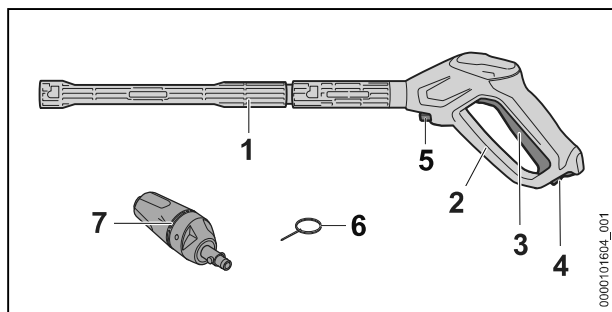

#### 1 Spray lance

The spray lance connects the spray gun to the nozzle.

#### 2 Spray gun

The spray gun is used to hold and control the spray attachment.

#### 3 Levers

The trigger opens and closes the valve in the spray gun. The trigger starts and stops the water jet.

#### 4 Retaining latch

The retaining latch releases the trigger.

#### 5 Locking lever

The locking lever holds the connector in the spray gun.

#### 6 Cleaning pin

The cleaning pin is used to clean the nozzles.

#### 7 3-in-1 nozzle

The 3-in-1 nozzle consists of a fan-jet nozzle, a rotary nozzle and a spray nozzle to which a cleaning agent can be added.

### 3.3 Symbols

Meanings of the symbols that may be attached to the high-pressure washer, the spray attachment and the battery:



In this position, the retaining latch unlocks the lever.



In this position, the retaining latch locks the lever.



This product is designed for use with a STIHL battery. Permissible batteries are listed in this User Manual.



1 LED lights up red. The battery is too warm or too cold.



4 LEDs flash red. There is an error in the battery.



**L<sub>WA</sub>** Guaranteed sound power level in accordance with Directive 2000/14/EC in dB(A) for the purpose of comparing the sound emissions of products.



The information next to the symbol indicates the energy content of the battery according to the cell manufacturer's specification. The energy content available in operation is lower.



Do not dispose of the product with your household waste.



These symbols indicate original STIHL spare parts and original STIHL accessories.

## 4 Safety Precautions

### 4.1 Warning symbols

The warning symbols on the high-pressure washer or on the battery have the following meanings:



Observe safety notices and take the necessary precautions.



Read and understand the User Manual and keep it in a safe place for reference.



Wear safety glasses.



- Do not direct the water jet at people and animals.
- Do not direct the water jet at electrical systems, electrical connections, sockets and live cables.
- Do not direct the water jet at electrical appliances and at the high-pressure washer.



Do not connect the high-pressure washer directly to the drinking water supply.

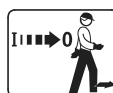

Switch off high-pressure washer during breaks from operation and before transport, storage, servicing or repair.



Do not use, transport and store the high-pressure washer at temperatures below 0°C.



Remove the battery during work interruptions, transport, storage, maintenance or repair.



Protect the battery against heat and fire.



Protect the battery against rain and moisture and do not immerse it in liquids.

## 4.2 Intended Use

The STIHL REA 60.0 PLUS high-pressure washer is used to clean vehicles, trailers, patios, paths and facades, for example.

The high-pressure washer is not suitable for commercial use.

The high-pressure washer may be used in the rain.

The STIHL AK battery supplies power to the high-pressure washer.

### **⚠ WARNING**

- Batteries not explicitly approved by STIHL for the high-pressure washer may cause a fire or explosion. Persons may be seriously or fatally injured, and property may be damaged.
  - ▶ Use a STIHL AK battery to operate the high-pressure washer.
- Using the high-pressure washer or battery other than for its intended use can result in serious injuries or death and damage to property.
  - ▶ Always use the high-pressure washer and the battery as described in this User Manual.

The STIHL REA 60.0 PLUS high-pressure washer is not designed for the following uses:

- Cleaning asbestos cement and similar surfaces
- Cleaning surfaces painted or varnished with paints containing lead
- Cleaning surfaces which come into contact with foodstuffs
- Cleaning the high-pressure washer itself

## 4.3 Requirements for users

### **⚠ WARNING**

- Users who have not received instruction are not aware of and cannot assess the dangers of the high-pressure washer and the battery. The user or other persons may sustain serious or fatal injuries.



▶ Read and understand the User Manual and keep it in a safe place for reference.

- ▶ If allowing another person to use the high-pressure washer or battery: Give them the user manual as well.
- ▶ Make sure that the user meets the following conditions:

- The user is rested.

- This machine and the battery must not be used by persons (including children) with impaired physical, sensory or mental abilities or lack of experience and know-how.

- The user can identify and assess the dangers of the high-pressure washer and the battery.

- The user is an adult or is being trained in an occupation under supervision according to national regulations.

- The user has received instruction from a STIHL dealer or other expert before operating the high-pressure washer for the first time.

- The user is not under the influence of alcohol, medication or drugs.

- ▶ If you are unsure: Contact a STIHL authorized dealer.

## 4.4 Clothing and equipment

### **⚠ WARNING**

- Objects may be thrown into the air at high speed while working. The user may be injured.



▶ Wear close fitting safety glasses. Suitable safety glasses tested to standard EN 166 or national standards and bearing the corresponding mark are available to buy.

- ▶ Wear a long sleeved, close fitting top and long trousers.
- Spray (aerosols) may form while operating. Breathing in aerosols can be harmful to health and trigger allergic reactions.
  - ▶ Carry out a risk assessment according to the surface to be cleaned and the surrounding area.
  - ▶ If the risk assessment shows formation of aerosols: Wear a respirator of protection class FFP2 or equivalent protection class.
- Wearing unsuitable footwear can cause the user to slip and fall. The user may be injured.
  - ▶ Wear sturdy, enclosed footwear with non-slip soles.

## 4.5 Work Area and Surroundings

### 4.5.1 High-pressure washer

#### **WARNING**

- Bystanders, children and animals are not aware of the dangers of the high-pressure washer and objects being thrown into the air and cannot assess them. This may result in serious injury to bystanders, children and animals and damage to property.
  - ▶ Keep bystanders, children and animals away from the working area.
  - ▶ Do not leave the high-pressure washer unattended.
  - ▶ Ensure that children cannot play with the high-pressure washer.
- Electrical components of the high-pressure washer can produce sparks. Sparks may cause fires and explosions in highly flammable or explosive environments. Persons may be seriously or fatally injured, and property may be damaged.
  - ▶ Do not work in a highly flammable or explosive environment.

### 4.5.2 Battery

#### **WARNING**

- Bystanders, children and animals cannot recognize or assess the dangers of the battery. Bystanders, children and animals may be seriously injured.

- ▶ Keep bystanders, children and animals away from the work area.
- ▶ Do not leave the battery unattended.
- ▶ Make sure that children cannot play with the battery.
- The battery is not protected against all ambient conditions. If the battery is exposed to certain ambient conditions, the battery may catch fire, explode or be irreparably damaged. This may result in serious injury to people and damage to property.



- ▶ Protect battery from heat and fire.
- ▶ Do not throw the battery into a fire.

- ▶ Do not charge, use and store the battery outside of the specified temperature limits,  20.3.



- ▶ Protect the battery from rain and moisture and do not immerse it in liquids.

- ▶ Keep battery away from small metal parts.
- ▶ Do not expose the battery to high pressure.
- ▶ Do not expose the battery to microwaves.
- ▶ Protect the battery from chemicals and salts.

## 4.6 Safe Condition

### 4.6.1 High-pressure washer

The high-pressure washer is in a safe condition if the following conditions are met:

- The high-pressure washer is undamaged.
- The flap is closed and undamaged.
- The high-pressure hose, the handle, the couplings and the spray attachment are undamaged.
- The spray attachment is correctly attached.
- The high-pressure washer is clean.
- The spray attachment is clean.
- The controls function properly and have not been modified.
- An original STIHL accessory for this high-pressure washer is fitted.
- The accessories are correctly installed.

#### **WARNING**

- If not in safe condition, components may no longer operate correctly, and safety devices may be rendered ineffective. There is a risk of serious or fatal injury.
  - ▶ Never use a damaged high-pressure washer.
  - ▶ Never use a damaged high-pressure hose, couplings or spray attachment.

- ▶ Always attach the spray attachment as described in this User Manual.
- ▶ If the high-pressure washer is dirty: Clean the high-pressure washer.
- ▶ If the spray attachment is dirty: Clean the spray attachment.
- ▶ If the battery compartment is moist or wet: Allow the battery compartment to dry.
- ▶ Do not modify the high-pressure washer.
- ▶ If the controls do not work: Do not operate the high-pressure washer.
- ▶ Fit original STIHL accessories for this high-pressure washer.
- ▶ Install accessories as described in this User Manual or in the User Manual for the accessories.
- ▶ Do not insert objects into the openings in the high-pressure washer.
- ▶ Replace worn or damaged labels.
- ▶ If you are unsure: Contact a STIHL authorized dealer.

#### 4.6.2 Battery

The battery is in a safe condition if the following points are observed:

- Battery is undamaged.
- The battery is clean and dry.
- Battery functions properly and has not been modified.

### WARNING

- A battery that is not in a safe condition cannot operate safely. People may suffer serious injuries as a result.
  - ▶ Never work with a damaged battery.
  - ▶ Never attempt to charge a damaged or defective battery.
  - ▶ If the battery is dirty: Clean the battery.
  - ▶ Do not touch the battery with moist hands.
  - ▶ If the battery is moist or wet: Allow the battery to dry,  20.4.
  - ▶ Never attempt to modify the battery.
  - ▶ Never insert objects in the battery's openings.
  - ▶ Never bridge the battery's contacts with metallic objects (short circuit).
  - ▶ Do not open the battery.
  - ▶ Replace worn or damaged labels.
- Fluid may leak from a damaged battery. If that liquid comes into contact with the skin or eyes, the skin or eyes may be irritated.
  - ▶ Avoid contact with the liquid.
  - ▶ If skin contact occurs: Wash affected areas of skin with plenty of water and soap.

- ▶ In the event of contact with eyes: Rinse eyes with plenty of water for at least 15 minutes and consult a doctor.
- A damaged or defective battery may smell unusual, emit smoke or burn. Persons may be seriously or fatally injured, and property may be damaged.
  - ▶ If the battery smells unusual or emits smoke: do not use the battery and keep it away from combustible substances.
  - ▶ If the battery catches fire: Attempt to extinguish the battery with a fire extinguisher or water.

## 4.7 Operation

### WARNING

- In certain situations, the user may no longer be able to concentrate on their work. This may result in the user stumbling, falling and suffering serious injury.
  - ▶ Work calmly and methodically.
  - ▶ In poor light conditions and poor visibility: Do not operate the high-pressure washer.
  - ▶ Use the high-pressure washer on your own.
  - ▶ Watch out for obstacles.
  - ▶ Work standing on the ground and keep your balance. If you have to work at a height: Use a mobile elevating work platform or secure scaffolding.
  - ▶ If you start feeling fatigue: Take a break.
- If the high-pressure washer starts behaving differently or in an unusual way while operating, the high-pressure washer may be in an unsafe condition. This may result in serious injury to people and damage to property.
  - ▶ Stop working, remove the battery and contact a STIHL authorized dealer.
  - ▶ The high-pressure washer must always be operated in an upright position.
  - ▶ To ensure an adequate exchange of cooling air, do not cover the high-pressure washer.
- When the spray gun trigger is released, the high-pressure pump switches off automatically and water stops flowing out of the nozzle. The high-pressure washer is then in stand-by mode and is still switched on. If the spray gun trigger is squeezed, the high-pressure pump switches on again automatically and water flows out of the nozzle. This may result in serious injury to people and damage to property.
  - ▶ When not operating the machine: Lock the spray gun trigger.



- ▶ Switch off the high-pressure washer.
- ▶ Remove the battery.
- At temperatures below 0 C, water can freeze on the surface to be cleaned and in the components of the high-pressure washer. The user may slip, fall and be seriously injured. Damage to property may occur.
  - ▶ Do not use the high-pressure washer at temperatures below 0 C.
- Pulling on the high-pressure hose or on the water can cause the high-pressure washer to move and fall over. Damage to property may occur.
  - ▶ Do not pull on the high-pressure hose or water hose.
- If the high-pressure washer is placed on a sloping, uneven or soft surface, it may move and fall over. Damage to property may occur.
  - ▶ Place the high-pressure washer on a horizontal, flat, hard surface.
- If working at a height, the high-pressure washer or the spray attachment may fall to the ground. This may result in serious injury to people and damage to property.
  - ▶ Use a lift bucket or secure scaffolding.
  - ▶ Do not place the high-pressure washer in a lift bucket or on scaffolding.
  - ▶ If the high-pressure hose does not have sufficient reach: Extend the high-pressure hose by connecting a high-pressure hose extension.
  - ▶ Secure the spray attachment so that it cannot fall.
- The water jet may detach asbestos fibers from surfaces. Asbestos fibers may spread through the air after drying and be breathed in. Breathing in asbestos fibers can be harmful to health.
  - ▶ Do not clean surfaces containing asbestos.
- The water jet may remove oil from vehicles or machinery. The oily water may enter the soil, the water system or the drains. That would create an environmental hazard.
  - ▶ Vehicles or machinery should only be cleaned at places where there is an oil trap in the water drain.
- In combination with leaded paint the water jet can form leaded aerosols and leaded water. Leaded aerosols and leaded water may enter the soil, the water system or the drains. Inhaling aerosols can be harmful to health and trigger allergic reactions. That would create an environmental hazard.
  - ▶ Do not clean surfaces that are painted or lacquered with leaded paint.
- The water jet can damage sensitive surfaces. Damage to property may occur.
  - ▶ Do not clean sensitive surfaces with the rotary nozzle.
  - ▶ Sensitive surfaces made of rubber, fabric, wood and similar materials should be cleaned at a lower operating pressure and from a greater distance.
- If while in use the 3-in-1 nozzle is immersed in dirty water and then operated, the 3-in-1 nozzle may be damaged.
  - ▶ Do not use the 3-in-1 nozzle in dirty water.
  - ▶ If cleaning a container: Empty the container and allow the water to flow away while cleaning it.
- Easily combustible and explosive liquids that are sucked in can cause fires and explosions. Persons may be seriously or fatally injured, and property may be damaged.
  - ▶ Do not suck in or spread easily combustible or explosive liquids.
- Drawing in irritant, corrosive and toxic liquids can endanger health and damage components of the high-pressure washer. Persons may be seriously or fatally injured, and property may be damaged.
  - ▶ Do not suck in or spread irritating, caustic or toxic liquids.
- The strong water jet can seriously injure people and animals and cause damage to property.
  - ▶ Do not direct the water jet at people and animals.
- ▶ Do not direct the water jet at places that are not fully visible.
- ▶ Do not use the water jet to clean clothing while wearing it.
- ▶ Do not use the water jet to clean shoes or boots while wearing them.
- If electrical equipment, electrical connections, sockets and live power cords come into contact with water, electric shock may result. Persons may be seriously or fatally injured, and property may be damaged.
  - ▶ Do not direct the water jet at electrical systems, electrical connections, sockets and live cables.
- If electrical appliances come into contact with water, electric shock may result. The user may be seriously injured or killed, and property may be damaged.







- ▶ Do not direct the water jet at electrical appliances.

- ▶ Keep electrical appliances from the working area.

- The water jet may damage the high-pressure washer. Damage to property may occur.



- ▶ Do not direct the water jet at the high-pressure washer.

- An incorrectly routed high-pressure hose may suffer damage. As a result of the damage, water under high pressure may escape uncontrolled into the surrounding area. This may result in serious injury to people and damage to property.

- ▶ Do not direct the water jet at the high-pressure hose.
- ▶ Route the high-pressure hose so that it is not under tension or tangled.
- ▶ Route the high-pressure hose so that it will not be damaged, kinked or crushed, or chafed.
- ▶ Protect the high-pressure hose from heat, oil and chemicals.

- An incorrectly routed water hose may suffer damage and people may trip over it. People may be injured and the water hose may be damaged.

- ▶ Do not direct the water jet at the water hose.
- ▶ Route and mark the water hose so that people will not trip over it.
- ▶ Route the water hose so that it is not under tension or tangled.
- ▶ Route the water hose so that it will not be damaged, kinked or crushed, or chafed.
- ▶ Protect the water hose from heat, oil and chemicals.

- The strong water jet produces reactive forces. The user may lose control of the spraying system due to the reaction forces that occur. This may result in serious injury to the user and damage to property.

- ▶ Hold the spray gun with both hands.
- ▶ Work as described in this User Manual.

## 4.8 Detergents

### ⚠ WARNING

- If detergents come into contact with the skin or eyes, the skin or eyes may be irritated.
  - ▶ Observe the user manual for the detergent.

- ▶ Avoid contact with detergents.
- ▶ If skin contact occurs: Wash affected areas of skin with plenty of water and soap.
- ▶ If eye contact occurs: Flush eyes with plenty of water for at least 15 minutes and consult a doctor.
- Using the wrong or inappropriate detergent can damage the pressure washer or the surface of the object being cleaned and be harmful to the environment.
  - ▶ STIHL recommends the use of genuine STIHL detergents.
  - ▶ Observe the user manual for the detergent.
  - ▶ If you have any doubts, be sure to consult a STIHL dealer.

## 4.9 Connecting the water supply

### ⚠ WARNING

- Releasing the spray gun trigger causes a kickback in the water hose. A kickback can force dirty water back into the drinking water main. This can pollute the drinking water.



- ▶ Do not connect the high-pressure washer directly to the drinking water main.

- ▶ Observe the regulations of the water supply company. If required, use proper system separation (e.g. backflow preventer) when connecting to the drinking water system.
- Dirty or sandy water can damage components of the pressure washer.
  - ▶ Use clean water.
  - ▶ If using dirty or sandy water: Use a water filter with the pressure washer.
- If the water supply to the pressure washer is insufficient, components of the pressure washer may be damaged.
  - ▶ Turn tap fully on.
  - ▶ Make sure there is a sufficient supply of water to the pressure washer, 20.1.

## 4.10 Transporting

### 4.10.1 High-pressure washer

### ⚠ WARNING

- The high-pressure washer may tip over or move during transport. Persons may be injured or property may be damaged.
  - ▶ Lock the spray gun trigger.

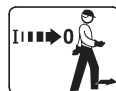

- ▶ Switch off the high-pressure washer.



- ▶ Remove the battery.

- ▶ Secure the high-pressure washer using lashing straps, belts or a net so that it cannot tip over or move.
- At temperatures below 0° C water can freeze in the components of the pressure washer. The high-pressure washer may be damaged.
  - ▶ Drain high-pressure hose and spray attachment.



- ▶ If the high-pressure washer cannot be transported in a frost-proof environment: Use a glycol-based antifreeze to protect the pressure washer.

#### 4.10.2 Battery

### ⚠ WARNING

- The battery is not protected against all ambient conditions. The battery may be damaged if it is exposed to certain ambient conditions, and damage to property may occur.
  - ▶ Never transport a damaged battery.
- The battery may turn over or shift during transport. This may result in injury to people and damage to property.
  - ▶ Pack the battery in packaging in such a way that it cannot move.
  - ▶ Secure the packaging so that it cannot move.

## 4.11 Storing

### 4.11.1 High-pressure washer

### ⚠ WARNING

- Children are not aware of and cannot assess the dangers of the high-pressure washer. Children may be seriously injured.
  - ▶ Lock the spray gun trigger.

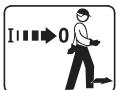

- ▶ Switch off the high-pressure washer.



- ▶ Remove the battery.
- ▶ Store the high-pressure washer out of the reach of children.
- Moisture may cause the electrical contacts on the high-pressure washer and metal components to corrode. The high-pressure washer may be damaged.



- ▶ Remove the battery.

- ▶ Store the high-pressure washer in a clean, dry state.
- At temperatures below 0 C, water can freeze in the components of the pressure washer. The high-pressure washer may be damaged.
  - ▶ Drain the high-pressure hose and spray attachment.



- ▶ If the high-pressure washer cannot be stored in a frost-proof environment: Use a glycol-based antifreeze to protect the high-pressure washer.

#### 4.11.2 Battery

### ⚠ WARNING

- Children are not aware of and cannot assess the dangers of the battery. Children may be seriously injured.
  - ▶ Store the battery out of the reach of children.
- The battery is not protected against all ambient conditions. If the battery is exposed to certain ambient conditions, the battery may be irreparably damaged.
  - ▶ Store the battery in a clean and dry condition.
  - ▶ Store the battery in an enclosed space.
  - ▶ Store the battery separately from the high-pressure washer.
  - ▶ If the battery is stored in the charger, disconnect the mains plug and store the battery at a state of charge between 40% and 60% (2 lit green LEDs).
  - ▶ Do not store the battery outside of the specified temperature limits, 20.3.

## 4.12 Cleaning, maintenance and repair

### ⚠ WARNING

- The high-pressure washer may start up unintentionally if the battery is left in place during cleaning, maintenance or repair operations. This may result in serious injury to people and damage to property.
  - ▶ Lock the spray gun trigger.

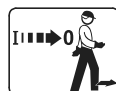

- ▶ Switch off the high-pressure washer.



- ▶ Remove the battery.

- Harsh detergents, cleaning with a water jet or sharp objects can damage the high-pressure washer or the battery. If the high-pressure washer or battery is not cleaned correctly, components may no longer function properly or safety devices may be rendered inoperative. People may suffer serious injuries as a result.
  - ▶ Always clean the high-pressure washer or the battery as described in this User Manual.
- If the high-pressure washer or battery is not serviced or repaired correctly, components may no longer function properly or safety devices may be rendered inoperative. There is a risk of serious or fatal injury.
  - ▶ Do not attempt to service or repair the high-pressure washer or battery yourself.
  - ▶ If the high-pressure washer or battery require servicing or repairs: Contact a STIHL authorized dealer.

## 5 Preparing the pressure washer for operation

### 5.1 Preparing the high-pressure washer for use

The following steps must be performed before commencing work:

- ▶ Ensure that the following components are in a safe condition:
  - High-pressure washer, high-pressure hose and hose coupling, [10 4.6.1](#).
  - Battery, [10 4.6.2](#).
- ▶ Check the battery, [10 11.2](#).
- ▶ Fully charge the battery, [10 6.1](#).
- ▶ Clean the high-pressure washer, [10 16](#).
- ▶ If using a water filter: Check the water filter for dirt and clean it if it is dirty, [10 16.5](#).
- ▶ Set up the pressure washer on a firm and level base, where it will not slide or tip over.
- ▶ Unroll high-pressure hose from hose reel, [10 12.2](#).
- ▶ Attach the spray gun, [10 7.2.1](#).
- ▶ Attach the spray lance, [10 7.3.1](#).
- ▶ If using a nozzle: Attach the nozzle, [10 7.4.1](#).
- ▶ If using a detergent: Working with detergent, [10 12.6](#).
- ▶ Connect water supply, [10 8](#).
- ▶ Check the controls, [10 11.1](#).

## 5 Preparing the pressure washer for operation

- ▶ If it is not possible to carry out these steps: Do not use the pressure washer. Consult a STIHL servicing dealer.

## 6 Charging the Battery, LEDs

### 6.1 Charging the battery

The charging time depends on various factors, e.g. the battery temperature or the ambient temperature. For optimum performance, observe the recommended temperature ranges, [10 20.4](#). The actual charging time may vary from the charging time indicated. The charging time is indicated at [www.stihl.com/charging-times](http://www.stihl.com/charging-times).

The charging process starts automatically when the mains plug is plugged into a socket and the battery is inserted into the charger. The charger switches off automatically when the battery is fully charged.

The battery and the charger warm up during charging.

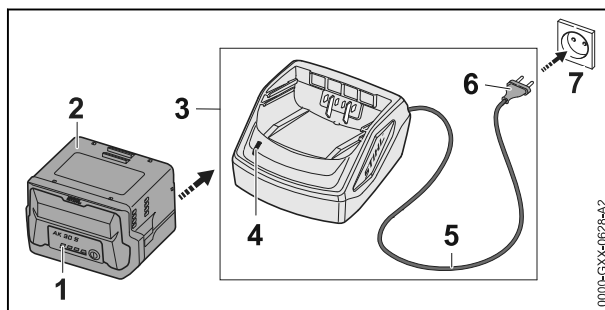

- ▶ Plug the mains plug (6) into an easily accessible socket (7).  
The charger (3) will run a self-test. The LED (4) will glow green for about 1 second and red for about 1 second.
- ▶ Routing the connecting cord (5).
- ▶ Insert the battery (2) in the guides in the charger (3) and press it home as far as stop. The LED (4) glows green. The LEDs (1) glow green and the battery (2) is being charged.
- ▶ When the LED (4) and the LEDs (1) on the battery no longer light up: The battery (2) is fully charged and can be removed from the charger (3).
- ▶ If the charger (3) is no longer required: Disconnect the mains plug (6) from the wall outlet (7).

## 6.2 Displaying the state of charge

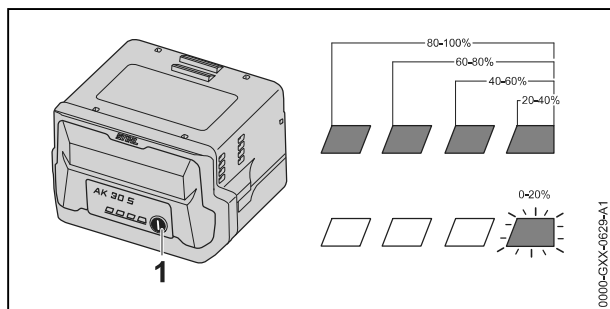

- ▶ Depress the pushbutton (1).  
The LEDs light up green for about 5 seconds and indicate the state of charge.
- ▶ If the LED on the right flashes green: Charge the battery.

## 6.3 LEDs on the battery

The LEDs can indicate the state of charge of the battery or any faults. The LEDs can may light up steady or flash in green or red.

If the LEDs light up steady or flash green, this indicates the state of charge of the battery.

- ▶ If the LEDs light up red or flash red: Trouble-shooting, 19.1.  
There is an error in the high-pressure washer or battery.

# 7 Assembling the pressure washer

## 7.1 Assembling the high-pressure washer

Attach the hose reel handle

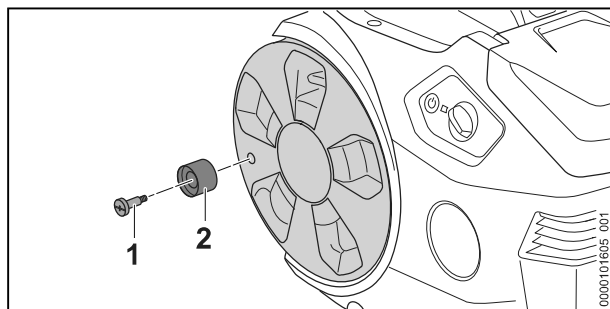

- ▶ Insert the screw (1) into the hose reel handle (2).
- ▶ Insert the screw (1) with the hose reel handle (2) into the hose reel and tighten it down securely.

## Installing the holders

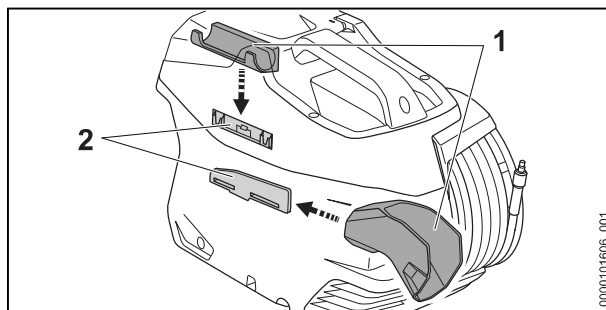

- ▶ Insert the holders (1) into the guides (2).  
The holders (1 and 2) audibly engage.

## Insert the nozzle

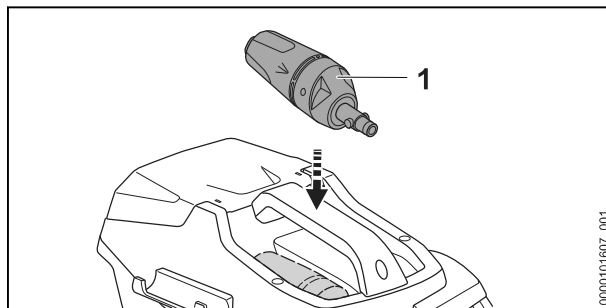

- ▶ Insert the 3-in1 nozzle (1).

## 7.2 Attaching and removing the spray gun

### 7.2.1 Attaching the spray gun

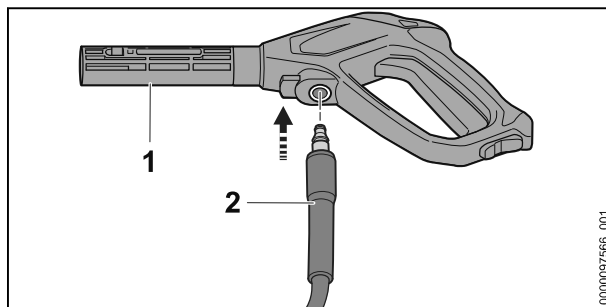

- ▶ Slide the connector (2) into the spray gun (1).  
The connector (2) engages with an audible click.
- ▶ If the connector (2) cannot be easily pushed into the spray gun (1): Grease the gasket on the connector (2) with grease for fittings.

### 7.2.2 Removing the spray gun

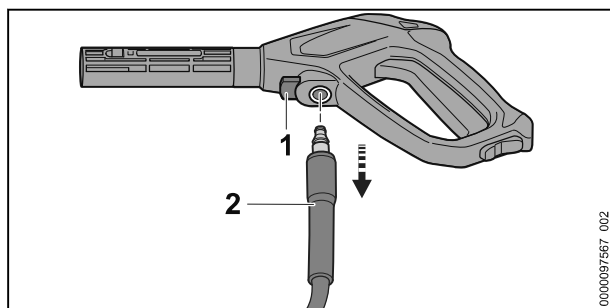

- ▶ Press and hold the locking lever (1).
- ▶ Pull out the connector (2).

### 7.3 Attaching and removing the spray lance

#### 7.3.1 Attaching the spray lance

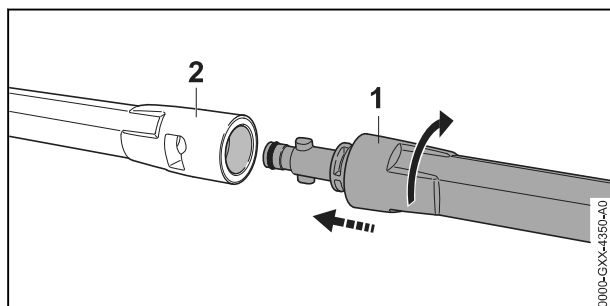

- ▶ Push spray lance (1) into spray gun (2).
- ▶ Twist the spray lance (1) until it engages.
- ▶ If the spray lance (1) cannot be pushed easily into the spray gun (2): Grease the gasket on the spray lance (1) with grease for fittings.

#### 7.3.2 Removing the spray lance

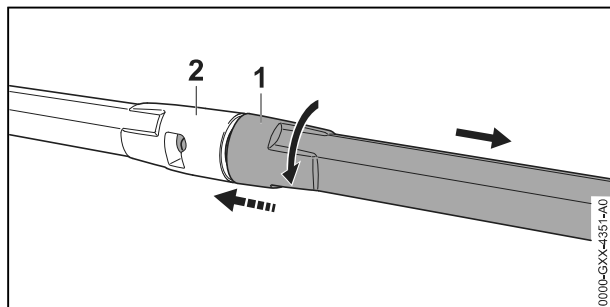

- ▶ Squeeze spray lance (1) and spray gun (2) together and twist as far as they will go.
- ▶ Pull spray lance (1) and spray gun (2) apart.

### 7.4 Attaching and removing the nozzle

#### 7.4.1 Attaching the Nozzle

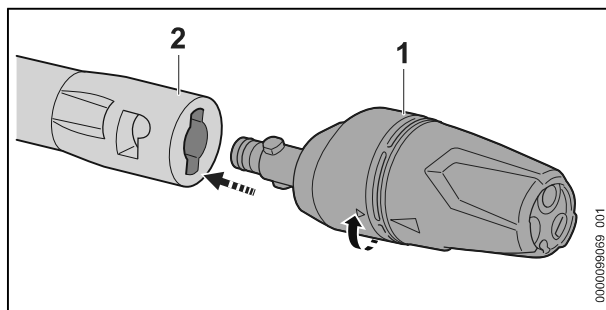

- ▶ Push nozzle (1) onto the spray lance (2).
- ▶ Turn the nozzle (1) until it engages
- ▶ If the nozzle (1) cannot be pushed easily into the spray lance (2): Grease the gasket on the nozzle (1) with grease for fittings.

#### 7.4.2 Removing the nozzle

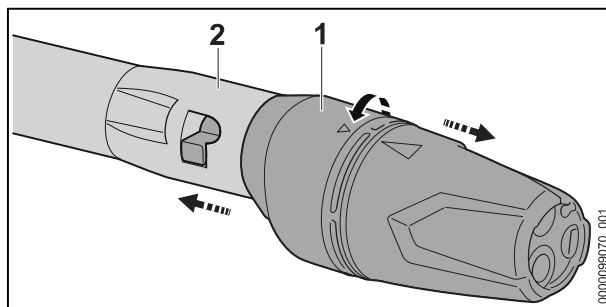

- ▶ Press nozzle (1) and spray lance (2) together and turn until stop.
- ▶ Pull nozzle (1) and spray lance (2) apart.

## 8 Connecting to a water source

### 8.1 Connecting the high-pressure washer to the water supply

#### Connecting the water filter

If the high-pressure washer is operated with sandy water or water from cisterns, a water filter must be connected to the high-pressure washer. The water filter filters sand and dirt out of the water and thus protects the components of the high-pressure washer from damage.

Depending on the market, the water filter may be included with the high-pressure washer.

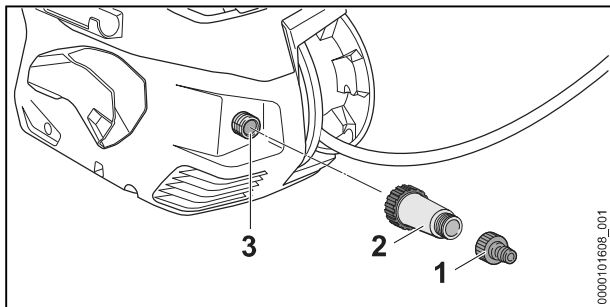

- ▶ Unscrew the connector (1).
- ▶ Screw the water filter (2) onto the water supply (3) and tighten by hand.
- ▶ Screw the connector (1) onto the water filter (2) and tighten by hand.

### Connecting the Water Hose

The water hose must meet the following requirements:

- The water hose has a diameter of 1/2".
- The water hose is between 10 m and 25 m long.
- ▶ Connect the water hose to a tap.
- ▶ Turn on the water tap fully and flush the water hose with water.  
Sand and dirt will be flushed out of the water hose. The water hose will be vented.
- ▶ Turn off tap.

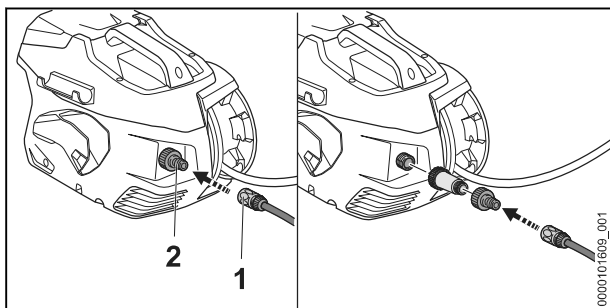

- ▶ Push the coupling (1) onto the connector (2). The coupling (1) engages with an audible click.
- ▶ Turn tap fully on.
- ▶ If the spray lance is attached to the spray gun: Remove the spray lance.
- ▶ Squeeze the spray gun trigger until an even water jet is delivered from the spray gun.
- ▶ Release spray gun trigger.
- ▶ Lock the spray gun trigger.
- ▶ Attach the spray lance.
- ▶ Attach the nozzle.

### Removing the water hose

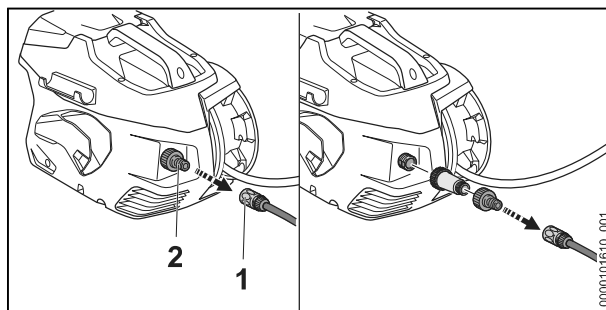

- ▶ Turn off tap.
- ▶ To unlock the coupling: Pull the ring (1) or twist and hold it.
- ▶ Pull the coupling off the connector (2).

## 8.2 Using high-pressure washer from an alternative water source

The high-pressure washer can draw in water from rain barrels, water tanks and flowing or still bodies of water.

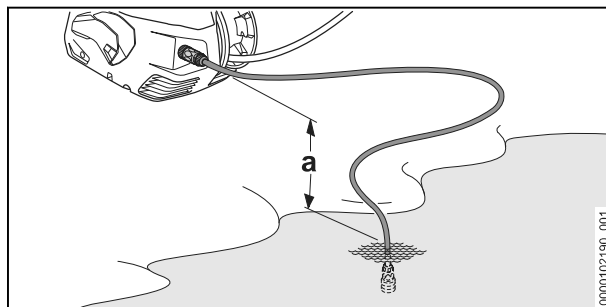

So that the water can be drawn in, the height difference between the high-pressure washer and the water source must not exceed the max. suction lift (a), 20.1.

The appropriate STIHL suction set must be used. The suction set includes a water hose with a special coupling and an integrated water filter.

Depending on the market, the appropriate STIHL suction set may be included with the high-pressure washer.

### Connecting the water hose

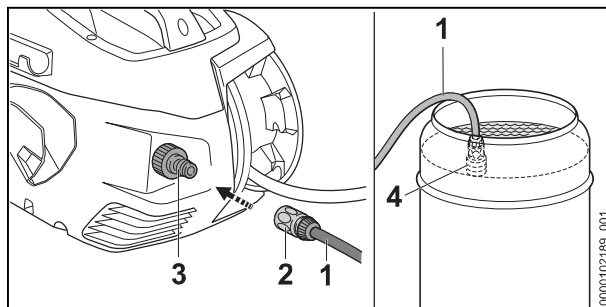

- ▶ Fill the water hose (1) with water so that no air is present any longer in the water hose.
- ▶ Push the coupling (2) onto the connector (3). The coupling (2) engages with an audible click.
- ▶ Attach the suction bell (4) to the water source so that the suction bell (4) does not touch the ground.
- ▶ If the spray gun is fitted to the high-pressure hose: Remove the spray gun.
- ▶ Hold the high-pressure hose downwards.
- ▶ Switch on the high-pressure washer until an even water jet flows out of the high-pressure hose.
- ▶ Switch off the high-pressure washer.
- ▶ Connect the spray gun to the high-pressure hose.
- ▶ Press and hold down the spray gun trigger.
- ▶ Switch on the high-pressure washer.

## 9 Removing and Fitting the Battery

### 9.1 Inserting the battery

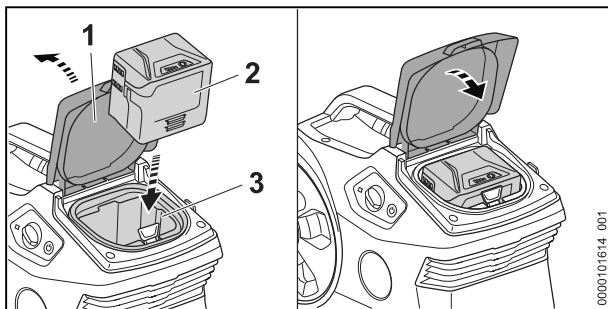

- ▶ Open the flap (1) as far as it will go and hold it there.
- ▶ Insert the battery (2) into the battery compartment (3) as far as it will go. The battery (2) engages with a click and is now locked.
- ▶ Close the lid (1).

### 9.2 Removing the battery

- ▶ Place the high-pressure washer on a level surface.

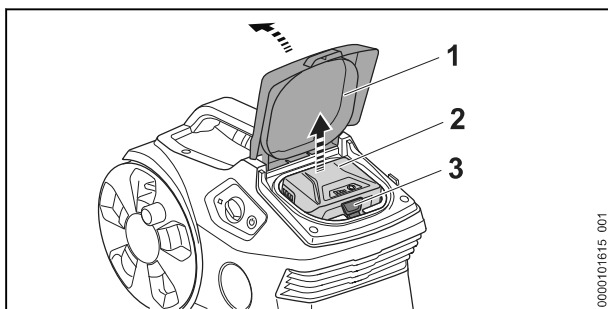

- ▶ Open the flap (1) as far as it will go and hold it there.
- ▶ Press the locking lever (3). The battery (2) is now unlocked and can be removed.
- ▶ Close the flap (1).

## 10 Switching the pressure washer on and off

### 10.1 Switching on the high-pressure washer

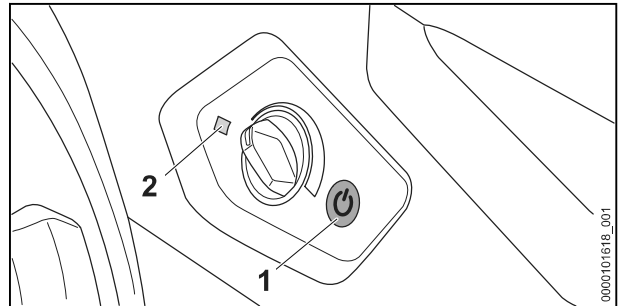

- ▶ Press the pushbutton (1). The LED (2) lights up green. The high-pressure washer is ready to use.

The high-pressure washer switches off automatically if it is not used for more than 30 minutes. The LED (2) no longer lights up.

- ▶ Press the pushbutton (1) again. The high-pressure washer is operational again.

### 10.2 Switching off the high-pressure washer

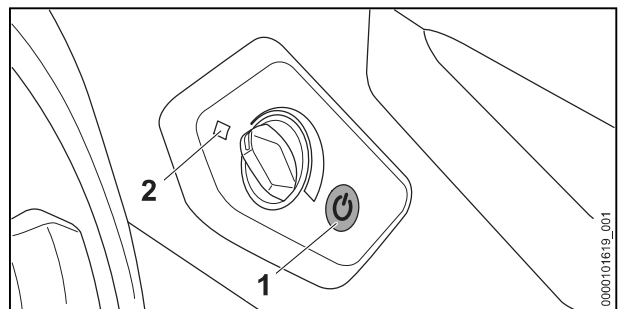



- ▶ Press the pushbutton (1). The LED (2) no longer lights up.

## 11 Checking the high-pressure washer and battery

### 11.1 Checking the controls

#### Retaining latch and lever

- ▶ Switch off the high-pressure washer and remove the battery.

- Move the retaining latch to the  position.
- Try to pull the lever.
- If the lever can be pressed: Do not use the high-pressure washer; contact a STIHL authorized dealer. The retaining latch is defective.
- Move the retaining latch to the  position.
- Press the lever and release it again.
- If the lever is stiff or does not spring back to its idle position: Do not use the high-pressure washer; contact a STIHL authorized dealer. The lever is defective.

## 11.2 Testing the Battery

- Press button on battery. The LEDs glow or flash.
- If the LEDs do not glow or flash: Do not use the battery and contact your STIHL servicing dealer. There is a malfunction in the battery.

# 12 Operating the pressure washer

## 12.1 Holding and controlling the spray gun

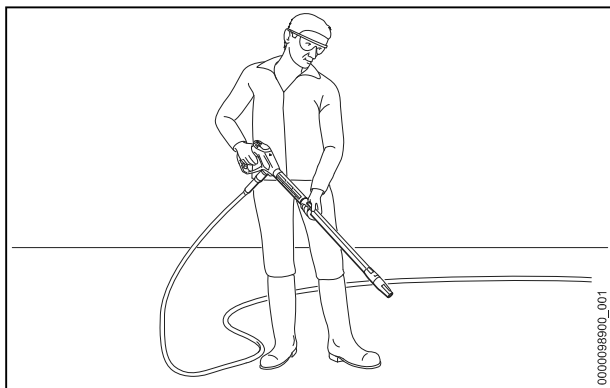

- Hold the spray gun by the handle with one hand, wrapping your thumb around the handle.
- Hold the spray lance firmly with your other hand, wrapping your thumb around the spray lance.
- Point the nozzle at the ground.

## 12.2 Unwinding the high-pressure hose

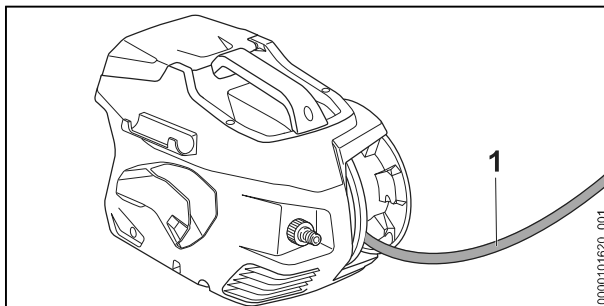

- Unwind the high-pressure hose (1) from the hose reel.

## 12.3 Squeezing and locking the spray gun trigger

### Pressing the spray gun trigger

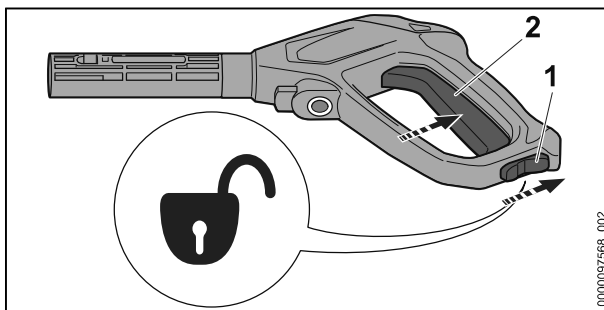

- Move the retaining latch (1) to the  position.
- Press and hold the trigger (2). The high-pressure pump starts up automatically and water flows out of the nozzle.

### Locking the spray gun trigger

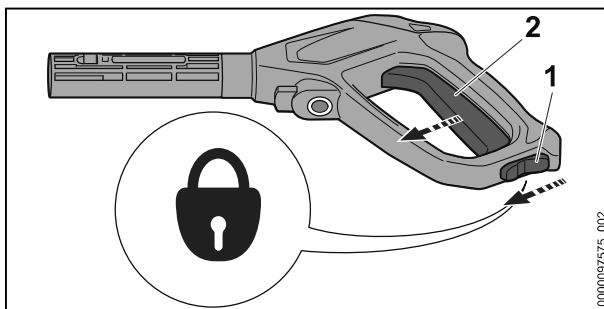

- Release the trigger (2). The high-pressure pump switches off automatically and water stops flowing out of the nozzle. The high-pressure washer is still switched on.
- Move the retaining latch (1) to the  position.

## 12.4 Setting the operating pressure

The operating pressure can be set according to the application.



Work can be carried out with a high operating pressure if stubborn dirt is to be removed.

Low working pressure can be used when removing soiling from sensitive surfaces.

- Switch on the high-pressure washer.

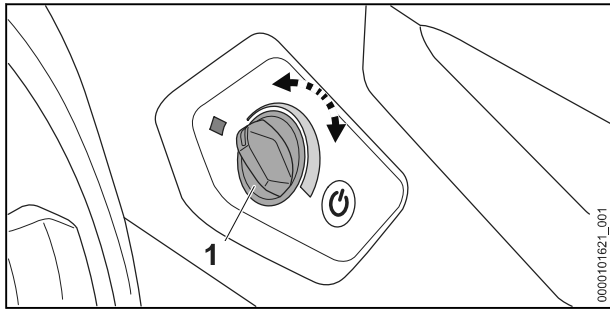

Increase the operating pressure

- Turn the rotary control (1) clockwise to set the desired operating pressure.

Reduce the operating pressure

- Turn the rotary control (1) counterclockwise to set the desired operating pressure.

## 12.5 Cleaning

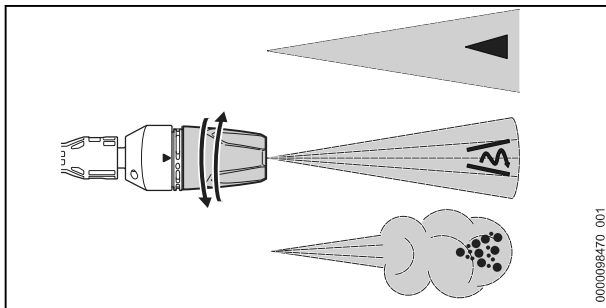

The 3-in 1 nozzle can be set according to the application:

- The fan-jet nozzle ◀ is suitable for cleaning light and medium soiling.
- The rotary nozzle ⌚ is suitable for cleaning stubborn dirt on insensitive surfaces.
- The spray nozzle ☁ is suitable for cleaning with detergent.
  - Before cleaning, point the water jet at an inconspicuous spot on the surface and check that the surface is not damaged.
  - Select the distance between the nozzle and the surface to be cleaned so that the surface to be cleaned is not damaged.
  - Adjust the 3-in 1 nozzle so that the surface to be cleaned is not damaged.
  - Adjust the 3-in 1 nozzle only when the lever of the spray gun is not pressed.

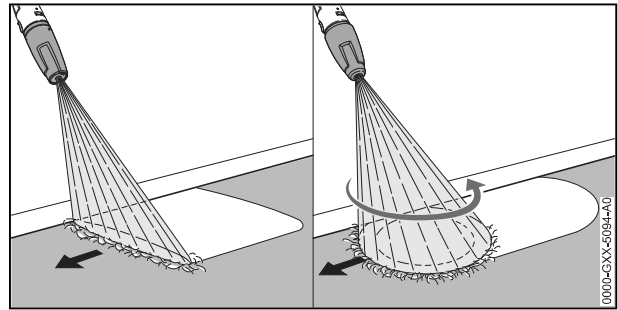

- Move the spraying equipment evenly along the surface to be cleaned.
- Move forward slowly in a controlled manner.

## 12.6 Working with detergent

Detergents can increase the cleaning effect of the water.

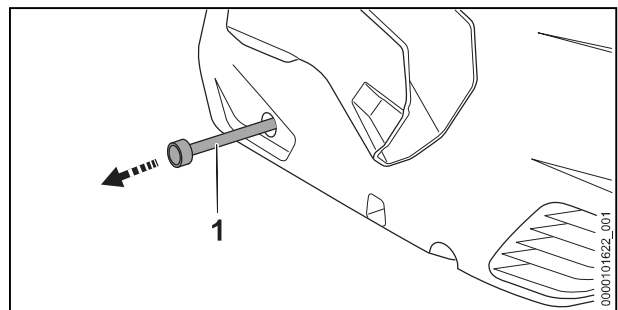



- Pull out the detergent hose (1) from the high-pressure washer.
- Unscrew the lid of the detergent container.
- Insert the detergent hose (1) into the detergent container.
- Rotate the 3-in-1 nozzle into position ☁ and select the highest operating pressure.

## 13 After Finishing Work

### 13.1 After finishing work

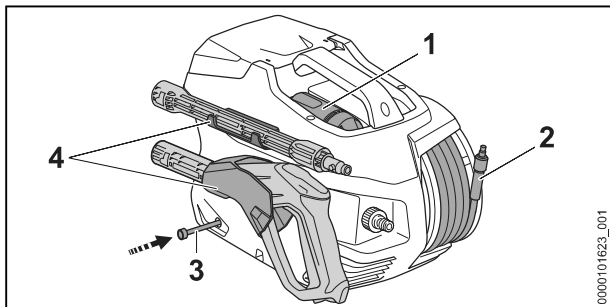
- After using a detergent: Rinse the high-pressure washer.
- Push the detergent hose (3) into the high-pressure washer.
- Switch off the high-pressure washer and remove the battery.
- If the high-pressure washer is connected to the water supply: Close the faucet.
- Press the spray gun trigger. The water pressure is reduced.
- Lock the spray gun trigger.
- Disconnect the high-pressure washer from the water source.
- Remove the water hose.
- Remove and clean the nozzle and spray lance.
- Remove the spray gun and let the remaining water run out of the spray gun.



- ▶ Coil the high-pressure hose (2) so that it is evenly distributed over the reel.
- ▶ Insert the nozzle (1).
- ▶ Store the spray attachment in the holders (4) on the high-pressure washer.
- ▶ If the high-pressure washer is wet: Allow the high-pressure washer to dry.
- ▶ If the battery is moist or wet: Allow the battery to dry,  20.4.
- ▶ Clean the high-pressure washer.
- ▶ Clean the battery.

## 14 Transporting

### 14.1 Transporting the high-pressure washer

- ▶ Switch off the high-pressure washer and remove the battery.

#### Carrying the high-pressure washer

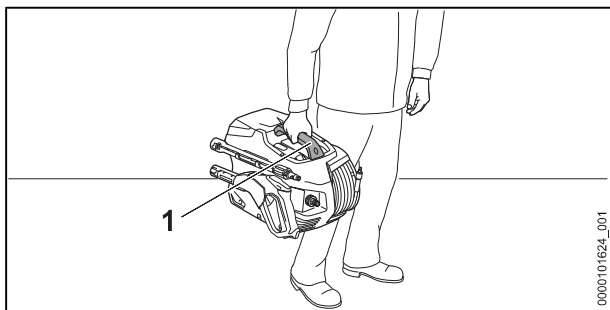

- ▶ Use the handle (1) to carry the high-pressure washer.

#### Transporting the High-Pressure Washer in a Vehicle

- ▶ Secure the high-pressure washer so that it cannot turn over or move.
- ▶ If the high-pressure washer cannot be transported in a frost-proof environment: Use antifreeze to protect the high-pressure washer.

### 14.2 Transporting the battery

- ▶ Switch off the high-pressure washer and remove the battery.
- ▶ Check that the battery is in a safe condition.
- ▶ Pack the battery in packaging in such a way that it cannot move inside the packaging.

- ▶ Secure the packaging so that it cannot move.

The battery is subject to the Carriage of Dangerous Goods regulations. The battery is classified as UN 3480 (lithium ion batteries) and has been tested pursuant to UN Manual Tests and Criteria Part III, Subsection 38.3.

The transport regulations can be found at [www.stihl.com/safety-data-sheets](http://www.stihl.com/safety-data-sheets).

## 15 Storing

### 15.1 Storing the high-pressure washer

- ▶ Switch off the high-pressure washer and remove the battery.
- ▶ The high-pressure washer should be stored so that the following conditions are met:
  - The high-pressure washer is secured against tipping over or moving.
  - The high-pressure washer is out of the reach of children.
  - The high-pressure washer is clean and dry.
  - The high-pressure washer is in an enclosed space.
  - The high-pressure washer is in a temperature range above 0°C.
  - If the high-pressure washer cannot be protected from frost in storage: Use antifreeze to protect the high-pressure washer.

### 15.2 Storing the battery

STIHL recommends keeping the battery in a charging state between 40% and 60 % (2 lit green LEDs).

- ▶ The battery should be stored in such a way that the following conditions are fulfilled:
  - The battery is out of the reach of children.
  - The battery is clean and dry.
  - The battery is in an enclosed space.
  - The battery is stored separately from the high-pressure washer.
  - If the battery is stored in the charger, disconnect the mains plug and store the battery at a state of charge between 40% and 60% (2 lit green LEDs).
  - Do not store the battery outside of the specified temperature limits,  20.3.

**NOTICE**

- If the battery is not stored as described in this user manual, the battery may become deeply discharged and irreparably damaged.
  - ▶ Charge a discharged battery before storing it. STIHL recommends storing the battery in a state of charge between 40% and 60% (2 lit green LEDs).
  - ▶ Store the battery separately from the high-pressure washer.

## 16 Cleaning

### 16.1 Rinsing the high-pressure washer

If a detergent was used:

- ▶ Rotate the 3-in-1 nozzle into position  and select the highest power level.
- ▶ Switch on the high-pressure washer and rinse with clean water for approximately 30 seconds.

### 16.2 Cleaning the high-pressure washer and accessories

- ▶ Switch off the high-pressure washer and remove the battery.
- ▶ Use a damp cloth to clean the high-pressure washer, high-pressure hose, spray gun and accessories.
- ▶ Clean the connectors and couplings on the high-pressure washer, high-pressure hose and spray gun with a damp cloth.
- ▶ Use a paintbrush to clean the ventilation slots.
- ▶ Remove foreign objects from the battery compartment and clean the battery compartment with a damp cloth.
- ▶ Use a paintbrush or soft brush to clean the electrical contacts in the battery compartment.

### 16.3 Cleaning nozzle and spray lance

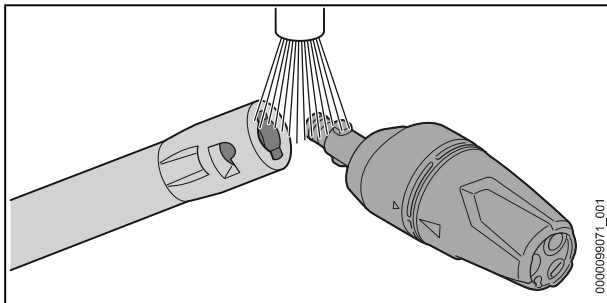

- ▶ Rinse the nozzle and spray lance under running water and dry with a cloth.

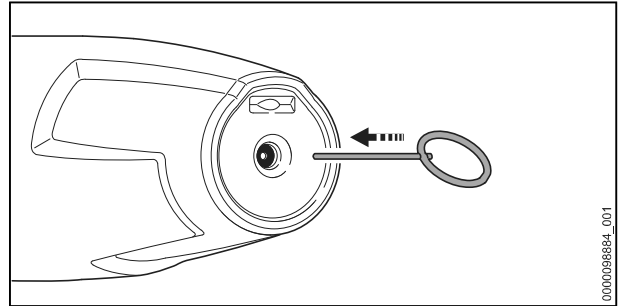

- ▶ If the nozzle is clogged: Clean the nozzle with the cleaning pin.

### 16.4 Cleaning the water intake screen

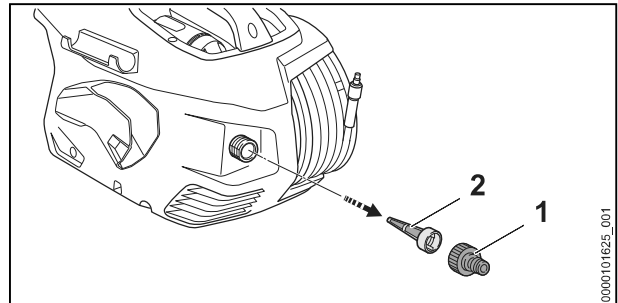

- ▶ Unscrew the connector (1) of the water connection.
- ▶ Pull the water intake screen (2) out of the water connection.
- ▶ Rinse the water intake screen (2) under running water.
- ▶ Insert the water intake screen (2) into the water connection.
- ▶ Attach the connector (1) and tighten it by hand.

### 16.5 Cleaning the Water Filter

The water filter must be disassembled for cleaning.

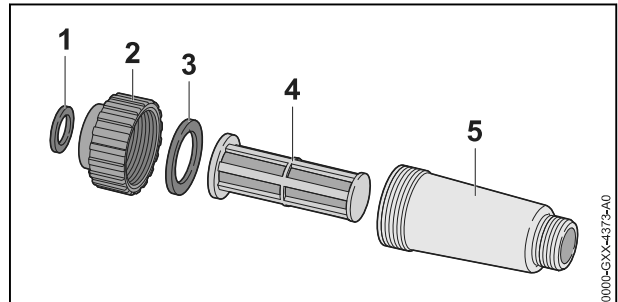

- ▶ Disassembling the water filter.
- ▶ Rinse gaskets (1 and 3), fastener (2), filter (4) and filter housing (5) under running water.
- ▶ Grease the gaskets (1 and 3) with a lubricant suitable for faucets.
- ▶ Reassemble the water filter.

## 16.6 Cleaning the water filter in the suction set

The suction cup must be disassembled for cleaning the water filter.

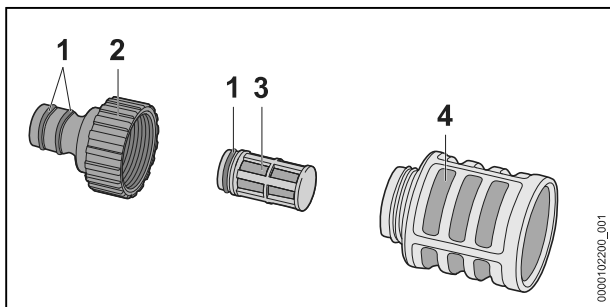

- ▶ Unscrew the connector (2).
- ▶ Remove the water filter (3) from the suction cup (4).
- ▶ Rinse out the connector (2), water filter (3) and suction cup (4) under running water.
- ▶ Grease the gaskets (1) with grease suitable for faucets and valves.
- ▶ Reassemble the suction cup.

## 16.7 Cleaning the Battery

- ▶ Clean the battery with a damp cloth.

## 19 Troubleshooting

### 19.1 Correcting errors in the high-pressure washer or battery

Error	LEDs on the battery	Cause	Remedy
The high-pressure washer does not start when switched on. The electric motor buzzes.	1 LED flashes green.	State of charge of the battery is too low.	▶ Charge the battery.
	1 LED lights up steady red.	The battery is too warm or too cold.	▶ Remove the battery. ▶ Allow the battery to cool down or warm up.
	3 LEDs flash red.	There is an error in the high-pressure washer.	▶ Remove the battery. ▶ Clean the electrical contacts in the battery compartment. ▶ Insert the battery. ▶ Switch on the high-pressure washer. ▶ If 3 LEDs continue to flash red: Do not use the high-pressure washer; contact a STIHL authorized dealer.
	3 LEDs light up red.	The high-pressure washer is too hot.	▶ Remove the battery. ▶ Allow the high-pressure washer to cool down. ▶ Clean the nozzle.
	4 LEDs flash red.	There is an error in the battery.	▶ Remove the battery and reinsert it. ▶ Switch on the high-pressure washer. ▶ If 4 LEDs continue to flash red: Do not use the battery; contact a STIHL authorized dealer.

## 17 Maintenance

### 17.1 Maintenance intervals

Maintenance intervals depend on the ambient conditions and the operating conditions. STIHL recommends the following maintenance intervals:

Monthly



- ▶ Clean water intake screen.

## 18 Repairing

### 18.1 Repairing the high-pressure washer and battery

The user cannot repair the high-pressure washer, accessories or the battery.

- ▶ If the high-pressure washer or an accessory is damaged: Do not use the high-pressure washer or accessory; contact a STIHL authorized dealer.
- ▶ If the battery is defective or damaged: Replace the battery.

Error	LEDs on the battery	Cause	Remedy
	-	No electrical contact between the high-pressure washer and the battery.	<ul style="list-style-type: none"> <li>▶ Remove the battery.</li> <li>▶ Clean the electrical contacts in the battery compartment.</li> <li>▶ Insert the battery.</li> </ul>
	-	The battery is damp.	▶ Allow battery to dry,  20.4.
The high-pressure washer switches off while in operation.	3 LEDs light up red.	The high-pressure washer is too hot.	<ul style="list-style-type: none"> <li>▶ Remove the battery.</li> <li>▶ Allow the high-pressure washer to cool down.</li> <li>▶ Clean the nozzle.</li> </ul>
	-	There is an electrical error.	<ul style="list-style-type: none"> <li>▶ Remove the battery and reinsert it.</li> <li>▶ Switch on the high-pressure washer.</li> </ul>
The runtime of the high-pressure washer is too short.	-	The battery is not fully charged.	▶ Fully charge the battery.
	-	The battery life has been exceeded.	▶ Replace battery.
Charging does not start when the battery is inserted into the charger.	1 LED lights up steady red.	The battery is too warm or too cold.	▶ Leave the battery inserted in charger. The charging starts automatically as soon as the permitted temperature range is reached.
The high-pressure pump repeatedly switches on and off without the spray gun trigger being squeezed.	-	There is a leak in the high-pressure pump, high-pressure hose or spray attachment.	▶ Ask a STIHL servicing dealer to inspect the pressure washer.
The operating pressure fluctuates or drops.	-	There is not enough water.	<ul style="list-style-type: none"> <li>▶ Open water tap fully.</li> <li>▶ Make sure that a sufficient quantity of water is available.</li> </ul>
	-	The nozzle is blocked.	▶ Clean the nozzle.
	-	The water intake screen or water filter is blocked.	▶ Clean the water intake screen and water filter.
	-	The high-pressure pump, high-pressure hose or spray attachment is leaking or defective.	▶ Ask a STIHL servicing dealer to inspect the pressure washer.
The shape of the water jet has changed.	-	The nozzle is blocked.	▶ Clean the nozzle.
	-	The nozzle is worn.	▶ Fit a new nozzle.
Detergent is no longer drawn in.	-	The detergent bottle is empty.	▶ Fill the detergent bottle with a detergent.
	-	The filter of the detergent hose is dirty.	▶ Rinse out the filter of the detergent hose under running water.
Connectors with high-pressure washer, high-pressure hose, spray gun or spray lance are stiff.	-	The gaskets of the connections are not greased.	▶ Grease the gaskets.  19.2

## 19.2 Lubricating the seals

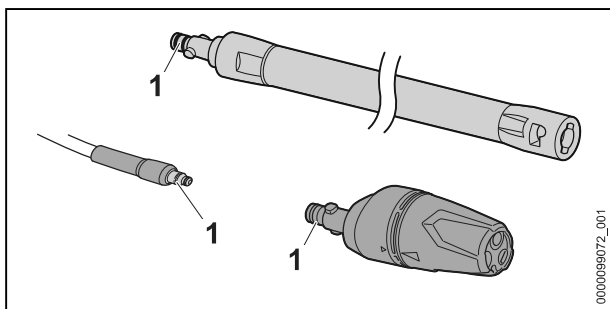

- Grease the seals (1) with grease for fittings.

## 20 Specifications

### 20.1 STIHL REA 60.0 PLUS high-pressure washer

- Approved battery: STIHL AK
- Power consumption: 1000 W
- Protection class: III
- Degree of protection: IPX5
- Operating pressure (p): 10 MPa (100 bar)
- Max. pressure (p max.): 13 MPa (130 bar)
- Max. water supply pressure (p in max.): 1 MPa (10 bar)
- Max. water throughput (Q max.): 4.5 l/min (270 l/h)
- Minimum water throughput (Q min.): 4 l/min (240 l/h)
- Max. suction lift: 0.5 m
- Max. water temperature in pressure mode (t in max): 40 °C
- Max. water temperature in suction mode: 20 °C
- sample inspection
  - Length: 426 mm
  - Width: 314 mm
  - Height: 292 mm
- Length of high-pressure hose: 5 m
- Weight (m) without battery and with accessories attached: 7 kg

Parameters dependent on pressure have been measured at an inlet pressure of 0.3 MPa (3 bar).

For runtime, see [www.stihl.com/battery-life](http://www.stihl.com/battery-life).

### 20.2 STIHL AK Battery

- Battery technology: lithium-ion
- Voltage: 36 V
- Capacity in Ah: see rating label
- Energy content in Wh: see rating label
- Weight in kg: See rating label

## 20.3 Temperature limits



### WARNING

- The battery is not protected against all ambient conditions. If the battery is exposed to certain environmental conditions, it may catch fire or explode. This may result in serious injury to people and damage to property.
  - Do not charge the battery below -20°C or above 50°C.
  - Do not use the high-pressure washer or battery at a temperature below -20°C or above 50°C.
  - Do not use the high-pressure washer or battery at a temperature below -20°C or above +70°C.

### 20.4 Recommended temperature ranges

For optimum performance of the high-pressure washer and battery, note the following temperature ranges:

- Charging: 5°C to 40°C
- Use: -10°C to 40°C
- Storage: -20°C to +50°C

If the battery is charged, used or stored outside the recommended temperature ranges, performance may be restricted.

If the battery is wet or moist, allow the battery to dry for at least 48 h between 15°C and 50°C and with less than 70% humidity. Higher humidity may extend the drying time.

### 20.5 Sound and vibration values

The K value for the sound pressure level is 2 dB(A). The K value for the sound power level is 2 dB(A). The K-value for vibration level is 2 m/s².

- Sound pressure level  $L_{pA}$  measured according to EN 60335-2-79: 89 dB(A)
- Sound power level  $L_{wA}$  measured according to EN 60335-2-79: 85 dB(A)
- Vibration level  $a_h$  measured according to EN 60335-2-79, fan-jet nozzle:  $\leq 2.5 \text{ m/s}^2$ .

For information on compliance with the Physical Agents (Vibration) Directive 2002/44/EC, see [www.stihl.com/vib](http://www.stihl.com/vib).

### 20.6 REACH

REACH is an EC regulation and stands for the Registration, Evaluation, Authorisation and Restriction of Chemical substances.

For information on compliance with the REACH regulation see [www.stihl.com/reach](http://www.stihl.com/reach).

## 21 Spare Parts and Accessories

### 21.1 Spare parts and accessories

**STIHL**  These symbols indicate original STIHL spare parts and original STIHL accessories.

STIHL recommends the use of original STIHL spare parts and accessories.

Despite ongoing market observation, STIHL is unable to judge the reliability, safety and suitability of other manufacturers' spare parts and accessories; accordingly, STIHL cannot warrant for the use of those parts.

Original STIHL spare parts and original STIHL accessories are available from STIHL dealers.

## 22 Disposal

### 22.1 Disposing of the high-pressure washer and battery

Contact local authorities or a STIHL authorized dealer for information on disposal.

Improper disposal can be harmful to health and pollute the environment.

- ▶ Take STIHL products including packaging to a suitable collection point for recycling in accordance with local regulations.
- ▶ Do not dispose with domestic waste.

## 23 EC Declaration of Conformity

### 23.1 STIHL REA 60.0 PLUS high-pressure washer

ANDREAS STIHL AG & Co. KG  
Badstraße 115  
D-71336 Waiblingen

Germany

declare under our sole responsibility that

- Type: high-pressure washer
- Manufacturer's brand: STIHL
- Model: REA 60.0 PLUS
- Serial number: REA01

conforms to the specifications of Directives 2011/65/EU, 2006/42/EC and 2014/30/EU and has been developed and built in compliance with the versions of the following standards valid at

the production date: EN 55014-1, EN 55014-2, EN 60335-1, EN 60335-2-79, EN 61000-3-2, EN 61000-3-3, and EN 62233.

The measured and the guaranteed sound power level have been determined in accordance with Directive 2000/14/EC, Annex V, and standard ISO 3744.

- Measured sound power level: 85 dB(A)
- Guaranteed sound power level: 87 dB(A)

The technical documents are stored at ANDREAS STIHL AG & Co. KG Produktzulassung.

The year of construction, country of manufacture and the serial number are shown on the high-pressure washer.

Waiblingen, 2022-08-01

ANDREAS STIHL AG & Co. KG

pp 

Robert Olma, Vice President, Regulatory Affairs & Global Governmental Relations

## 24 UKCA Declaration of Conformity

### 24.1 STIHL REA 60.0 PLUS high-pressure washer

**UK  
CA**

ANDREAS STIHL AG & Co. KG  
Badstraße 115  
D-71336 Waiblingen

Germany

declare under our sole responsibility that

- Type: high-pressure washer
- Manufacturer's brand: STIHL
- Model: REA 60.0 PLUS
- Serial number: REA01

complies with the relevant provisions of the UK regulations The Restriction of the Use of Certain Hazardous Substances in Electrical and Electronic Equipment Regulations 2012, Supply of Machinery (Safety) Regulations 2008 and Electromagnetic Compatibility Regulations 2016 and has been developed and manufactured in accordance with the versions of the following standards valid on the date of manufacture:

EN 55014-1, EN 55014-2, EN 60335-1,  
EN 60335-2-79, EN 61000-3-2, EN 61000-3-3,  
EN 62233.

The measured and guaranteed sound power levels were determined in accordance with the UK regulation Noise Emission in the Environment by Equipment for use Outdoors Regulations 2001, Schedule 8, using the ISO 3744 standard.

- Measured sound power level: 85 dB(A)
- Guaranteed sound power level: 87 dB(A)

The technical documentation is stored at  
ANDREAS STIHL AG & Co. KG.

The year of construction, country of manufacture and the serial number are shown on the high-pressure washer.

Waiblingen, 2022-08-01

ANDREAS STIHL AG & Co. KG

pp 

Robert Olma, Vice President, Regulatory Affairs  
& Global Governmental Relations

## 25 Addresses

www.stihl.com

## Table des matières

1	Préface.....	47
2	Informations concernant la présente Notice d'emploi.....	47
3	Vue d'ensemble.....	48
4	Prescriptions de sécurité.....	50
5	Préparatifs avant l'utilisation du nettoyeur haute pression.....	58
6	Recharge de la batterie et DEL.....	58
7	Assemblage du nettoyeur haute pression.....	59
8	Branchement sur une source d'alimentation en eau.....	60
9	Introduction et extraction de la batterie.....	62
10	Mise en marche et arrêt du nettoyeur haute pression.....	62
11	Contrôle du nettoyeur haute pression et de la batterie.....	62
12	Travail avec le nettoyeur haute pression..	63
13	Après le travail.....	64
14	Transport.....	65
15	Rangement.....	65
16	Nettoyage.....	66
17	Maintenance.....	67

18	Réparation.....	67
19	Dépannage.....	67
20	Caractéristiques techniques.....	69
21	Pièces de rechange et accessoires.....	70
22	Mise au rebut.....	71
23	Déclaration de conformité UE.....	71
24	Déclaration de conformité UKCA.....	71
25	Adresses.....	72

## 1 Préface

Chère cliente, cher client,

Nous vous remercions d'avoir choisi un produit STIHL. Dans le développement et la fabrication de nos produits, nous mettons tout en œuvre pour garantir une excellente qualité répondant aux besoins de nos clients. Nos produits se distinguent par une grande fiabilité, même en cas de sollicitations extrêmes.

STIHL garantit également la plus haute qualité au niveau du service après-vente. Nos revendeurs spécialisés fournissent des conseils compétents, aident nos clients à se familiariser avec nos produits et assurent une assistance technique complète.

STIHL se déclare résolument en faveur d'un développement durable et d'une gestion responsable de la nature. La présente Notice d'emploi vous aidera à utiliser votre produit STIHL en toute sécurité et dans le respect de l'environnement, pendant toute sa longue durée de vie.

Nous vous remercions de votre confiance et vous souhaitons beaucoup de plaisir avec votre produit STIHL.



Dr. Nikolas Stihl

**IMPORTANT ! LIRE CETTE NOTICE AVANT D'UTILISER CE PRODUIT ET LA CONSERVER PRÉCIEUSEMENT.**

## 2 Informations concernant la présente Notice d'emploi

### 2.1 Documents applicables

Les consignes de sécurité locales sont à respecter.