



Husqvarna®



TS 100i

EN	Operator's manual
ES	Manual de usuario
PT	Manual do utilizador
IT	Manuale dell'operatore

2-39
40-79
80-119
120-158

Contents

Introduction.....	2	Troubleshooting.....	27
Safety.....	6	Transportation, storage and disposal.....	32
Assembly.....	13	Technical data.....	35
Operation.....	15	Service.....	37
Maintenance.....	19	Declaration of Conformity.....	38

Introduction

Pre-delivery inspection and product numbers

Note: A pre-delivery inspection has been done of this product. Make sure that you receive a signed copy of the pre-delivery inspection document from your dealer.

Service agent contact information:	
This operator's manual belongs to product with product number / serial number:	
/	
Motor:	

Product description

This is a lawn tractor with the cutting deck installed between the front and rear axles. The product is battery-operated and has an installed battery.

Intended use

This product is only used to cut grass in private gardens and on private garden slopes with not more than 10° slope. It is not to be used in public parks, sports grounds, in farming or in forestry. Attach an optional accessory to use the product for other tasks. Only use the product with accessories that are approved by the manufacturer. Speak to an approved service agent for more information.

To use the product differently is incorrect use. It will void your warranty and reject the responsibility for damage to the user of third parties on the part of the manufacturer.

Refer to local directives for the operation of lawn mowers.

Insure your product

Make sure that you have insurance coverage for your new product. Speak to your insurance company if you are not sure. We recommend a fully comprehensive insurance that includes third party, fire, damage, theft and liability.

Product overview

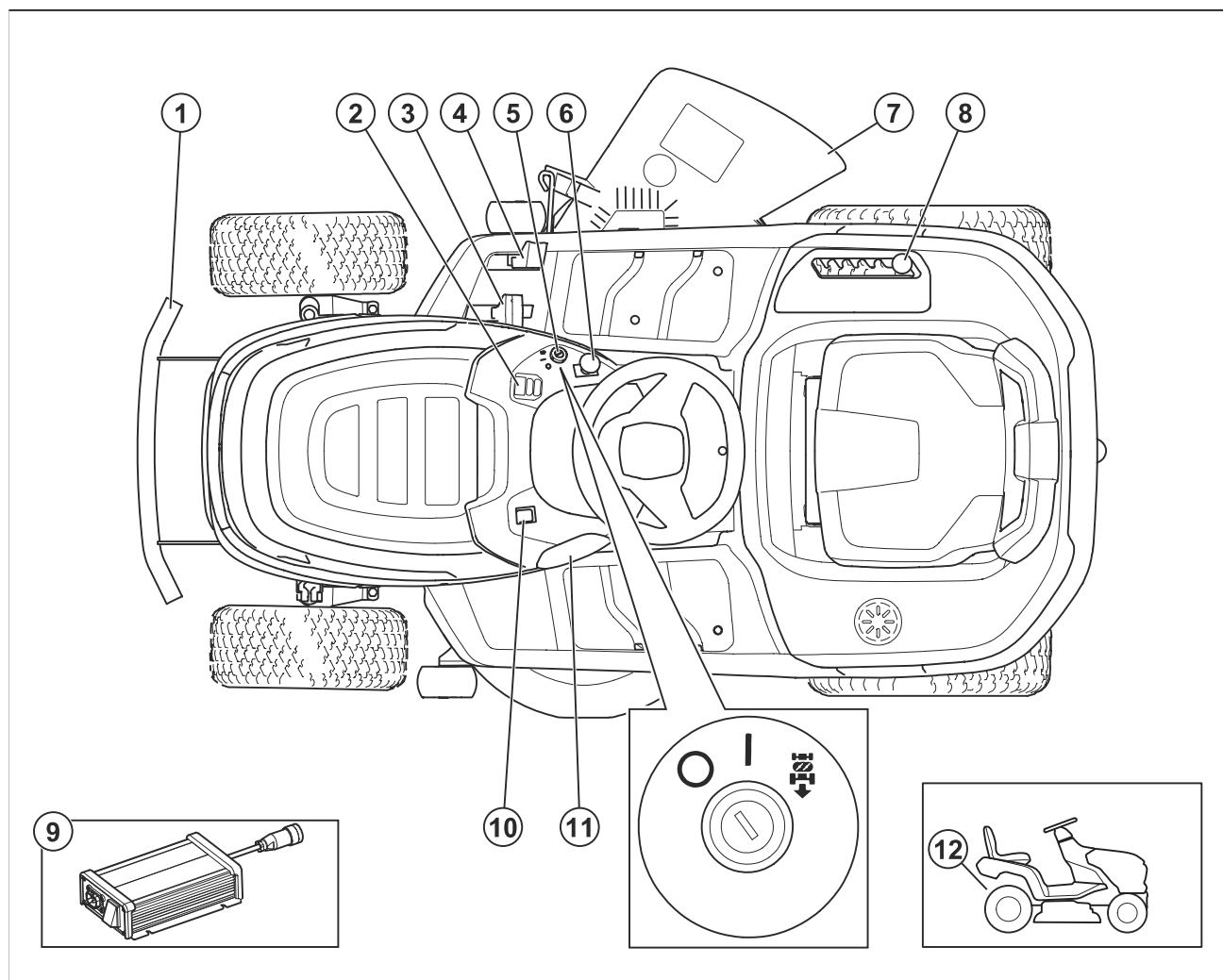

1. Front bumper
2. Display
3. Forward pedal
4. Rearward pedal
5. Power switch
6. PTO button
7. Deflector
8. Cutting height lever
9. Battery charger
10. Light switch
11. Socket for battery charger
12. Lever to engage or disengage the electric parking brake

Display overview

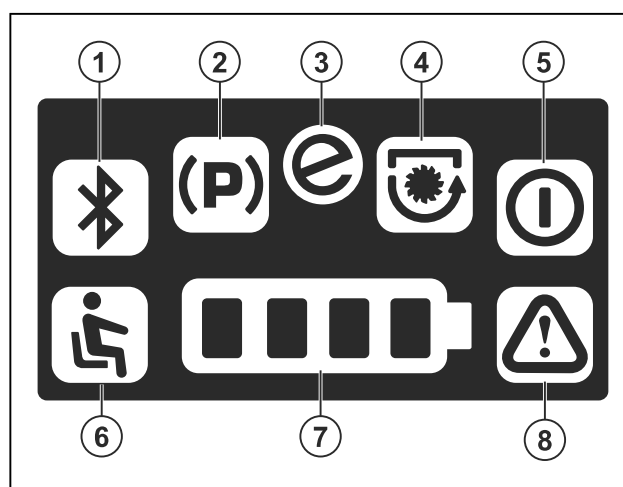

1. Not used in this product
2. Parking brake indicator
3. SavE indicator
4. Blades engaged indicator

5. Standby indicator
6. Operator presence control (OPC)
7. Battery level indicator
8. Warning indicator

Husqvarna Connect

The operators manual and more information about the product is available at Husqvarna Connect App. Husqvarna Connect is a free App for your mobile device. Refer to *To start to use Husqvarna Connect on page 15.*

Operator Presence Control (OPC)

The OPC engages when the operator lifts from the seat. The drive motor stops. The cutting deck motors stop if the blades are engaged. Refer to *Operation conditions on page 10.*

Work light

The product has work light. Push the power switch to make the work light come on (A) or go off (B).

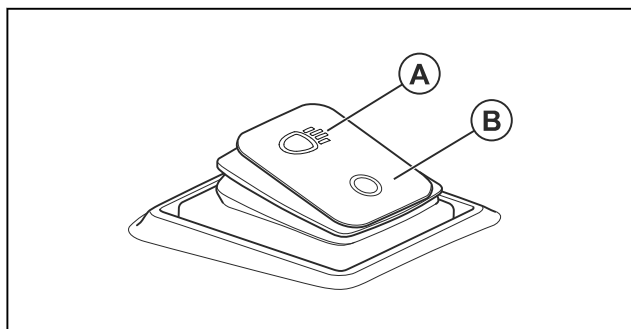

Symbols on the product



WARNING: This product can be dangerous and cause serious injury or death to the operator or others. Be careful and use the product correctly.



Read the operator's manual carefully and make sure that you understand the instructions before you use this product.



Remove the power switch key before you do maintenance on the product.



Automatic parking brake



Engage the electric parking brake.



Disengage the electric parking brake.



Power off



Power on

START

Start drive mode.



Cutting height



Reverse operation system (ROS)



Reverse



Forward



Work lights on/off



Use hearing protection.



The blades are disengaged.



The blades are engaged.



Keep body parts away from rotating parts.



Keep body parts away from rotating blades.



Look out for ejecting objects and ricochets.



Do not cut grass across a slope. Do not cut grass on ground that slopes more than 10°.



Tip-over hazard



Look behind you before and while you move the product in reverse.



Never carry passengers on the product or equipment.

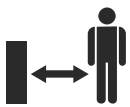

Keep bystanders away.



No step



MAX. XXXN / (XXkg)

Max. permitted vertical load on the towbar is specified in *Technical data on page 35* and on the label.



MAX. XXXN / (XXkg)

Max. permitted horizontal load on the towbar is specified in *Technical data on page 35* and on the label.



Do not try to repair the battery. Speak to your Husqvarna servicing dealer.



Noise emission to the environment label as per EU and UK directives and regulations, and New South Wales legislation "Protection of the Environment Operations (Noise Control) Regulation 2017". The guaranteed sound power level of the product is specified in *Technical data on page 35* and on the label.



Scannable code



The product agrees with the applicable EC directives.



This product conforms to the applicable UK regulations.

Note: Other symbols/decals on the product refer to market specific legal requirements.

Label on the product



DANGER – Keep hands and feet away.

Product damage

We are not responsible for damages to our product if:

- the product is incorrectly repaired.

- the product is repaired with parts that are not from the manufacturer or not approved by the manufacturer.
- the product has an accessory that is not from the manufacturer or not approved by the manufacturer.

Safety

Safety definitions

Warnings, cautions and notes are used to point out specially important parts of the manual.



WARNING: Used if there is a risk of injury or death for the operator or bystanders if the instructions in the manual are not obeyed.



CAUTION: Used if there is a risk of damage to the product, other materials or the adjacent area if the instructions in the manual are not obeyed.

Note: Used to give more information that is necessary in a given situation.

General product safety warnings



WARNING: Read all safety warnings, instructions, illustrations and specifications provided with this product. Failure to follow all instructions listed below may result in electric shock, fire and/or serious injury.

Save all warnings and instructions for future reference. The term "product" in the warnings refers to your mains-operated (corded) product or battery-operated (cordless) product.

Work area safety

- **Keep work area clean and well lit.** Cluttered or dark areas invite accidents.
- **Do not operate the product in explosive atmospheres, such as in the presence of flammable liquids, gases or dust.** The product create sparks which may ignite the dust or fumes.
- **Keep children and bystanders away while operating the product.** Distractions can cause you to lose control.

Personal safety

- **Stay alert, watch what you are doing and use common sense when operating a product. Do not use a product while you are tired or under the influence of drugs, alcohol or medication.** A moment of inattention while operating products may result in serious personal injury.

- the product is not repaired at an approved service center or by an approved authority.
- **Use personal protective equipment. Always wear eye protection.** Protective equipment such as dust mask, non-skid safety shoes, hard hat or hearing protection used for appropriate conditions will reduce personal injuries.
- **Prevent unintentional starting. Ensure the switch is in the off-position before connecting to power source and/or battery pack, picking up or carrying the product.** Carrying products with your finger on the switch or energising products that have the switch on invites accidents.
- **Remove any adjusting key or wrench before turning the product on.** A wrench or a key left attached to a rotating part of the product may result in personal injury.
- **Do not overreach. Keep proper footing and balance at all times.** This enables better control of the product in unexpected situations.
- **Dress properly. Do not wear loose clothing or jewellery. Keep your hair and clothing away from moving parts.** Loose clothes, jewellery or long hair can be caught in moving parts.
- **If devices are provided for the connection of dust extraction and collection facilities, ensure these are connected and properly used.** Use of dust collection can reduce dust-related hazards.
- **Do not let familiarity gained from frequent use of products allow you to become complacent and ignore product safety principles.** A careless action can cause severe injury within a fraction of a second.

Product use and care

- **Do not force the product. Use the correct product for your application.** The correct product will do the job better and safer at the rate for which it was designed.
- **Do not use the product if the switch does not turn it on and off.** Any product that cannot be controlled with the switch is dangerous and must be repaired.
- **Disconnect the plug from the power source and/or remove the battery pack, if detachable, from the product before making any adjustments, changing accessories, or storing products.** Such preventive safety measures reduce the risk of starting the product accidentally.
- **Store idle products out of the reach of children and do not allow persons unfamiliar with the product or these instructions to operate the product.** Products are dangerous in the hands of untrained users.
- **Maintain products and accessories. Check for misalignment or binding of moving parts, breakage**

of parts and any other condition that may affect the product's operation. If damaged, have the product repaired before use. Many accidents are caused by poorly maintained products.

- **Keep cutting tools sharp and clean.** Properly maintained cutting tools with sharp cutting edges are less likely to bind and are easier to control.
- **Use the product, accessories and tool bits etc. in accordance with these instructions, taking into account the working conditions and the work to be performed.** Use of the product for operations different from those intended could result in a hazardous situation.
- **Keep handles and grasping surfaces dry, clean and free from oil and grease.** Slippery handles and grasping surfaces do not allow for safe handling and control of the product in unexpected situations.

Battery tool use and care

- **Recharge only with the charger specified by the manufacturer.** A charger that is suitable for one type of battery pack may create a risk of fire when used with another battery pack.
- **Use products only with specifically designated battery packs.** Use of any other battery packs may create a risk of injury and fire.
- **When battery pack is not in use, keep it away from other metal objects, like paper clips, coins, keys, nails, screws or other small metal objects, that can make a connection from one terminal to another.** Shorting the battery terminals together may cause burns or a fire.
- **Under abusive conditions, liquid may be ejected from the battery; avoid contact. If contact accidentally occurs, flush with water. If liquid contacts eyes, additionally seek medical help.** Liquid ejected from the battery may cause irritations or burns.
- **Do not use a battery pack or tool that is damaged or modified.** Damaged or modified batteries may exhibit unpredictable behavior resulting in fire, explosion or risk of injury.
- **Do not expose a battery pack or tool to fire or excessive temperature.** Exposure to fire or temperature above 130 °C may cause explosion.
- **Follow all charging instructions and do not charge the battery pack or tool outside the temperature range specified in the instructions.** Charging improperly or at temperatures outside the specified range may damage the battery and increase the risk of fire.

Service

- **Have your product serviced by a qualified repair person using only identical replacement parts.** This will ensure that the safety of the product is maintained.
- **Never service damaged battery packs.** Service of battery packs should only be performed by the manufacturer or authorized service providers.

General safety instructions



WARNING: This product can cut off hands and feet and throw objects. Serious injury or death may occur if you do not obey the safety instructions.



WARNING: Do not continue to use a product with damaged cutting equipment. Damaged cutting equipment can throw objects and cause serious injury or death. Replace damaged blades immediately.



WARNING: This product produces an electromagnetic field during operation. This field may under some circumstances interfere with active or passive medical implants. To reduce the risk of serious or fatal injury we recommend persons with medical implants to consult their physician and the medical implant manufacturer before operating this product.



WARNING: Read the warning instructions that follow before you use the product.

- Always be careful and use your common sense. Avoid all situations which you consider to be beyond your capability. If you feel uncertainty about the operating procedures after you read the operator's manual, consult an expert before you continue.
- Read and understand the operator's manual and the instructions on the product carefully before you start the product.
- Learn how to use the product and its controls safely and learn how to stop the product quickly.
- Learn to recognize the safety decals.
- Do not change this product or use the product if it is possible that it has been changed by others.
- Keep the product clean to make sure that you can clearly read signs and stickers.
- Keep in mind that the operator will be held responsible for accidents that involve other persons or their property.
- Do not put hands or feet near parts that rotate.
- Do not put hands or feet below the product.
- Keep away from the discharge opening at all times.
- Make sure that discharged material does not hit other persons or animals.
- Make sure that discharged material does not hit walls or other hard surfaces. Discharged materials can ricochet.
- Always stop the blades when you operate the product on gravel surfaces.

- Do not operate the cutting deck if the discharge chute or other safety devices are missing or defective.
- Always disengage the blades when you do not mow.
- Do not use the cutting deck to mow leaves or other unwanted materials that can cause buildup.
- Do not transport passengers. The product must only be used by one person.

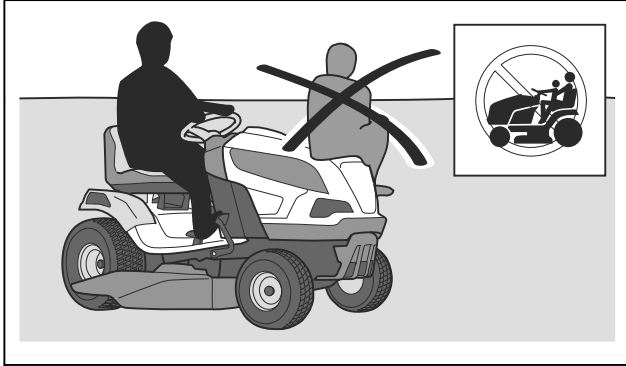

- Do not let the product stay unsupervised with the power on. Always stop the blades, make sure that the parking brake is engaged, stop the motor, and remove the key for the power switch before you let the product stay unsupervised.
- Only use the product in daylight or in other well-lit conditions. Keep the product at a safe distance from holes or other irregularities in the ground. Look out for other possible risks.
- Do not use the product in bad weather, for example in fog, in rain, moist or in wet locations, strong winds, intense cold, risk of lightning, etc.
- Find and mark stones and other fixed objects to prevent collision.
- Clear the area of objects such as stones, toys, wires, etc. that may become caught in the blades and be thrown out.

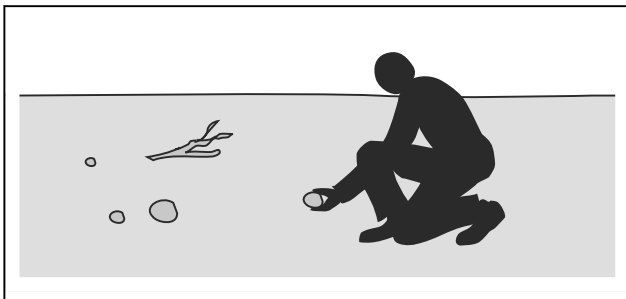

- Do not let children or other persons not approved for operation of the product to use or do servicing on it. Local laws may regulate the age of the user.
- Make sure that nobody else is in the vicinity of the product when you start the product, engage the drive, or start to move the product.
- Keep an eye on the traffic when you mow near a road or move across a road.
- Do not use the product if you are fatigued, while under the influence of alcohol or drugs, medicine

or anything that can have a negative effect on your vision, alertness, coordination or judgement.

- Be careful when you put the product on a trailer or a truck and when you remove the product from a trailer or truck.
- Always park the product on a level surface with the power off.
- Stop the product and make sure that all parts have stopped before you clean or do maintenance on the product.
- Stop the product and make sure that all parts have stopped before you remove the grass catcher or remove blockage in the discharge chute.
- Let the product become cool before you put it in storage.

Safety instructions regarding children



WARNING: Read the warning instructions that follow before you use the product.

- Serious accidents can occur if you are not on your guard for children in the vicinity of the product. Children can be attracted to the product and to mowing. It is very possible that children do not stay where you last saw them.
- Keep children away from the area to be mowed. Make sure that an adult is responsible for the children.
- Keep an eye out and stop the product if children enter the work area. Be very careful near corners, bushes, trees or other objects that prevents a clear view.
- Before and while you move the product in reverse, look behind you and look down to make sure there are no small children in the vicinity of the product.
- Do not let children ride along. They can fall off and get seriously injured or prevent safe maneuvering of the product.
- Do not let children operate the product.

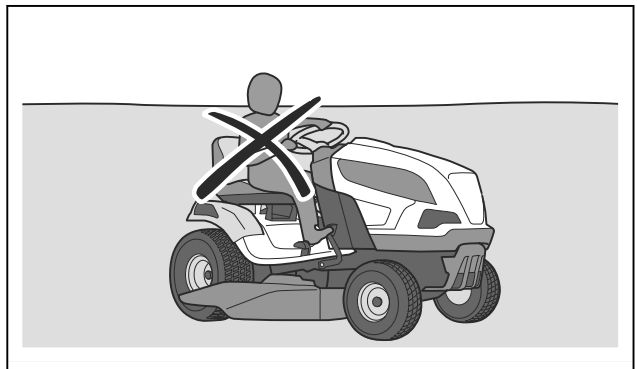

Battery safety



WARNING: Read the warning instructions that follow before you use the product.

General:

- Read all safety warnings and all instructions. Failure to follow the warnings and instructions may result in electric shock and fire and/or serious injury.
- Entrust installation and repairs to your authorized servicing dealer only. Never attempt to install or repair the batteries.
- Regularly check that the batteries are intact. Damaged or modified batteries may exhibit unpredictable behavior resulting in fire, explosion or risk of injury. Never repair or open damaged batteries.
- A damaged battery can cause an explosion and cause injury. If the battery has a deformation or is damaged, do not use the product and speak to an approved Husqvarna service agent.
- Do not dismantle, open or shred batteries.
- Do not subject batteries to mechanical shock.
- Do not expose cells or batteries to heat or fire. Avoid storage in direct sunlight.
- Do not short circuit batteries. Do not keep batteries in storage where they can short circuit each other or be short circuited by other metal objects.
- Do not allow battery content to come in contact with the skin or eyes. If contact has been made, wash the affected area with copious amounts of water and seek medical advice.
- Do not use any battery which is not designed for use with the equipment.
- Do not mix cells of different manufacture, capacity, size or type within a device.
- Keep cells or batteries out of the reach of children.
- Keep the battery clean and dry.
- Use only the battery in the application for which it was intended.

48 V batteries:

- The Husqvarna 48 V batteries are exclusively used as power supply for the Husqvarna battery ride-on products. To avoid injury, the battery must not be used as a power source for other devices.
- Never use batteries or appliances that is faulty, modified or damaged.
- Never attempt to modify or repair the appliances or the batteries. Entrust all repairs to your authorized servicing dealer only.

Safety instructions for operation



WARNING: Read the warning instructions that follow before you use the product.

- Always look down and behind you before and while you move in reverse. Look out for large and small obstacles.
- Decrease the speed before you turn around a corner.
- Stop the blades when you move across areas that you do not cut.



CAUTION: Read the caution instructions that follow before you use the product.

- Move around stones and other larger objects carefully and make sure that the blades do not hit the objects.
- Do not operate the product across objects. Stop and examine the product and cutting deck if you operate the product across or into an object. If it is necessary, make repairs before you restart.

Personal protective equipment



WARNING: Read the warning instructions that follow before you use the product.

- Use approved personal protective equipment when you use the product. Personal protective equipment cannot fully prevent injury but it decreases the degree of injury if an accident does occur. Let your dealer help you select the right equipment.
- Use approved hearing protection. Long-term exposure to noise can result in permanent hearing impairment.
- Use heavy-duty slip-resistant boots or shoes. Steel toes are recommended. Do not use open shoes or go with bare feet.

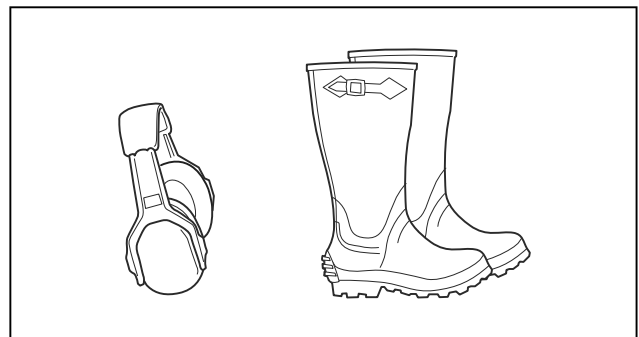

- Use protective gloves when necessary, for example when you attach, examine or clean the cutting equipment.

- Do not wear loose-fitting clothing, jewelry or other items that can get caught in moving parts.
- Keep first aid equipment and fire extinguisher near.

Safety devices on the product



WARNING: Read the warning instructions that follow before you use the product.

- Do not use a product with safety devices that are damaged or do not operate correctly. Do a check of the safety devices regularly. If the safety devices are damaged, speak to your Husqvarna service agent.
- Do not make modifications on safety devices. Do not use the product if protective plates, protective covers, safety switches or other protective devices are not attached or are damaged.

To do a check of the power switch

1. Disconnect the battery charge cable.
2. Turn the power switch to "I". Make sure that all the used LEDs on the display come on.

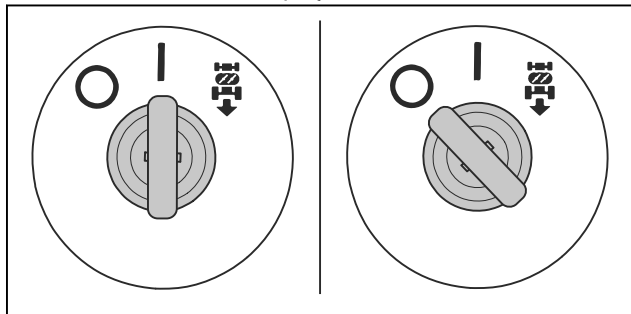

3. Turn the power switch to "O". Make sure that the product stops immediately and the LEDs on the display go off.

To do a check of the reverse operation system (ROS)

If the reverse operation system (ROS) does not operate correctly, speak to an approved service agent.

1. Start the product. Refer to *To start the product on page 17*.
2. Engage the cutting deck. Refer to *To engage and disengage the cutting deck on page 17*.

3. With the power switch in the "I" position (A), push down on the rearward pedal. The blades must stop when you push down on the rearward pedal.

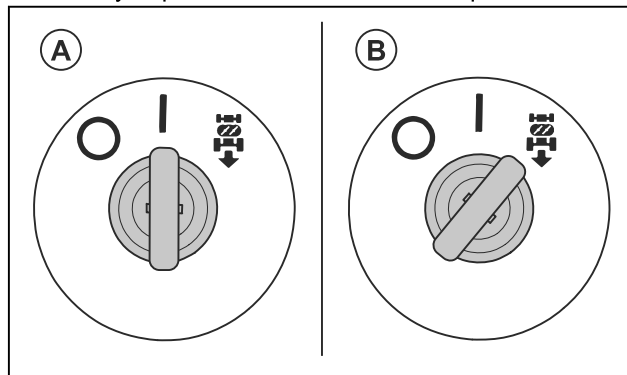

4. Disengage the cutting deck.
5. Turn the power switch to the ROS on position (B).
6. Engage the cutting deck again.
7. With the power switch in the ROS on position, push down on the rearward pedal. The blades must not stop when you push down on the rearward pedal.

Operation conditions

- The drive mode can only start when the drive of the blades is disengaged.
- The drive mode can only start when the forward pedal and the rearward pedal are in their neutral position.
- The drive mode can only start when the electric parking brake is engaged.
- The product can only operate in reverse with the cutting deck engaged when the ROS is engaged.
- The drive of the blades can only operate when the operator sits in the seat.

To do a check of the operation conditions

Do a check of the operation conditions daily.

1. Make sure that you cannot start the drive mode when the drive of the blades is engaged.
2. Make sure that you cannot start the drive mode when you push the forward pedal or rearward pedal.
3. Make sure that you cannot start the drive mode when the electric parking brake is disengaged.
4. Make sure that the drive on the blades stops when the cutting deck is engaged and you lift from the seat.
5. Do a check of the reverse operation system (ROS). Refer to *To do a check of the reverse operation system (ROS) on page 10*.

To do a check of the forward pedal and rearward pedal

1. Start the product. Refer to *To start the product on page 17*.
2. Make sure that the forward pedal and rearward pedal are not blocked and can be operated freely.

3. Slowly push the forward pedal to move forward.
4. Release the forward pedal to brake. Make sure that the brake engages when the forward pedal is released.

Note: The product has an automatic brake that engages when you release the pedals.

5. Do the same procedure for the rearward pedal.
6. Make sure that the product does not move when the pedals are in their neutral position.

Parking brake



WARNING: If the parking brake does not work, the product can start to move and cause injury or damage. Make sure that the parking brake is regularly examined and adjusted.

Refer to *Parking brake* on page 16.

Warning indicator on the display



CAUTION: If the warning indicator on the display comes on, stop the product and refer to *Troubleshooting* on page 27.

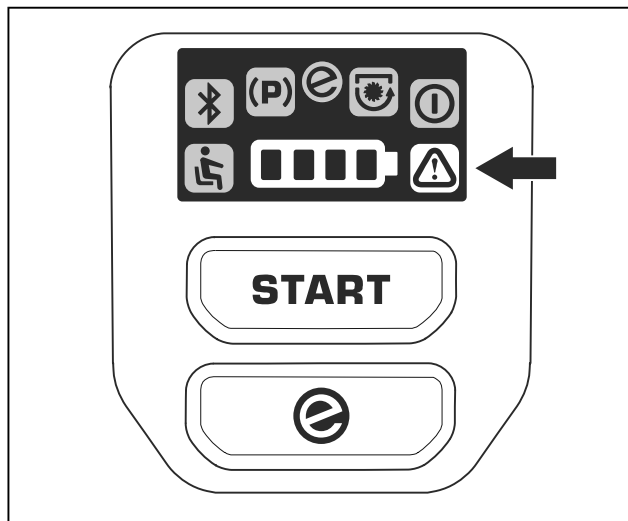

Protective covers

Missing or damaged protective covers increase the risk of injury on moving parts and hot surfaces. Do a check of the protective covers before you operate the product. Make sure that the protective covers are correctly attached and do not have cracks or other damages. Replace damaged covers.

To cut grass on slopes



WARNING: Read the warning instructions that follow before you use the product.

- To cut grass on slopes increases the risk that you can not control the product and that it overturns. This can cause injury or death. It is necessary to cut the grass carefully on all slopes. If you cannot reverse up a slope or if you do not feel safe, do not cut it.
- Remove stones, branches and other obstacles.
- Cut up and down the slope, not from side to side.
- Do not operate the product on ground that slopes more than 10°.

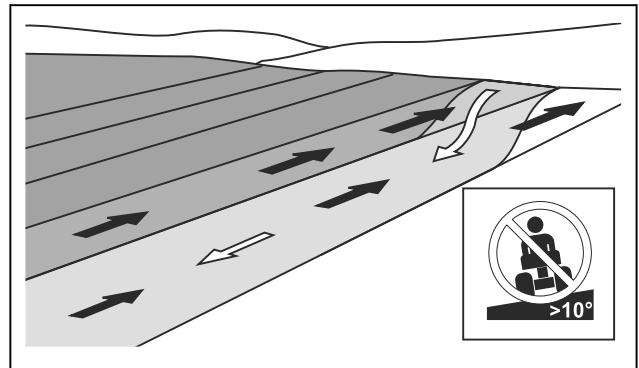

- Do not start or stop on a slope.
- Move smoothly and slowly on slopes.
- Do not make sudden changes in speed or direction.
- Do not turn more than necessary. Turn slowly and gradually when you move down a slope. Move at low speed. Turn the wheel carefully.
- Look out for and do not move across furrows, holes and bumps. There is a higher risk that the product overturns on ground that is not flat. Long grass can hide obstacles.
- Do not cut grass near edges, ditches or banks. The product can suddenly overturn if a wheel moves across the edge of a steep slope or a ditch, or if an edge gives way. If the product falls into water, there is a risk of drowning.

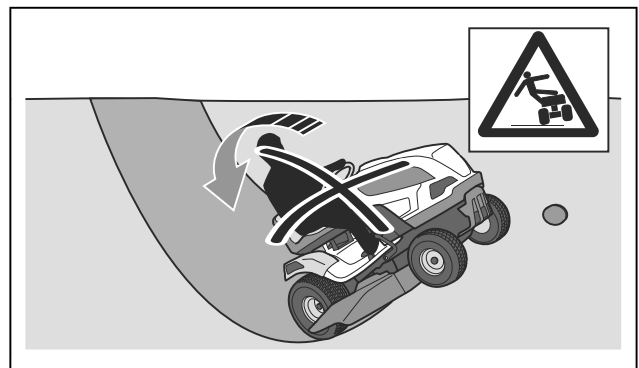

- Do not cut wet grass. It is slippery, and tires can lose their grip so that the product skids.

- Do not put your foot on the ground to try to make the product more stable.
- Move very carefully if an accessory or other object is attached that can make the product less stable.
- Follow the manufacturer's recommendations for wheel weights or counterweights.

Tow safety

- Only use tow equipment approved by Husqvarna.
- Use the tow bar to attach the equipment.
- Do not tow equipment that is heavier than the maximum permitted tow equipment weight. Refer to *Technical data on page 35*.

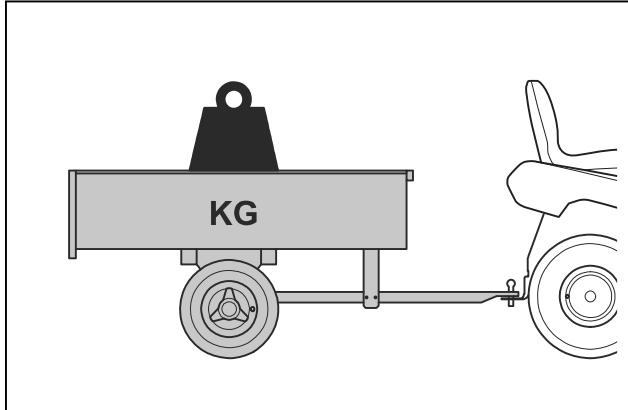

- Make sure that no other persons are near the product when you tow equipment.
- Be careful when you tow equipment on slopes or rough ground.
- Operate the product at low speed when you tow equipment.

Transport safety

- Use an approved transport vehicle for transportation of the product.
- The product is heavy and can cause crush injuries. Be careful when you load it onto or off a vehicle or trailer.
- A markets national or local regulations can set limit to the transportation of the product.
- The operator of the transport vehicle is responsible to attach the product safely during transport. Refer to *To safely attach the product for transportation on page 32*.

Battery safety



WARNING: A damaged battery can cause an explosion and cause injury. If the battery has a deformation or is damaged, speak to an approved Husqvarna service agent.



WARNING: Read the warning instructions that follow before you use the product.

- Use protective glasses when you are near batteries.
- Do not wear watches, jewelry or other metal objects near the battery.
- Keep the battery out of reach for children.
- Charge the battery in a space with good airflow.
- Keep flammable materials at a minimum clearance of 1 m when you charge the battery.
- Discard replaced batteries. See *Disposal of the battery and battery charger on page 33*.
- Explosive gases can come from the battery. Do not smoke near the battery. Keep the battery away from open flames and sparks.

Safety instructions for maintenance



WARNING: The product is heavy and can cause injury or damage to property or the adjacent area. Do not do maintenance on the product and cutting deck without these conditions:

- The power switch is set to in the off (O) position and the key to the power switch is removed.
- The product is parked on a level surface.
- The electric parking brake is engaged.
- The cutting deck is disengaged.
- The cable to the battery charger is disconnected.



WARNING: Read the warning instructions that follow before you use the product.

- For best performance and safety, do maintenance on the product regularly as given in the maintenance schedule. Refer to *Maintenance schedule on page 19*.
- Electrical shocks can cause injuries. Do not do maintenance on the battery. Do not touch the cables when the motor is on. Do not do a function test with your fingers.
- Do not start the product if the protective covers are removed. There is a high risk of injury caused by hot parts or electrical shock.
- Let the product become cool before you do maintenance on it.
- The blades are sharp and can cause cuts. Wind protection around the blades or use protective gloves when you do work on the blades.



CAUTION: Read the caution instructions that follow before you use the product.

- Make sure that all nuts and bolts are tightened correctly and that the equipment is in good condition.

- The vibrations in the product during operation can be different from the declared vibration value in *Technical data on page 35*. The difference is caused by variations in how the product is used. If you operate the product frequently or for long

periods of time, take breaks regularly to prevent injury from vibrations.

- The product is approved only with the equipment supplied or recommended by the manufacturer.

Assembly

Introduction



WARNING: Read and understand the safety chapter before you assemble the product.

Assembly overview

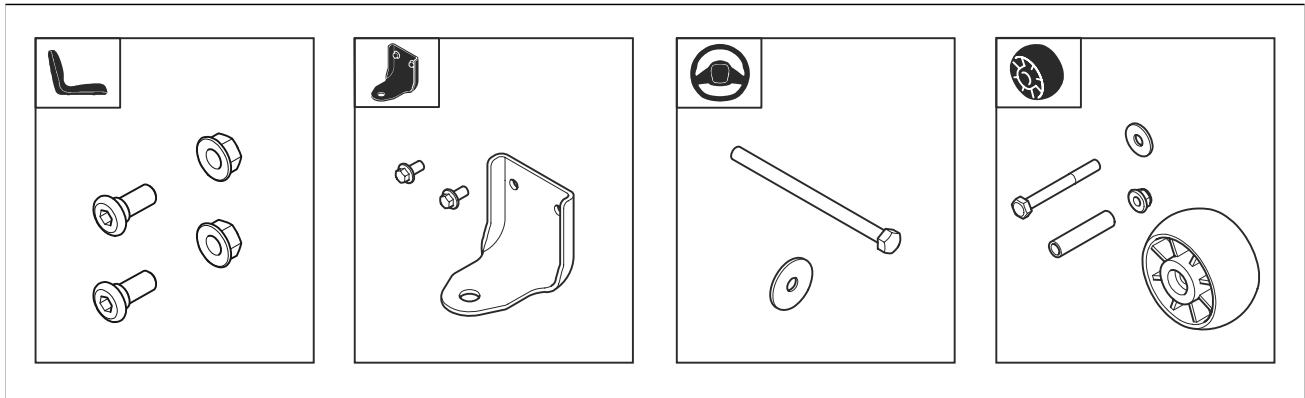

To install the steering wheel

Refer to *Assembly overview on page 13* for the correct fasteners for this task.

1. Install the steering column cover. The steering column cover is attached with snap locks. Push down on the steering column cover until it locks in position.

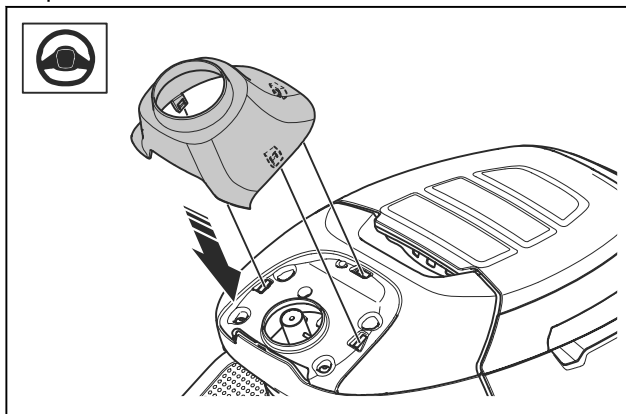

2. Put the steering wheel (A) on the steering column. The pins on the steering column must go into the slots in the steering wheel.

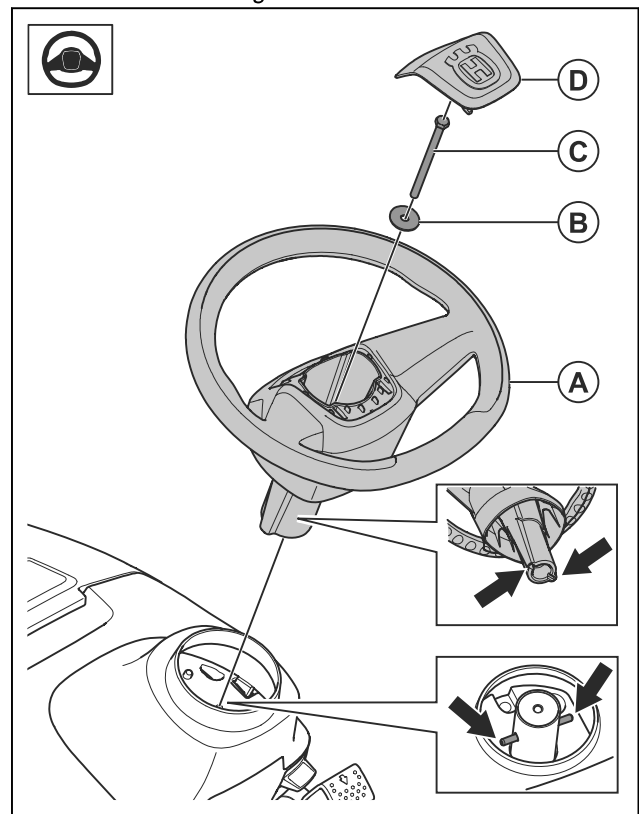

3. Install the washer (B) and the bolt (C). Tighten the bolt to 24 Nm.
4. Install the center cover (D) on the steering wheel.
The center cover is attached with snap locks.

To install the seat

Refer to *Assembly overview on page 13* for the correct fasteners for this task.

1. Hold the seat in position and install the 2 screws (A) and the 2 nuts (B).

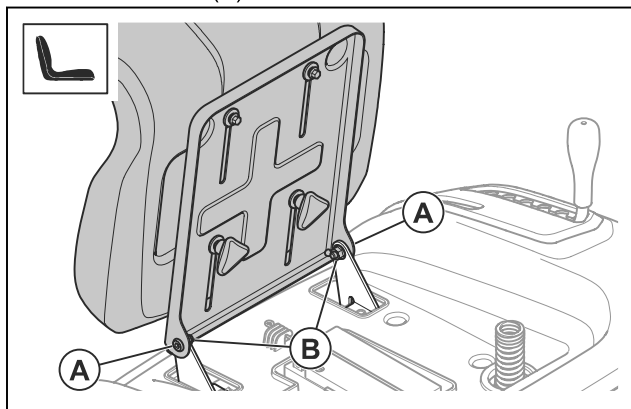

2. Do a check of the operator presence control. Refer to *Operation conditions on page 10*.



WARNING: Do not operate the product if the operator presence control is defective.

To install the anti-scalp wheels

Refer to *Assembly overview on page 13* for the correct fasteners for this task.

- Install the anti-scalp wheel (A), the bushing (B), the washer (C), the bolt (D), and the nut (E) in 1 of the 3 holes.

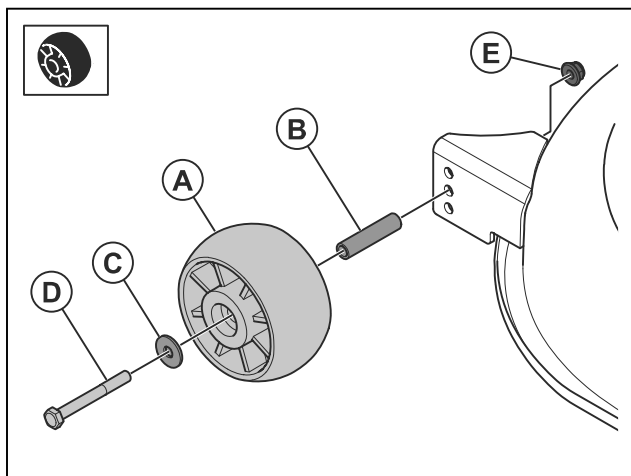

To adjust the seat

1. Fold the seat forward.
2. Loosen the 2 quick knobs.

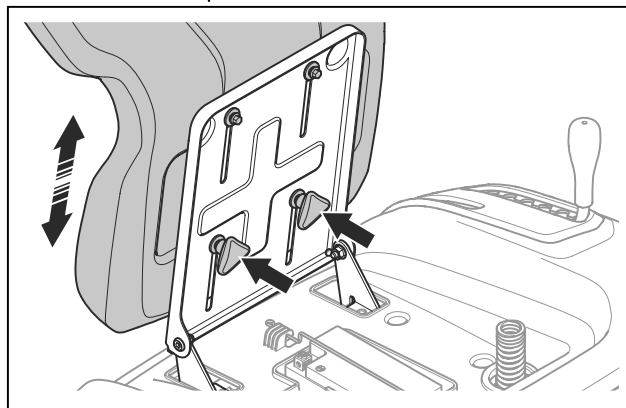

3. Move the seat until it is in a position where you can push the pedals down fully.
4. Tighten the 2 quick knobs fully.

To install the tow bar

Refer to *Assembly overview on page 13* for the correct fasteners for this task.

- Install the tow bar with the 2 screws.

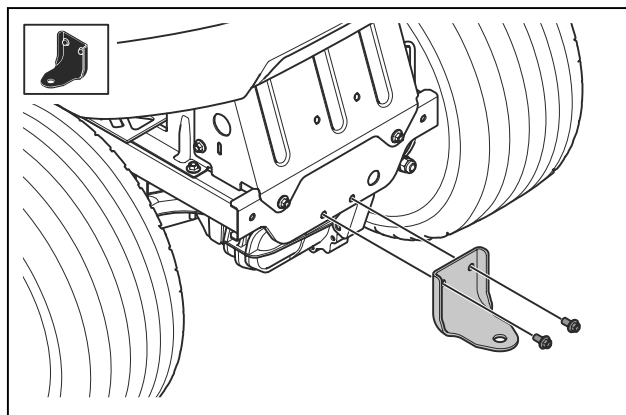

Operation

Introduction



WARNING: Read and understand the safety chapter before you use the product.

To start to use Husqvarna Connect

1. Download the Husqvarna Connect app on your mobile device.
2. Register in the Husqvarna Connect app.
3. Do the instruction steps in the Husqvarna Connect app to connect and register the product.

To charge the battery



WARNING: An incorrectly used or damaged battery charger can cause an electrical shock, battery leakage or too high temperatures. Regularly examine the battery charger and the battery for damage.



CAUTION: Charge the battery before you use it the first time. A new battery is not fully charged.



CAUTION: Only use approved battery chargers. Refer to *Approved battery chargers* on page 37.



CAUTION: The charge process is only possible when the temperature of the battery is in the permitted charge temperature range (0–45°C). If the temperature of the battery is higher than 50°C, the temperature of the battery must decrease below 40°C before the charge process starts. If the battery temperature is lower than -5°C, the temperature of the battery must be more than 5°C before the charge process starts.



CAUTION: Use the battery in conditions where temperatures are between 0°C and 40°C.

Note: The battery can go into sleep mode when the product is in storage or the state of charge is very low. To start the battery, the start button must be pushed for 2 seconds. If the battery does not start it must be charged continuously until it is fully charged. The charge time is longer when the battery is in sleep mode.

1. Connect the battery charger to a grounded mains socket and to the product.

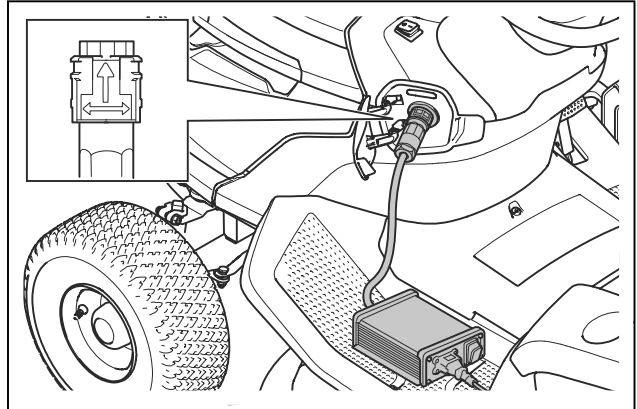

2. Set the battery charger ON/OFF switch to ON.
3. Wait until the battery is fully charged. The battery is fully charged when all 4 battery LED lights are solid. Refer to *Battery indication* on page 15.
4. Set the charger ON/OFF switch to OFF before you disconnect the battery charger.

Battery indication

The battery indicator on the display shows the state of charge when the product is activated. When the charger is connected and the product is activated, the display shows a charge animation. When the battery is fully charged and the charger is connected, all 4 battery LED lights are solid.

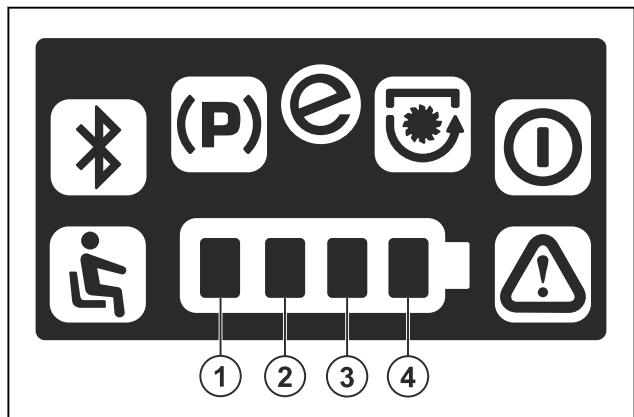

LED lights	State of charge
All 4 LED lights are solid.	The battery is 76%–100% charged.
LED light 1–3 are solid.	The battery is 51%–76% charged.
LED light 1–2 are solid.	The battery is 26%–51% charged.

LED lights	State of charge
LED light 1 is solid.	The battery is 0%–25% charged.

When the battery is low, the first LED light flashes and the product goes into reduced mode. The product operates at lower speed and the blades stop to save power. When the battery is almost empty, the first LED light and the warning indicator flash together. It is possible to operate the product in reduced mode. Charge the battery as soon as possible.

When a charger is connected, 4 LEDs above the socket for the battery charger show the state of charge.

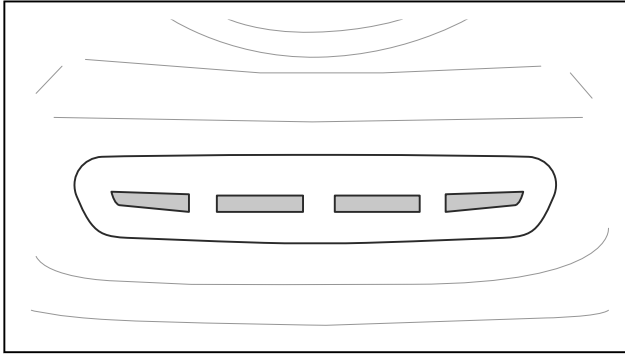

Note: All 4 LEDs come on momentarily when the battery charger is connected.



CAUTION: If no LEDs come on or if red LEDs flash when the battery charger is connected, there is an error. Look for warning symbols on the display. Disconnect the charger and refer to *Troubleshooting on page 27*.

When the battery is fully charged, all 4 LEDs are on.



CAUTION: If the charger is connected and the charger ON/OFF switch is set to OFF, all charge indicators will go off. Make sure that you disconnect the charger before you operate the product.

LEDs	State of charge
All 4 LEDs are on.	The battery is 76–100% charged.
LEDs 1–3 are on.	The battery is 51–75% charged.
LEDs 1–2 are on.	The battery is 26–50% charged.
LED 1 is on.	The battery is 0–25% charged.

Note: If a charger is connected when the temperature of the battery is higher or lower than the permitted charge temperature range, the charge does not start. Yellow LEDs show the state of charge. When the temperature of the battery is in the permitted charge temperature range, the charge automatically starts.

Note: If you use the product in cold temperatures, the operation time can decrease.

To disconnect the battery charger

Note: It is not possible to start the product when the battery charger is connected.

1. Set the charger ON/OFF switch to OFF.
2. Turn the charger plug to disconnect the battery charger.

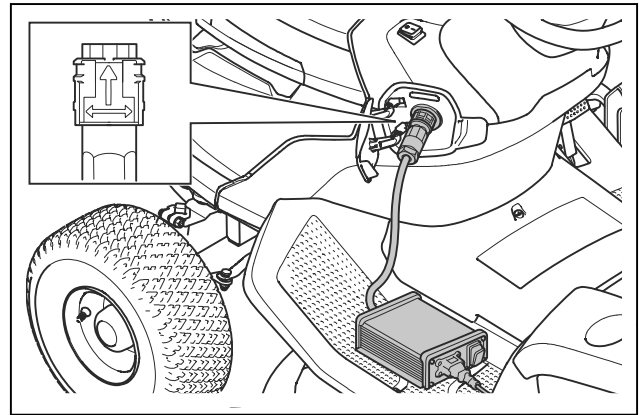

Parking brake

The parking brake is electric. The parking brake is automatically applied when the product is stationary and released when you push the pedals. A parking brake symbol shows on the display when the parking brake is applied.

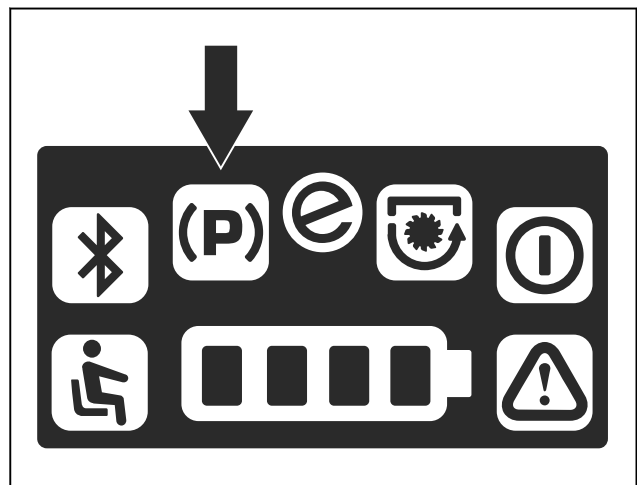

To move the product manually



WARNING: Before you operate the product, make sure that the electric parking brake system is engaged.



CAUTION: Do not push the product longer than necessary or at a speed higher than 6 km/h.

To move the product with the motor off, the electric parking brake system must be disengaged. The lever for the electric parking brake system is behind the left rear wheel.

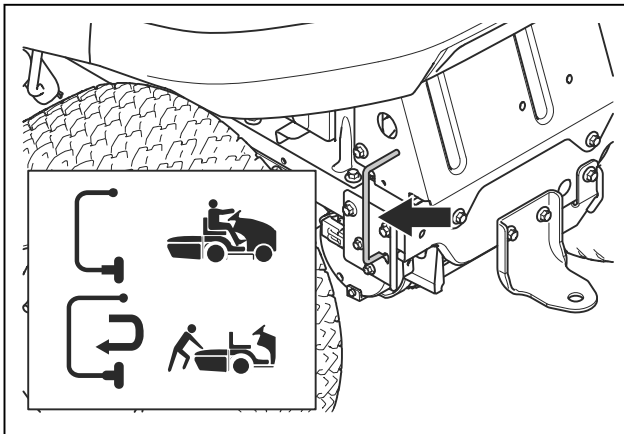

- To disengage the electric parking brake system, do the steps that follow.
 - a) Move the lever to the right.
 - b) Pull the lever out and move it to the left.
- To engage the electric parking brake system, do the steps that follow.
 - a) Move the lever to the right and push it in.
 - b) Pull the lever to the left.

To start the product

1. Disconnect the cable to the battery charger.
2. Make sure that the electric parking brake is engaged. Refer to *Parking brake on page 16*.
3. Put the cutting deck in the highest position. Refer to *To set the cutting height on page 18*.
4. Make sure that the cutting deck is disengaged. Refer to *To engage and disengage the cutting deck on page 17*.
5. Sit in the seat in work position.

6. Set the power switch to the "I" position. The standby indicator flashes and the product is set to idle mode.

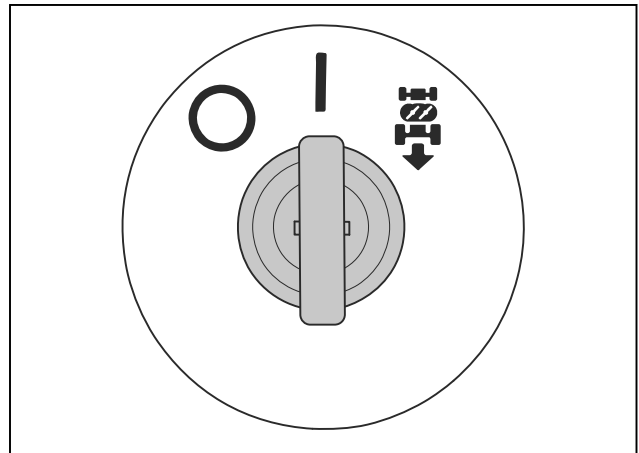

Note: The battery can go into sleep mode when the product is in storage or if the state of charge is very low. If the battery is in sleep mode, nothing happens when you set the power switch to the "I" position. To start the battery, push the start button for 2 seconds. If the battery does not start, it must be charged continuously until it is fully charged. The charge time is longer when the battery is in sleep mode.

7. Push the start button for 2 seconds. The standby indicator comes on and the product is set to drive mode.

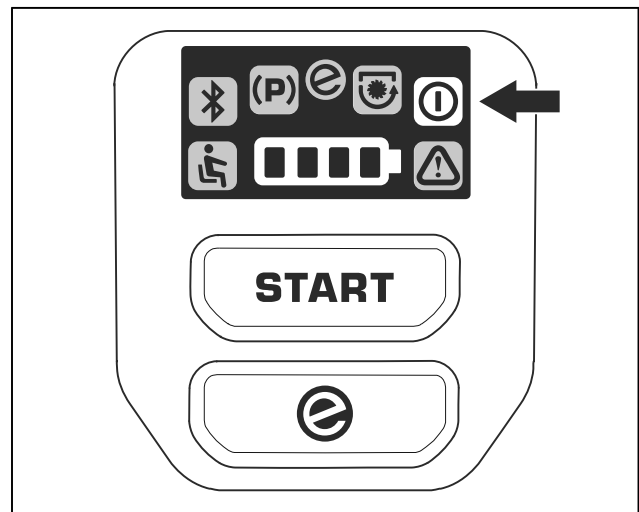

To engage and disengage the cutting deck



WARNING: Do not operate the cutting deck without a deflector installed to the grass discharge.

- Pull out the PTO button to engage the cutting deck.

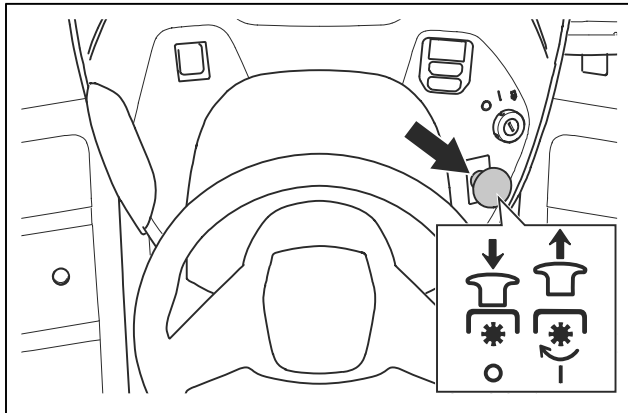

- Push in the PTO button to disengage the cutting deck.

To set the cutting height

- Pull the cutting height lever in the direction of the seat and put it in 1 of the notches for the correct cutting height.

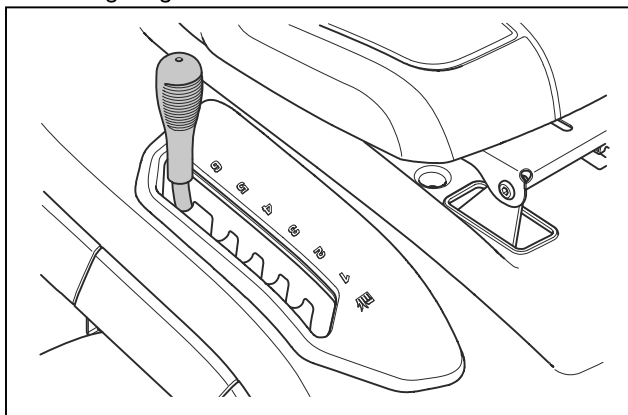

To operate the product

1. Start the product. Refer to *To start the product on page 17.*
2. Carefully push the forward pedal (A) or the rearward pedal (B). The speed increases the more the pedal is pushed down.

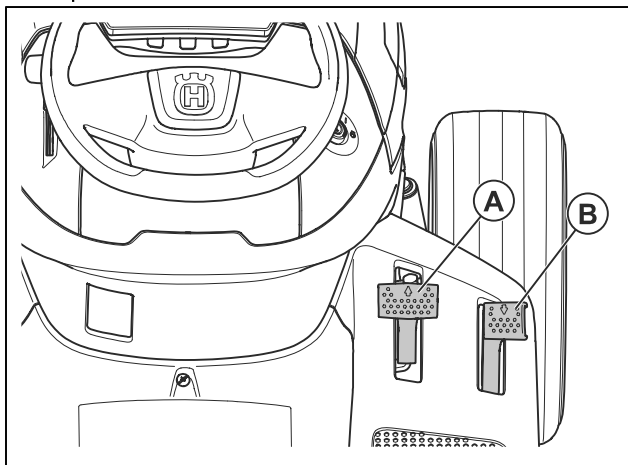

Note: The parking brake is automatically released when you push a pedal.

Note: The forward pedal and the rearward pedal go back to their neutral position when they are released.

3. Release the pedals to brake.
4. Select the correct cutting height. Refer to *To set the cutting height on page 18.*
5. Engage the cutting deck. Refer to *To engage and disengage the cutting deck on page 17.*

To use the reverse operation system (ROS)

Note: If you try to go rearward with the product when the cutting deck is engaged, the product stops immediately. Engage the ROS to go rearward with the product when the cutting deck is engaged.



WARNING: Before and while you operate the product rearward, look down and behind the product for the safety of others.

1. Start the product. Refer to *To start the product on page 17.*

Note: It is not possible to start the product when the power switch is in the ROS position.

2. Turn the power switch clockwise to the ROS position to engage the ROS.

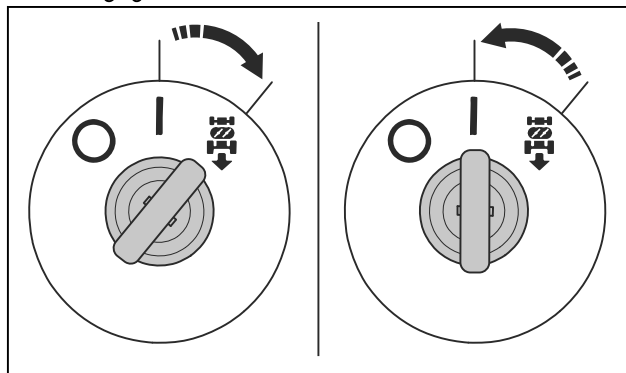

3. Slowly push down the rearward pedal to start movement.
4. Turn the power switch counterclockwise to the "I" position to disengage the ROS.

To use the SavE function

The product has a battery save function (SavE) that gives longer operation time. The SavE function decreases the speed of the product and the speed of the blades.

- To start the SavE function, push and hold the SavE button until the SavE symbol comes on with a constant green light.

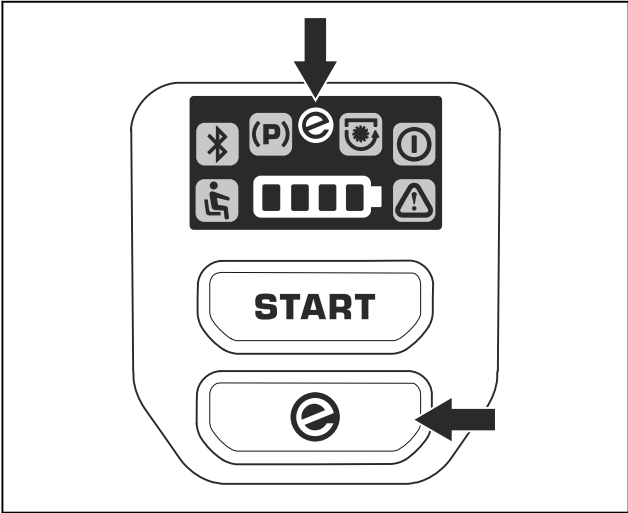

- To stop the SavE function, push and hold the SavE button until the SavE symbol goes off.

To stop the product

- Disengage the cutting deck. Refer to *To engage and disengage the cutting deck* on page 17.
- Turn the power switch to the "O" position.

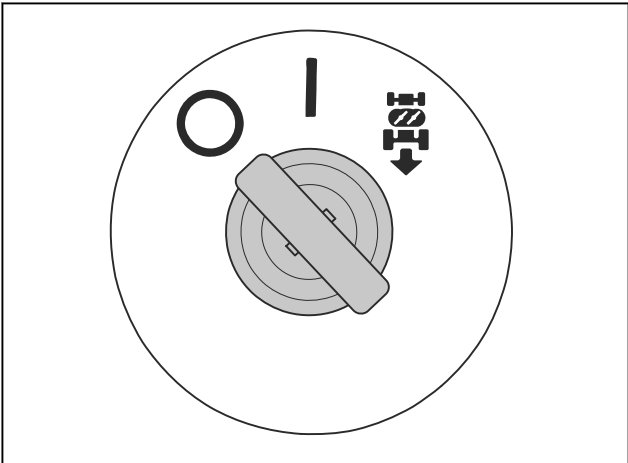

To get a good cutting result

- For best performance, do maintenance on the product regularly as given in the maintenance schedule. Refer to *Maintenance schedule* on page 19.
- Do not cut a wet lawn. Wet grass can give a bad cutting result.
- Do not use tire chains when you attach the cutting deck to the product.
- Make sure that the cutting deck is level. Refer to *To adjust the parallelism of the cutting deck* on page 25.
- If the grass is high, start with a high cutting height and decrease it gradually.
- Use the standard drive mode. If the grass is high and thick, move the product forward at low speed.
- Cut the grass in an irregular pattern.
- Use the left side of the cutting deck when you cut near trees, bushes or paths. The blade cuts approximately 15 mm in from the side of the cutting deck.
- When you cut large areas, move the product to the right during 1 or 2 turns around the work area. This procedure will keep the grass discharge away from shrubs, fences and driveways. After approximately 2 turns around the work area, cut in the opposite direction.

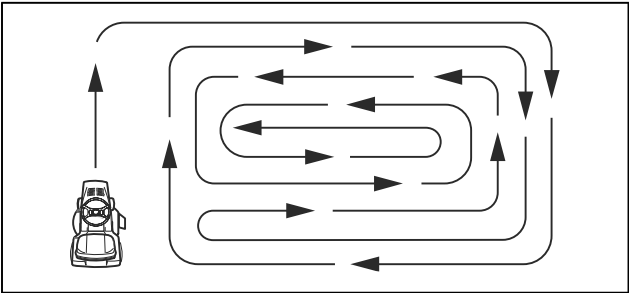

- To get the best cutting result, cut the grass frequently.

Maintenance

Introduction



WARNING: Before you do any maintenance work you must read and understand the safety chapter.

Maintenance schedule

X = The instructions are given in this operator's manual.
O = The instructions are not given in this operator's manual. Let an approved service agent do the maintenance.

Maintenance schedule	Before each use/weekly	Every 50 h or annually
Connect the product to Husqvarna Service Hub (HSH) and do an update of the firmware. Do a calibration if it is necessary.		O
Do a check of the battery status in Husqvarna Service Hub (HSH). Charge the battery to 80% if it is necessary.		O

Maintenance schedule	Before each use/weekly	Every 50 h or annually
Make sure that all fasteners are tightened correctly.		O
Lubricate the product. Refer to the lubrication schedule.		X
Lubricate the seat.		O
Make sure that the tire pressure is correct in all 4 tires.	X	X
Remove the drive wheels and apply grease to the axles.		O
Clean the cutting deck, below the covers and below the cutting deck.	X	X
Lubricate the cutting deck frame and the cutting deck presence control.		O
Lubricate the anti-scalp wheels on the cutting deck.		O
Examine the blades. Sharpen and balance the blades if it is necessary.		O
Do a check of the parallelism of the cutting deck. Adjust the parallelism if it is necessary.		X
Do a check of the PTO button.	X	X
Do a check of the operator presence control (OPC).	X	X
Do a check of the forward and rearward drive at different speeds.		O
Examine the grass catcher and the microswitches for the grass catcher (applicable for TC models only).	X	X

Lubrication schedule

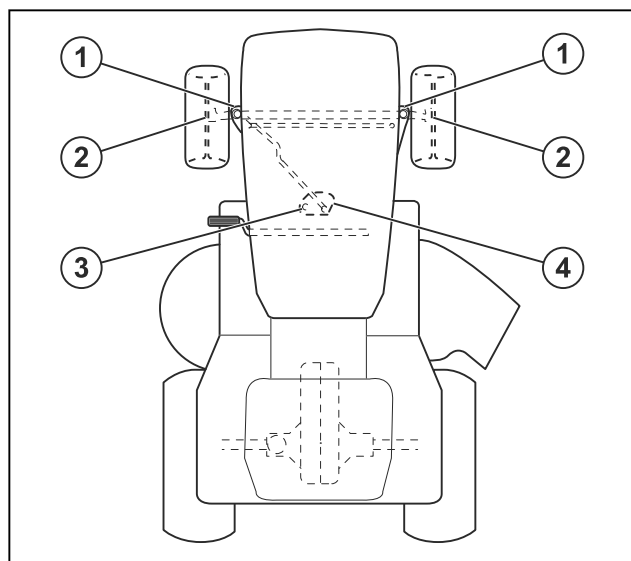

Pos.	Part	Lubrication
1	Wheel spindles	Grease
2	Bearings	Grease
3	Gear teeth on the sector gear	Grease

Pos.	Part	Lubrication
4	Gear teeth on the steering column	Grease

To clean the product



CAUTION: Do not use a high-pressure washer or a steam cleaner. Water can go into bearings and electrical connections and cause corrosion which causes damage to the product.

Clean the product immediately after use.

- Before you clean with a wet cloth, clean with a brush. Remove grass and dirt from the propulsion system.
- Clean the air intake for the cooling fan of the motor control unit for the drive motor. Refer to *To clean the air intakes on the motor control unit for the drive motor on page 21*.
- Clean the air intakes for the cooling fans of the motor control units for the cutting deck motors.
- Use a wet cloth to clean the product.
- Do not use water on electrical components or bearings. Detergent usually increases the damage.

- Make sure that the battery and battery charger are clean before you connect the battery charger to the product.
- Clean the top of the cutting deck, below the cutting deck, and below the motor covers. To clean the cutting deck, refer to *To clean the cutting deck on page 21*. To clean below the motor covers, refer to *To clean below the motor covers on the cutting deck on page 22*.
- When the product is clean, start the cutting deck for a short period to blow off remaining water.

To clean the air intakes on the motor control unit for the drive motor

Note: The motor control unit for the drive motor is found in the left rear wheel well.

1. Stop the product. Refer to *To stop the product on page 19*.
2. Make sure that the electric parking brake is engaged. Refer to *Parking brake on page 16*.
3. Remove the cover on the enclosure for the motor control unit.

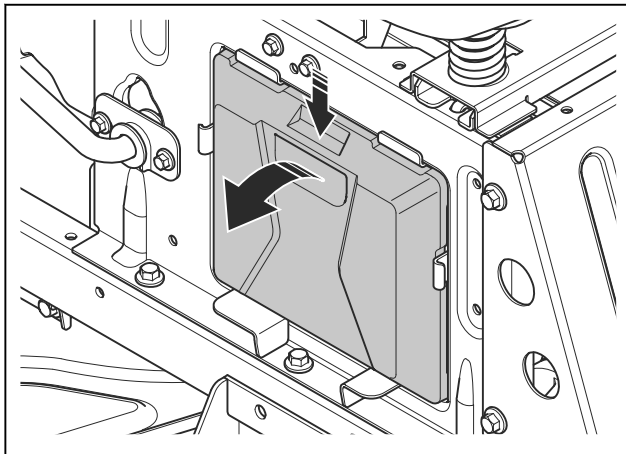

4. Clean the air intakes with compressed air or a soft brush.

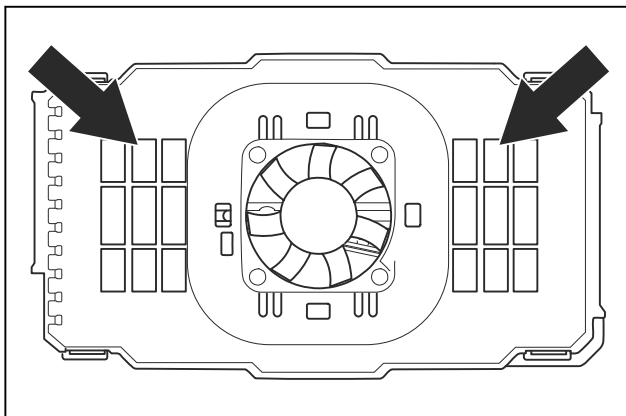

CAUTION: Do not use water or detergent. Water or detergent can cause damage to the electrical components.

To clean the cutting deck



WARNING: Do not use the product with a broken or missing deck washout port. There is a risk of thrown objects. Replace a broken or missing deck washout port immediately.

1. Park the product in a clear area on your lawn that is near a water source with a garden hose.



CAUTION: Do not point the discharge chute of the product in the direction of buildings or vehicles.

2. Make sure that the cutting deck is disengaged. Refer to *To engage and disengage the cutting deck on page 17*.
3. Stop the product. Refer to *To stop the product on page 19*.
4. Make sure that the electric parking brake is engaged. Refer to *Parking brake on page 16*.
5. Connect a garden hose (A) to the deck washout port (B) and start the water supply.

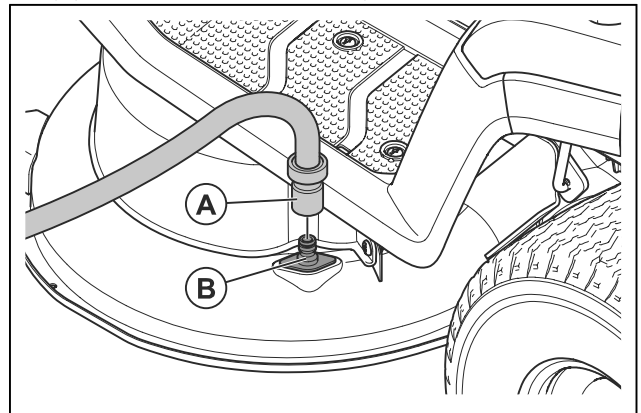

6. Sit in the seat and start the product. Refer to *To start the product on page 17*.



CAUTION: Examine the area again to make sure that the area is clear before you start the product.

7. Engage the cutting deck and let it operate at full speed until the cutting deck is clean. Refer to *To engage and disengage the cutting deck on page 17*.
8. Disengage the cutting deck and stop the product. Refer to *To engage and disengage the cutting deck on page 17* and *To stop the product on page 19*.
9. Stop the water supply and disconnect the garden hose from the deck washout port.
10. Move the product to a dry area.
11. Sit in the seat and start the product. Refer to *To start the product on page 17*.
12. Engage the cutting deck and let it operate until the cutting deck is dry.

To clean below the motor covers on the cutting deck

1. Make sure that the cutting deck is disengaged. Refer to *To engage and disengage the cutting deck on page 17*.
2. Stop the product. Refer to *To stop the product on page 19*.
3. Make sure that the electric parking brake is engaged. Refer to *Parking brake on page 16*.
4. Remove the 4 screws and the 2 motor covers from the cutting deck.

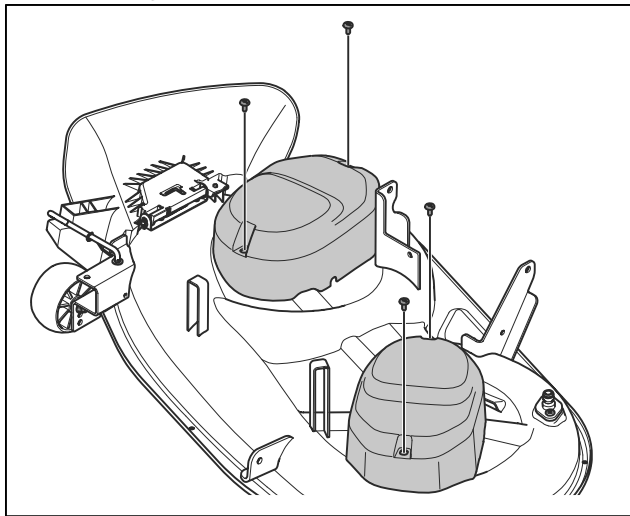

5. Clean the area adjacent to the cutting deck motors and motor control units with compressed air or a soft brush.



CAUTION: Do not use water or detergent. Water or detergent can cause damage to the electrical components.

6. Clean the air intakes on the motor control units with compressed air or a soft brush.

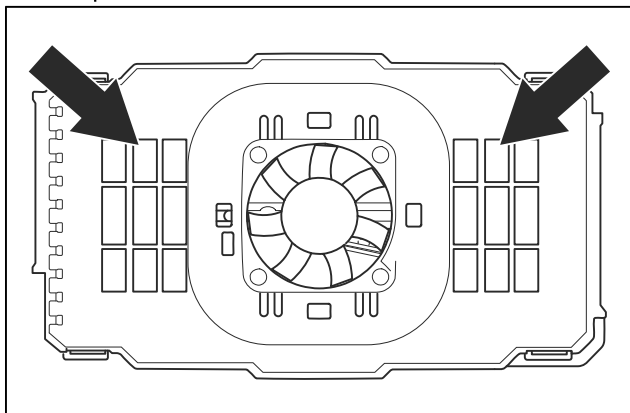

CAUTION: Do not use water or detergent. Water or detergent can cause damage to the electrical components.

To remove and install the front cover

1. Open the front cover.
2. Disconnect the headlight wire connector (A).

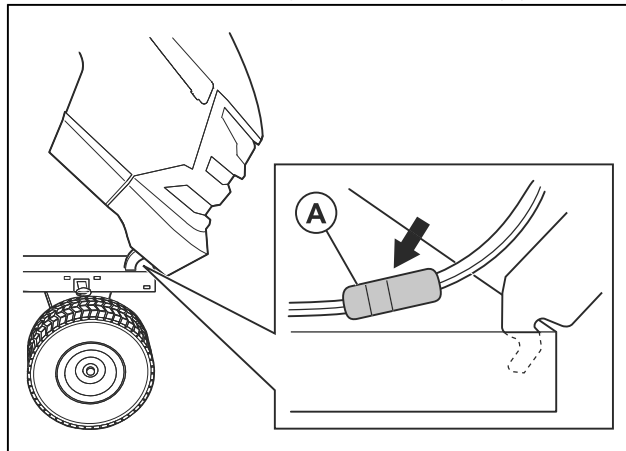

3. Tilt the front cover forward and lift it to remove it from the product.
4. Install the front cover in the opposite sequence.

To replace the LED headlight



CAUTION: Only use Husqvarna original spare parts. Wrong rating can cause damage to the product.

1. Open the front cover.
2. Turn the LED holder slightly counterclockwise and pull it out from the reflector.
3. Replace the LED in the LED holder.
4. Push the LED holder into the reflector.
5. Turn the LED holder slightly clockwise to install it.
6. Close the front cover.

To do a check of the parking brake

1. Park the product on a hard surface that slopes maximum 10°. Keep the product on.



WARNING: Do not park the product on a grass slope when you do a check of the parking brake.

Note: The parking brake is electric. The parking brake is automatically applied when the product is stationary.

2. Make sure that the parking brake symbol shows on the display and that the product does not move. If the product moves, speak to your Husqvarna servicing dealer.

To remove and install the inner dashboard cover

1. Open the front cover.
2. Remove the Husqvarna Service Hub (HSH) cable (A) from the slot in the inner dashboard cover.

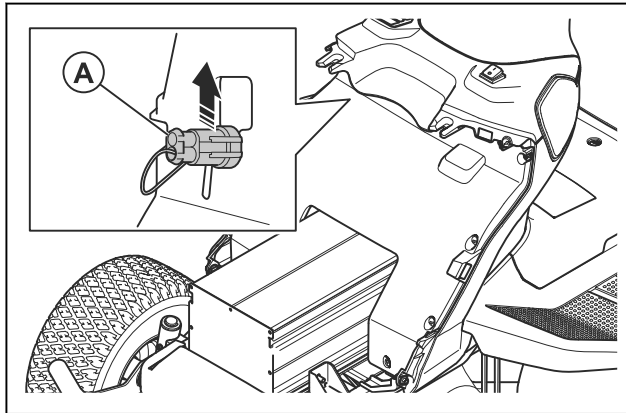

3. Remove the 6 screws (B).

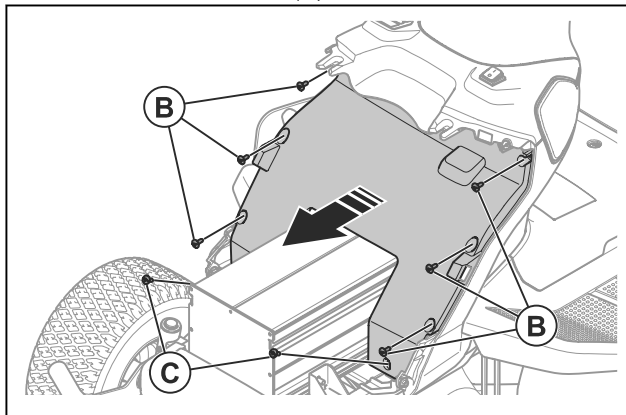

4. Remove the 2 screws (C) at the bottom of the inner dashboard cover.
5. Carefully remove the inner dashboard cover.
6. Install the inner dashboard cover in the opposite sequence.

To replace the fuse for the power control unit

A broken fuse for the power control unit is identified by a burned fuse wire.

1. Make sure that the battery charger is disconnected from the product. Refer to *To disconnect the battery charger on page 16*.
2. Set the power switch to the off (O) position and remove the power switch key.
3. Open the front cover.
4. Remove the inner dashboard cover. Refer to *To remove and install the inner dashboard cover on page 23*.

5. Push the 4 clips and remove the cover from the power control unit.

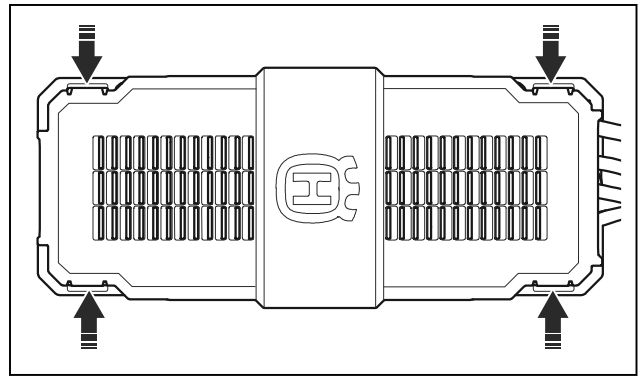

6. Pull out the fuse for the power control unit from its holder.

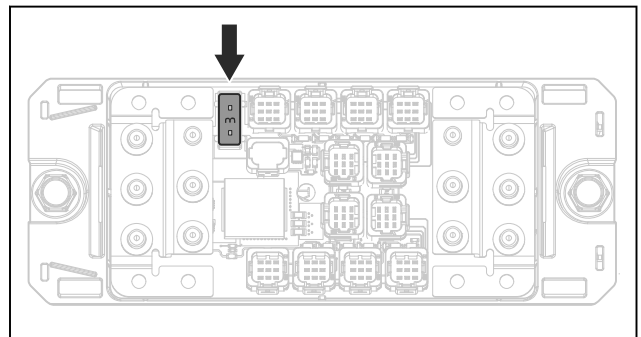

7. If the fuse is broken, replace the fuse with a new fuse of the same type. Refer to *Technical data on page 35*.

Note: If the fuse for the power control unit breaks again a short period of time after you replace it, speak to your Husqvarna servicing dealer.

Tire pressure

Make sure that the tire pressure is correct in all 4 tires. Refer to *Technical data on page 35*.

Cutting deck

To remove and install the frame tunnel cover

1. Remove the 2 screws.

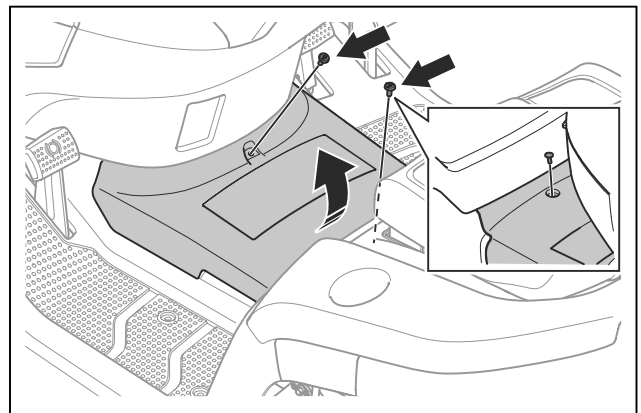

2. Carefully lift the rear edge of frame tunnel cover and remove it.
3. Install the frame tunnel cover in the opposite sequence.

To remove and install the cutting deck

1. Disengage the cutting deck and stop the product.
2. Set the power switch in the off (O) position and remove the power switch key.
3. Put the cutting deck in the lowest position.
4. Remove the frame tunnel cover. Refer to *To remove and install the frame tunnel cover on page 23*.
5. Disconnect the 2 cables from the cutting deck.

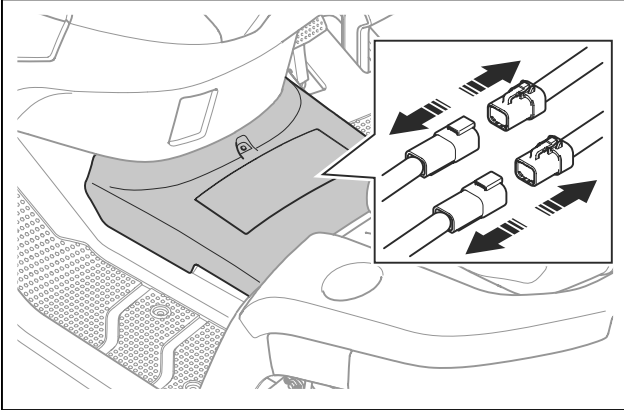

CAUTION: Make sure that the power switch is set to the off (O) position and the power switch key is removed. Risk of damage to electrical components.

6. Remove the 4 screws and the 2 motor covers from the cutting deck.

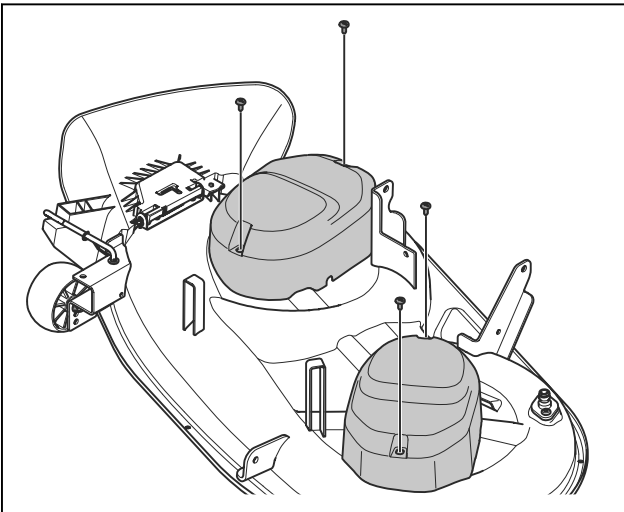

7. Do the steps that follow to disconnect the front link.

- a) Remove the clip (A) and the washer (B).

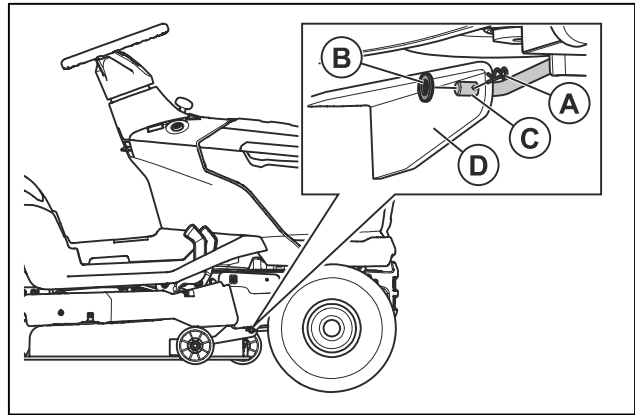

- b) Disconnect the front link (C) from the bracket (D) on the cutting deck.

8. Do the steps that follow to disconnect the 2 rear links. There is one rear link on the left side and one rear link on the right side of the product.



WARNING: The cutting deck is heavy. Use a crowbar or equivalent below the cutting deck to hold the weight of the cutting deck when you disconnect the 2 rear links.

- a) Remove the clip (E), the washer (F) and the pin (G) on the left side.

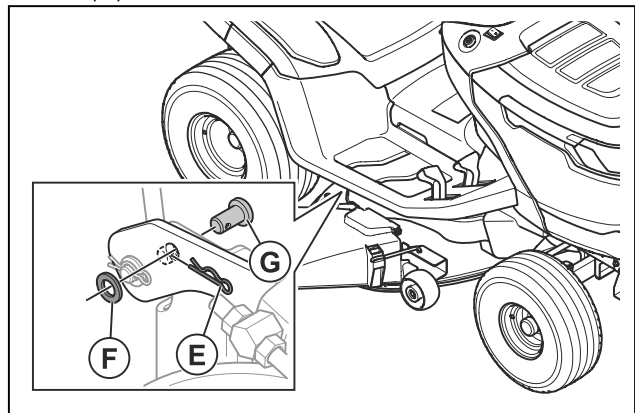

- b) Disconnect the cutting deck from the left rear link.
- c) Pull and hold the cutting height lever in the lowest position with one hand. Remove the clip, the washer, and the pin from the front of the right rear link.



WARNING: Do not release the cutting height lever. The mechanism for the cutting height adjustment is spring-loaded. The force from the spring can cause crush injury if you do not pull and hold the cutting height lever.

- d) Disconnect the cutting deck from the right rear link.
- e) Carefully release the cutting height lever.



WARNING: The mechanism for the cutting height adjustment is spring-loaded. The force from the spring can cause crush injury. Keep body parts away.

9. Move the cutting height lever to the highest position.
10. Remove the cutting deck from the product.
11. Install the cutting deck in the opposite sequence.

- a) Make sure that the brackets are in the correct position when you install the cutting deck. The bracket on the right side (A) must be on the inner side of the right rear link. The bracket on the left side (B) must be on the outer side of the left rear link.

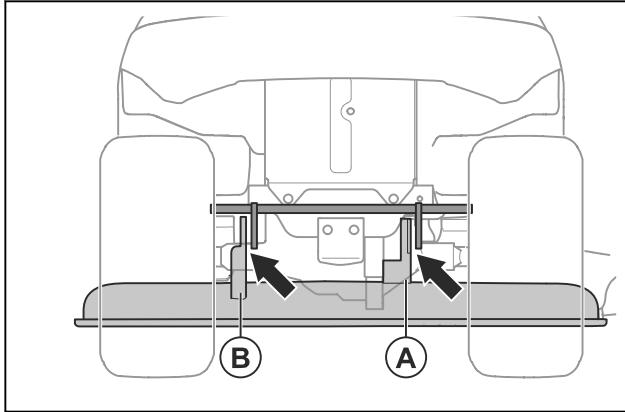

- b) Connect the 2 cables to the cutting deck.

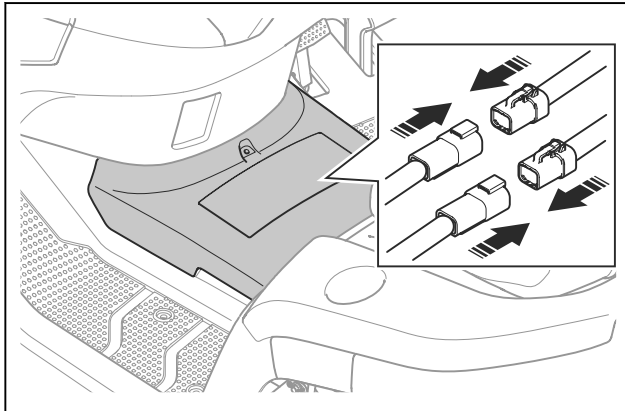

- c) Install the frame tunnel cover. Refer to *To remove and install the frame tunnel cover on page 23*.

To adjust the parallelism of the cutting deck

To do a side-to-side adjustment of the cutting deck

If the cutting height is different between the right and left side, the cutting height can be adjusted.

1. Make sure that the tire pressure is correct in all 4 tires. Refer to *Tire pressure on page 23*.
2. Park the product on a level surface.
3. Set the power switch in the off (O) position and remove the power switch key.

4. Put the cutting deck in the highest position.
5. Measure the distance (X) from the bottom edge of the cutting deck to the ground on the left and right side. The distance must be the same on the 2 sides.

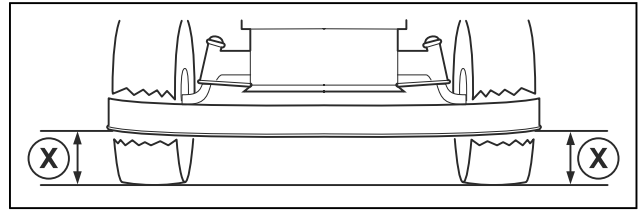

WARNING: The blades on the cutting deck are sharp and can cause injury. Use protective gloves.

6. Loosen the locknuts on the cutting height stays.

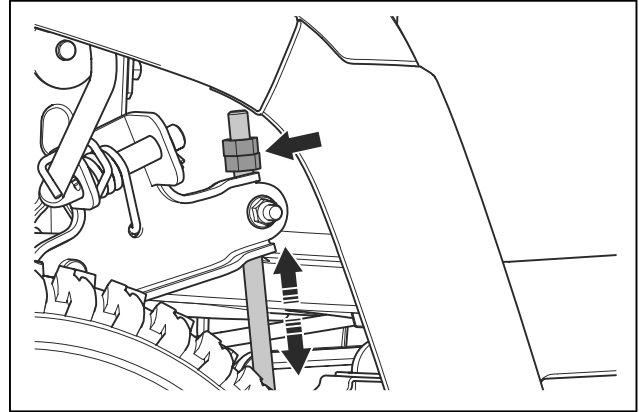

Note: The cutting height stays are behind the cutting deck, in front of the rear wheels.

7. Adjust the nuts on the cutting height stays until the cutting deck has the same cutting height on the left and right side.
 - a) Turn the nuts counterclockwise to lower the cutting deck.
 - b) Turn the nuts clockwise to lift the cutting deck.
8. Measure the distance again. Adjust until the 2 sides are equal.
9. Tighten the locknuts when the side-to-side adjustment is complete.
10. Cut some grass and examine the results. Adjust if it is necessary.

To do a front-to-rear adjustment of the cutting deck

The cutting deck must be level side to side before you do front to rear adjustment. Refer to *To do a side-to-side adjustment of the cutting deck on page 25*.

1. Make sure that the tire pressure is correct in all 4 tires. Refer to *Tire pressure on page 23*.
2. Park the product on a level surface.
3. Set the power switch in the off (O) position and remove the power switch key.
4. Put the cutting deck in the highest position.

- Measure the distance from the bottom edge of the cutting deck to the ground at the rear (A) and at the front (B). The distance at the front must be 5–10 mm lower than at the rear.

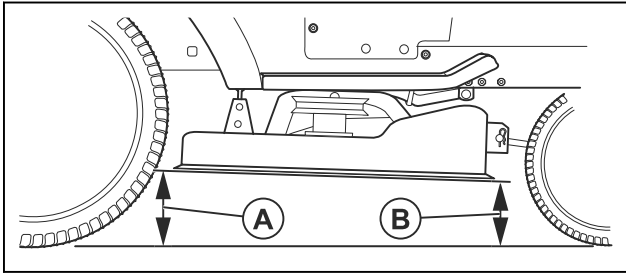

WARNING: The blades on the cutting deck are sharp and can cause injury. Use protective gloves.

- If it is necessary to make a front adjustment, loosen the locknut and turn the nut on the front link.

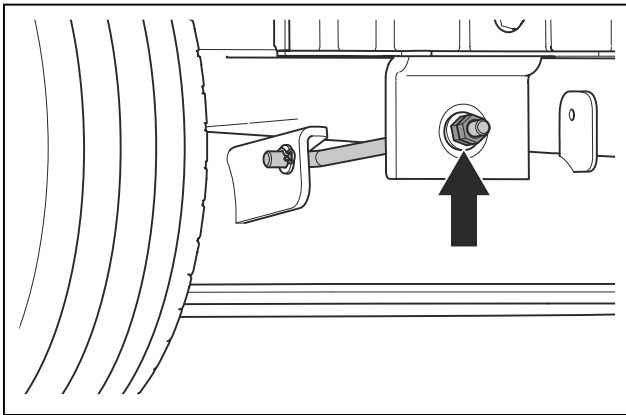

Note: The front link is in the front of the product, behind the muffler.

- Turn the nut counterclockwise to lower the front of the cutting deck.
- Turn the nut clockwise to lift the cutting deck.
- Tighten the locknut when the front adjustment is complete.

To examine the blades



CAUTION: Damaged or incorrectly balanced blades can cause damage to the product. Replace damaged blades. Let an approved service agent help you sharpen and balance blunt blades.

- Remove the cutting deck. Refer to *To remove and install the cutting deck on page 24*.
- Look at the blades to see if they are damaged and if it is necessary to sharpen them.

To replace the blades

- Remove the cutting deck. Refer to *To remove and install the cutting deck on page 24*.

- Lock the blade with a wooden block.

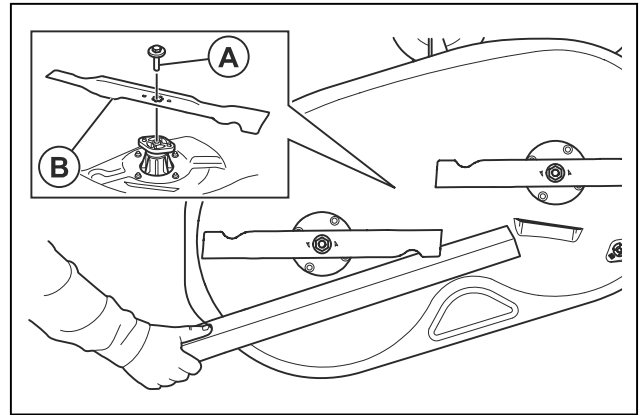

- Remove the bolt (A) and the blade (B).
- Install the new blades. Make sure that the bent ends on the blades point up.



WARNING: Incorrect blade type can cause objects to eject from the cutting deck and cause serious injury. Use only the blades given in *Technical data on page 35*.

- Tighten the bolts to 58.5–69.5 Nm.
- Install the cutting deck. Refer to *To remove and install the cutting deck on page 24*.

To adjust the anti-scalp wheels

The anti-scalp wheels keep the cutting deck in the correct position on the ground and prevent lawn scalping in most terrain conditions. The anti-scalp wheels are adjusted correctly when they are slightly off the ground when the cutting deck is at the necessary cutting height.

- Park the product on a level surface.
- Set the power switch to the off (O) position and remove the power switch key.
- Put the cutting deck in the necessary cutting height. Refer to *To set the cutting height on page 18*.
- Remove the nut (A), the bolt (B), the washer (C), the anti-scalp wheel (D), and the bushing (E).

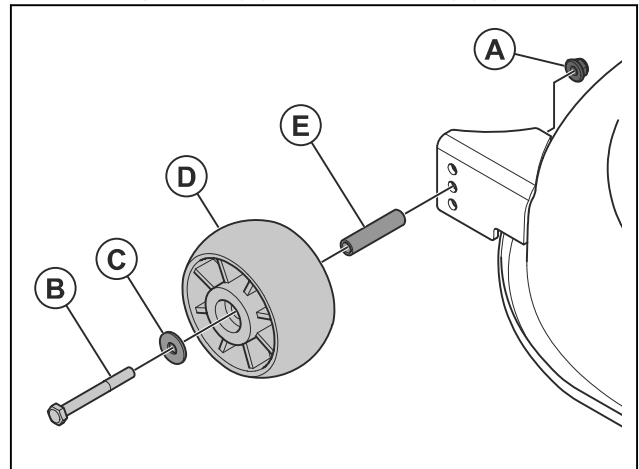

5. Install the anti-scalp wheel, the bushing, the bolt, the washer, and the nut in 1 of the 3 holes.
6. Adjust all anti-scalp wheels in the same procedure.

Troubleshooting

Troubleshooting schedule

Problem	Cause	Action
The display does not come on when the power switch is set to position "I".	The battery is empty.	Charge the battery. Refer to <i>To charge the battery on page 15</i> .
	The battery is in sleep mode.	To start the battery, push the start button for 2 seconds. If the battery does not start, it must be charged continuously until it is fully charged. The charge time is longer when the battery is in sleep mode.
	The fuse for the power control unit is broken.	Replace the fuse for the power control unit, refer to <i>To replace the fuse for the power control unit on page 23</i> . Speak to your Husqvarna servicing dealer if the problem continues.
	The display, or the cable to the display, is broken.	Speak to your Husqvarna servicing dealer.
	The power switch is broken.	
Drive mode does not start when you push the start button.	Incorrect start procedure.	Make sure that you use the correct start procedure. Refer to <i>To start the product on page 17</i> .
	The start button is pushed for less than 2 seconds.	Push the start button for 2 seconds. A display change shows that drive mode is on.
	The control panel is broken.	Speak to your Husqvarna servicing dealer.



Problem	Cause	Action
The cutting deck motors do not start.	The cutting deck is not engaged.	Engage the cutting deck. Refer to <i>To engage and disengage the cutting deck on page 17.</i>
	The cable to the cutting deck is not connected correctly.	Connect the cutting deck to the product. Refer to <i>To remove and install the cutting deck on page 24.</i>
	The cutting deck is full of grass.	Clean the cutting deck. Refer to <i>To clean the product on page 20.</i>
	The grass is too high.	Adjust the cutting height to the grass conditions.
	The temperature of the control units for the cutting deck motors is too high.	Stop the product and wait for the temperature to decrease. Restart after 20 minutes.
	The reverse operation system (ROS) is disengaged.	Engage the reverse operation system (ROS). Refer to <i>To use the reverse operation system (ROS) on page 18.</i>
	The reverse operation system (ROS) is engaged when you try to restart the cutting deck.	<ol style="list-style-type: none"> 1. Set the power switch to the on (I) position. 2. Start the drive mode. 3. Engage the reverse operation system (ROS). 4. Engage the cutting deck.
	There is an error in the cutting deck.	Disengage the cutting deck. If the problem continues, stop the product and set the power switch in the off (O) position. Wait 5 minutes before you start the product again. Speak to your Husqvarna servicing dealer if the problem continues.
		Do troubleshooting in the display. Refer to <i>LED light signals on the display on page 30.</i>
	There is no grass catcher or other accessory installed to the grass discharge (if applicable).	Make sure that a grass catcher or other accessory is installed to the grass discharge (if applicable).
	The battery is low and the blades have stopped to save power. Refer to <i>Battery indication on page 15.</i>	Charge the battery. Refer to <i>To charge the battery on page 15.</i>
	The cutting deck motors are broken.	Speak to your Husqvarna servicing dealer.
	The control units for the cutting deck motors are broken.	
	There is no power in the cable to the cutting deck.	





Problem	Cause	Action
The battery does not charge. The LEDs above the socket for the battery charger do not come on.	The battery charger is not correctly connected to the mains outlet or to the product.	Make sure that the battery charger is connected correctly. Refer to <i>To charge the battery on page 15</i> .
	The ON/OFF switch on the battery charger is set to OFF.	Set the ON/OFF switch on the battery charger to ON.
	The battery charger is broken.	Disconnect the battery charger and speak to your Husqvarna servicing dealer.
	There is an internal error.	
	The mains outlet is broken.	Put the battery charger plug into a mains outlet that has the voltage and frequency that is specified on the rating plate.
The battery does not charge. The LEDs above the socket for the battery charger flash red.	The temperature is not in the charge temperature range.	Wait until the battery temperature is in the permitted charge temperature range. Refer to <i>To charge the battery on page 15</i> . Look for warning symbols on the display. Refer to <i>LED light signals on the display on page 30</i> and <i>Warning indicator on the display on page 11</i> .
	The battery is broken.	Disconnect the battery charger and speak to your Husqvarna servicing dealer.
	There is an internal error.	
The battery does not charge. The LEDs above the socket for the battery charger show the state of charge in yellow.	The battery temperature is higher or lower than the permitted charge temperature range.	Make sure that the charger and the product is in a location that is in the permitted charge temperature range. Refer to <i>To charge the battery on page 15</i> . If the charger is connected, the charge starts automatically when the battery temperature is in the permitted charge temperature range. If the problem continues, speak to your Husqvarna servicing dealer.
There is vibration in the product when the cutting deck is engaged.	The blades are loose or damaged.	Examine the blades. Refer to <i>To examine the blades on page 26</i> . If the problem continues, speak to your Husqvarna servicing dealer.
	One or more blades are incorrectly installed or not balanced.	
	A cutting deck motor is loose.	
There is vibration in the product when the cutting deck is disengaged.	One or more wheels are loose.	Do a visual inspection. Speak to your Husqvarna servicing dealer if the problem continues.
	The product has a flat tire.	
	There are loose screws in the product.	
	The drive motor is loose.	
The product stops when you try to operate the product rearward.	The reverse operation system (ROS) is disengaged.	Engage the reverse operation system (ROS). Refer to <i>To use the reverse operation system (ROS) on page 18</i> .

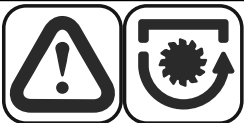

Problem	Cause	Action
The cutting result is unsatisfactory.	The blades are blunt.	Examine the blades for wear and damage. Refer to <i>To examine the blades on page 26</i> .
	The grass is long or wet.	Refer to <i>To get a good cutting result on page 19</i> .
	The cutting deck is not parallel to the ground.	Adjust the parallelism of the cutting deck. Refer to <i>To adjust the parallelism of the cutting deck on page 25</i> .
	There is grass blockage in the cutting deck.	Clean the cutting deck. Refer to <i>To clean the product on page 20</i> .
	There is grass blockage in the center chute (if applicable).	Remove the grass blockage in the center chute.
	The air holes in the cutting deck are clogged.	Clean the cutting deck. Refer to <i>To clean the cutting deck on page 21</i> .
	The tire pressure is different on the right and left sides.	Make sure that the tire pressure is correct in all tires. Refer to <i>Technical data on page 35</i> .
	The product is operated at too high speed.	Refer to <i>To get a good cutting result on page 19</i> .
	The motor speed is too low.	Refer to <i>To get a good cutting result on page 19</i> .

LED light signals on the display

The LED lights on the display will give signals if there is a fault or if the operation conditions are not obeyed. Refer to *Operation conditions on page 10*.

Symbol	Name	Shows on the display	Cause/action
	Operator presence control (OPC)	The symbol shows.	Start is prevented because the operator is lifted from the seat.
		The symbol flashes.	The operator is lifted from the seat during drive mode.
	Indicator for the electric parking brake	The symbol shows.	The electric parking brake is engaged.
		The symbol flashes.	The electric parking brake is disengaged. Start is prevented. Refer to <i>To start the product on page 17</i> .
	Blades engaged indicator	The symbol shows.	The cutting deck is engaged.
		The symbol flashes for a few seconds.	The cutting deck is engaged. Start is prevented. Refer to <i>To start the product on page 17</i> .

Symbol	Name	Shows on the display	Cause/action
	Warning indicator	The symbol shows.	There is a critical error in the product. Stop the product and set the power switch in the off (O) position. Wait for 5 minutes before you start the product again. Speak to your Husqvarna servicing dealer if the problem continues.
		The symbol flashes.	There is an error in the product. Refer to the combination of symbols on the display for more information.
	Blade engagement error	The symbols flash.	The temperature of the cutting deck motor or the control unit for the cutting deck motor is too high. Disengage the cutting deck and wait for the temperature to decrease. Speak to your Husqvarna servicing dealer if the problem continues.
			There is an error in the cutting deck motor or the control unit for the cutting deck motor. Disengage the cutting deck. If the problem continues, stop the product and wait for 5 minutes before you start the product again. Speak to your Husqvarna servicing dealer if the problem continues.
	Standby indicator	The symbol shows.	The product is in drive mode.
		The symbol flashes.	The product is in idle mode.
	Standby error	The symbols flash.	Start is prevented because the forward pedal or rearward pedal is pushed down. Refer to <i>To start the product on page 17</i> .
	Battery level indicator	The 4 LEDs flash sequentially.	The battery is charging. Start is prevented because the charger is connected. Refer to <i>To start the product on page 17</i> .

Symbol	Name	Shows on the display	Cause/action
 	Battery warning	LED 1 on the battery level indicator and the warning indicator flash.	The battery is empty. Charge the battery. Refer to <i>To charge the battery on page 15</i> .
		LED 1 and 4 on the battery level indicator and the warning indicator flash.	The battery temperature is higher than recommended. Stop the product and set the power switch in the off (O) position. Wait for the battery temperature to decrease before you start the product again. Speak to your Husqvarna servicing dealer if the problem continues.

Transportation, storage and disposal

Transportation

- The product is heavy and can cause crush injuries. Be careful when you load it onto or off a vehicle or trailer.
- Use an approved trailer for transportation of the product.
- Make sure that you have knowledge of local road traffic regulations before transportation of the product in a trailer or on roads.
- To make it easier to load the product onto a trailer, put the cutting deck in the highest position.

To tow the product

To move the product with the power off, the electric parking brake system must be disengaged.

- Disengage the electric parking brake system. Refer to *To move the product manually on page 17*.
- Tow the product at low speed and short distances only.

To safely attach the product for transportation



WARNING: Before you attach the product, you must read and understand the safety chapter. Refer to *Safety on page 6*.



WARNING: The parking brake is not sufficient to lock the product during transportation. Attach the product tightly to the load area.

Equipment: 2 approved straps and 4 chocks.

- Park the product in the center of the load area.

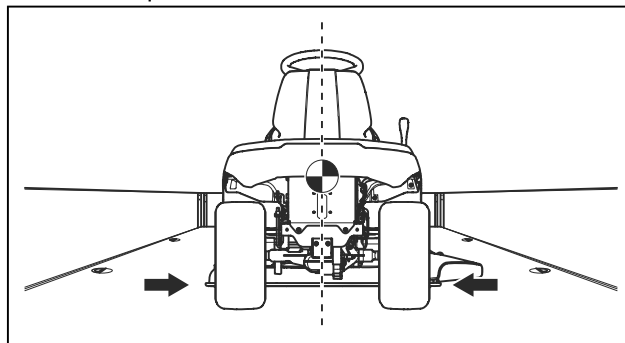

CAUTION: For transportation in transport vehicles with a cover, let the product become cool before you put it below the cover.

- Make sure that the center of gravity of the product is above the wheel axle of the transport vehicle. If a trailer is used for transportation, make sure that the vertical force on the tow bar is correct.

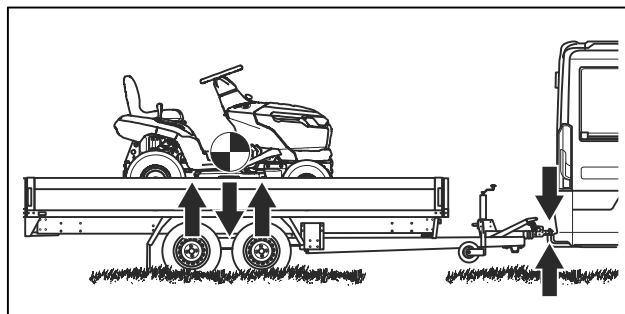

- Apply the parking brake.
- Remove all loose objects.

5. Attach the first strap to the tow bar.

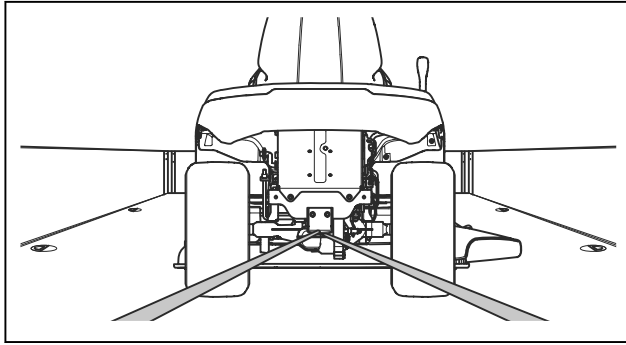

6. Tighten the strap rearward to attach the product to the load area.

7. Put the second strap around the front axle.

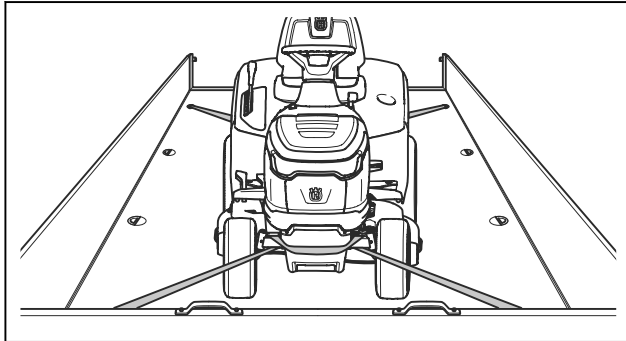

8. Attach the strap to the load area.
9. Tighten the strap in the direction of the front of the load area to attach the product to the load area.
10. Put the chocks in front of and behind the rear wheels.

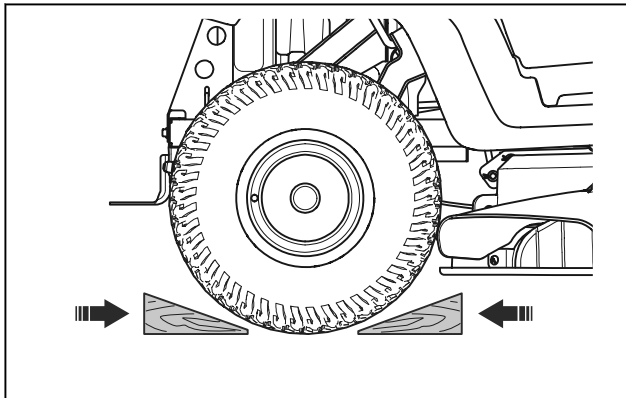

Transportation of batteries

- The supplied 48 V batteries obey the requirements of the Dangerous Goods Legislation.
- Obey the special requirement for packaging and labels for commercial transportation by third parties and forwarding agents.
- Speak to a person with special training in dangerous material before you send the product. Obey all applicable national regulations.
- Use tape on open contacts when you put the battery in a package. Put the battery in a tight package to prevent movement.

Storage

Prepare the product for storage at the end of the season and before more than 30 days of storage.



WARNING: Remove grass, leaves and other flammable materials from the product to decrease the risk of fire. Let the product become cool before you put it in storage.

- Set the power switch to the off (O) position.
- Clean the product, refer to *To clean the product on page 20*. Fill in paint damages to prevent corrosion.
- Examine the product for worn or damaged parts and tighten loose screws and nuts.
- Fully charge the battery before storage. Make sure that the charge of the batteries is 50 % or more during storage.

Note: The battery can go into sleep mode when the product is in storage or the state of charge is very low. To start the battery the start button must be pushed for 2 seconds. If the battery does not start, it must be charged continuously until it is fully charged. The charging time is longer when the battery is in sleep mode.

- Lubricate all grease nipples, joints and axles.
- Keep the product in a clean and dry area. Put a protective cover on the product.

Note: A protective cover for protection of your product during storage or transport is available at your dealer.

- Keep the product in a locked area to prevent access for children or persons that are not approved.
- Keep the product and the power supply in a dry and frost-free area.
- If you will use the product, keep the product in storage where the ambient temperature is between 0 °C/32 °F and 50°C/122 °F. If you will not use the product, you can keep the product in storage where the ambient temperature is between -20 °C/-4 °F and 50°C/122 °F.
- Keep the product out of sunlight.
- Do not keep the product in areas where static electricity can occur.

Disposal of the battery and battery charger

Symbols on the product or its packaging indicate that this product cannot be handled as domestic waste. It must instead be submitted to an appropriate recycling station for the recovery of electrical and electronic equipment.

By ensuring that this product is taken care of correctly, you can help to counteract the potential negative impact on the environment and people that can otherwise

result through the incorrect waste management of this product. For more detailed information about recycling this product, contact your municipality, your domestic waste service or the shop from where you purchased the product.

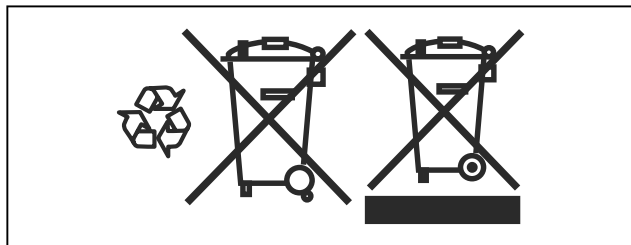

Disposal

- Chemicals can be dangerous and must not be discarded on the ground. Always discard used chemicals at a service center or an applicable disposal location.
- When the product is worn out, send it to the dealer or to an applicable recycling location.
- Oil and the battery can have negative effects on the environment. Obey the local recycling requirements and applicable regulations.
- Do not discard the battery as domestic waste.
- Send the battery to a Husqvarna service agent or discard it at a disposal location for used batteries.

Technical data

Technical data

Dimensions	
Width, excl. cutting deck, mm	916
Width, incl. cutting deck, mm	990
Height, mm	1100
Length, mm	1680
Weight, incl. cutting deck and battery, kg	161
Wheel base, mm	1152
Track width, front, mm	730
Track width, rear, mm	700
Tire pressure, front, kPa/bar/PSI	150/1.5/21.76
Tire pressure, rear, kPa/bar/PSI	100/1/14.5
Front tires	15×6-6
Rear tires	18×8.5-8
Max. gradient, degrees °	10
Max. tow equipment weight, at 10° gradient, kg	100
Max. permitted vertical load on the tow bar, N/kg	250/25
Max. permitted horizontal load on the tow bar, N/kg	250/25
Drive motor	
Motor type	Brushless DC motor
Voltage, V	48
Nominal motor output, kW	1.5
Max. motor speed, rpm	3500
Transmission	
Brand	LINIX
Grease volume, l	0.12
Max. forward speed, km/h	10
Max. reverse speed, km/h	6
Electrical system	
Type	48 V. DC, negative earthed
Main fuse, A	80
Cutting deck fuse, A	80
Fuse for the power control unit, A / V	3 / 58

Lamp type	12V, 18W
Cutting deck	
Cutting width, mm	950
Cutting deck motor output, kW	3×0.9
Cutting height, 6 positions, mm	25–100
Noise emissions ¹	
Sound power level, measured dB(A)	98
Sound power level, guaranteed dB(A)	100
Sound levels ²	
Sound pressure level at the operators ear, dB(A)	83
Vibration levels ³	
Vibration level on the steering wheel, m/s ²	1.2
Vibration level in the seat, m/s ²	2.0
Blades	
Blade length, mm	483
Article number	537 67 42-08
Article number, mulch kit (accessory) ⁴	547 55 55-01
Article number, mulch blade (accessory) ⁵	537 67 43-08



WARNING: Use only the cutting decks that are specified in this manual. Cutting decks that are not approved for this product can cause objects to eject at high speed and cause serious injury.

Control points	
Parallelism cutting deck with cutting height in position 1	5–10 mm / 0.197–0.394 in.
Control of cutting height in position 1	25 ± 2 mm / 0.98 ± 0.079 in.

Approved batteries

Only use original batteries for this product.

Battery	EM-5240Li
Article number	598 84 43-01

¹ Noise emissions in the environment measured as sound power (L_{WA}) in conformity with EC directive 2000/14/EC.

² Noise pressure level according to EN ISO 5395. Reported data for noise pressure level has a typical statistical dispersion (standard deviation) of 3.0 dB(A).

³ Vibration level according to EN ISO 5395. Reported data for vibration level has a typical statistical dispersion (standard deviation) of 1.5 m/s² (steering wheel) and 1.5 m/s² (seat).

⁴ The mulch kit includes blades, mulch plate, and parts for assembly.

⁵ Use the blades only with the complete mulch kit parts in mulch kit 547 55 55-01.

Battery	EM-5240Li
Type	Lithium-ion
Battery capacity, Ah	38.5
Nominal voltage, V	50.4
Weight, kg/lbs	17/38

Approved battery chargers

Battery charger	PS300C (included)	PS900C (optional)
Input voltage, V	220–240	220–240
Input current, A	1.8	4.5
Frequency, Hz	50	50
Power, W	300	900
Output voltage, V	58	58
Output current, A	5.3	15.5

Service

Do a yearly check at an authorized service center to make sure that the product functions safely and at its best during high season. The best time to do a servicing or overhaul of the product is low season.

When you send an order for the spare parts, give information about the purchase year, model, type, and serial number.

Always use original spare parts.

Declaration of Conformity

EU Declaration of Conformity

We, Husqvarna AB, SE 561 82 Huskvarna, SWEDEN,
Tel. +46 36 146500 declare on our sole responsibility
that the product:

Description	Ride-on lawn mower
Brand	Husqvarna
Type / Model	TS 100i
Identification	Serial number dating 2023 and onwards

complies fully with the following EU directives and
regulations:

Directive/Regulation	Description
2006/42/EC	"relating to machinery"
2014/30/EU	"relating to electromagnetic compatibility"
2000/14/EC	"relating to the noise emissions in the environment"
2011/65/EU	"on the restriction of the use of certain hazardous substances in electrical and electronic equipment"

and that the following standards and/or
technical specifications are applied; EN ISO
12100:2010, EN ISO 5395-1:2013+A1:2018,
EN ISO 5395-3:2013+A1:2017+A2:2018, EN
62841-1:2015/AC:2015/A11:2022, EN ISO
14982:2009, EN 61000-6-2:2005, EN
61000-6-3:2007+A1:2011+AC:2012, EN 50665:2017,
EN IEC 63000:2018.



Notified body: 0197, TÜV Rheinland LGA Products
GmbH, Tillystrasse 2, 90431 Nürnberg, Germany
has certified conformity with the council's directive
2000/14/EC, conformity assessment procedure: Annex
VI.

For more information relating to noise emissions, refer to
Technical data on page 35.

Huskvarna, 2024-01-30

A handwritten signature in black ink, appearing to read 'Claes Losdal'.

Claes Losdal, Development Manager/Garden Products,
Husqvarna AB

Responsible for technical documentation

UK Declaration of Conformity

We, Husqvarna AB, SE-561 82 Huskvarna, Sweden, tel:
+46-36-146500, declare on our sole responsibility that
the product:

Description	Ride-on lawn mower
Brand	Husqvarna
Type / Model	TS 100i
Identification	Serial numbers dating from 2023 and onwards

complies fully with the following UK regulations:

Description
The Supply of Machinery (Safety) Regulations 2008
Electromagnetic Compatibility Regulations 2016
The Noise Emission in the Environment by Equipment for use Outdoors Regulations 2001, schedule 9
The Restriction of the Use of Certain Hazardous Substances in Electrical and Electronic Equipment Regulations 2012

and that the following standards and/or
technical specifications are applied: EN ISO
12100:2010, EN ISO 5395-1:2013+A1:2018,
EN ISO 5395-3:2013+A1:2017+A2:2018, EN
62841-1:2015/AC:2015/A11:2022, EN ISO
14982:2009, EN 61000-6-2:2005, EN
61000-6-3:2007+A1:2011+AC:2012, EN 50665:2017,
EN IEC 63000:2018.

UK Importer:
Husqvarna UK Ltd
Preston Road, Co. Durham
DL5 6UP

Approved Body: AnP Certification Limited, 2 Parkfield
Street, Rusholme, Manchester, M14 4PN, UK, has
carried out certified conformity according to the Outdoor
Noise Regulations of 2001, conformity assessment
procedure: Schedule 9.

For more information relating to noise emissions, refer to
Technical data on page 35.

Huskvarna, 2024-01-30



Claes Losdal, Development Manager/Garden Products,
Husqvarna AB

Responsible for technical documentation

**UK
CA**