



Husqvarna®



590BTS



EN	Operator's manual	9-20
SV	Bruksanvisning	21-32
DA	Brugsanvisning	33-45
FI	Käyttöohje	46-58
NO	Bruksanvisning	59-70
FR	Manuel d'utilisation	71-85
NL	Gebruiksaanwijzing	86-98
IT	Manuale dell'operatore	99-112
ES	Manual de usuario	113-126
DE	Bedienungsanweisung	127-140
UK	Посібник користувача	141-155
RU	Руководство по эксплуатации	156-170
HU	Használati utasítás	171-184
PT	Manual do utilizador	185-198
BG	Ръководство за експлоатация	199-213
PL	Instrukcja obsługi	214-227
RO	Instrucțiuni de utilizare	228-240
ET	Kasutusjuhend	241-253
LV	Lietošanas pamācība	254-267
LT	Operatoriaus vadovas	268-280
SK	Návod na obsluhu	281-293
EL	Οδηγίες χρήσης	294-308
TR	Kullanım kılavuzu	309-321
JA	取扱説明書	322-334
KO	사용자 설명서	335-346
HR	Priručnik za korištenje	347-359
SR	Priručnik za rukovaoca	360-372
SL	Navodila za uporabo	373-385
BS	Korisnički priručnik	386-398
CS	Návod k použití	399-411

590BTS

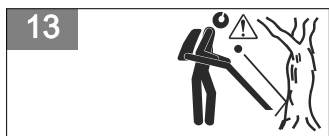
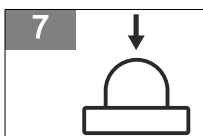
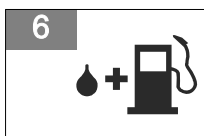
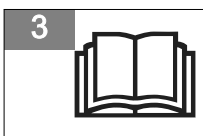
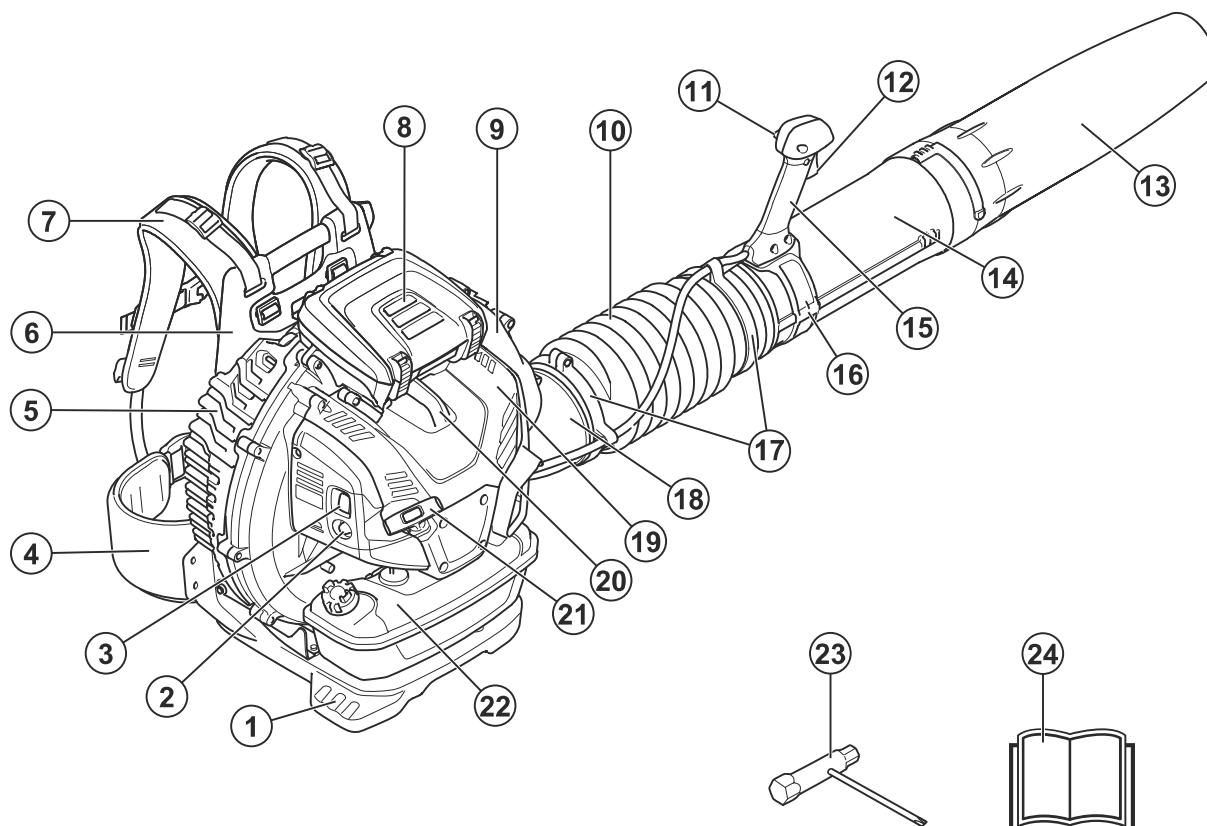

15

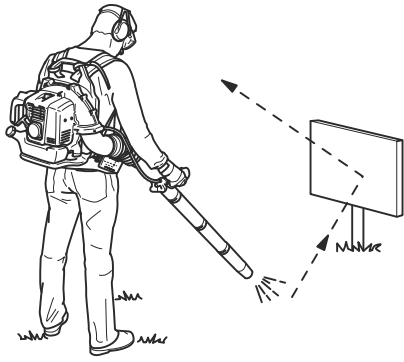

16



17



18

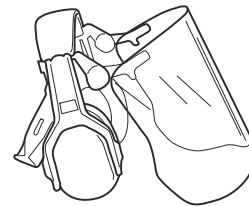

19

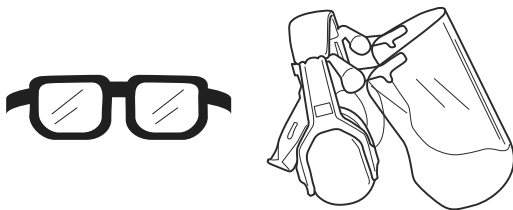

20

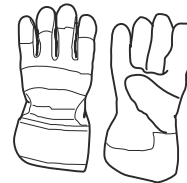

21



22

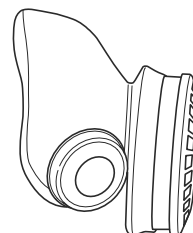

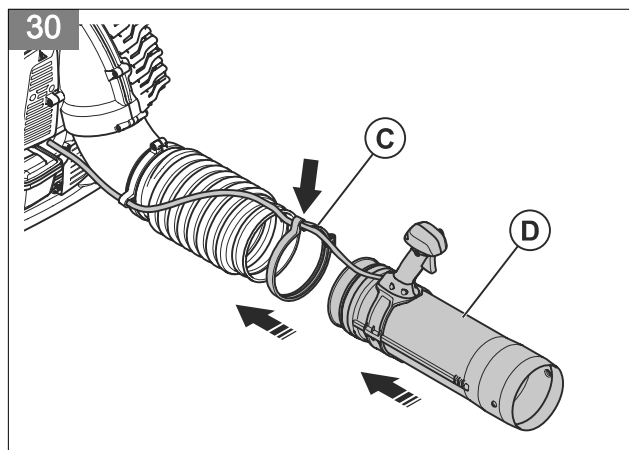
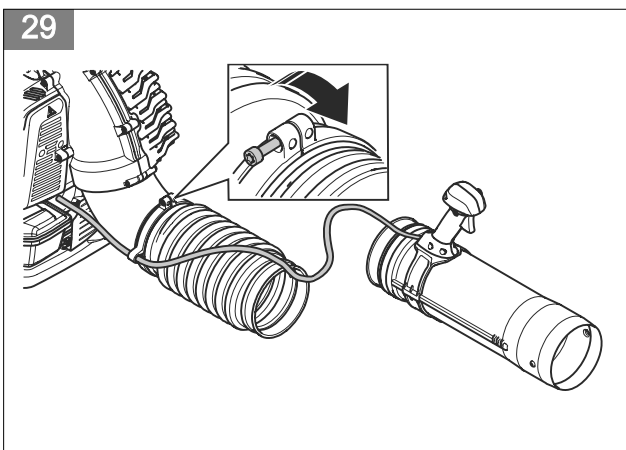
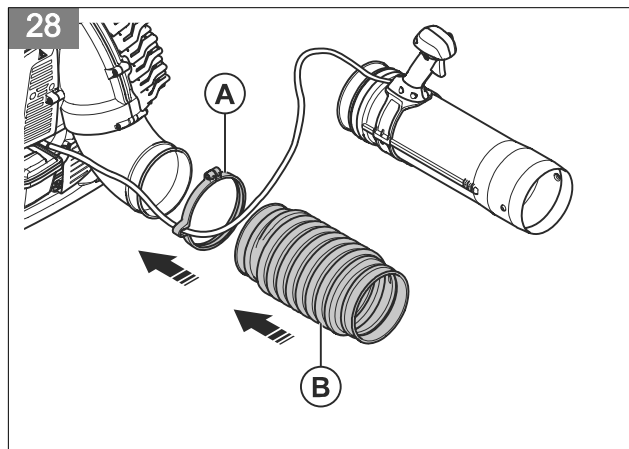
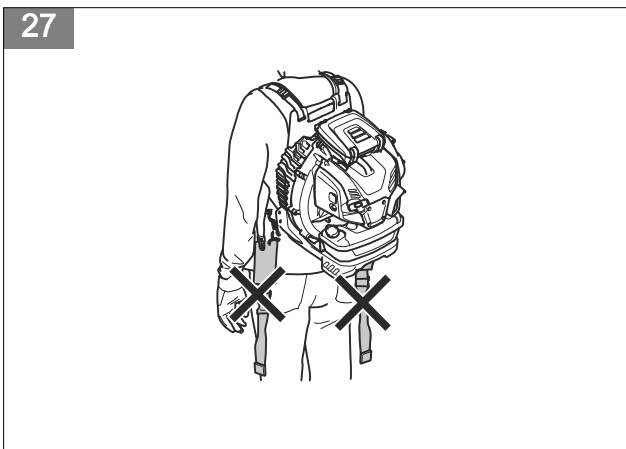
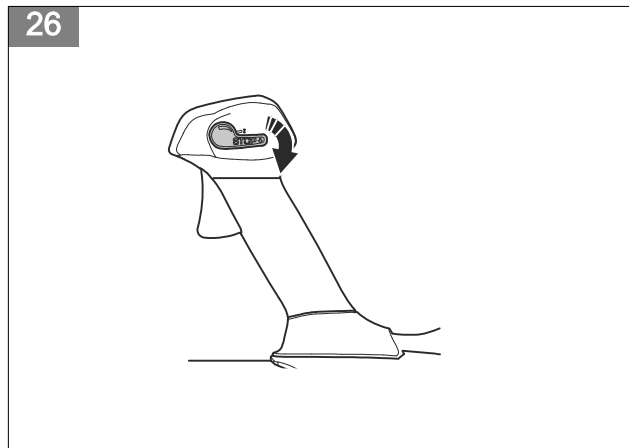
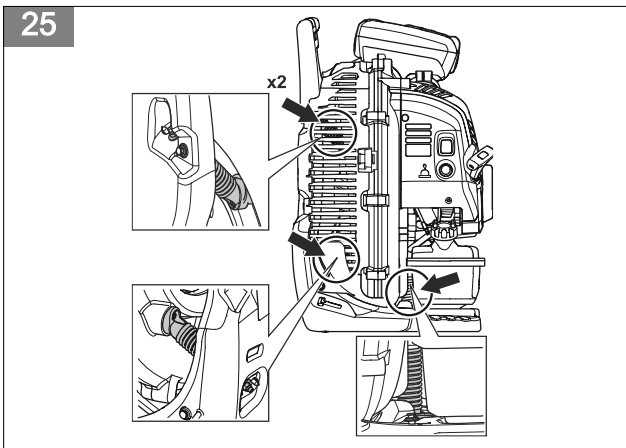
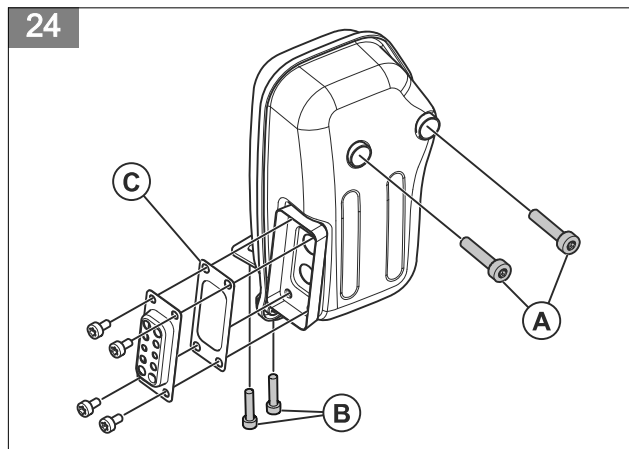
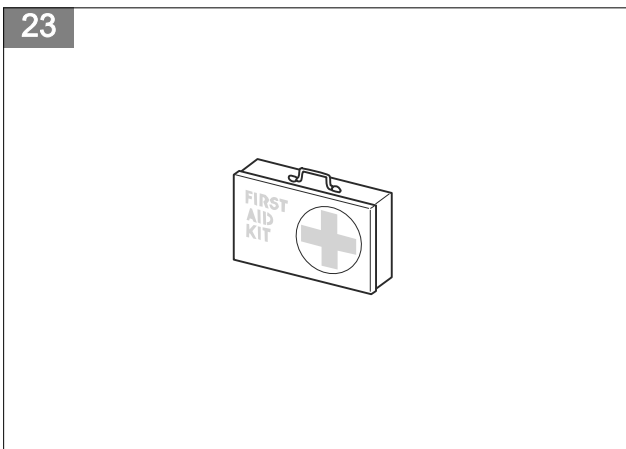

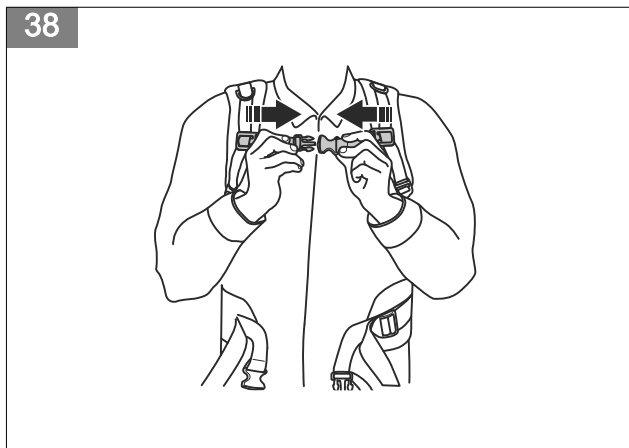
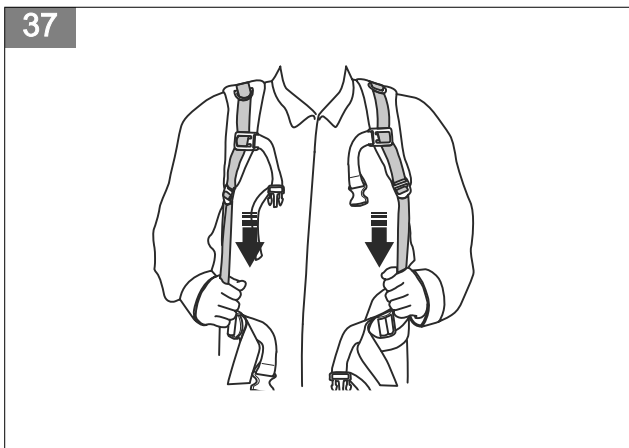
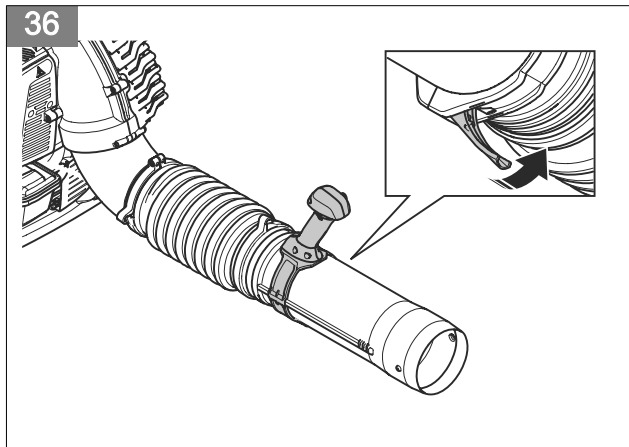
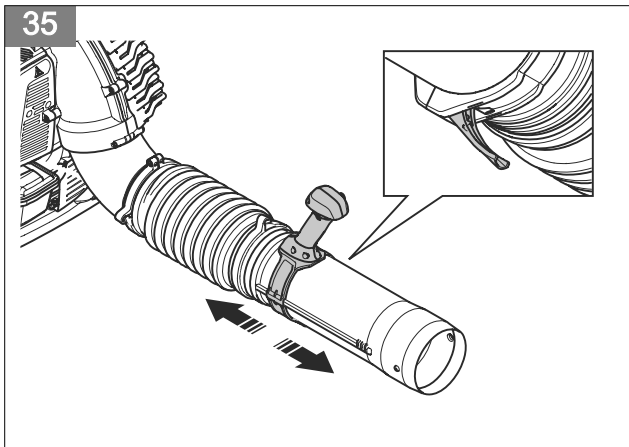
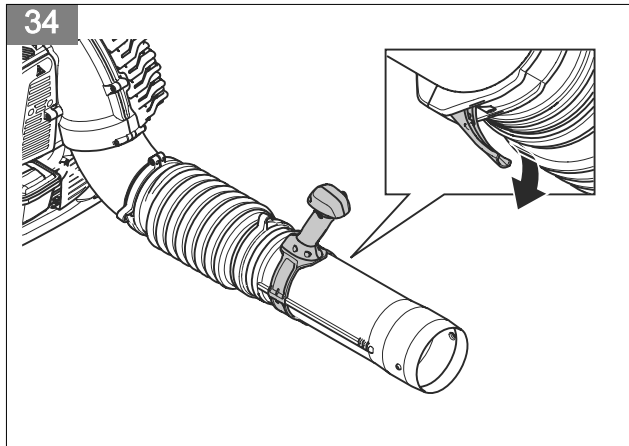
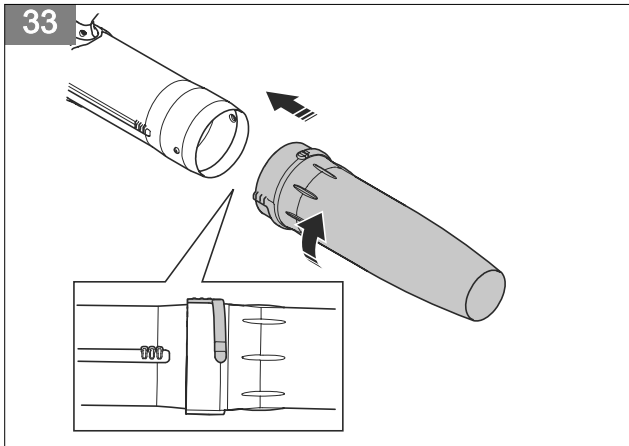
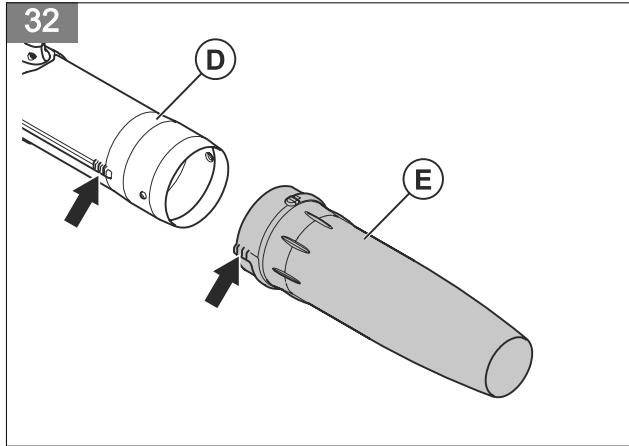
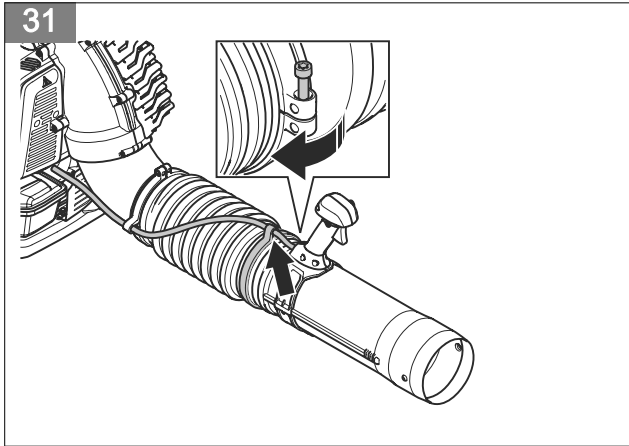

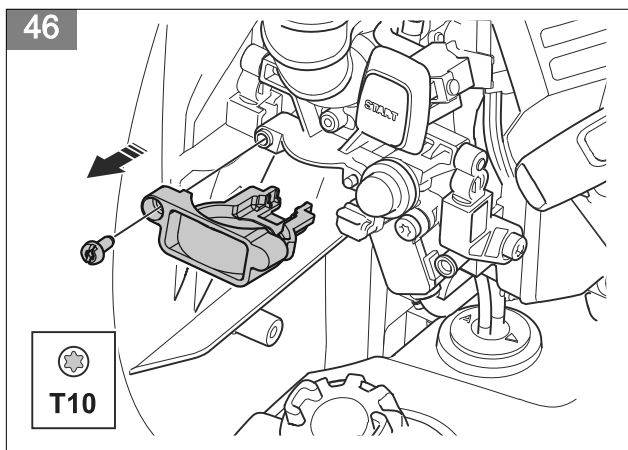
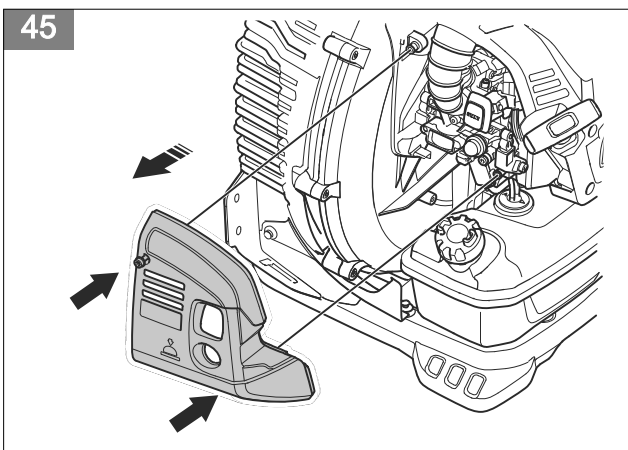
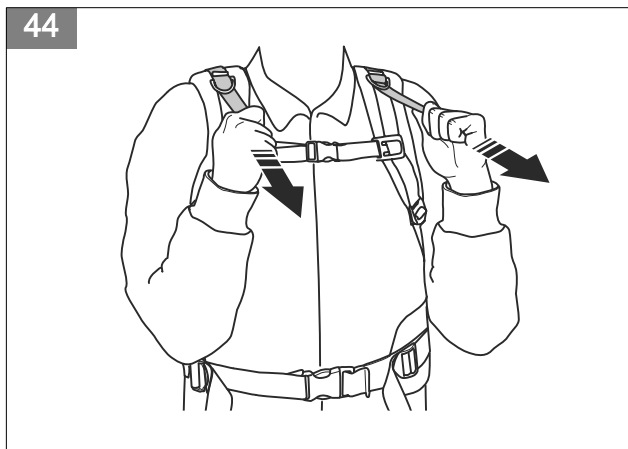
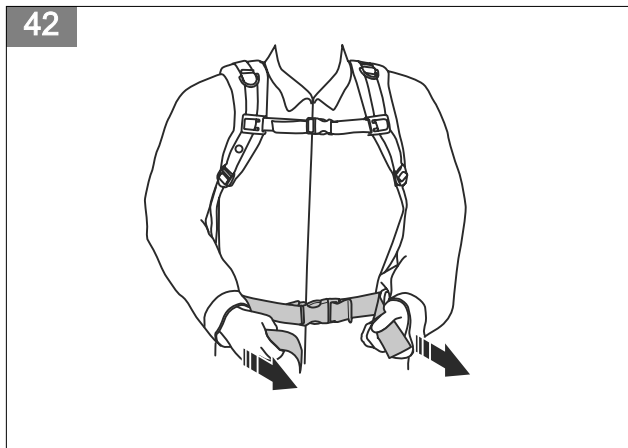
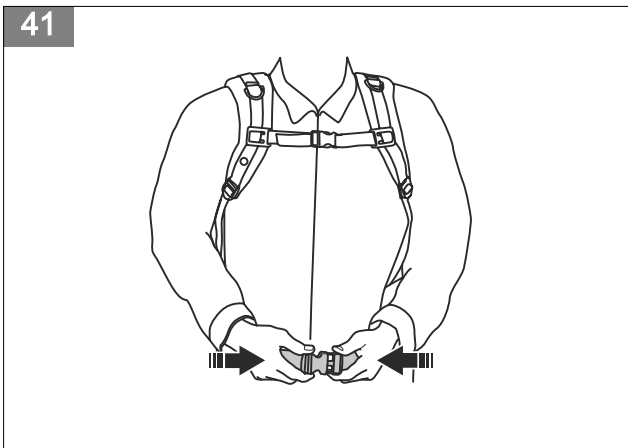
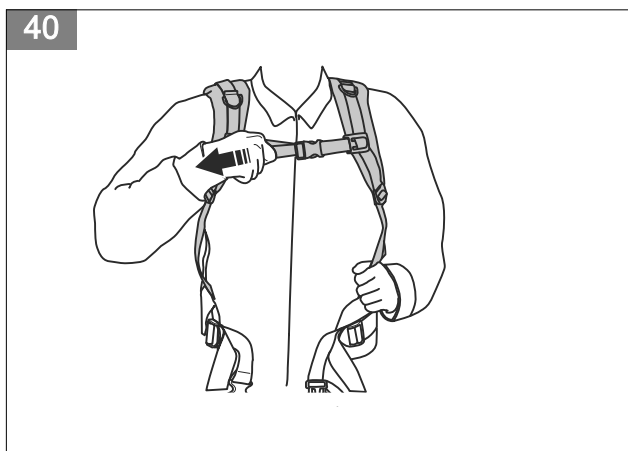
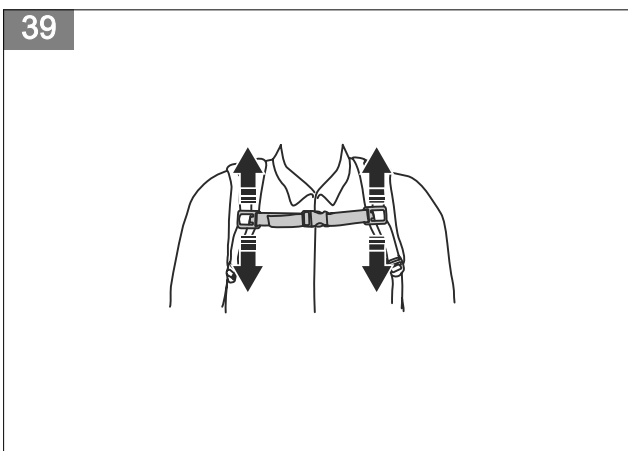

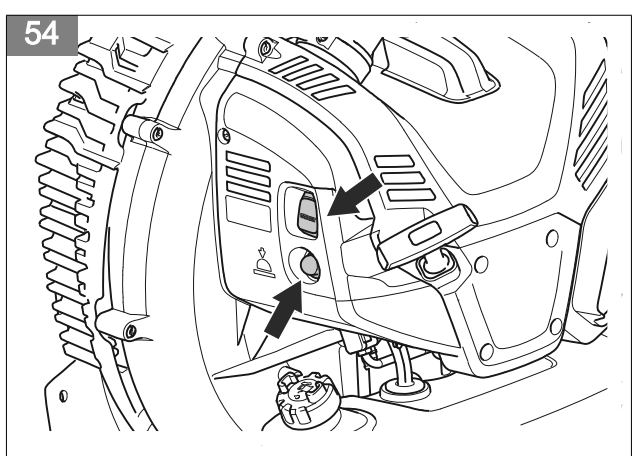
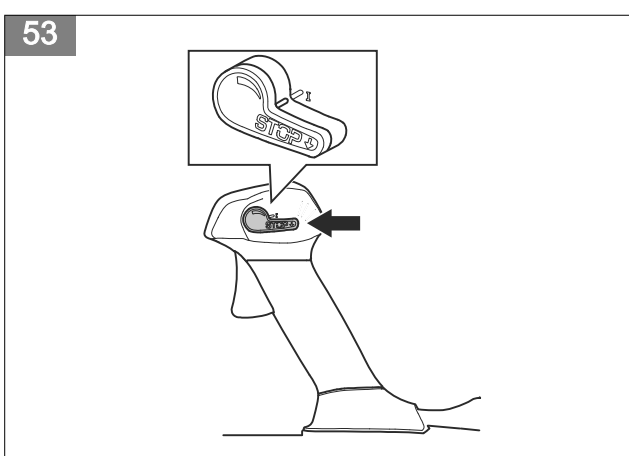
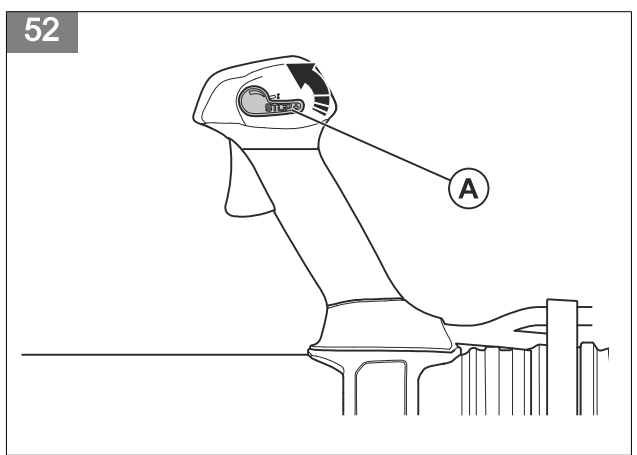
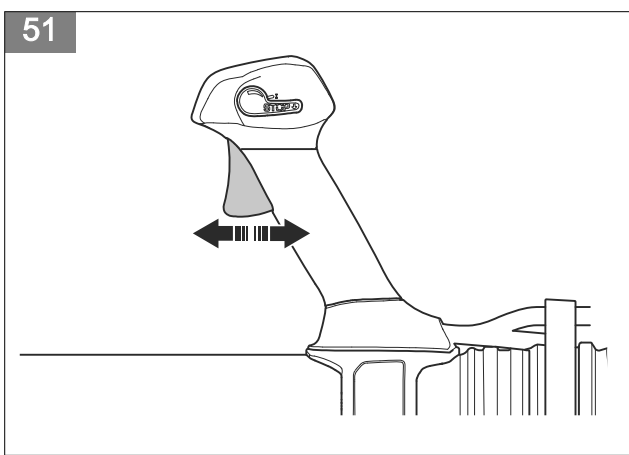
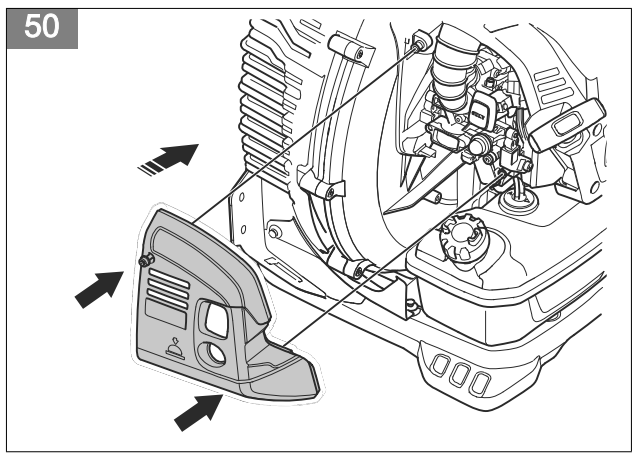
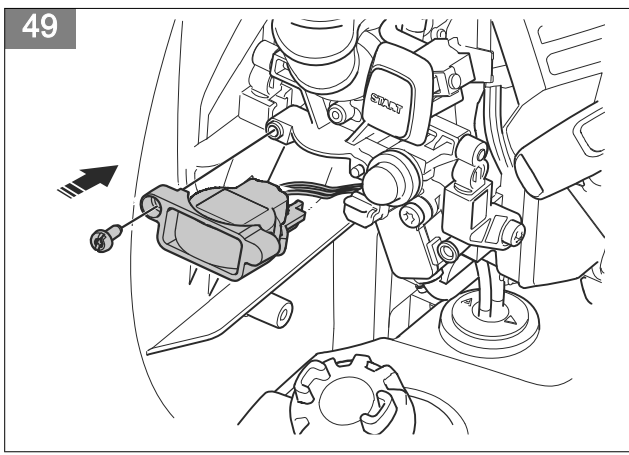
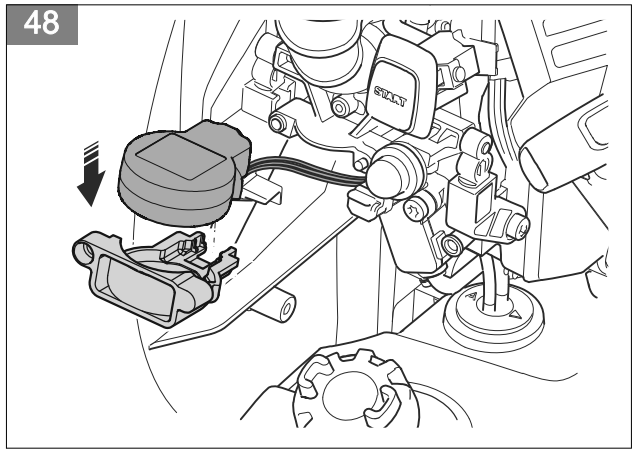
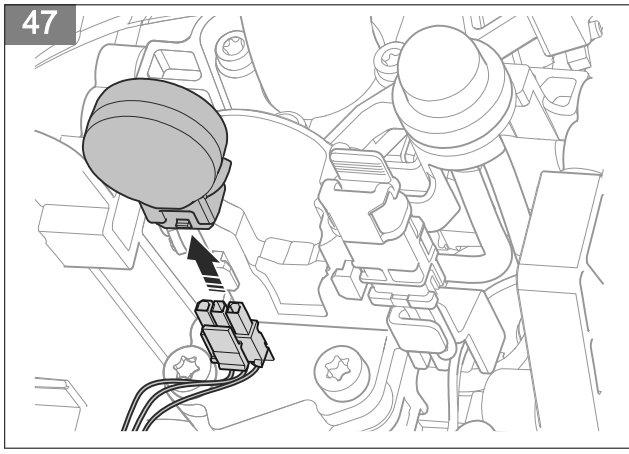

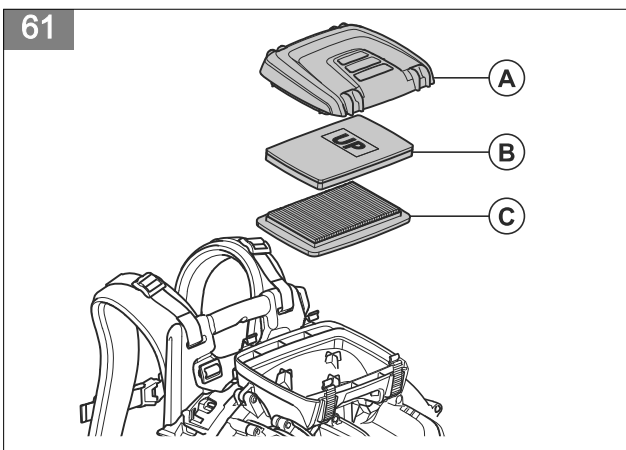
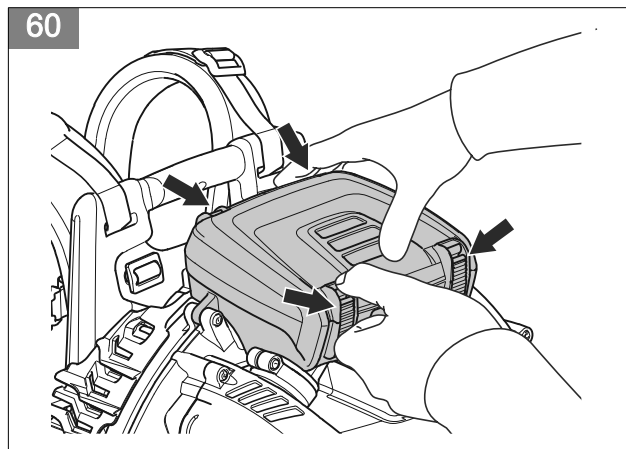
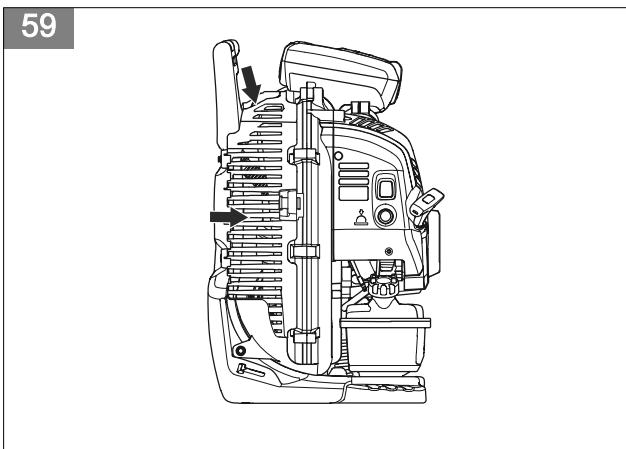
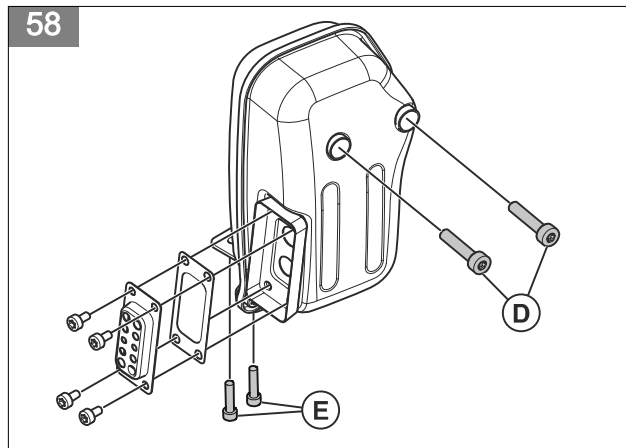
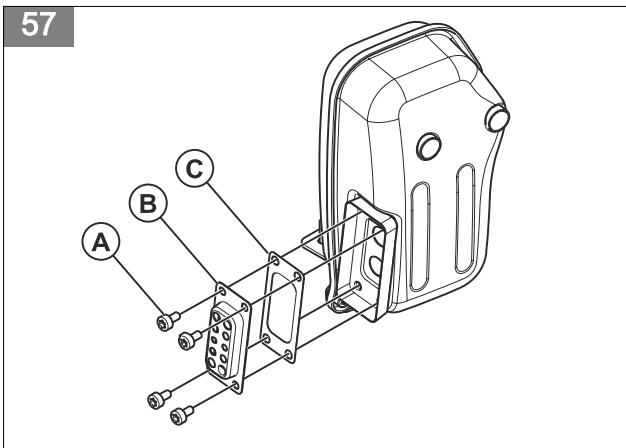
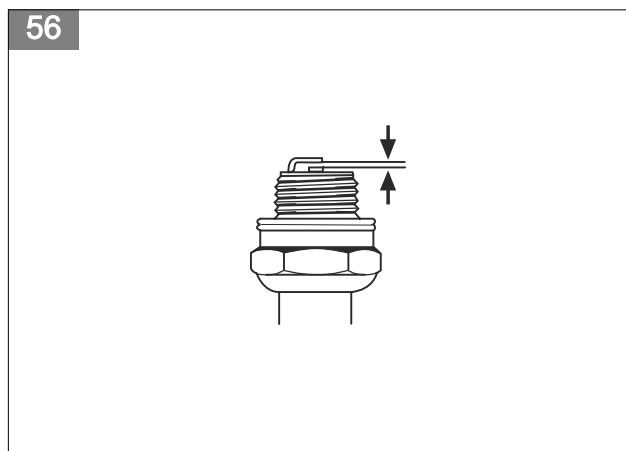
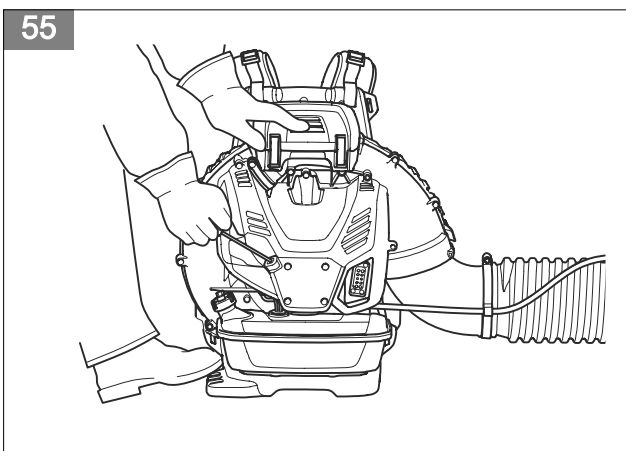

Contents

Introduction.....	9	Maintenance.....	16
Safety.....	10	Transportation, storage and disposal.....	18
Assembly.....	13	Troubleshooting.....	19
Operation.....	14	Technical data.....	19

Introduction

Product description

This product is a backpack blower with a combustion engine.

We have a policy of continuous product development and therefore reserve the right to modify the design and appearance of products without prior notice.

Intended use

Use the product to blow leaves and other unwanted material from areas such as lawns, pathways and asphalt roads.

Product overview

(Fig. 1)

1. Foot plate
2. Air purge bulb
3. Start button
4. Waist belt
5. Air intake screen
6. Frame
7. Harness
8. Air filter
9. Fan housing
10. Flexible hose
11. Stop switch with throttle position adjustment
12. Throttle control
13. Standard nozzle
14. Control pipe
15. Handle
16. Handle holder
17. Clamp
18. Pipe angle
19. Engine cover
20. Spark plug
21. Starter rope handle
22. Fuel tank
23. Combination wrench
24. Operator's manual

(Fig. 3)

Read the operator's manual carefully and make sure that you understand the instructions before use.

(Fig. 4)

Use approved hearing protection and approved eye protection. If the environment contains dust, use a breathing mask.

(Fig. 5)

Use approved protective gloves.

(Fig. 6)

Mixture of gasoline and two-stroke oil.

(Fig. 7)

Air purge bulb.

(Fig. 8)

Stop.

(Fig. 9)

Start button.

(Fig. 10)

Keep all parts of your body away from hot surfaces.

(Fig. 11)

The product agrees with the applicable EC directives.

(Fig. 12)

Noise emission to the environment label as per EU and UK directives and regulations, and New South Wales legislation "Protection of the Environment Operations (Noise Control) Regulation 2017. The guaranteed sound power level of the product is specified in *Technical data on page 19* and on the label

Symbols on the product

(Fig. 2)

WARNING! This product is dangerous. Injury or death can occur to the operator or bystanders if the product is not used carefully and correctly. To prevent injury to the operator or bystanders, read and obey all safety instructions in the operator's manual.

(Fig. 13)

Look out for thrown objects. Thrown objects can cause serious injury. Use personal protective equipment.

(Fig. 14)

Keep a safety distance at a minimum of 15 m to persons or animals.

yyyywwxxxxx

The rating plate or the laser printing shows the serial number. **yyyy** is the production year and **ww** is the production week.

Note: Other symbols/decals on the product refer to certification requirements for other commercial areas.

Euro V Emissions



WARNING: Tampering with the engine voids the EU type-approval of this product.

Product damage

We are not responsible for damages to our product if:

- the product is incorrectly repaired.
- the product is repaired with parts that are not from the manufacturer or not approved by the manufacturer.
- the product has an accessory that is not from the manufacturer or not approved by the manufacturer.
- the product is not repaired at an approved service center or by an approved authority.

Safety

Safety definitions

Warnings, cautions and notes are used to point out particularly important parts of the manual.



WARNING: Used if there is a risk of injury or death for the operator or bystanders if the instructions in the manual are not obeyed.



CAUTION: Used if there is a risk of damage to the product, other materials or the adjacent area if the instructions in the manual are not obeyed.

Note: Used to give more information that is necessary in a given situation.

General safety instructions



WARNING: Read the warning instructions that follow before you use the product.

- Do not do changes to the product without approval from the manufacturer and always use original accessories. Modifications and/or accessories that are not approved can result in serious injury or the death of the operator or others.
- Do not use a damaged product. Do the safety checks and maintenance given in this operator's manual. All other maintenance must be done by approved servicing personnel.

- All servicing and repair operations must be done by approved servicing personnel. If a part of the product is damaged, speak to your servicing dealer.

Safety instructions for operation



WARNING: Read the warning instructions that follow before you use the product.

- This product is a dangerous tool if used carelessly or incorrectly and can cause serious, even fatal injuries. It is extremely important that you read and understand the contents of this operator's manual.
- Long-term exposure to noise can result in permanent hearing impairment. Always use approved hearing protection.
- Do not operate the machine near open windows.
- Do an overall inspection of the machine before use. Refer to *Maintenance schedule on page 16*.
- Never use the machine if you are tired, if you have drunk alcohol, or if you are taking medication that could affect your vision, your judgement or your coordination.
- Wear personal protective equipment. Refer to *Personal protective equipment on page 11*.
- All covers and guards must be fitted before starting. Ensure that the spark plug cap and ignition lead are undamaged to avoid the risk of electric shock.
- The blower operator must make sure that no bystanders or animals come nearer than 15 m. Whenever several operators are working in the same work area, they should maintain a safe distance of at least 15 m from one another.
- It is necessary that bystanders wear eye protection.
- Never allow children to operate the machine. Never allow anyone else to use the machine without first

ensuring that they have read and understood the contents of the operator's manual.

- Always check for any objects that may block the air intake screen before beginning work.
- Never remove the air intake screen.
- In case of emergency, release yourself from the machine by opening the waist and chest belt and let the machine fall backwards.
- Always contact local authorities and make sure you are following applicable directives.
- Keep all parts of your body away from hot surfaces.
- Never start the machine indoors. Exhaust fumes can be dangerous if inhaled.
- Observe and be aware of the surroundings. Ensure that no people or animals can come into contact with the product. If anyone approaches your work area, set the throttle control to the lowest throttle until the person is at a safe distance. Direct the product away from people, animals, play areas, open windows and cars etc. No unauthorised persons or animals may be present in the working area, which is 15 metres.
- Overexposure to vibration can lead to circulatory damage or nerve damage in people who have impaired circulation. Contact your doctor if you experience symptoms of overexposure to vibration. Such symptoms include numbness, loss of feeling, tingling, pricking, pain, loss of strength, changes in skin colour or condition. These symptoms normally appear in the fingers, hands or wrists. The risk increases at low temperatures.
- Engine exhaust fumes contain carbon monoxide, which can cause carbon monoxide poisoning. For this reason you should not start or run the product indoors, or anywhere that is poorly ventilated. The exhaust fumes from the engine are hot and may contain sparks which can start a fire. Never start the product indoors or near combustible material.
- Allow the engine to cool before refueling.
- The powerful currents of air can move objects at such a speed that they can bounce back and cause serious eye injuries.

(Fig. 15)

- Do not direct the air jet towards people or animals.
- Do not use the machine in bad weather, such as dense fog, heavy rain, strong wind, intense cold, etc. Working in bad weather is tiring and can lead to dangerous conditions, e.g. slippery surfaces.
- Use the product as an alternative to a hose to save water.
- Minimize the time of operation by lightly wetting dusty areas or using spray equipment.
- Make sure you can move and stand safely. Check the area around you for possible obstacles (roots, rocks, branches, ditches, etc.) in case you have to move suddenly. Take great care when working on sloping ground.

(Fig. 16)

- Do not overreach when working.

- Never put the product down with the engine running unless you have it in clear sight.
- Never operate the product from ladders or high places (such as roofs), it is prohibited and could result in severe injury.

(Fig. 17)

- Do not use the product unless you are able to call for help in the event of an accident.
- Watch out for thrown objects. Always wear eye protection. Stones, rubbish, etc. can be thrown up into the eyes causing blindness or serious injury. Keep unauthorised persons at a distance. Children, animals, onlookers and helpers should be kept outside the safety zone of 15 m. Stop the machine immediately if anyone approaches.
- Do not operate the product if the exhaust gas outlet on the engine cover is covered by a wall and/or some other obstacles. The product could get damaged. Make sure that the distance is 50 cm or more from the obstacles during operation.
- Always stop the engine before cleaning.
- Always move the product away from the refueling area and source before starting. Place the product on a flat surface.
- The product may only be started in its complete design. If the product is started without all the guards fitted there is a risk of personal injuries.
- Dispose the debris in the waste receptacles after use of the product.

Personal protective equipment



WARNING: Read the warning instructions that follow before you use the product.

- Always use approved personal protective equipment when you use the product. Personal protective equipment cannot fully prevent injury but it decreases the degree of injury if an accident does occur. Let your dealer help you select the right equipment.
- Use approved hearing protection.

(Fig. 18)

- Use approved eye protection. If you use a visor, you must also use approved protective goggles. Approved protective goggles must agree with the ANSI Z87.1 standard in the USA or EN 166 in EU countries.

(Fig. 19)

- Use gloves when it is necessary, for example, when you examine or clean the product.

(Fig. 20)

- Use protective boots, or shoes, with non-slip soles.

(Fig. 21)

- Use clothing made of a strong fabric. Always use heavy, long pants and long sleeves. Do not use

loose clothing that can catch on twigs and branches. Do not wear scarves, jewelry, short pants, open shoes or go with bare feet. Put your hair up safely above your shoulders.

- Use breathing protection when there is a risk of dust.

(Fig. 22)

- Keep first aid equipment close at hand.

(Fig. 23)

Safety devices on the product



WARNING: Read the warning instructions that follow before you use the product.

- Do not use a product with safety devices that are damaged or do not operate correctly.
- Do a check of the safety devices regularly. Refer to *Maintenance on page 16*.
- If the safety devices are damaged or do not operate correctly, speak to your Husqvarna servicing dealer.

To do a check of the Muffler



WARNING: The muffler becomes very hot during/after operation and at idle speed. There is a risk of fire, especially when you operate the product near flammable materials and/or fumes.



WARNING: Do not operate a product without a muffler or with a damaged muffler. A damaged muffler can increase the noise level and the risk of fire. Keep fire extinguishing tools near. Do not use a product without, or with a broken, spark arrester mesh if you must have a spark arrester mesh in your area.



WARNING: Do not operate a product that has a damaged muffler or a muffler that is in bad condition. Return product to your local Husqvarna dealer/service station if the muffler is damaged.

The muffler keeps the noise levels to a minimum and points the exhaust fumes away from the operator. In areas with a hot, dry weather there is a high risk of fire. Obey local regulations and maintenance instructions. Refer to *To do maintenance of the muffler on page 17* for more information.

1. Stop the engine.
2. Do a visual check for damage and deformation.

Note: The inner surfaces of the muffler contain chemicals that can cause cancer. Be careful not to touch these elements if the muffler is damaged.

3. Make sure that the muffler is correctly attached to the product. Tighten the screws (A) to 10–12 Nm, and tighten the screws (B) to 6–8 Nm. (Fig. 24)
4. Examine the spark arrester screen (C), do a visual check.
 - a) Replace the spark arrester screen if it is damaged.
 - b) Clean the spark arrester screen if it is blocked. Refer to *To do maintenance of the muffler on page 17* for more information.

Vibration damping system

The product has a vibration damping system that decreases vibrations and makes operation easier. Examine the vibration damping system and make sure that it is not damaged. Make sure that the vibration damping system is attached correctly.

(Fig. 25)

Air filter

Do not use the product without an air filter or if the air filter is damaged or has a deformation.

Stop switch

Use the stop switch to stop the engine. Make sure that the engine stops fully.

(Fig. 26)

Harness safety

Always use the harness when you operate the product. If you do not use the harness, you cannot operate the product safely. This can result in injury to you or other persons. Make sure that the waist belt and chest strap are attached and correctly adjusted. There is a risk that an open belt can go into the fan of the product. Refer to *To adjust the harness and waist belt on page 14*.

(Fig. 27)

Fuel safety



WARNING: Read the warning instructions that follow before you use the product.

- Do not mix the fuel indoor or near a heat source.
- Do not start the product if there is fuel or engine oil on the product. Remove the unwanted fuel/oil and let the product dry. Remove unwanted fuel from the product.
- If you spill fuel on your clothing, change clothing immediately.

- Do not get fuel on your body, it can cause injury. If you get fuel on your body, use a soap and water to remove the fuel.
- Do not start the engine if you spill oil or fuel on the product or on your body.
- Do not start the product if the engine has a leak. Examine the engine for leaks regularly.
- Be careful with fuel. Fuel is flammable and the fumes are explosive and can cause injuries or death.
- Do not breathe in the fuel fumes, it can cause injury. Make sure that there is sufficient airflow.
- Do not smoke near the fuel or the engine.
- Do not put warm objects near the fuel or the engine.
- Do not add the fuel when the engine is on.
- Make sure that the engine is cool before you refuel.
- Before you refuel, open the fuel tank cap slowly and release the pressure carefully.
- Make sure there are sufficient airflow when refueling and mixing fuel (petrol and two-stroke oil) or draining the fuel tank.
- Fuel and fuel vapor are highly flammable and can cause serious injury when inhaled or allowed to come into contact with the skin. For this reason, observe caution when handling fuel and make sure there is sufficient airflow.
- Tighten the fuel tank cap carefully or a fire can occur.
- Move the product at a minimum of 3 m (10 ft) from the position where you filled the tank before a start.
- Do not put too much fuel in the fuel tank.
- Make sure that a leak cannot occur when you move the product or fuel container.
- Do not put the product or a fuel container where there is an open flame, spark or pilot light. Make sure that the storage area does not contain an open flame.
- Only use approved containers when you move the fuel or put the fuel into storage.
- Empty the fuel tank before long-term storage. Obey the local law on where to dispose fuel.
- Clean the product before long-term storage.
- Remove the spark plug cap before you put the product into storage to make sure that the engine does not start accidentally.

Safety instructions for maintenance



WARNING: Read the warning instructions that follow before you use the product.

- Your warranty may not cover damage or liability caused by the use of non-authorized accessories or replacement parts.
- The inside of the muffler contains chemicals that may be carcinogenic. Avoid contact with these elements in the event of a damaged muffler.
- Stop the engine before assembling or dismantling accessories or other parts.
- Disconnect the spark plug cable before you assemble the product, put the product into storage or do maintenance on the product.

Assembly

Introduction



WARNING: Read and understand the safety chapter before you assemble the product.

To assemble the tube and handle on the product

1. Use the clamp (A) to attach the flexible hose (B) and the throttle cable to the the pipe angle. Make sure that the throttle cable is placed in the groove on the inside of the clamp. (Fig. 28)
2. Make sure that the clamp screw is on the top of the tube. Hold the clamp in the correct position, push the screw into the clamp and tighten the screw. Make sure that the routing of the throttle cable go along the tube as shown in the illustration. (Fig. 29)
3. Use the clamp (C) to attach the control pipe (D) and the throttle cable to the flexible hose. Make sure that the throttle cable is placed in the groove on the inside of the clamp. (Fig. 30)

4. Make sure that the throttle cable is on the top of the tube. Hold the clamp in the correct position, push the screw into the clamp and tighten the screw. (Fig. 31)
5. Align the marks of the 3 lines on the standard nozzle (E) and on the control pipe (D). (Fig. 32)
6. Push the standard nozzle onto the control pipe. Turn the standard nozzle to lock it in position. (Fig. 33)

Note: You can lubricate the standard nozzle and the control pipe to make them easier to assemble.

To adjust the handle position

A correctly adjusted handle and product makes operation easier.

1. Loosen the lock on the handle clamp. (Fig. 34)
2. Slide the handle into position. (Fig. 35)
3. Tighten the lock on the handle clamp. (Fig. 36)

To adjust the harness and waist belt

1. Put on the harness of the product and adjust the shoulder straps to set the correct height of the product. (Fig. 37)
2. Connect the belt buckle for the chest strap. (Fig. 38)
3. Adjust the position of the chest strap. (Fig. 39)
4. Tighten the chest strap. (Fig. 40)
5. Put the waist belt around your waist and connect the belt buckle for the waist strap. (Fig. 41)
6. Tighten the waist belt strap. (Fig. 42)
7. Loosen the shoulder straps a little to move the weight to the waist belt. (Fig. 43)
8. Tighten the load lifter straps to get the product tight to body. (Fig. 44)

Operation

Introduction



WARNING: Read and understand the safety chapter before you use the product.

Connectivity

This product is prepared for connectivity and has a location for installation of a Husqvarna Connectivity Device. When the Husqvarna connectivity device is installed, the product has *Bluetooth®* wireless technology and can use Husqvarna Fleet Services™ to connect to mobile devices. This enables more functions.

Husqvarna Fleet Services™

Husqvarna Fleet Services™ is a cloud solution that gives the operator an overview of all products that are connected. On this product a Husqvarna Fleet Services™ sensor can be installed. The Husqvarna Fleet Services™ sensor collects product data and lets you connect to the Husqvarna Fleet Services™ system. The Husqvarna Fleet Services™ system reports data such as operation time, servicing intervals and location of the product.

For more information about Husqvarna Fleet Services™, download the Husqvarna Fleet Services™ app or speak to your Husqvarna representative.

To install the Husqvarna connectivity device

Do the steps that follow to install the Husqvarna connectivity device. For more information about the Husqvarna connectivity device, refer to www.husqvarna.com.

1. Loosen the 2 screws and remove the air intake cover. (Fig. 45)
2. Remove the torx screw and open the lid for the connectivity device. (Fig. 46)
3. Install the plug into the connectivity device. (Fig. 47)
4. Put the connectivity device in the lid. (Fig. 48)
5. Install the lid and tighten the screw. (Fig. 49)
6. Install the air intake cover and tighten the 2 screws. (Fig. 50)

Husqvarna Connect

Husqvarna Connect is a free app for your mobile device. The Husqvarna Connect app gives extended functions for your Husqvarna product.

- Extended product information.
- Information about, and help with, product parts and servicing.

To start to use Husqvarna Connect

1. Download the Husqvarna Connect app on your mobile device.
2. Register in the Husqvarna Connect app.
3. Follow the instruction steps in the Husqvarna Connect app to connect and register the product.

Note: Husqvarna Connect app is not available for download in all markets. Speak to your servicing dealer for more information.

Fuel

To use fuel



CAUTION: This product has a two-stroke engine. Use a mixture of gasoline and two-stroke engine oil. Make sure to use the correct quantity of oil in the mixture. Incorrect ratio of gasoline and oil can cause damage to the engine.

Husqvarna alkylate fuel



CAUTION: Do not use gasoline with an octane number less than 90 RON (87 AKI). This can cause damage to the product.



CAUTION: Do not use gasoline with more than 10% ethanol concentration (E10). This can cause damage to the product.



CAUTION: Do not use leaded gasoline. This can cause damage to the product.

We recommend Husqvarna alkylate fuel for best performance. This fuel gives less dangerous exhaust fumes compared to regular fuel. It keeps the engine clean and increases the engine life. Husqvarna alkylate fuel is not available in all commercial areas.

- Always use new unleaded gasoline with a minimum octane number of 90 RON (87 AKI) and with less than 10% ethanol concentration (E10).
- Use gasoline with a higher octane number if you frequently use the product at continuously high engine speed.
- Always use a good quality unleaded gasoline/oil mixture.

Two-stroke oil

- For best results and performance use Husqvarna two-stroke oil, which is specially formulated for our two-stroke engines.
- If Husqvarna two-stroke oil is not available, use a different two-stroke oil of good quality that is formulated for air-cooled engines. Consult your servicing dealer when you select an oil.
- Do not use two-stroke oil for water-cooled outboard engines, also referred to as outboard oil.
- Do not use oil intended for four-stroke engines.

Gasoline, liters	Two-stroke oil, liters
	2% (50:1)
5	0.10
10	0.20
15	0.30
20	0.40

To make the fuel mixture

Note: Always use a clean fuel container when you mix the fuel.

Note: Do not make more than 30 days quantity of fuel mixture.

1. Add half of the gasoline quantity.
2. Add the full quantity of oil.
3. Shake the fuel mixture to mix the contents.
4. Add the remaining gasoline quantity.
5. Shake the fuel mixture to mix the contents.
6. Fill the fuel tank.

To add fuel

- Always use a fuel container with an antispill valve.

- If there is some fuel on the container, remove the unwanted fuel and let the container dry.
- Make sure that the area near the fuel tank cap is clean.
- Shake the fuel container before you add the fuel mixture to the fuel tank.

To add fuel to the fuel tank

1. Stop the product.
2. Put the product on a flat surface.
3. Loosen the fuel tank cap to release the pressure in the fuel tank.
4. Remove the fuel tank cap.
5. Fill the fuel tank to 80%.
6. Tighten the fuel tank cap fully.
7. Make sure that there is no leak in the fuel tank.

Before you operate the product



WARNING: Read the safety instructions before you operate the product.

- Use the blower with the lowest possible throttle. A lower throttle means less noise and less dust, and it is also easier to keep control over the rubbish collected together/moved.
- Use a rake or a brush to release rubbish stuck to the ground.
- Use the minimum number of blowers along with other equipment to reduce the sound level.
- Hold the opening of the blower as close to the ground as possible. Utilize the entire length of the blow pipe to keep the air current close to the ground. Clean up afterwards. Make sure that you have not blown rubbish into someone's garden.
- Operate power equipment only at reasonable hours, not early in the morning or late at night when people might be disturbed. Comply with times listed in local ordinances.
- This blower is a backpack type, and is carried using a shoulder harness while operating. It is operated and controlled with the handle on the tube using the right hand.
- The speed of the air jet is regulated by means of the throttle. Select the speed best suited for respective tasks.
- Check that the air intake is not blocked, for example, by leaves or rubbish. A clogged air intake reduces the machine's blowing capacity and increases the engine's working temperature, which can result in engine failure. Stop the engine and remove the object.
- Be aware of the wind direction. Work with the wind to make your work easier.
- Using the blower to move large piles is time consuming and creates unnecessary noise.

- Keep a good balance and a firm foothold.
- When work is finished the machine should be stored vertically.

To operate the throttle control

- To increase the blower speed during operation, push the throttle control until you get the correct speed. (Fig. 51)
- To decrease the blower speed during operation, release the throttle control until you get the correct speed.

To operate the stop switch with throttle position adjustment

The stop switch with throttle position adjustment (A) lets you set the blower speed without the throttle control.

- To increase the set blower speed during operation, push the stop switch (A) up. (Fig. 52)
- To decrease the set blower speed during operation, push the stop switch down.
- To stop the product, push the stop switch down fully.

To start the product

1. Set the throttle to the position for idle speed. (Fig. 53)
2. Push the start button down fully until it locks in position.

Note: If the throttle is not set to idle speed, the start button does not lock in position.

3. Push the air purge bulb again and again until fuel starts to fill the air purge bulb. It is not necessary to fill the air purge bulb fully. (Fig. 54)
4. Put the product on a flat surface on the ground.
5. Hold the product with the left hand and put one foot on the foot plate.
6. Pull the starter rope handle slowly until resistance occurs. (Fig. 55)
7. Pull the starter rope handle quickly with the right hand until the engine starts.

Note: Do not pull the starter rope handle to full extension and do not let go of the starter rope handle.

8. Let the engine run for 2–3 minutes to become warm before operation.

To stop the product



CAUTION: Stop the product when the engine is at idle speed.

- Push the stop switch. (Fig. 26)

Maintenance

Introduction



WARNING: Read and understand the safety chapter before you do maintenance on the product.

Maintenance schedule

Maintenance	Daily	Weekly	Monthly
Clean the external surfaces.	X		
Make sure that the control handle operates correctly.	X		
Make sure that the start/stop switch operates correctly.	X		
Examine the engine, the fuel tank and the fuel lines for leaks. Examine the fuel filter for contamination. Replace the fuel filter if it is necessary.	X		
Clean the air filter. Replace the air filter if it is necessary.	X		
Tighten nuts and screws.	X		
Examine the air intake and make sure that it is not blocked.	X		
Examine the starter and the starter rope for damages.		X	

Maintenance	Daily	Weekly	Monthly
Examine the vibration damping units for damages, cracks and deformation. Make sure that the vibration damping units are correctly installed.		X	
Examine the spark plug. Refer to <i>To do a check of the spark plug on page 17.</i>		X	
Clean the cooling system.		X	
Clean the external surface of the carburetor and the area around it.		X	
Clean the fuel tank.			X
Examine all cables and connections.			X
Examine and clean the spark arrestor screen on the muffler (for products without catalytic converter).		X	
Examine and clean the spark arrestor screen on the muffler (for products with catalytic converter).			X
Examine the spark plug. Replace if it is necessary.			X

To do a check of the spark plug



CAUTION: Use the recommended spark plug. Refer to *Technical data on page 19.* An incorrect spark plug can cause damage to the product.

- If the product is not easy to start or to operate or if the product operates incorrectly at idle speed, examine the spark plug for unwanted materials. To decrease the risk of unwanted material on the spark plug electrodes, do these steps:
 - make sure that the idle speed is correctly adjusted.
 - make sure that the fuel mixture is correct.
 - make sure that the air filter is clean.
- Clean the spark plug if it is dirty.
- Make sure that the electrode gap is correct. Refer to, *Technical data on page 19.* (Fig. 56)
- Replace the spark plug monthly or more frequently if necessary.

To do a check of the start/stop switch

- Use the start/stop switch to stop the engine (Fig. 26)
- Make sure that the engine stops fully.

To clean the cooling system



CAUTION: A dirty or blocked cooling system can make the product too hot, which can cause damage to the product.

The cooling system includes the cooling fins on the cylinder and the air intake screen.

- Make sure that the cooling system is not dirty or blocked.
- Clean the cooling system with a brush weekly or more frequently if it is necessary.

To do maintenance of the muffler



WARNING: Do not use a product that has a damaged muffler.



WARNING: Do not use a product if the spark arrestor screen on the muffler is missing or damaged.



WARNING: The mufflers become very hot during and after operation, also at idle speed. Use protective gloves to prevent burn injuries.

- Stop the engine and let the muffler become cool.
- Replace the spark arrestor screen if it is damaged.
- Remove the screws (A) and remove the exhaust duct (B). (Fig. 57)

Note: The inner surfaces of the muffler contain chemicals that can cause cancer. Be careful not to touch these elements if the muffler is damaged.

- Remove the spark arrestor screen (C) and clean it with a wire brush. Remove dirt from the inlet and outlet of the muffler with the wire brush. Also, remove dirt from the exhaust port of the cylinder with the wire brush.
- Attach the spark arrestor screen and the exhaust duct with the screws. Tighten the screws to 2–3 Nm.

6. Make sure that the muffler is correctly attached to the product. Tighten the screws (D) to 10–12 Nm, and tighten the screws (E) to 6–8 Nm. (Fig. 58)



CAUTION: The spark arrestor mesh must be replaced if it is damaged. Do not use a product if the spark arrestor mesh on the muffler is missing or damaged.



CAUTION: If the spark arrestor mesh is frequently blocked it can be a sign that performance of the catalytic converter is decreased. Turn to your servicing dealer to examine the muffler. A blocked spark arrestor mesh will cause overheating and result in damage to the cylinder and piston.

To examine the air intake screen

A clogged air intake screen decreases the blow force and increases the temperature of the engine. An increased temperature can result in engine failure.

1. Stop the engine.
2. Disconnect the spark plug cable.
3. Examine the air intake screen for damages. Make sure that the air intake screen is attached correctly with clips and straps. (Fig. 59)
4. Remove dirt, leaves and unwanted materials from the air intake screen.

To clean the air filter

Clean the air filter regularly from dirt and dust. This prevents carburetor malfunctions, start problems, loss of engine power, wear to engine parts and more fuel consumption than usual. Clean the air filter at an interval of 40 hours of operation or less if the operation conditions are heavy.

1. Loosen the fasteners that holds the air filter cover in position. (Fig. 60)
2. Remove the air filter cover (A). (Fig. 61)
3. Remove the foam filter (B) from the air filter cover.
4. Remove the paper filter (C) from the filter frame.
5. Replace the paper filter.
6. Clean the foam filter with warm soap water.

Note: An air filter that is used for a long time cannot be fully cleaned. Replace the air filter regularly and always replace a damaged air filter.

7. Make sure that the foam filter is dry.
8. Clean the inner surface of the air filter cover with a brush.
9. Put the foam filter in the air filter cover. Make sure that the foam filter side with the word UP faces the air filter cover.
10. Install the air filter cover and fasteners.

To replace the harness and waist belt



WARNING: A damaged harness can make the product fall and cause injuries.

1. Stop the engine.
2. Loosen the straps if it is necessary.
3. Push the clamps through the holes in the frame to remove the harness and waist belt.
4. Attach the clamps of the new harness and waist belt through the holes in the frame.
5. Make sure that all straps and clamps are safely attached to the frame.

Transportation, storage and disposal

Transportation and storage



WARNING: To prevent the risk of fire, make sure that there are no leaks or fumes during transportation or storage. Make sure that there is no risk of sparks or fire.

- Empty the fuel tank before transportation or long-term storage. Push the air purge bulb to make sure that all fuel is removed. Discard the fuel at an applicable disposal location.
- Make sure that the product is clean and that a full servicing is done before long-term storage.
- Remove the spark plug and put approximately 1–2 ml of two-stroke oil into the cylinder. Pull the starter

- rope handle slowly 3 times and install the spark plug again.
- Attach the product safely to the vehicle during transportation.
- Keep the product in a dry, cool and clean space with good airflow. Keep the product away from children.

Disposal

- Obey the local recycling requirements and applicable regulations.
- Discard all chemicals, such as engine oil or fuel, at a service center or at an applicable disposal location.
- When the product is no longer in use, send it to a Husqvarna dealer or discard it at a recycling location.

Troubleshooting

The engine does not start		
Check	Possible cause	Solution
Stop switch.	The stop switch is in the stop position.	Let an approved service agent replace the stop switch.
Starter pawls.	The starter pawls cannot move freely.	Remove the starter cover and clean around the starter pawls.
		Let an approved service agent help you.
Fuel tank.	Incorrect fuel type.	Drain the fuel tank and fill it with the correct fuel.
Spark plug.	Spark plug is dirty or wet.	Make sure that the spark plug is dry and clean.
	The electrode gap on the spark plug is incorrect.	Clean the spark plug. Make sure that the electrode gap is correct. Make sure that the spark plug has a suppressor.
		Refer to technical data for the correct electrode gap.
	Spark plug is loose.	Tighten the spark plug.

Engine starts but stops again		
Check	Possible cause	Solution
Fuel tank.	Incorrect fuel type.	Drain the fuel tank and fill it with the correct fuel.
Air filter.	The air filter is clogged.	Clean the air filter.

Technical data

Technical data

	590BTS
Engine	
Cylinder displacement, cm ³	79.4
Idle speed, min ⁻¹ (rpm)	2000
Maximum power speed, min ⁻¹ (rpm)	7700

	590BTS
Catalytic converter muffler	No
Speed-regulated ignition system	Yes
Ignition system	
Spark plug	NGK CMR7H
Electrode gap, mm	0.6–0.7
Fuel and lubrication system	
Fuel tank capacity, l / cm ³	2.7/2700
Weight	
Weight, kg	11.9
Fan performance	
Maximum air velocity with standard nozzle, mph / m/s	216/96
Air flow with standard nozzle, cfm / m ³ /min	1245/35
Noise emissions ¹	
Sound power level, measured dB (A)	113
Sound power level, guaranteed L _{WA} dB (A)	114
Sound levels ²	
Equivalent sound pressure level at the operator's ear, measured according to EN 15503, dB (A):	
Equipped with blower nozzle (original)	106
Vibration levels ³	
Equivalent vibration levels (a _{hv,eq}) at handles, measured according to EN15503, m/s ²	1.5

Compliance and approvals

Hereby, Husqvarna AB, SE-561 82 Huskvarna, Sweden, tel: +46-36-146500, declares that the equipment type 590BTS is in conformity with the Directives and the regulation 2006/42/EC, 2014/30/EU, 2000/14/EC, 2011/65/EU.

The full text of the EU declaration of conformity is available at the following internet address: www.husqvarna.com; search for the product, and choose DoC applicable to the manufacture date of your product. The serial number with date of manufacture can be found on the product type plate.

¹ Noise emissions in the environment measured as sound power (L_{WA}) in conformity with EC directive 2000/14/EC. The difference between guaranteed and measured sound power is that the guaranteed sound power also includes dispersion in the measurement result and the variations between different machines of the same model according to Directive 2000/14/EC.

² Reported data for equivalent sound pressure level for the product has a typical statistical dispersion (standard deviation) of 3 dB (A).

³ Reported data for vibration level has a typical statistical dispersion (standard deviation) of 2 m/s².